

Railway Inn, Hampton

Do not scale from this print. Use figured dimensions only. Contractors are responsible for taking and checking site dimensions.
Design copyright is vested in the Company before from whom consent must be obtained for copying or reproducing this drawing.

PRELIMINARY



10/0013/DDJ

STATION ROAD

Site Access

127
127a

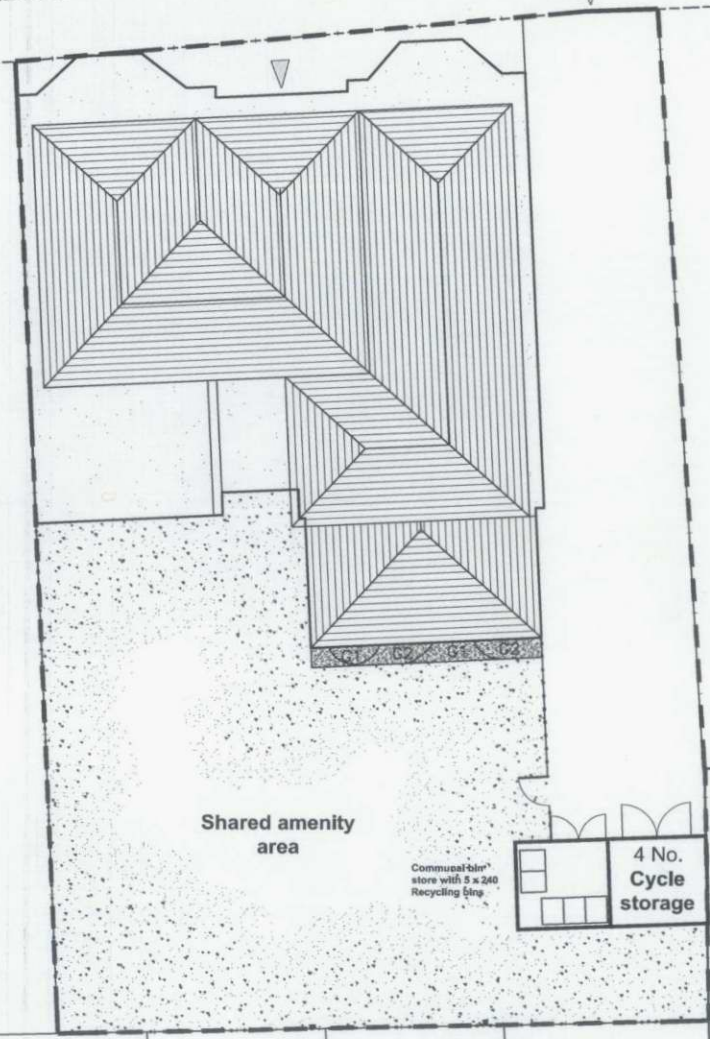

GENERAL KEY	
	GRASSED AREA, REFER TO LANDSCAPE DRAWING.
	1.8M HIGH CLOSE BOARDED FENCE, PLEASE REFER TO BOUNDARY TREATMENT DRAWING REF 174/10/500
	SITE BOUNDARY
	ACCESS GATES
	ROAD TO BE BLOCK PAVIORS
	ACCESS POINTS

LANDSCAPE KEY			
GROUND COVERS - GROUP 1 (G1)	HEIGHT	POT SIZE	CENTRE
GALIUM ODORATUM	20-30cm	1 LITRE	300
GERANIUM SANGUINEUM	20-30cm	1 LITRE	300
LAMIUM MACULATUM	20-30cm	1 LITRE	300
LYSIMACHIA NUMMULARIA	20-30cm	1 LITRE	300
GROUND COVERS - GROUP 2 (G2)	HEIGHT	POT SIZE	CENTRE
FILIPENDULA ULMORIA	20-30cm	1 LITRE	300
HEDERA HIBERNICA (HELIX 'HIBERNICA')	40-60cm	2 LITRE	600
TIARELLA CORDOLIA	20-30cm	1 LITRE	300
VINCA MINOR 'ARGENTEOVARIEGATA' (v.m. 'VARIEGATA')	20-30cm	1 LITRE	300

Shared amenity area

Communal bin store with 5 x 240 Recycling bins

4 No. Cycle storage

For further details on bin/cycle storage area, please refer to drawing 174/10/501

B Updated bicycle configuration as indicated. 228311
A Amended to suit planning approved site plan. 17/03/11



Project Railway Inn, Hampton
Title Site Plan
Scale 1:100 @ A2
Date January 2011
Drawn JB
Checked SRH

10001 FLOOR 7A SALISBURY SQUARE
OLD HATFIELD HERTS AL5 2AG
T 04577 272 001 F 01753 770 078
www.ashbydesign.co.uk

Drawing No. 174/11/1000
Revision B

59

Site Plan