

SWEPT PATH OF REFUSE VEHICLE ENTERING DEVELOPMENT

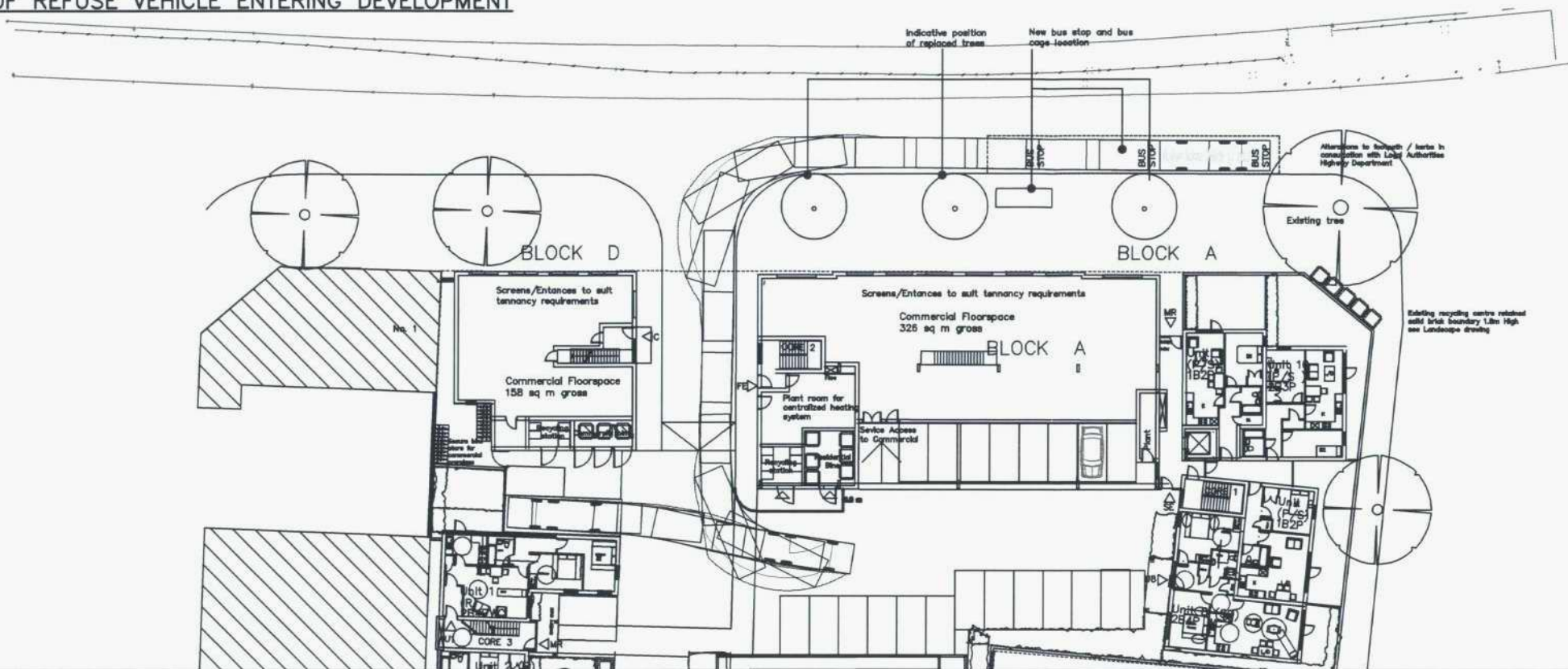

notes

- 1 DO NOT SCALE THIS DRAWING ON PRINT OR ELECTRONICALLY. WORK FROM FIGURED DIMENSIONS ONLY
- 2 No deviation from the details shown on this drawing is allowed without CampbellReith's prior permission in writing.
- 3 Read this drawing with all Architects, Service Engineers and CampbellReith's relevant details and drawings.
- 4 All work is to be in accordance with the relevant specifications issued by CampbellReith, British Standard Codes of Practice, Statutory requirements and the Contract Documents.
- 5 DRAWING STATUS
 S :- SCHEME ——— Outline/Scheme drawings for proposals, budgets etc.
 D :- DESIGN DEVELOPMENT — Evolving final design drawings for approvals, tenders, billing etc.
 C :- CONSTRUCTION ——— Fully developed drawings issued under instruction for construction.

ONLY STATUS C DRAWINGS TO BE USED FOR CONSTRUCTION.

07 DEC 2009

SWEPT PATH OF REFUSE VEHICLE EXITING DEVELOPMENT

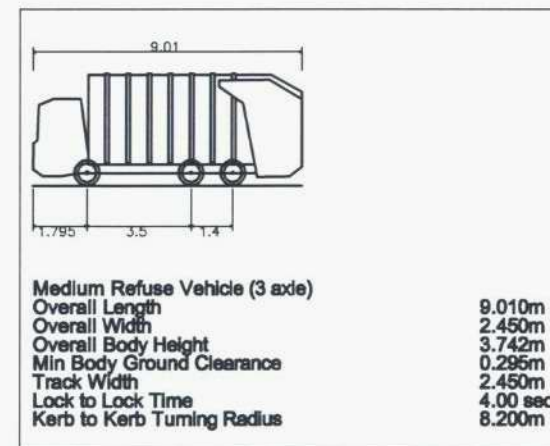
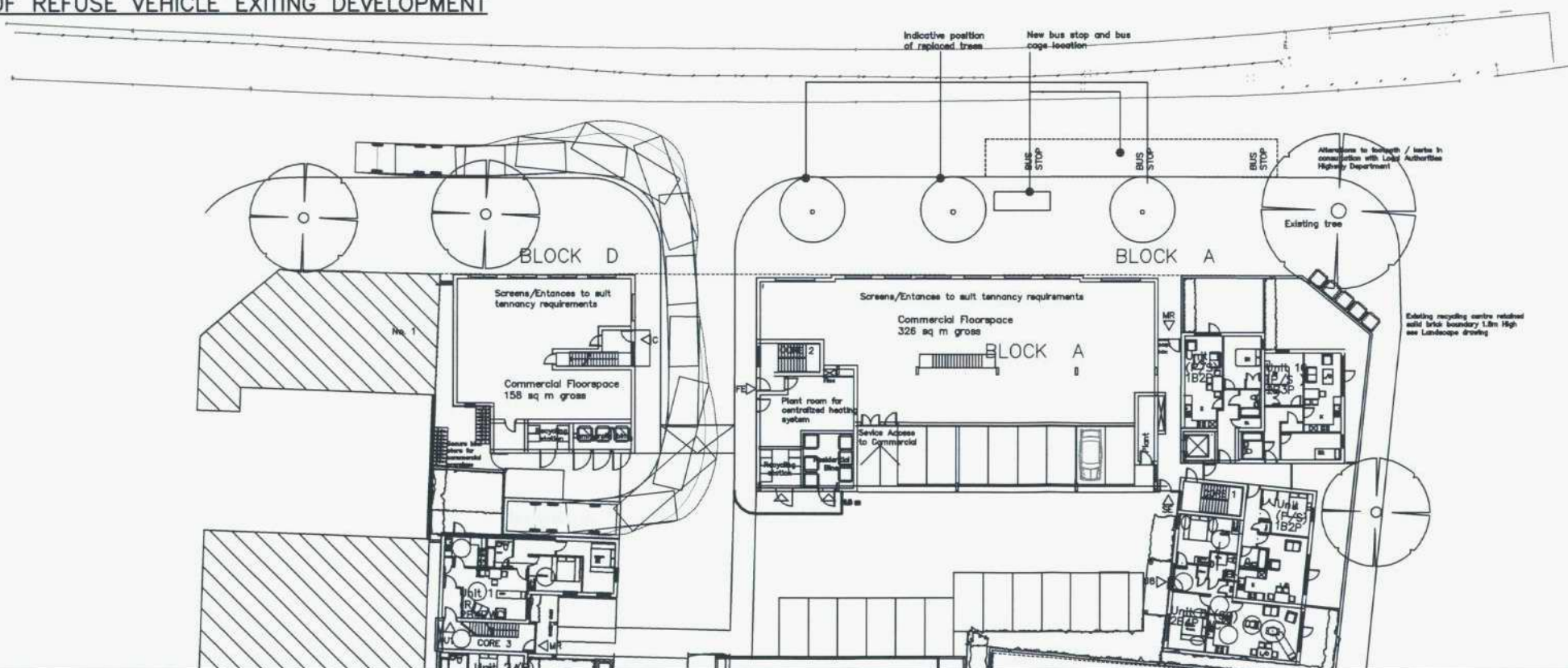

D2	ISSUED FOR INFORMATION	02.06.08	MJ
D1	ISSUED FOR INFORMATION	02.06.08	MJ
Status/Rev	Description	Date	By

Job Title
293 LOWER RICHMOND RD
SWEPT PATH ANALYSIS
OF MEDIUM REFUSE VEHICLE

CampbellReith
 consulting engineers

LONDON 020 7340 1700 • MANCHESTER 0161 619 3000
 REDHILL 01737 784 600 • BIRMINGHAM 01675 467 484
 www.campbellreith.com

drawn	date	scale	C1 checked	CAD filename	Job No.	Drq No.	Status/Rev
MV	05.08	1:500	—	8894-T302	8894	T302	D2