

All dimensions to be verified on site by Main Contractor before the start of any shop drawings or work whatsoever either on their own behalf or that of sub-contractors.
 Report any discrepancies to the Contract Administrator of once.
 This drawing is to be read with all relevant Architects and Engineers drawings and other relevant information.
 © Ingleton Wood LLP

05/1493/ FU1

| | |
|----------|-------------|
| DATE | 03 MAY 2005 |
| BY | |
| CHECKED | |
| APPROVED | |

LEGEND: DO NOT SCALE

- Buxus Sempervirens
- Euonymus Fortunei Coloratus
- Ceanothus Diamond Heights
- Hebe Plagiifolia 'Hidcote'
- Skimmia Japonica 'Fructu-rosa'
- Vinca Major 'Variegata'
- Potentilla 'Abbotswood'
- Lavandula Augustifolia 'Hidcote'
- Lawn Camomile
- Hydrangea Macrophylla-Serrata Bluebird
- Ceanothus Thyrsiflorus
- Cornus cotoneaster
- Existing Trees and Shrubs
- Hedera Helix Atropurpurea
- Hedera Helix Ivaceae

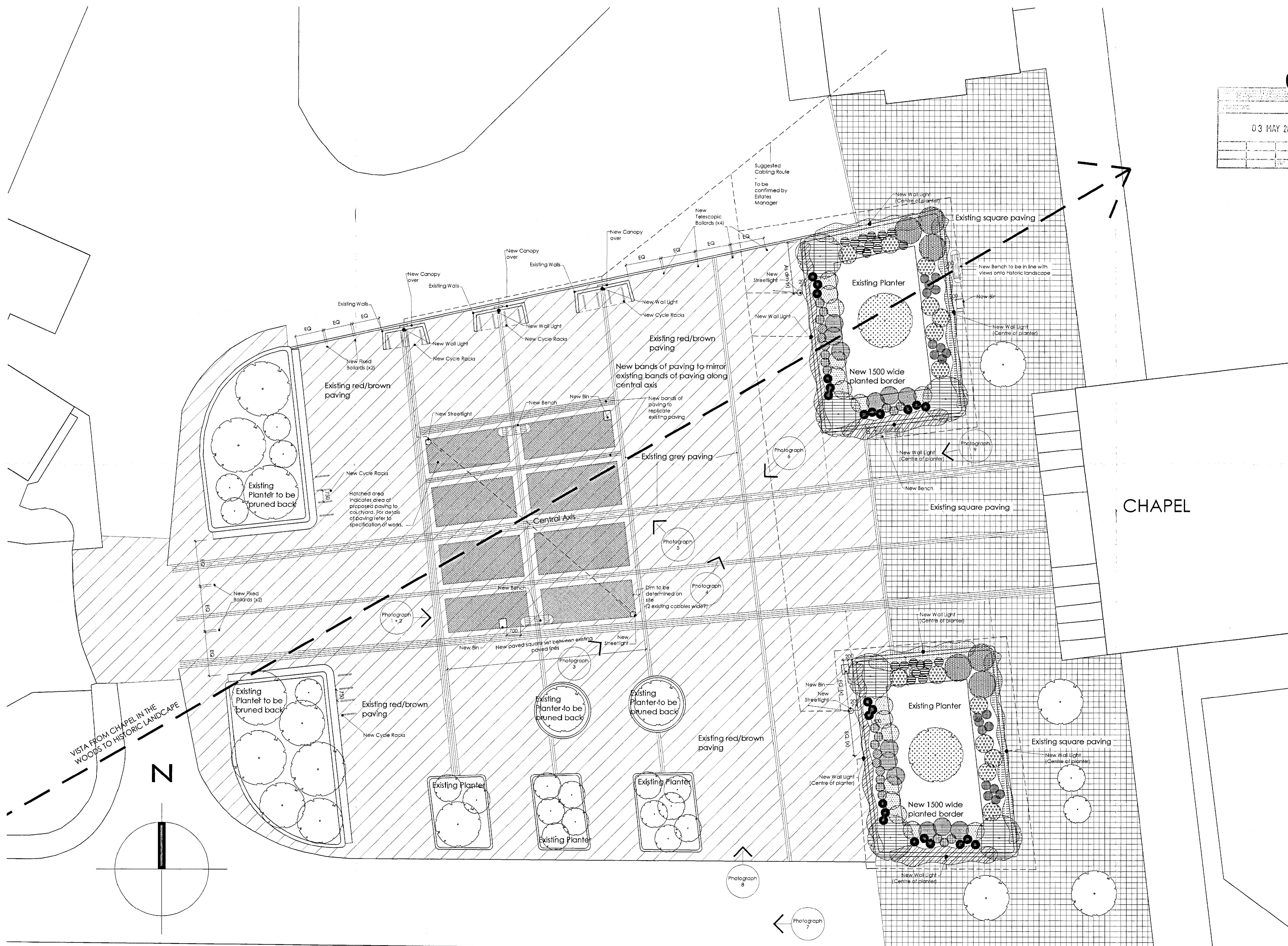

| Revision | Date | Description | Drawn | CHK |
|----------|------|-------------|-------|-----|
| | | | | |

Ingleton Wood a multi-disciplinary practice of:
 • architects
 • building surveyors
 • quantity surveyors
 • building services consultants

434 The London Fruit & Wood Exchange • Bushfield St • London • E1 6EX
 T: 0207 377 0301 • F: 0207 377 0401 • www.ingletonwood.co.uk
 Ingleton Wood LLP trading as Ingleton Wood. Reg no. 0036573. Partners are members of the IIP.
 London • Billerica • Brentwood • Colchester • Harlow • Oxford

Project: **St Mary's College Street Furniture and Poster Management**

Drawing Title: **Chapel Courtyard Upgrade Plan Option 2 (also options 3A and 3B)**

Client: **St Mary's College**

| | | | | |
|--------|----------|----------|--------|-------------|
| Drawn: | Checked: | Date: | Scale: | Folio Size: |
| CB | - | 24.02.05 | 1:100 | A1 |

| | | | |
|---------|----------|----------|--|
| Job no. | Drawn by | Revision | |
| 81066 | 903 - 2 | - | |

- Preliminary
- Design
- Tender
- Contract
- Working