

RECEIVED  
11 SEP 2012  
PLANNING

12/1486/FUL

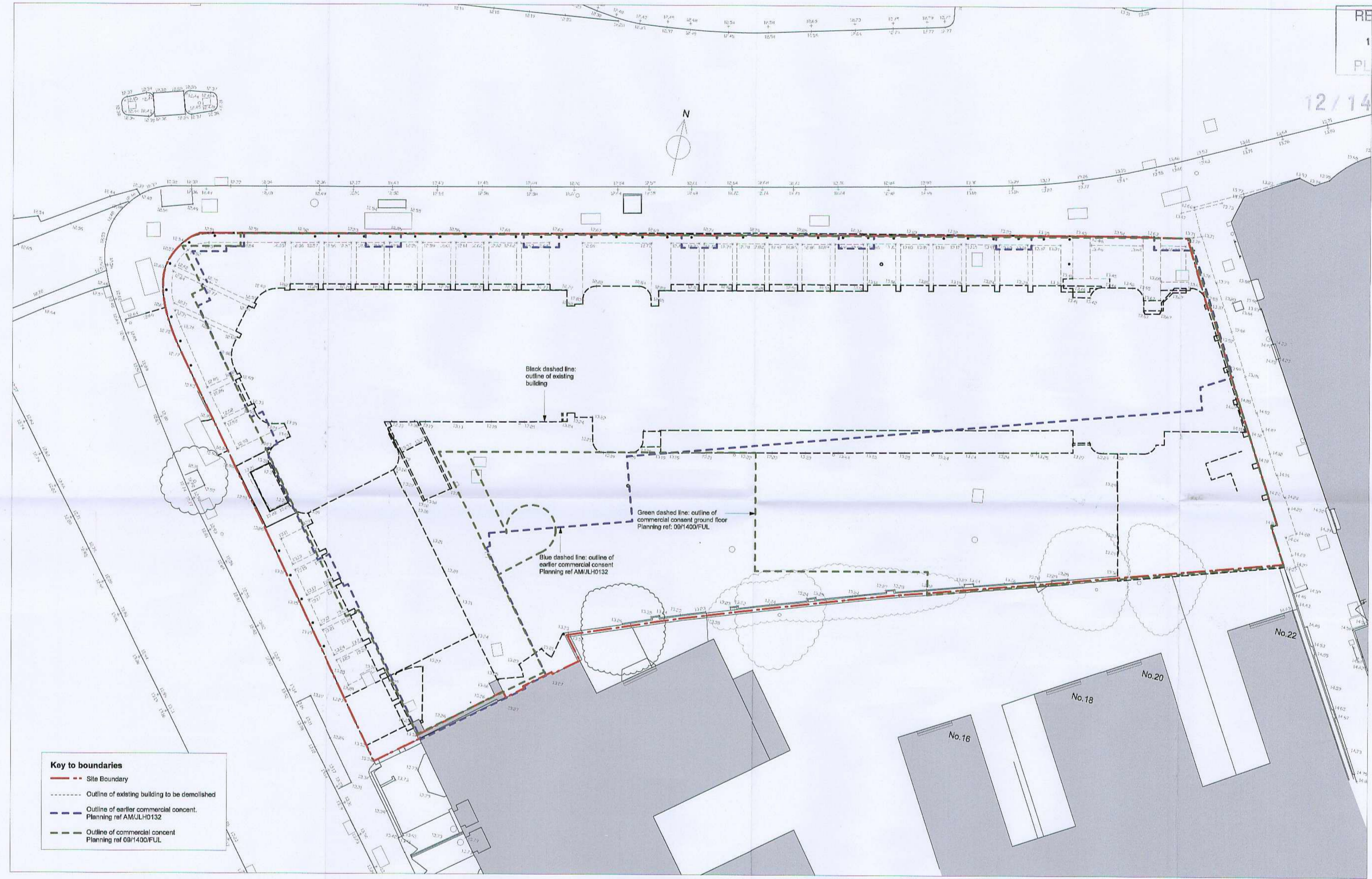

**Key to boundaries**

- - - Site Boundary
- - - - - Outline of existing building to be demolished
- - - - - Outline of earlier commercial consent. Planning ref AM/ALH0132
- - - - - Outline of commercial consent Planning ref 09/1400/FUL

Existing site plan

Notes:  
Do not scale dimensions from this drawing.  
Dimensions marked with an asterisk (\*) are open site dimensions to be confirmed on site.  
All given dimensions are to be checked on site when setting out and any discrepancy reported immediately.

**001 Hazard Notes**

Please be aware of the following Hazards have been identified in relation to the works shown on this drawing

ID	Hazard	Action
1	Restricted access to site	Phase works to allow continued occupation of building
2	Restrictions site area	Phase works in relation to peak times
3	Services (buried or in structures)	Survey site prior to works
4	Contamination	Survey site and remove contamination
5	Existing structures	Survey prior to demolition
6	Underground structures - Gas tanks	Survey
9	Ground water flooding	Monitor during excavations

A 9/8/12 GF outline of commercial consent amended ods pbp  
Rev: Date: Notes: By: Chid

Project:  
9-19 Paradise Road, Richmond

Client:  
Henry Boot Ltd

Drawing title:  
Proposed New Hotel  
Existing Site Plan

Ref: Sheet:  
-p03

Date: Scale:  
19.03.2012 1:100 @ A1

Drawn by: Checked by:  
ods pbp

Drawing no.: Revision:  
0779-02-101 A

bpr architects  
The Boathouse, Embankment  
Putney, London, SW15 1LB  
t +44(0)20 8785 9983  
f +44(0)20 8780 1507  
e info@bprarchitects.com  
www.bprarchitects.com