

RECEIVED
11 SEP 2012
PLANNING



Key to boundaries

- - - Site Boundary
- - - Outline of existing building to be demolished
- - - Outline of earlier commercial concept, Planning ref AM/JLH0132
- - - Outline of commercial concept, Planning ref 09/1400/FUL

Ground Floor Plan

Notes:
Do not scale dimensions from this drawing.
Dimensions marked with an asterisk (*) are open site dimensions to be confirmed on site.
All given dimensions are to be checked on site when setting out and any discrepancy reported immediately.

002 Hazard Notes

Please be aware of the following Hazards have been identified in relation to the works shown on this drawing

ID	Hazard	Action
1	Restricted access to site	Phase works to avoid peak periods of high traffic
2	Restrictions site area	Plan storage opt materials, avoid stacking of materials
3	Residential area	Take care to avoid disruption to neighbours
4	Rear garden wall	Garden wall to remain - protect and stabilize during works
5	Existing trees	protect trees and plants in neighbours gardens
6	Privacy	Be considerate to the privacy of teh neighbours gardens during the works.
9	narrow passagae	Minimise access through Vineyard Passagae

E	30/8/12	Window reveal depth increased	ods	pdp
D	11/8/12	Revised in line Planners comments	ods	pdp
C	9/8/12	GF outline of commercial concept amended	ods	pdp
B	4/8/12	Curian wall to lobby revised Section EE reference added	ods	pdp
A	17/4/12	Revised in line with TL comments	ods	pdp

Rev/ Date Notes By Chkd

Project:
9-19 Paradise Road, Richmond

Client:
Henry Boot Ltd

Drawing title:
Proposed New Hotel
Ground Floor Plan

Ref: -p03 Sheet:

Date: 19.03.2012 Scale: 1:100 @ A1

Drawn by: ods Checked by: pdp

Drawing no.: 0779-02-102 E Revisor:

RECEIVED
11 SEP 2012
PLANNING



Key to boundaries

- - - Site Boundary
- - - Outline of existing building to be demolished
- - - Outline of earlier commercial concept, Planning ref AM/JLH0132
- - - Outline of commercial concept Planning ref 09/1400/FUL

Ground Floor Plan

Notes:
Do not scale dimensions from this drawing.
Dimensions marked with an asterisk (*) are open site dimensions to be confirmed on site.
All given dimensions are to be checked on site when setting out and any discrepancy reported immediately.

002 Hazard Notes

Please be aware of the following Hazards have been identified in relation to the works shown on this drawing

ID	Hazard	Action
1	Restricted access to site	Phase works to avoid peak periods of high traffic
2	Restrictions site area	Plan storage opt materials, avoid stacking of materials
3	Residential area	Take care to avoid disruption to neighbours
4	Rear garden wall	Garden wall to remain - protect and stabilize during works
5	Existing trees	protect trees and plants in neighbours gardens
6	Privacy	Be considerate to the privacy of teh neighbours gardens during the works.
9	narrow passagae	Minimise access through Vineyard Passgae

E	30/8/12	Window reveal depth increased	ods	pdp
D	11/8/12	Revised in line Planners comments	ods	pdp
C	9/8/12	GF outline of commercial concept amended	ods	pdp
B	4/8/12	Curian wall to lobby revised Section EE reference added	ods	pdp
A	17/4/12	Revised in line with TL comments	ods	pdp

Rev/ Date Notes By Chkd

Project:
9-19 Paradise Road, Richmond

Client:
Henry Boot Ltd

Drawing title:
Proposed New Hotel
Ground Floor Plan

Ref: Sheet:
-p03

Date: Scale:
19.03.2012 1:100 @ A1

Drawn by: Checked by:
ods pdp

Drawing no.: Revisor:
0779-02-102 E

bpr architects
The Boathouse, Embankment
Putney, London, SW15 1LB
t +44(0)20 8785 9983
f +44(0)20 8780 1507
e info@bprarchitects.com
www.bprarchitects.com

RECEIVED
11 SEP 2012
PLANNING

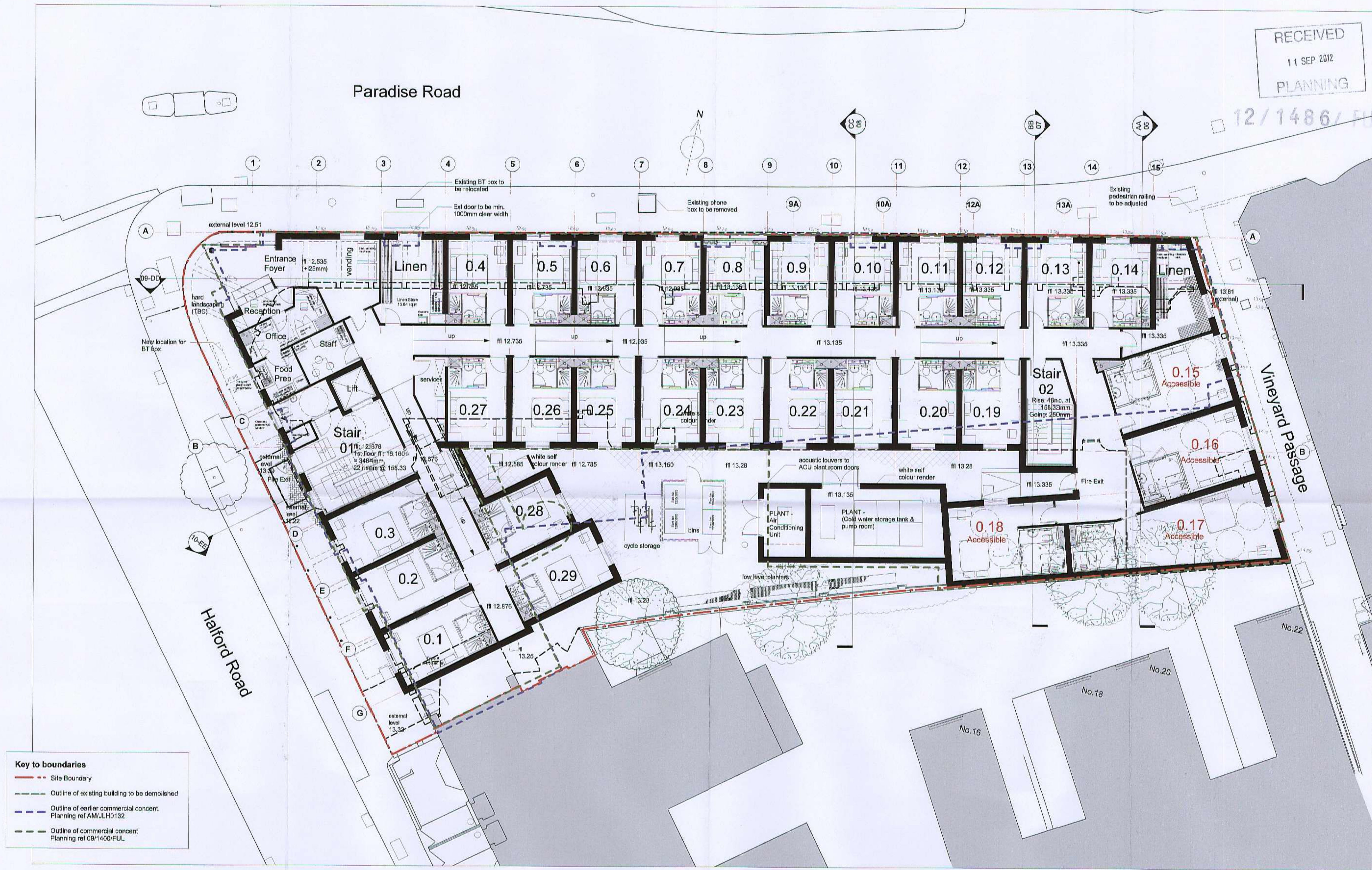

Key to boundaries

- - - Site Boundary
- - - Outline of existing building to be demolished
- - - Outline of earlier commercial concept, Planning ref AM/JLH0132
- - - Outline of commercial concept Planning ref 09/1400/FUL

Ground Floor Plan

Notes:
Do not scale dimensions from this drawing.
Dimensions marked with an asterisk (*) are open site dimensions to be confirmed on site.
All given dimensions are to be checked on site when setting out and any discrepancy reported immediately.

002 Hazard Notes

Please be aware of the following Hazards have been identified in relation to the works shown on this drawing

ID	Hazard	Action
1	Restricted access to site	Phase works to avoid peak periods of high traffic
2	Restrictions site area	Plan storage opt materials, avoid stacking of materials
3	Residential area	Take care to avoid disruption to neighbours
4	Rear garden wall	Garden wall to remain - protect and stabilize during works
5	Existing trees	protect trees and plants in neighbours gardens
6	Privacy	Be considerate to the privacy of teh neighbours gardens during the works.
9	narrow passages	Minimise access through Vineyard Passage

Rev	Date	Notes	By	Chkd
E	30/8/12	Window reveal depth increased	ods	pbp
D	11/6/12	Revised in line Planners comments	ods	pbp
C	9/6/12	GF outline of commercial concept amended	ods	pbp
B	4/5/12	Curian wall to lobby revised Section EE reference added	ods	pbp
A	17/4/12	Revised in line with TL comments	ods	pbp

Project:
9-19 Paradise Road, Richmond

Client:
Henry Boot Ltd

Drawing title:
Proposed New Hotel
Ground Floor Plan

Ref: -p03 Sheet:

Date: 19.03.2012 Scale: 1:100 @ A1

Drawn by: ods Checked by: pbp

Drawing no.: 0779-02-102 E Revisor:

bpr architects
The Boathouse, Embankment
Putney, London, SW15 1LB
t +44(0)20 8785 9983
f +44(0)20 8780 1507
e info@bprarchitects.com
www.bprarchitects.com