

TREES:-

- A - EXISTING TREES (3/4).
- C - BETULA PENDULA 'LACINIATA' (1).

SHRUBS:-

- 1 - MAHONIA x MEDIA 'CHARITY' (4)
- 2 - PIRACANTHA 'WATERCI' (2)
- 3 - VIBURNUM OPULUS 'ROSEUM' (3)
- 4 - HYDRANGEA PANICULATA 'GRANDIFLORA' (4)
- 5 - SARCOCOCCA CONFUSA (5)
- 6 - GALLTHERIA PUCRONATA 'SNOW WHITE' (5)
- 15 - DAPHNE ODORA 'AURUMMARGINATA' (6)
- 16 - LEYCESTERIA FORTIOSA (3)
- 17 - ROSA CANINA (7)

PERENNIAL & FERN:-

- 7 - DIGITALIS PURPUREA 'ALBAFLORITA' - SPACING .5m APPROX (20)
- 8 - IRIS FORTIDISSIMA - SPACING - SPACING .45m APPROX (6)
- 9 - HELLEBORUS ARGUTIFOLIUS - SPACING .5m APPROX (15)
- 10 - DRYOPTERIS FELIX - TIPS (3)

GROUND COVER:-

EXISTING HEDERA - TRANSPLANTED.

CLIMBERS:-

- 12 - HEDERA CANARIENSIS 'GLOIRE DE THAMBO' (2)
- 13 - HYDRANGEA PETIOLARIS (2)
- 14 - CLETARIS VITICELLA 'THADRE JULIA CORREYON' (2)
- 15 - ROSA 'CLIMBING ROSE BRUNNER' (2)

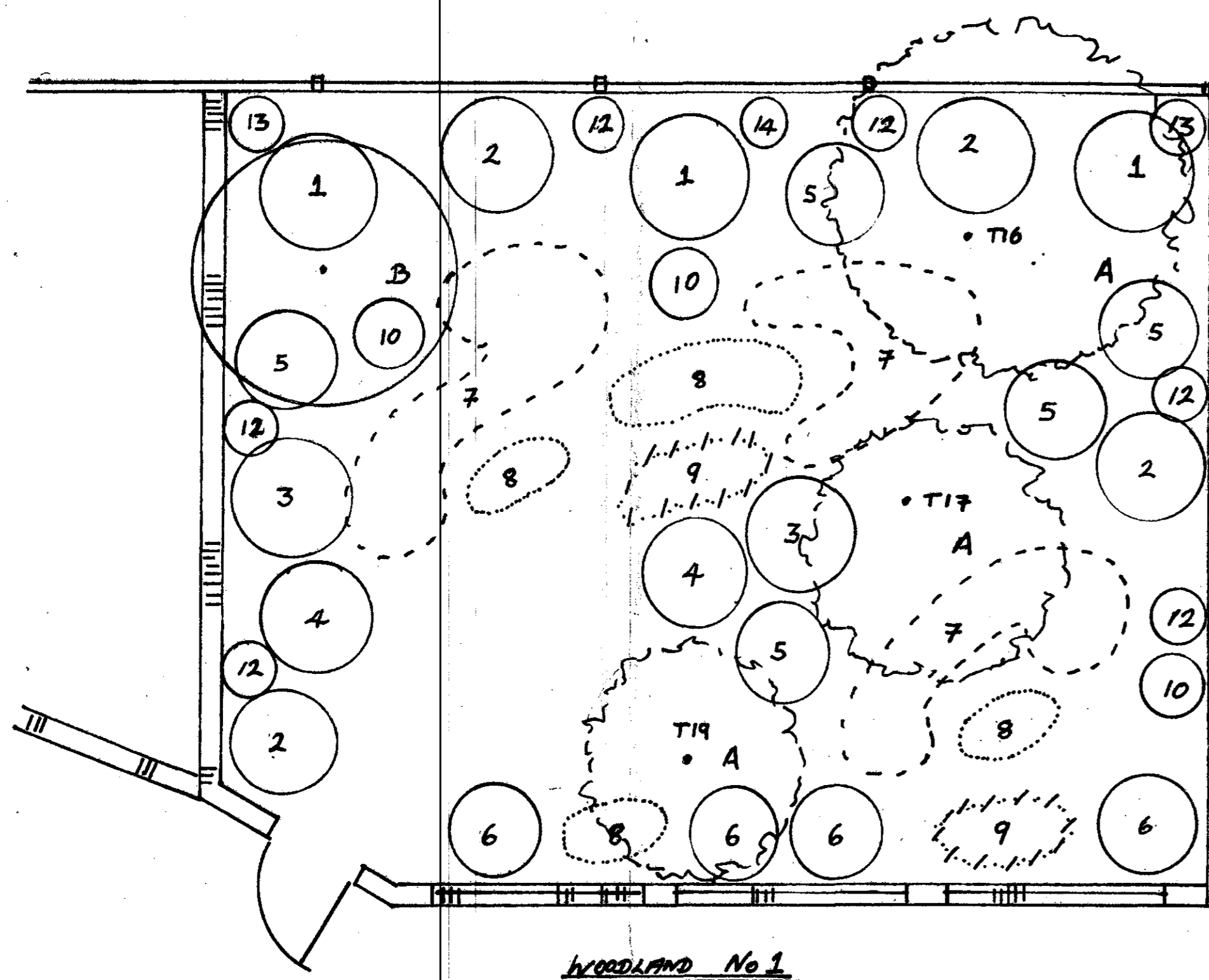

TREES:-

- A - EXISTING TREES (3)
- B - SALIX FRAGILIS (1)

SHRUBS:-

- 1 - MAHONIA x MEDIA 'CHARITY' (3)
- 2 - PIRACANTHA 'WATERCI' (4)
- 3 - VIBURNUM OPULUS (2) 'ROSEUM'
- 4 - HYDRANGEA PANICULATA 'GRANDIFLORA' (2)
- 5 - SARCOCOCCA CONFUSA (5)
- 6 - GALLTHERIA PUCRONATA 'SNOW WHITE' (4)

PERENNIAL + FERN:-

- 7 - DIGITALIS PURPUREA FLEBIFLORA (33)
- 8 - IRIS FORTIDISSIMA (18)
- 9 - HELLEBORUS ARGUTIFOLIUS (9)
- 10 - DRYOPTERIS FELIX - TIPS (3)

GROUND COVER

EXISTING HEDERA - TRANSPLANTED.

CLIMBERS:-

- 12 - HEDERA CANARIENSIS 'GLOIRE DE THAMBO' (6)
- 13 - HYDRANGEA PETIOLARIS (2)
- 14 - CLETARIS VITICELLA 'THADRE JULIA CORREYON' (1)

GROUND COVER:-

EXISTING HEDERA - TRANSPLANTED.

BULBS:-

- TO BOTH WOODLAND BORDERS 1 + 2.
- PLANTED IN SWATHES BETWEEN SHRUBS + PERENNIALS -
- NARCISSUS 'GERMINUM' - SPACING 10-15cm (300)
- NARCISSUS 'ORANGE' - SPACING 10-15cm (300)
- GALANTHUS NIVALIS 'POOPY GREEN TIP' - SPACING 10cm (200)
- GALANTHUS 'S.MANT' - SPACING 10cm - (200)
- HYACINTHUS NEPHELOPS 'ROBINSONIANA' - SPACING 10cm (500)

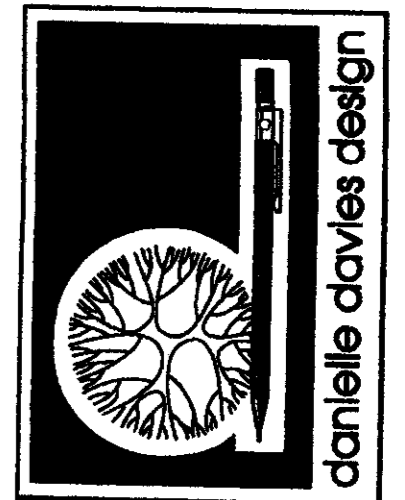

80 STATION ROAD
HAMPTON • MIDDLESEX
TW12 2AX

DW. No 004

Project - TWICKENHAM
RIVERSIDE
Client - RICHMOND BOROUGH
COUNCIL
Detail - WOODLAND BORDERS
No 1 + 2.
Scale - 1:50
Date - 8th October '03

OFFICE COPY North
DO NOT REMOVE FROM FILE
t: 020 8979 7878
f: 020 8979 8118
e: info@greenscheme.com
w: www.greenscheme.com

LONDON
RICHMOND UPON THAMES
09 SEP 2004
PLANNING

Do Not Scale From Plan