

0 5m

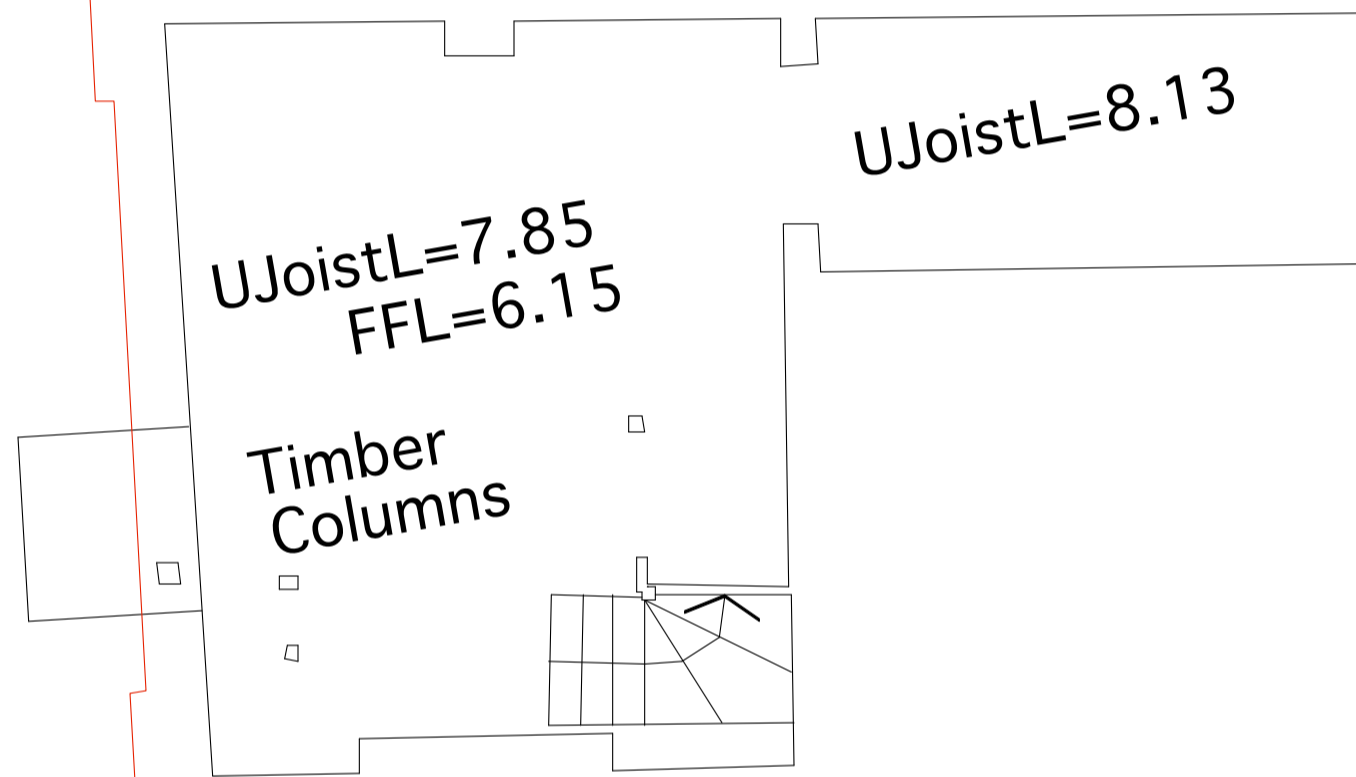

Rev.	Date	Description
--	12.02.14	Submitted for Planning Approval.

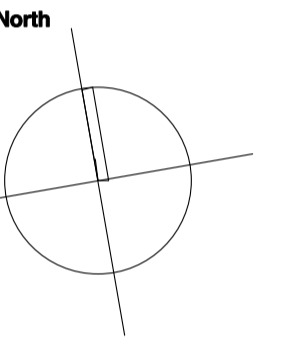

Notes:

Key:

Application Site

NISSEN RICHARDS studio

Unit 3 Waterhouse T 020 7670 8899
 8 Orsman Road info@nisserrichardstudio.com
 London N1 5QJ www.nisserrichardstudio.com

Project: 6-8 and 10 High Street, Hampton Wick, Kingston upon Thames, KT1 4DB
Client: Countrywide Design
Title: Existing Ground Floor Plan Existing Demolition Scheme
Scale: 1:50 at A1 1:100 at A3
Project no: A1372

Drawing no: A1372-PL-100