

Roof plan of sport storage unit

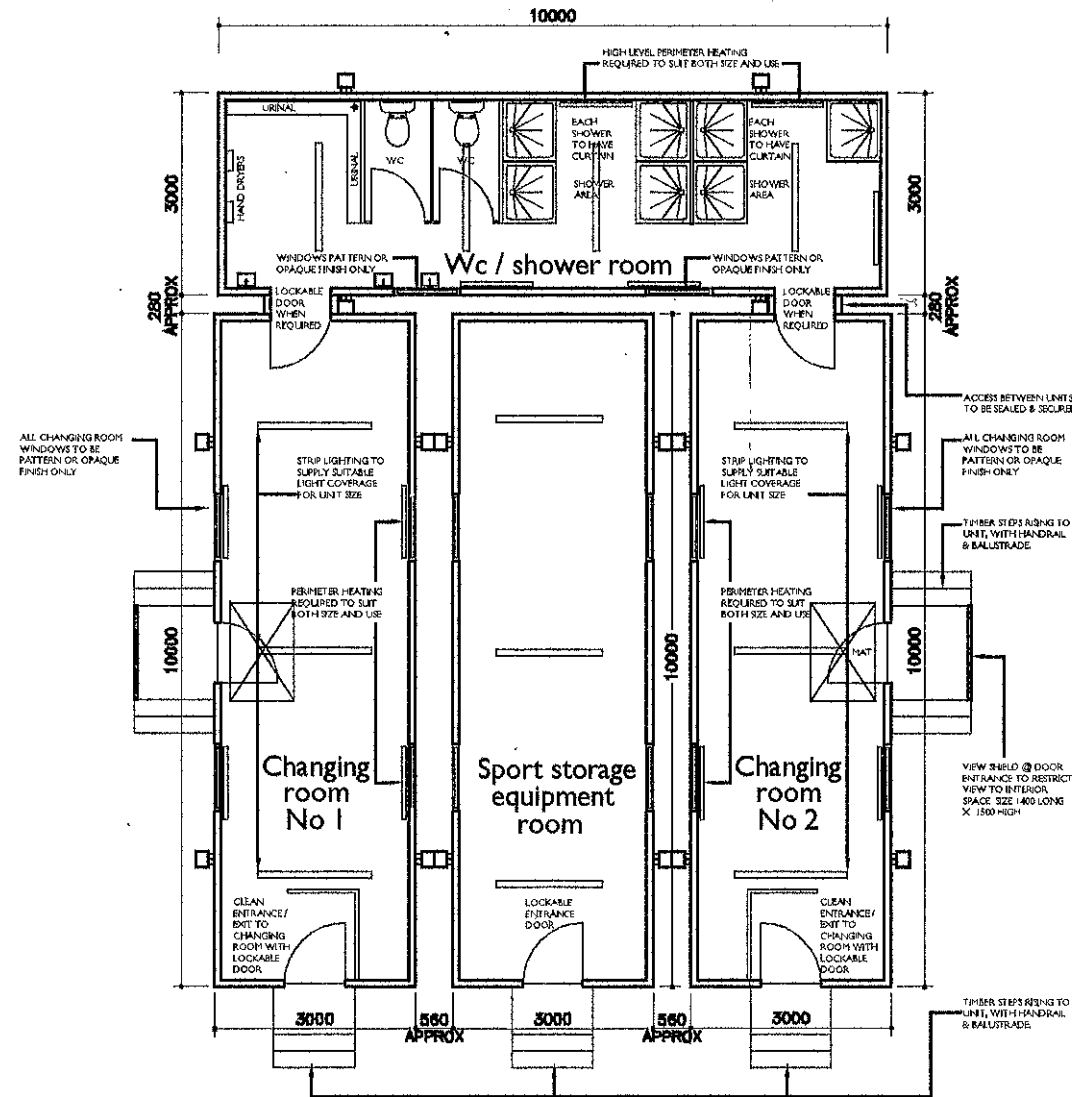

TEMPORARY CHANGING ROOMS AND STORE GROUND FLOOR PLAN

ASH DESIGN CONSULTANTS LTD
 Registered office: 195 Queen Victoria Road, London, EC4V 4DD
 Company registered in England and Wales No. 433888
 The rest of this drawing may be reproduced without consent
 All contractors must refer to the specification for taking and
 checking all measurements and dimensions.
 Do not scale from this drawing

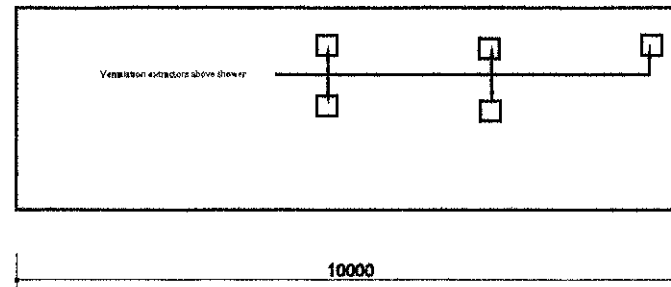

Rev	Date	By	Amendment



LEGEND

04/0293/ FUL

LONDON BOROUGH OF
 RICHMOND UPON THAMES
 02 FEB 2004
 PLANNING

TRIBAL
 Property Services
 A member of Tribal Group PLC

ASH DESIGN
 CHARTERED ARCHITECTS

LONDON
 RIVERSIDE OFFICES, BLOCK A, LITTLEBOOK BUSINESS PARK,
 DARTFORD, KENT DA1 5PZ
 Tel: 01322 027600 E-mail: ash@tribalps.co.uk
 Fax: 01322 280155 Website: www.TribalPS.co.uk

BRISTOL
 1 FORTLAND SQUARE,
 BRISTOL BS2 9RR
 Tel: 0117 311 5411
 Fax: 0117 311 5402

LEEDS
 TRIBAL HOUSE, HAWTHORN PARK,
 COM. ROAD LEEDS, LS14 1PO
 Tel: 0113 266 0200
 Fax: 0113 266 0202

Client
 St. MARY'S COLLEGE
 TWICKENHAM

Project
 TEMPORARY CHANGING ROOMS
 PORTA CABIN STRUCTURE

Drawing
 GROUND FLOOR PLAN

Date	Scale	Drawn by	Checked by
24/01/04	NTS	MH	

Project No	Drawing No	Revision
03788	P(0)2	