



- Legend**
- Application boundary
  - Existing trees to be retained
  - Proposed tree planting
  - Proposed specimen small tree / shrub planting
  - Evergreen hedge planting
  - Mixed shrub and herbaceous planting: species selected for shade and flooding tolerance where appropriate.
  - Proposed raised planters with mixed shrub planting
  - Amenity lawn
  - Areas of species rich grassland with wildflowers maintained as a meadow
  - Rear gardens
  - Informal natural play elements to include boulders and logs
  - Lighting
  - Timber and steel benches
  - Bollards
  - Cycle stands
  - Steps
  - Permeable textured paving to central piazza
  - Permeable block paving to shared surface areas
  - Bound gravel to paths with areas of soft landscape
  - Natural stone paving to riverside
  - Black asphalt to access ramps into undercroft carpark
  - Safe escape steel gantry walkway
  - Water

Allen Pyke Associates  
Landscape Architecture Urban Design Environmental Planning

Teddington Riverside



Client  
Haymarket

Drawing Number 2100-LA-02 Date 11/06/14 Revision P2  
Scale 1:250 @ A1 Drawn by / Chk TB/DA

### Illustrative Landscape Master Plan

The Factory, 2 Ace Road, Kingston upon Thames, Surrey KT2 4EF  
T 020 8549 3434 F 020 8547 1075 www.allenpyke.co.uk  
KINGSTON UPON THAMES • CAMBRIDGE

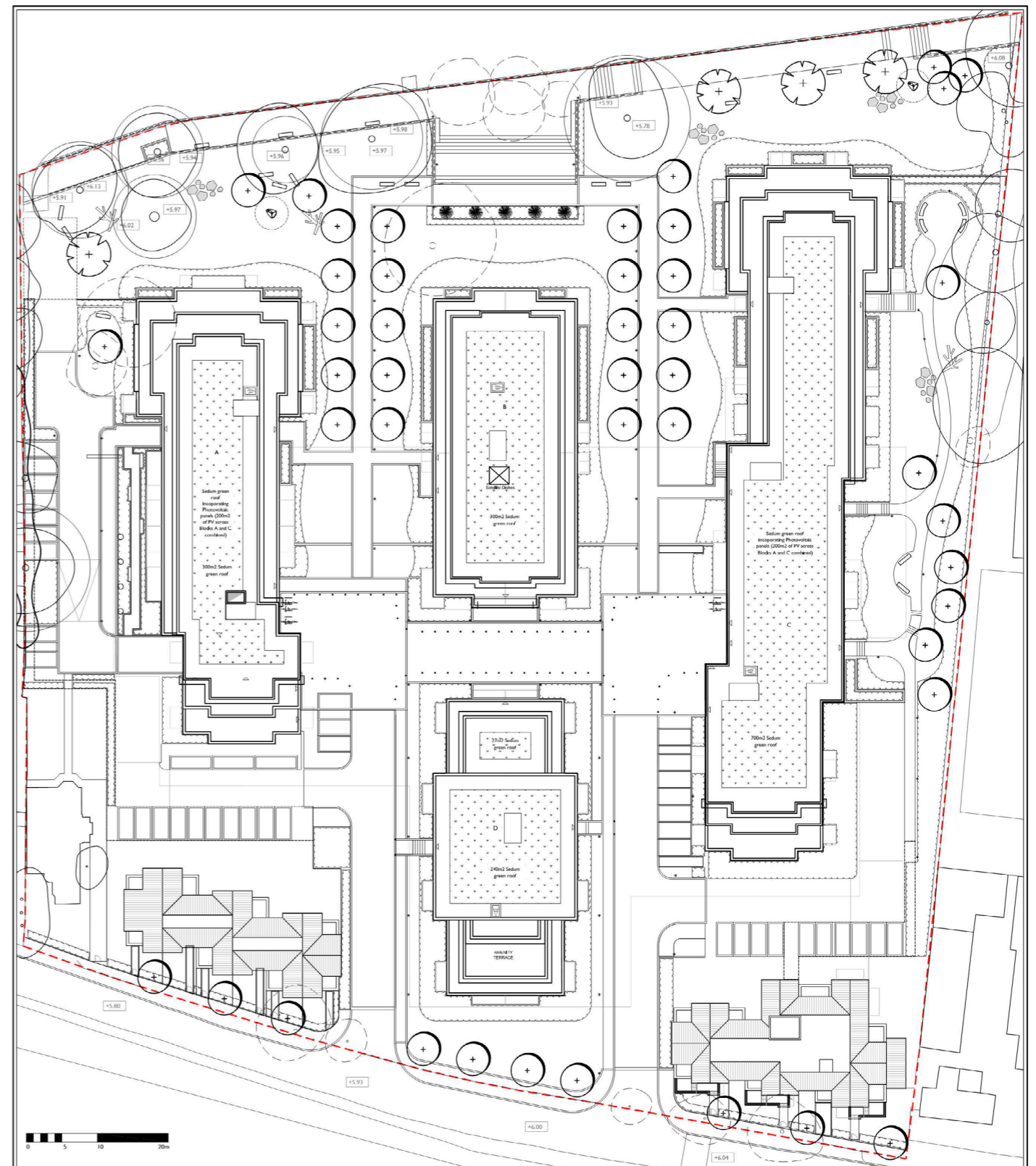

APPLY THE REFERENCE 2459-LA-07  
Notes  
This drawing is subject to copyright. Do not scale from this drawing.  
Based on drawing by TP Bennett Drawing number A999100107

- LEGEND**
- Application Boundary
  - Sedum green Roof by Zenco or similar approved.

Drawn by	TB/DA	Scale	1:250 @ A1
Checked by	TB/DA	Project	GREEN ROOF AND PV PLAN
Date	05/06/14	Drawing Number	2459-LA-07

**Allen Pyke Associates**  
Landscape Architecture Urban Design Environmental Planning  
The Factory, 2 Ace Road, Kingston upon Thames, Surrey KT2 4EF  
T 020 8549 3434 F 020 8547 1075 www.allenpyke.co.uk  
KINGSTON UPON THAMES • CAMBRIDGE