

NOTES:
 DO NOT SCALE. FIGURED DIMENSIONS ONLY TO BE TAKEN FROM THIS DRAWING. CHECK DIMENSIONS ON SITE AND REPORT DISCREPANCIES TO THE ARCHITECT.
 THIS DRAWING IS PROTECTED BY COPYRIGHT.
 ALL AREAS HAVE BEEN MEASURED FROM CURRENT DRAWINGS. THEY MAY VARY BECAUSE OF (EG) SURVEY, DESIGN DEVELOPMENT, CONSTRUCTION TOLERANCES, STATUTORY REQUIREMENTS OR RE-DEFINITION OF THE AREAS TO BE MEASURED.

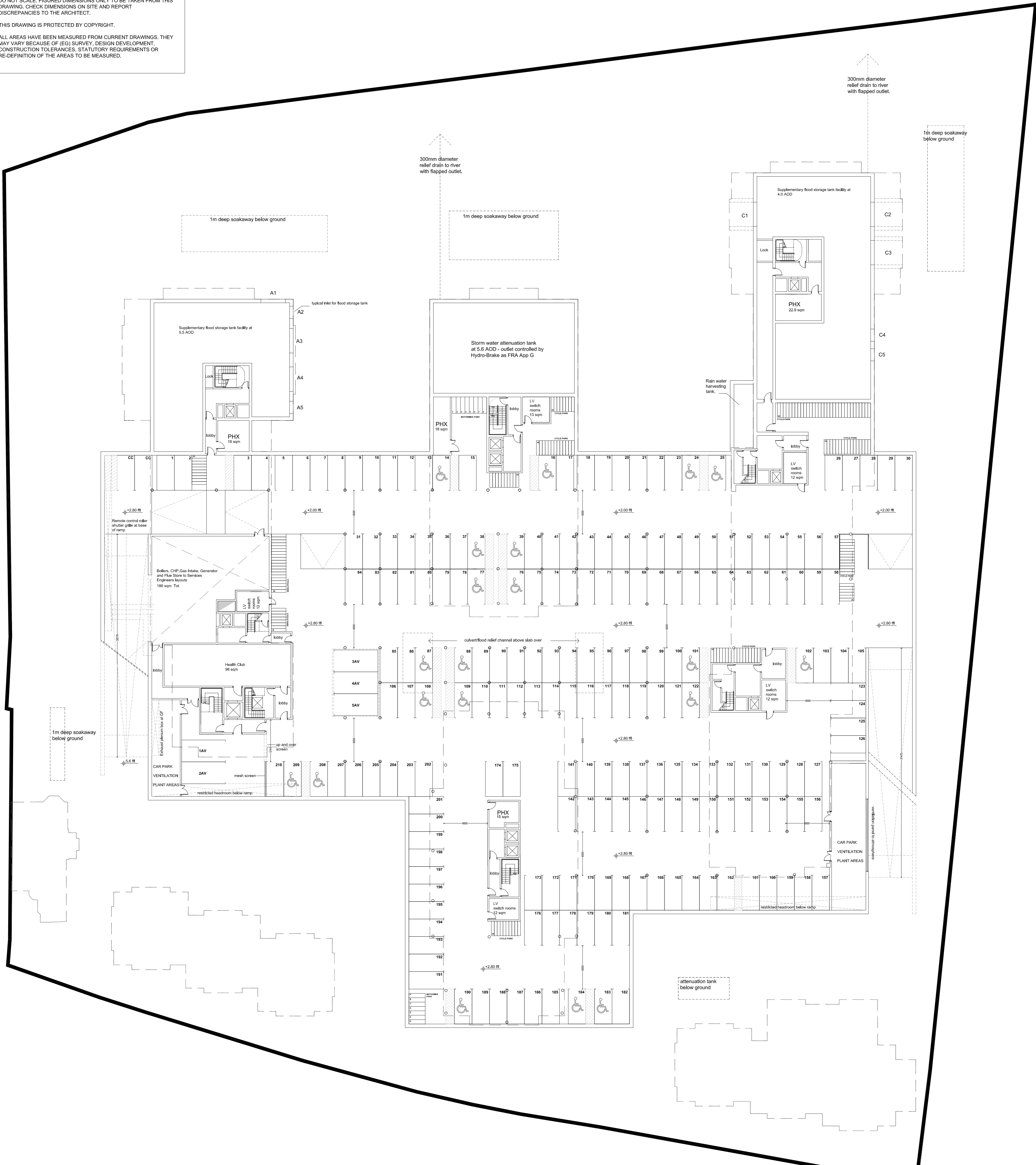

No.	Date	Comment	Drawn	Chk'd
P5	24.09.14	Amphibious vehicle compound shown	SG	JW
P4	07.08.14	Inlets to supplementary flood storage tank facility revised and culvert/flood relief channels redesigned and relocated. Relief drains added	MA	JW
P3	03.07.14	South outlet to culvert repositioned to suit stepped access to apartment over	MA/SG	JW
P2	12.06.14	Sundry flood details incorporated	SG	JW
P1	13.12.13	ISSUED AS PLANNING APPLICATION	SM/MA	JW

Revisions

ISSUE STATUS

PLANNING

tp bennett
 architecture
 interiors
 planning

One America Street London SE1 0NE UK +44 (0) 20 7206 2000 www.tpbennett.com
 London Moscow Abu Dhabi New York

Project
**Teddington Riverside
 Proposed Residential Redevelopment
 Broom Road, Teddington**

Drawing Title
Proposed Basement Plan

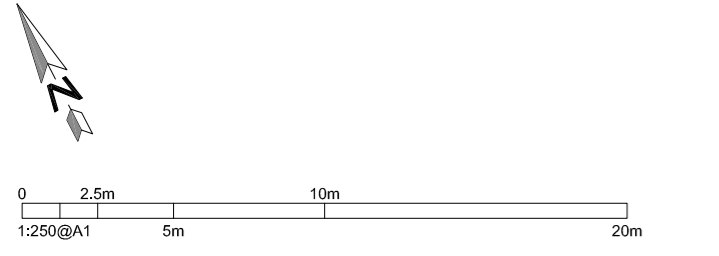

Drawn	Date	Scale @ A1	Alt. Ref.
SM	11.11.2013	1:250	--

tp bennett Project No.	Drawing Number	Rev
A9991	D 0099	P5