

**PROPOSED & EXISTING FLOOR PLAN -  
EXISTING CLASS USE PLAN OF HIGH STREET** (SHEET: PROP/PLANS/USE/01)  
75 Teddington High Street, London TW11 8HG

Date: September 2014

Planning4Property.com



EXISTING FRONT VIEW OF 75 TEDDINGTON HIGH STREET

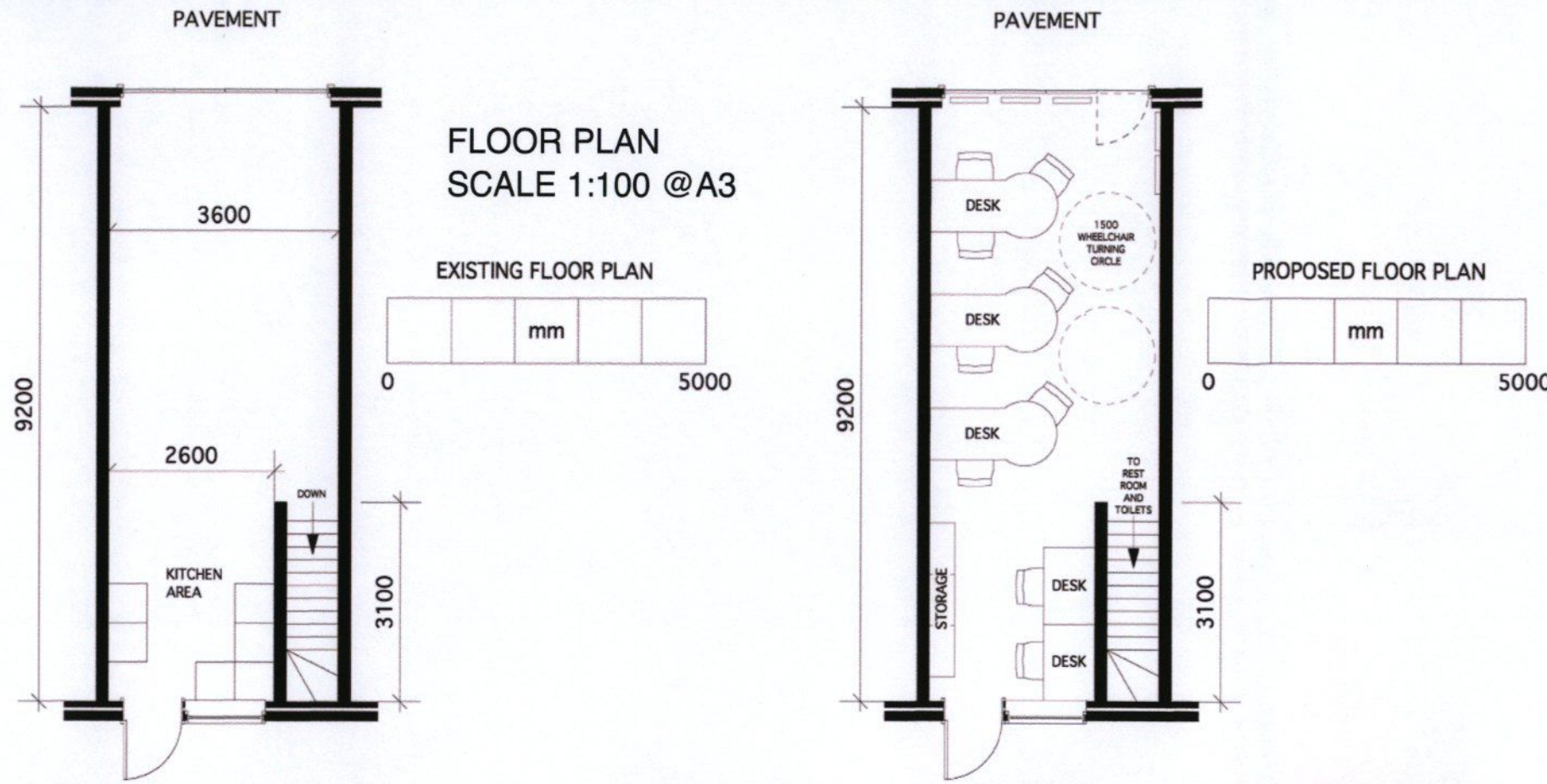

- A1
  - A2
  - A3/A5
  - A4
  - B1
  - C3
  - D1
  - OTHERS
- EXISTING CLASS USE ALONG TEDDINGTON HIGH STREET

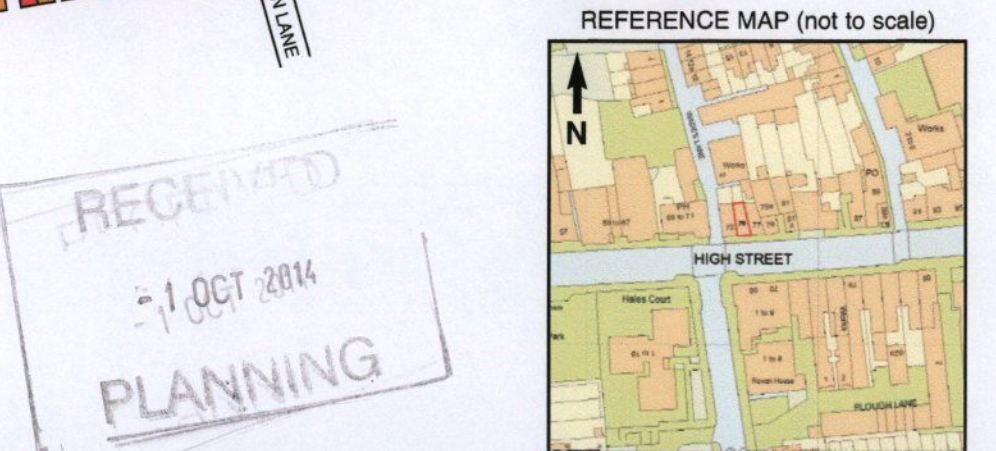

RECEIVED  
1 OCT 2014  
PLANNING