

Do not scale from this drawing. Contractors shall be responsible for the checking of all stated dimensions, with any anomalies being identified to the originator prior to any construction or fabrication works commencing.

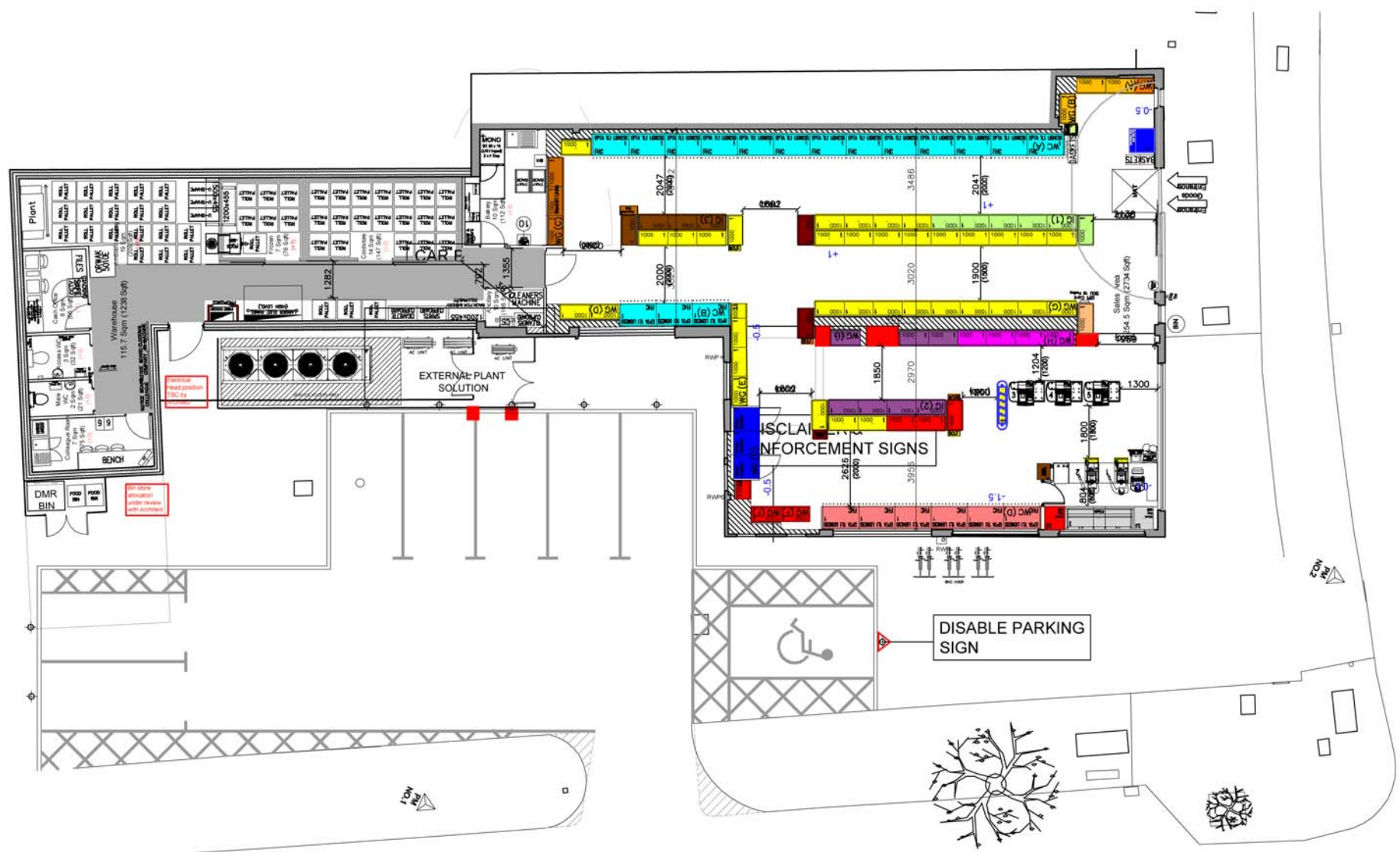

01 PROPOSED SITE PLAN
P 24 52215 1:100

Although we take every care to protect your car and belongings, we cannot accept any responsibility for damage or theft from your vehicle in this car park

Maximum stay 30 minutes
This is a customer car park with 30 minutes free parking for Sainsbury's customers. We are making checks on the length of time vehicles are parked within parking bays.
This car park is controlled. Please observe the following conditions for access to parking of your vehicle:
• Parking limited to 30 minutes
• Park within marked bays
• Blue Badge holders only within marked bays. Please observe the blue badge sign. Blue badge signs are not to be displayed in any other location.
Horizon Parking
Working in partnership with Sainsbury's

Contractor to confirm correct supplier of parking enforcement message

02 PROPOSED DISCLAIMER/ ENFORCEMENT SIGN
P2452 215 1:20

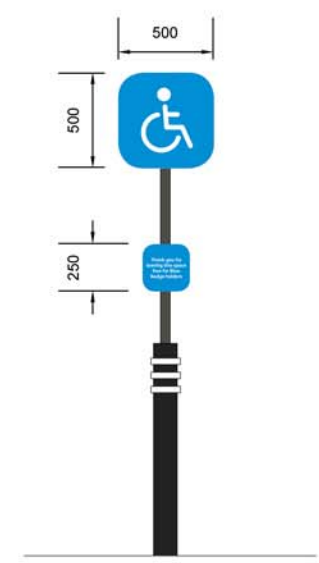

03 PROPOSED CAR PARKING SIGNS
P2452 215 1:20

Rev.	Date	Description
B	09-12-14	General Amendments.
A	15-03-13	Car parking layout amended.
--	19-12-12	First issue
<p>architects project managers cost consultants The Leathermarket Unit 13.1.1 Weston Street Barnesley London SE1 3ER tel: 020 7440 9540</p> <p>jla</p>		
Status PLANNING		
Project Title 196 HIGH STREET, TEDDINGTON, TW11 8HU. SITE REF. 2452		
Drawing Title SIGNAGE APPLICATION CAR PARK SIGNAGE		
Project Number S-2452	Drawing Number P-2452-215	Revision B
Drawn VA	Checked --	Scale 1:100@A1 1:200@A3
		Date 19-12-12
The content of this drawing is the property of JLA Chartered Architect and may not be copied in whole or part without formal consent.		