



Photo 7: Teaching and event room up in roof space

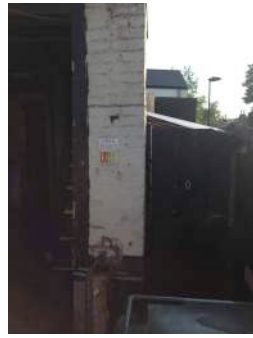

Photo 8: Outside store, with edge of steep ladder up to event room on left



Photo 9: Metal stair up to tack room

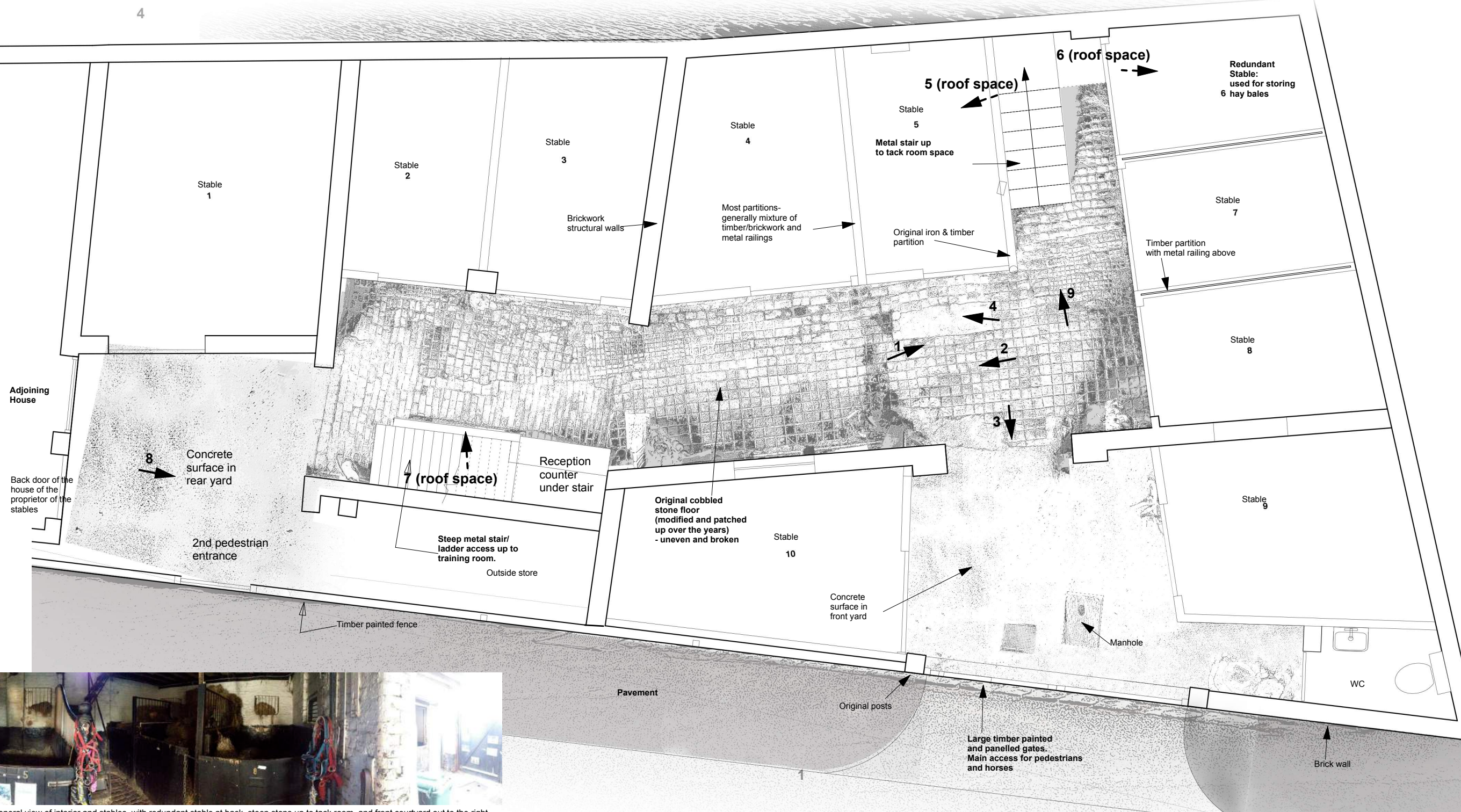

Photo 1: General view of interior and stables, with redundant stable at back, steep steps up to tack room, and front courtyard out to the right



Photo 2: General view of interior and stables, with racks on left for riding hats and bridles, and reception counter beyond



Photo 3: Front courtyard and entrance



Photo 4: Temporary structure to provide support to deteriorating roof structure



Photo 5: Tack room and store up in roof space



Photo 6: Tack room up in roof space

Drawing to be read in conjunction with all relevant information from Architects, Structural Engineers and Consultants.

Do not scale from this drawing. All dimensions to be checked on site before commencement of works. Discrepancies, where identified, must be reported to the Architect immediately.

This drawing is the property of Astronaut Kawada Architecture and must not be reproduced by or disclosed to any unauthorised person or organisation, neither wholly or in part, without written consent.

General Notes:

P1 14.04.2015 Issued for planning

Rev: Date: By: Description:

Project Title: **Park Lane Stables**

Drawing Title: **Existing internal photos & Existing Plan**

Scale: **1:50 @ A3** Date: **08.12.2014** Drawn By:

Project No: **0082** Drawing No: **004** Revision: **P1**

Astronaut Kawada Architecture

4 Ivory Wharf, 4 Elephant Lane, London SE16 4JD, UK
T: +44 (0)20 7231 2345 E: mail-uk@astronautkawada.com

London
Dean Griffiths

www.astronautkawada.com

Tokyo
Takashi Kawada