

- KEY TO DRAWING**
- APPLICATION SITE BOUNDARY
 - RESIDENTIAL DEVELOPMENT ZONE
 - EXISTING BUILDINGS
 - BUILDING ZONES
 - BUILDING ZONES - PODIUM AREA

NORTHING AND EASTING COORDINATES ARE INDICATED WITH REFERENCE TO THE ORDINANCE SURVEY NATIONAL GRID.

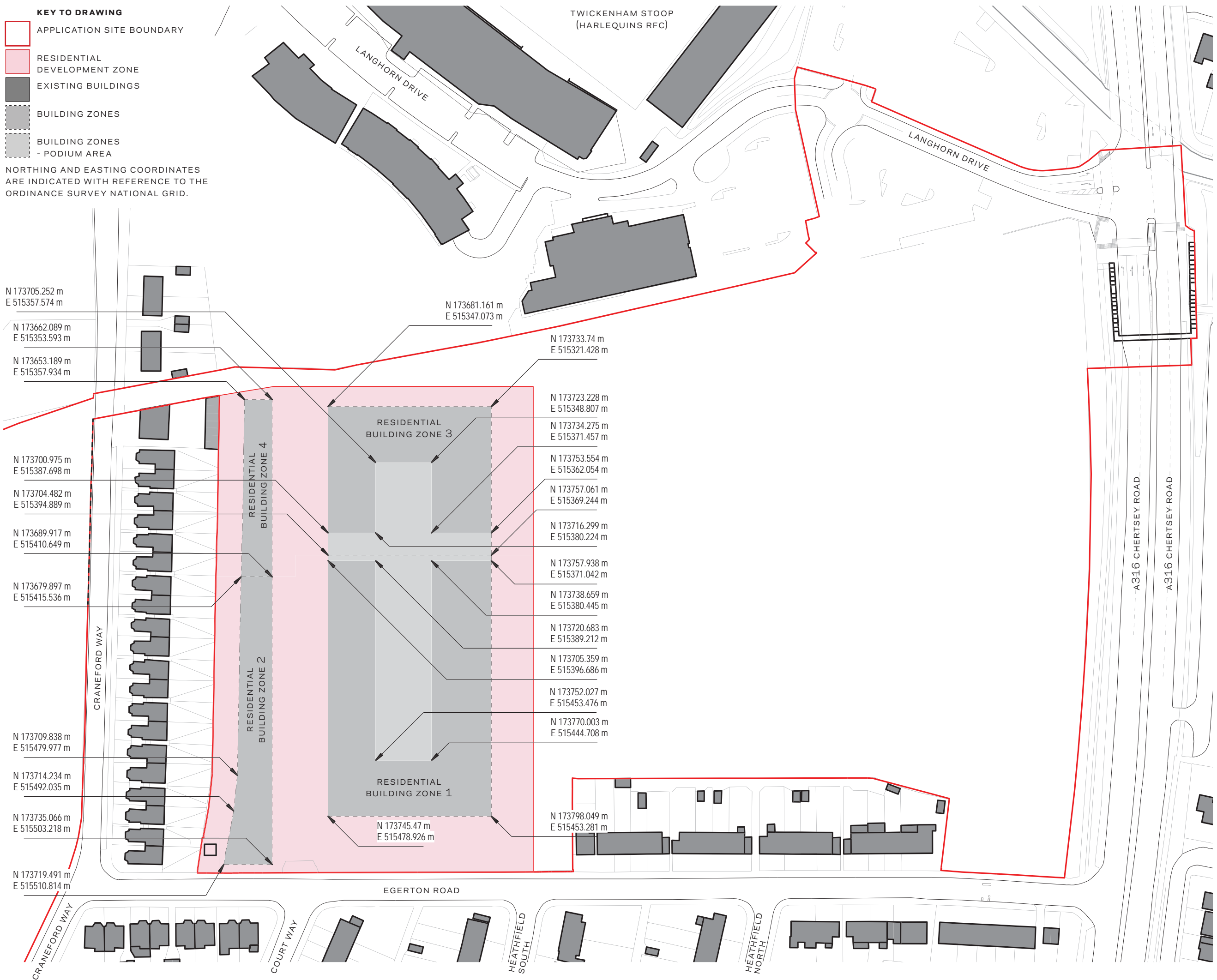

Project
REEC Richmond Education & Enterprise Campus

Prepared for
Richmond-upon-Thames College

Client Location
 Richmond upon Thames College | Egerton Road | Twickenham | Middlesex | TW2 7SJ



HOK
 Qube, 90 Whitfield Street
 London, W1T 4EZ, UK
 t +44 (0) 20 7636 2006
 f +44 (0) 20 7636 1987

All reproduction & intellectual property rights reserved © 2014

- In Association with
- FUSION PM**
 Project Management
 9 Springfield Lyons Approach, Chelmsford, Essex, CM2 5LB
 - VALIDUS LM**
 Project Management
 90 Long Acre, Covent Garden, London WC2E 9RZ
 - CASCADE CONSULTING**
 Environmental Consultants
 The Courtyard, Ladycross Business Park, Hollow Lane, Dormansland, Surrey RH17 6PB
 - CGMS CONSULTING**
 Planning Consultants
 140 London Wall, London EC2 5DN



This drawing incorporates Ordnance Survey Information © Crown copyright and database rights 2014 Ordnance Survey 100019441

Do not scale dimensions from drawings

No.	Description	Date
-	OPA SUBMISSION	2015.06.15

Drawn by: **æ** Reviewed by: **AA**
 Scale: **1:1250 @ A3**
 Project No: **12.33036**

Sheet Title:
**Residential Development Zone
 Building Zones Parameter Plan 1**

Original drawing is A3. Do not scale this drawing.
 Sheet Number:
PL-13