

SCHEDULE OF ACCOMMODATION

UNIT	TYPE	HR	GROSS INT SQFT	GROSS INT SQM
CAR SHOWROOM AND WORKSHOP UNIT		0	[4004]	372
TOTAL		0	[4004]	372

PRIVATE HOUSING

2 No	TYPE 1 HOUSE 3B5P	6	[1334]	124
2 No	TYPE 2 HOUSE 3B5P	6	[1442]	134
2 No	TYPE 3 HOUSE 3B5P	6	[1356]	126
2 No	FLAT 2B4P	3	[618]	76
TOTAL		42	[9902]	920
TOTAL COMMERCIAL AND PRIVATE HOUSING		42	[13906]	1292

NO. COMMERCIAL UNITS TOTAL - 1
NO. RESIDENTIAL UNITS TOTAL - 8

TOTAL NUMBER OF HABITABLE ROOMS - 42	
SITE AREA	0.26 HA
PARKING RESIDENTIAL	11 (3 DISABLED)
RETAIL	14 (2 DISABLED)
TOTAL	25

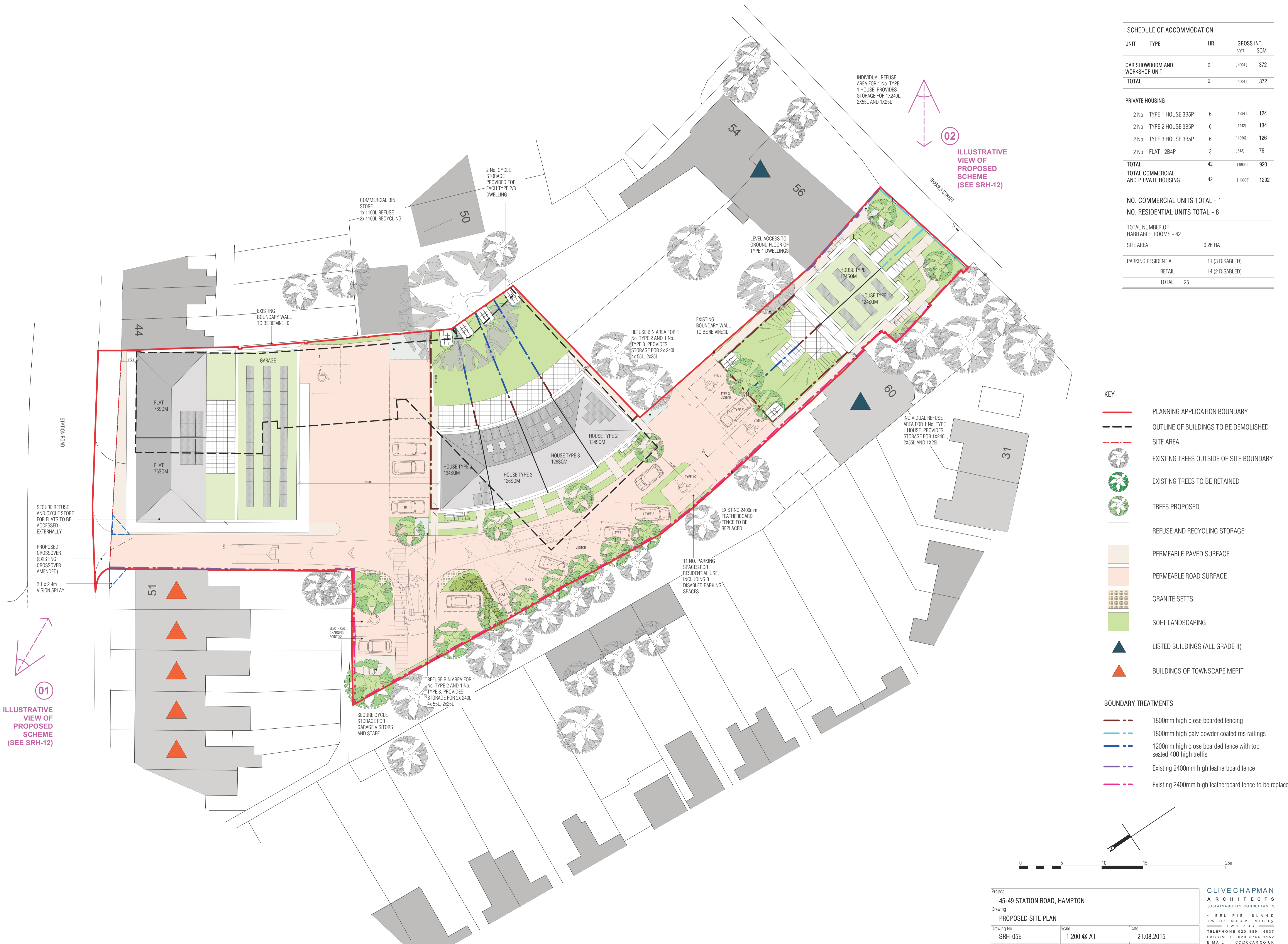

02
ILLUSTRATIVE VIEW OF PROPOSED SCHEME (SEE SRH-12)

01
ILLUSTRATIVE VIEW OF PROPOSED SCHEME (SEE SRH-12)

- KEY**
- PLANNING APPLICATION BOUNDARY
 - - - OUTLINE OF BUILDINGS TO BE DEMOLISHED
 - - - SITE AREA
 - EXISTING TREES OUTSIDE OF SITE BOUNDARY
 - EXISTING TREES TO BE RETAINED
 - TREES PROPOSED
 - REFUSE AND RECYCLING STORAGE
 - PERMEABLE PAVED SURFACE
 - PERMEABLE ROAD SURFACE
 - GRANITE SETTS
 - SOFT LANDSCAPING
 - LISTED BUILDINGS (ALL GRADE II)
 - BUILDINGS OF TOWNSCAPE MERIT
- BOUNDARY TREATMENTS**
- - - 1800mm high close boarded fencing
 - - - 1800mm high galv powder coated ms railings
 - - - 1200mm high close boarded fence with top seated 400 high trellis
 - - - Existing 2400mm high featherboard fence
 - - - Existing 2400mm high featherboard fence to be replaced

