

**KEY TO DRAWING**

- APPLICATION SITE BOUNDARY
- SCHOOLS DEVELOPMENT ZONE
- EXISTING BUILDINGS
- BUILDING ZONES

NORTHING AND EASTING COORDINATES ARE INDICATED WITH REFERENCE TO THE ORDINANCE SURVEY NATIONAL GRID.

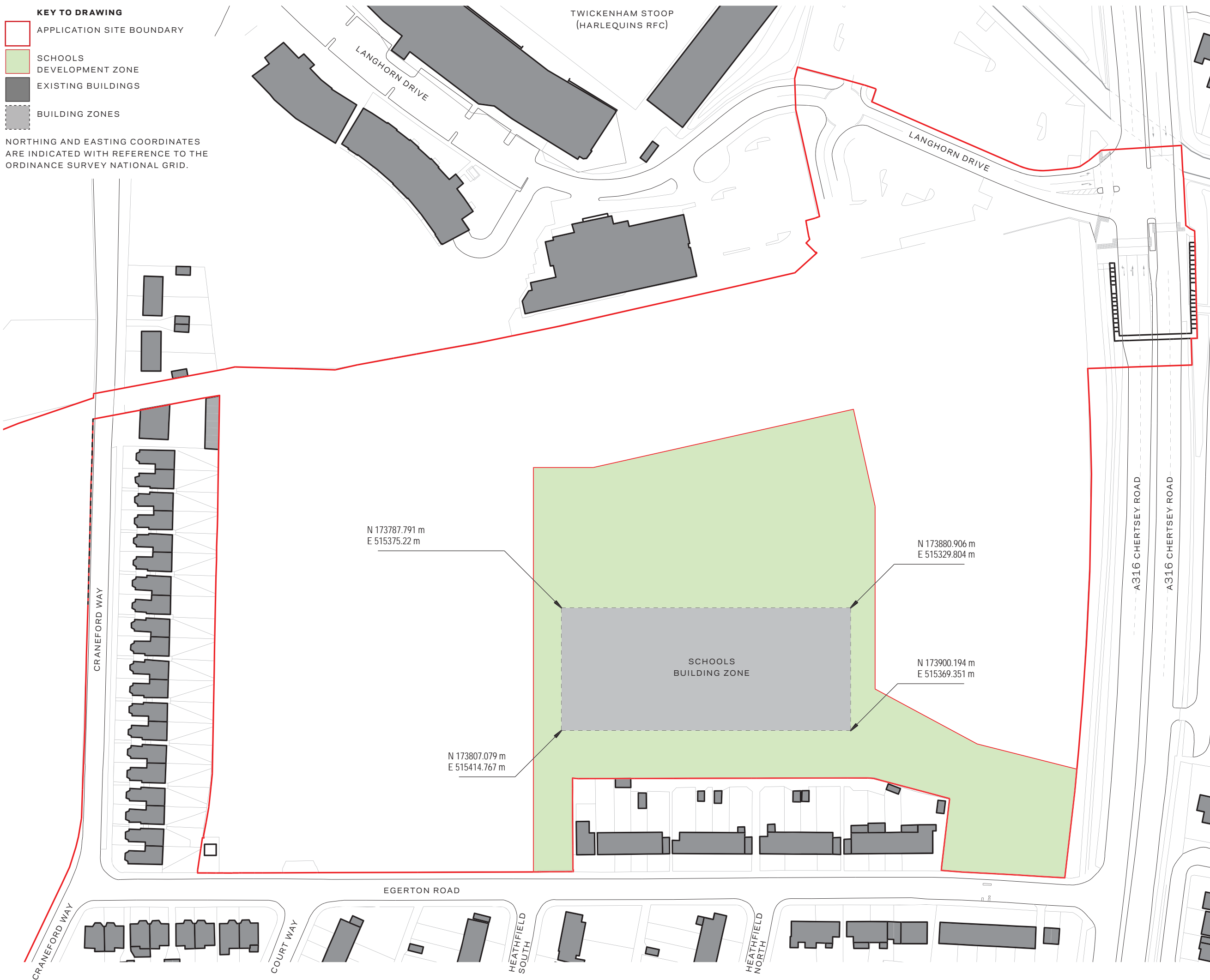

N 173787.791 m  
E 515375.22 m

N 173880.906 m  
E 515329.804 m

N 173900.194 m  
E 515369.351 m

N 173807.079 m  
E 515414.767 m

SCHOOLS BUILDING ZONE

Project  
**REEC Richmond Education & Enterprise Campus**  
 Prepared for  
**Richmond-upon-Thames College**  
 Client Location  
 Richmond upon Thames College | Egerton Road | Twickenham | Middlesex | TW2 7SJ



**HOK**  
 Qube, 90 Whitfield Street  
 London, W1T 4EZ, UK  
 t +44 (0) 20 7636 2006  
 f +44 (0) 20 7636 1987

All reproduction & intellectual property rights reserved © 2015

- In Association with
- FUSION PM**  
Project Management  
9 Springfield Lyons Approach, Chelmsford, Essex, CM2 5LB
  - VALIDUS LM**  
Project Management  
90 Long Acre, Covent Garden, London WC2E 9RZ
  - CASCADE CONSULTING**  
Environmental Consultants  
The Courtyard, Ladycross Business Park, Hollow Lane, Dormansland, Surrey RH17 6PB
  - CGMS CONSULTING**  
Planning Consultants  
140 London Wall, London EC2 5DN



This drawing incorporates Ordnance Survey Information © Crown copyright and database rights 2014 Ordnance Survey 100019441

Do not scale dimensions from drawings

No.	Description	Date
-	OPA SUBMISSION	2015.06.15
A	OPA REVISION	2015.11.17

Drawn by: **æ** Reviewed by: **AA**  
 Scale: **1:1250 @ A3**  
 Project No: **12.33036**

Sheet Title:  
**Schools Development Zone**  
**Building Zone Parameter Plan 1**

Original drawing is A3. Do not scale this drawing.  
 Sheet Number:  
**PL-11** **A**