

**KEY TO DRAWING**

- APPLICATION SITE BOUNDARY
- RESIDENTIAL DEVELOPMENT ZONE
- EXISTING BUILDINGS
- BUILDING ZONES
- BUILDING ZONES - PODIUM AREA

NORTHING AND EASTING COORDINATES ARE INDICATED WITH REFERENCE TO THE ORDINANCE SURVEY NATIONAL GRID.

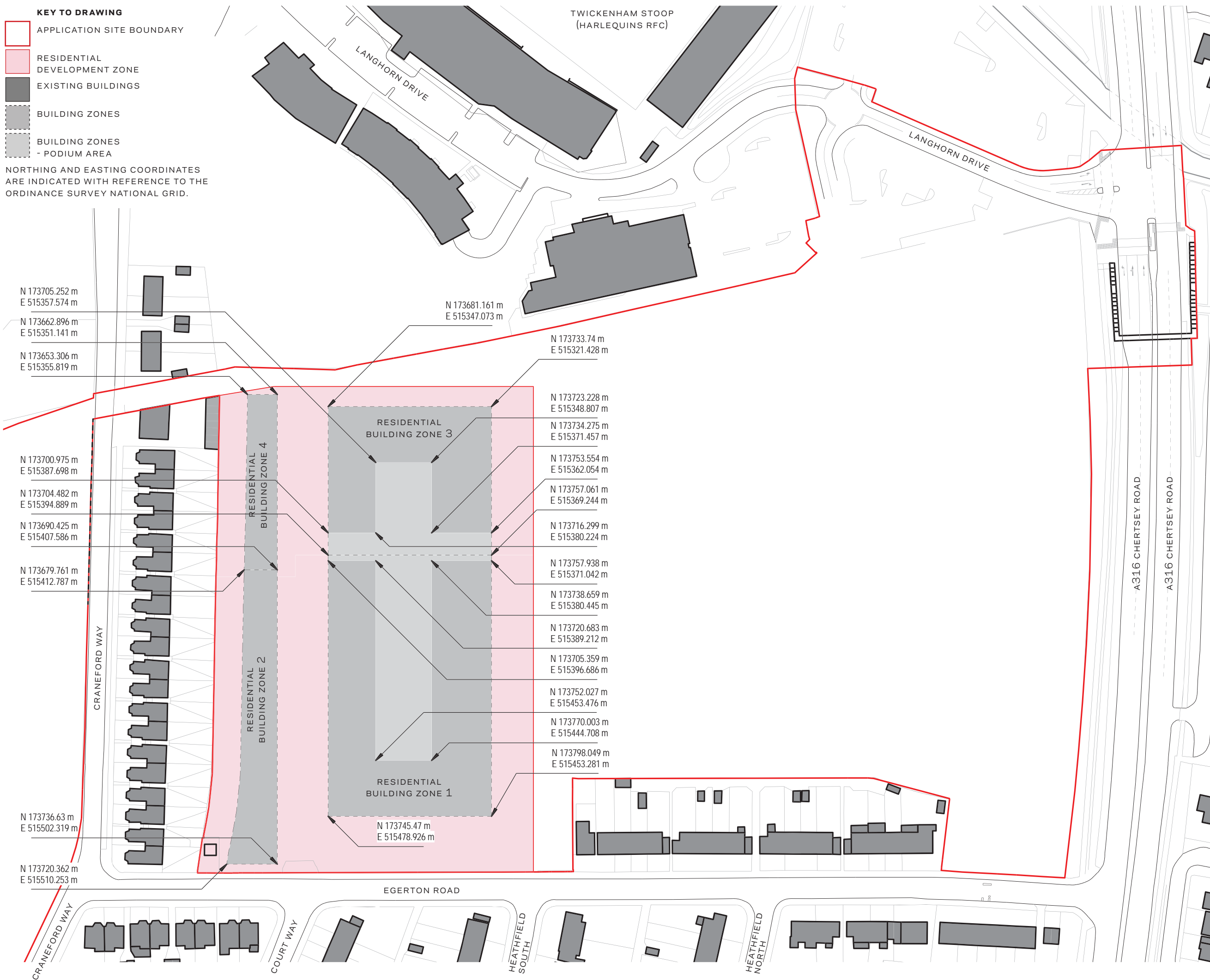

Project  
**REEC Richmond Education & Enterprise Campus**

Prepared for  
**Richmond-upon-Thames College**

Client Location  
 Richmond upon Thames College | Egerton Road | Twickenham | Middlesex | TW2 7SJ



**HOK**  
 Qube, 90 Whitfield Street  
 London, W1T 4EZ, UK  
 t +44 (0) 20 7636 2006  
 f +44 (0) 20 7636 1987

All reproduction & intellectual property rights reserved © 2015

- In Association with
- FUSION PM**  
 Project Management  
 9 Springfield Lyons Approach, Chelmsford, Essex, CM2 5LB
  - VALIDUS LM**  
 Project Management  
 90 Long Acre, Covent Garden, London WC2E 9RZ
  - CASCADE CONSULTING**  
 Environmental Consultants  
 The Courtyard, Ladycross Business Park, Hollow Lane, Dormansland, Surrey RH17 6PB
  - CGMS CONSULTING**  
 Planning Consultants  
 140 London Wall, London EC2 5DN

This drawing incorporates Ordnance Survey Information © Crown copyright and database rights 2014 Ordnance Survey 100019441

Do not scale dimensions from drawings

No.	Description	Date
-	OPA SUBMISSION	2015.06.15
A	OPA REVISION	2015.11.17

Drawn by: **æ** Reviewed by: **AA**  
 Scale: **1:1250 @ A3**  
 Project No: **12.33036**

Sheet Title:  
**Residential Development Zone  
 Building Zones Parameter Plan 1**

Original drawing is A3. Do not scale this drawing.  
 Sheet Number:  
**PL-13** **A**