

GENERAL NOTES
 All rights reserved.
 All drawings and written material appearing here, constitute original and unpublished work of the Architect and may not be duplicated, used or disclosed without written consent of the Architect.
 Notes and material designations are typical for similar conditions unless otherwise indicated.
 Do not scale from this drawing.

Drawing based on available information, dimensions not from a measured survey.

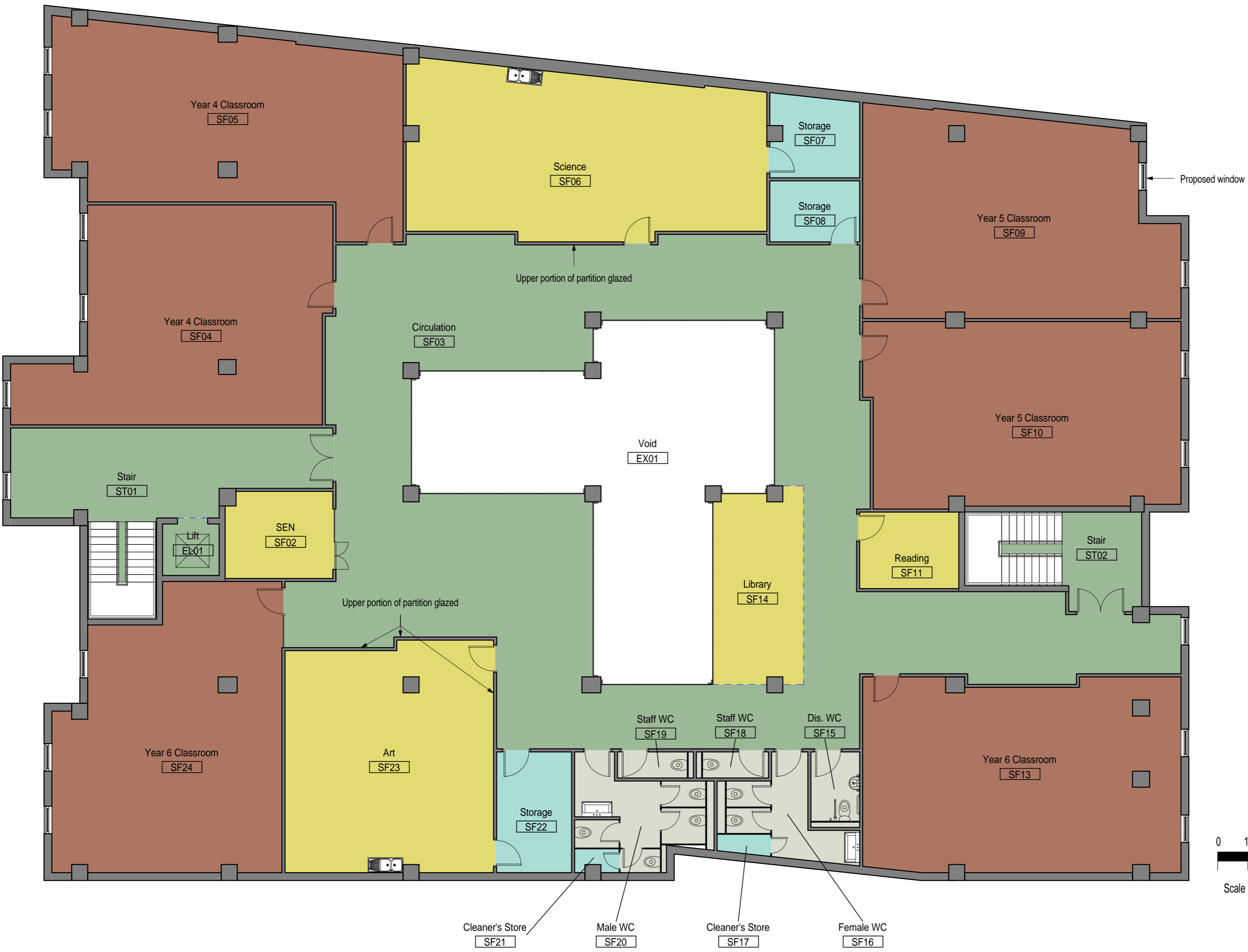

Department Legend

- Basic Teaching Space
- Circulation
- Learning Resource
- Storage
- WC

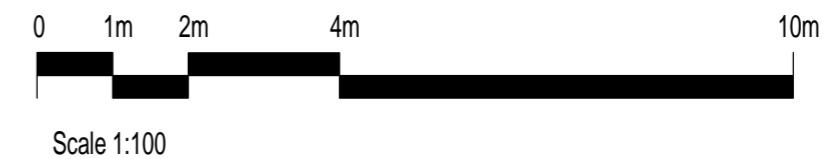

REV NO.	DATE	DESCRIPTION
1	11/01/16	Amendments as requested

KEY PLAN

PROJECT
GEMS Twickenham

CLIENT

Room Schedule - 03_Second Floor

Number	Name	Department	Area
EL01	Lift	Circulation	3 m ²
SF02	SEN	Learning Resource	10 m ²
SF03	Circulation	Circulation	201 m ²
SF04	Year 4 Classroom	Basic Teaching Space	63 m ²
SF05	Year 4 Classroom	Basic Teaching Space	65 m ²
SF06	Science	Learning Resource	63 m ²
SF07	Storage	Storage	8 m ²
SF08	Storage	Storage	6 m ²
SF09	Year 5 Classroom	Basic Teaching Space	65 m ²

Room Schedule - 03_Second Floor

Number	Name	Department	Area
SF10	Year 5 Classroom	Basic Teaching Space	63 m ²
SF11	Reading	Learning Resource	8 m ²
SF13	Year 6 Classroom	Basic Teaching Space	66 m ²
SF14	Library	Learning Resource	19 m ²
SF15	Dis. WC	WC	4 m ²
SF16	Female WC	WC	9 m ²
SF17	Cleaner's Store	Storage	1 m ²
SF18	Staff WC	WC	2 m ²
SF19	Staff WC	WC	2 m ²

Room Schedule - 03_Second Floor

Number	Name	Department	Area
SF20	Male WC	WC	12 m ²
SF21	Cleaner's Store	Storage	1 m ²
SF22	Storage	Storage	10 m ²
SF23	Art	Learning Resource	51 m ²
SF24	Year 6 Classroom	Basic Teaching Space	64 m ²
ST01	Stair	Circulation	36 m ²
ST02	Stair	Circulation	16 m ²
			849 m ²

RTKL
 AN ARCADIS COMPANY
 RTKL
 25 Farringdon Street, 10th Floor
 London EC4A 4AB
 T: +44(0)20 7306 0404

SHEET IDENTIFICATION
Second Floor Area Plan

STATUS
WIP

PROJECT NUMBER	DATE DRAWN	SCALE @ A2	SCALE @ A3	DRAWN BY	CHECKED BY	REVISION
	11/09/15	1:100	1:100	LA	AR	

DRAWING NUMBER
A-11002