

GENERAL NOTES
 1. THIS DRAWING IS TO BE READ IN CONJUNCTION WITH THE ARCHITECTS, SPECIALISTS AND ENGINEERS DRAWINGS AND SPECIFICATIONS. ANY DISCREPANCIES ARE TO BE REPORTED TO THE ARCHITECT/ENGINEER IMMEDIATELY.

TENDER ISSUE

KEY PLAN

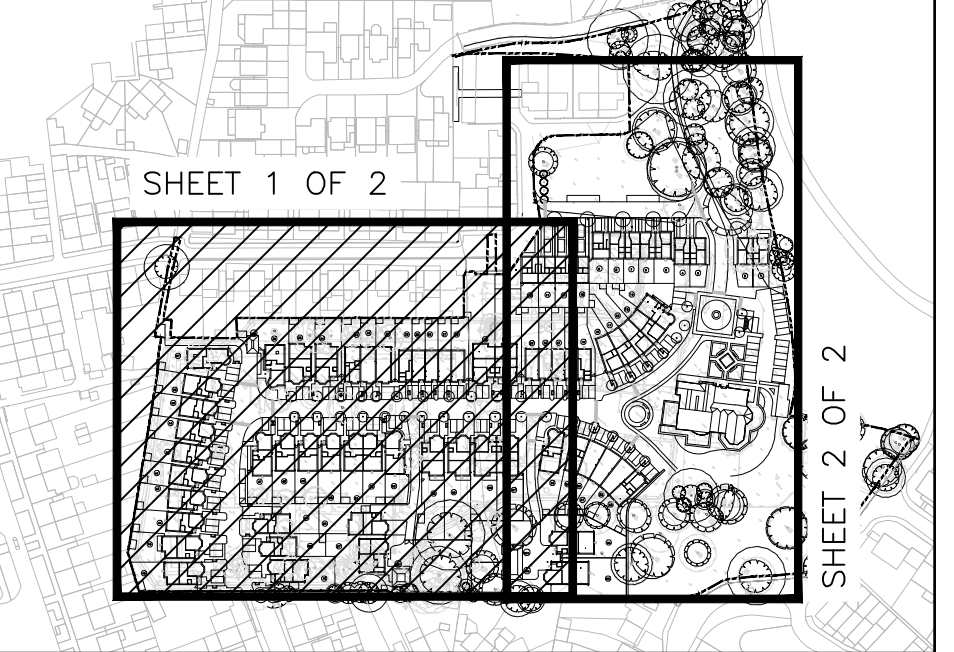

LATEST REVISIONS ARE 'TAGGED' WITH THIS INDICATOR. HOWEVER, ALL USERS OF THIS DRAWING MUST SATISFY THEMSELVES OF ALL REVISIONS TO ANY PREVIOUS ISSUES, BY COMPARISON OF THIS DRAWING AGAINST OTHER ISSUES, AS IT CANNOT BE GUARANTEED THAT EVERY ITEM OF REVISION HAS BEEN 'TAGGED'.

Rev	Date	Description	Drawn & Checked	Checked
G				
F				
E				
D				
C				
B				
A				
Revisions				
Date	05.02.16	FIRST ISSUE	DM/AZ	SC
Project				

LATCHMERE HOUSE

Title

EXTERNAL WORKS LAYOUT SHEET 1 OF 2

Client

BERKELEY HOMES (WEST LONDON) LIMITED

Architect

BROOKES ARCHITECTS

RLT

RLT ENGINEERING CONSULTANTS LTD
 CIVIL AND STRUCTURAL CONSULTING ENGINEERS
 2 ST PETER'S COURT MIDDLEBOROUGH COLCHESTER, ESSEX, CO1 1WD
 T: 01206 768655 F: 01206 768656 E: email@rltengcon.co.uk

ISO 9001 REGISTERED FIRM

EXTERNAL WORKS

- SITE LEVELS & FALLS $\frac{1}{XX}$ $\frac{1}{XX}$ $\frac{1}{XX}$
- EXISTING GROUND LEVELS $+ [8.45]$
- RETAINING WALL & TEXT $1250RW$
- GRAVEL BOARD & TEXT $300GB$
- BOUNDARY WALL & TEXT $---$
- FINISHED FLOOR LEVEL $FFL 00.000$
- EXPOSED BRICKWORK & No. OF COURSES (25)
- BRICK TANKING $4T$
- STEPS 3 STEPS
- BANKING MARKER $---$
- SITE BOUNDARY $---$
- 1.8m SERVICE CORRIDOR $---$
- PERMEABLE PAVING $---$

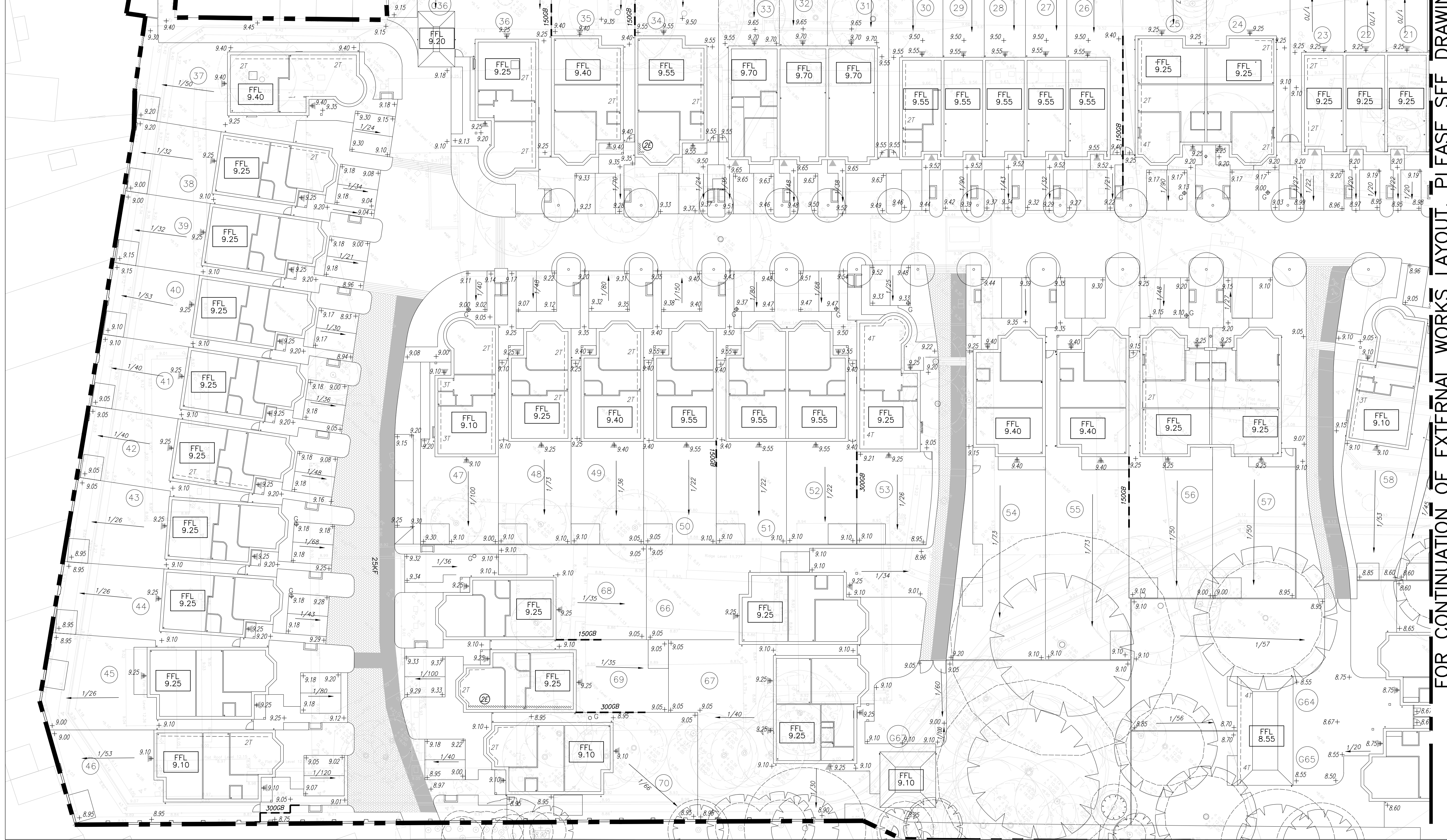
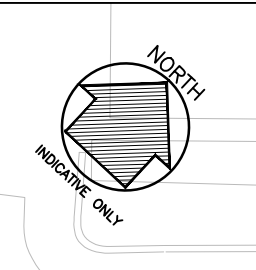

FOR CONTINUATION OF EXTERNAL WORKS LAYOUT, PLEASE SEE DRAWING No 1509/03/11