



FOR CONTINUATION OF EXTERNAL WORKS LAYOUT, PLEASE SEE DRAWING No 1509/03/10

SEE PLAN A FOR CONTINUATION

EXTERNAL WORKS	
SITE LEVELS & FALLS	+ 00.000 1/XX 1/XX 1:XX
EXISTING GROUND LEVELS	+ 8.45 1250RW
RETAINING WALL & TEXT	300GB
GRAVEL BOARD & TEXT	300GB
BOUNDARY WALL & TEXT	
FINISHED FLOOR LEVEL	FFL 00.000
EXPOSED BRICKWORK & No. OF COURSES	2
BRICK TANKING	4T
STEPS	3 STEPS
BANKING MARKER	
SITE BOUNDARY	
1.8m SERVICE CORRIDOR	
PERMEABLE PAVING	

DO NOT SCALE HARD COPIES OF THIS DRAWING OR INTERROGATE CAD VERSIONS. ONLY STATED DIMENSIONS AND COORDINATES ARE TO BE RELIED UPON. COPYRIGHT RESERVED

GENERAL NOTES
 1. THIS DRAWING IS TO BE READ IN CONJUNCTION WITH THE ARCHITECTS, SPECIALISTS AND ENGINEERS DRAWINGS AND SPECIFICATIONS. ANY DISCREPANCIES ARE TO BE REPORTED TO THE ARCHITECT/ENGINEER IMMEDIATELY.

TENDER ISSUE

KEY PLAN

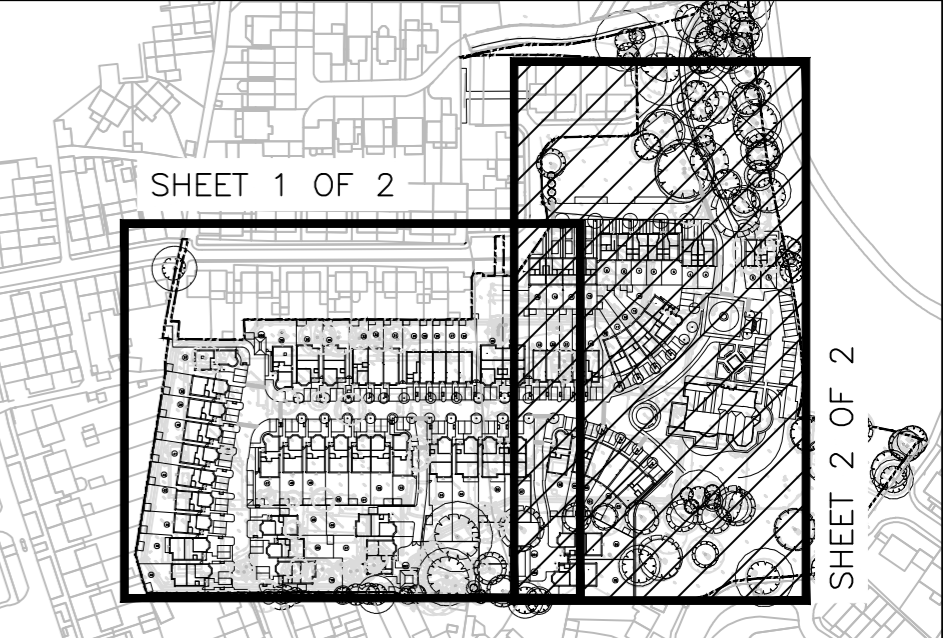

LATEST REVISIONS ARE 'TAGGED' WITH THIS INDICATOR. HOWEVER, ALL USERS OF THIS DRAWING MUST SATISFY THEMSELVES OF ALL REVISIONS TO ANY PREVIOUS ISSUES, BY COMPARISON OF THIS DRAWING AGAINST OTHER ISSUES, AS IT CANNOT BE GUARANTEED THAT EVERY ITEM OF REVISION HAS BEEN 'TAGGED'.

Rev	Date	Description	Drawn & Checked
	05.02.16	FIRST ISSUE	DM/AZ SC

LATCHMERE HOUSE

Title
EXTERNAL WORKS LAYOUT SHEET 2 OF 2

Client
BERKELEY HOMES

Architect
BROOKES ARCHITECTS

RLT

RLT ENGINEERING CONSULTANTS LTD
 CIVIL AND STRUCTURAL CONSULTING ENGINEERS
 2 ST PETER'S COURT MIDDLEBOROUGH COLCHESTER, ESSEX, CO1 1WQ
 T: 01206 768655 F: 01206 768656 E: email@rltengcon.co.uk

Dwg No. 1509/03/11 Scales: 1:250 @ A1 Rev: