

GENERAL NOTES
 1. THIS DRAWING IS TO BE READ IN CONJUNCTION WITH THE ARCHITECTS, SPECIALISTS AND ENGINEERS DRAWINGS AND SPECIFICATIONS. ANY DISCREPANCIES ARE TO BE REPORTED TO THE ARCHITECT/ENGINEER IMMEDIATELY.

AQUACELL CELLULAR SOAKAWAY DETAILS

SK1	- 17m x 2m x 0.8m DEEP = 27.2m ³
SK2	- 14m x 2m x 0.8m DEEP = 22.4m ³
SK3	- 13m x 2m x 0.8m DEEP = 20.8m ³
SK4	- 14m x 2m x 0.8m DEEP = 22.4m ³
SK5	- 20m x 2.5m x 0.8m DEEP = 40m ³
SK6	- 12m x 3m x 0.8m DEEP = 28.8m ³
SK7	- 06m x 1m x 0.8m DEEP = 4.8m ³
SK8	- 13m x 2m x 0.8m DEEP = 20.8m ³
SK9	- 12m x 2m x 0.8m DEEP = 19.2m ³
SK10	- 19m x 1.5m x 0.8m DEEP = 22.8m ³
SK11	- 08m x 2m x 0.8m DEEP = 12.8m ³
SK12	- 13m x 2m x 0.8m DEEP = 20.8m ³
HSK1	- 20m x 10m x 1.2m DEEP = 240m ³
HSK2	- 10m x 11m x 1.2m DEEP = 132m ³

TENDER ISSUE

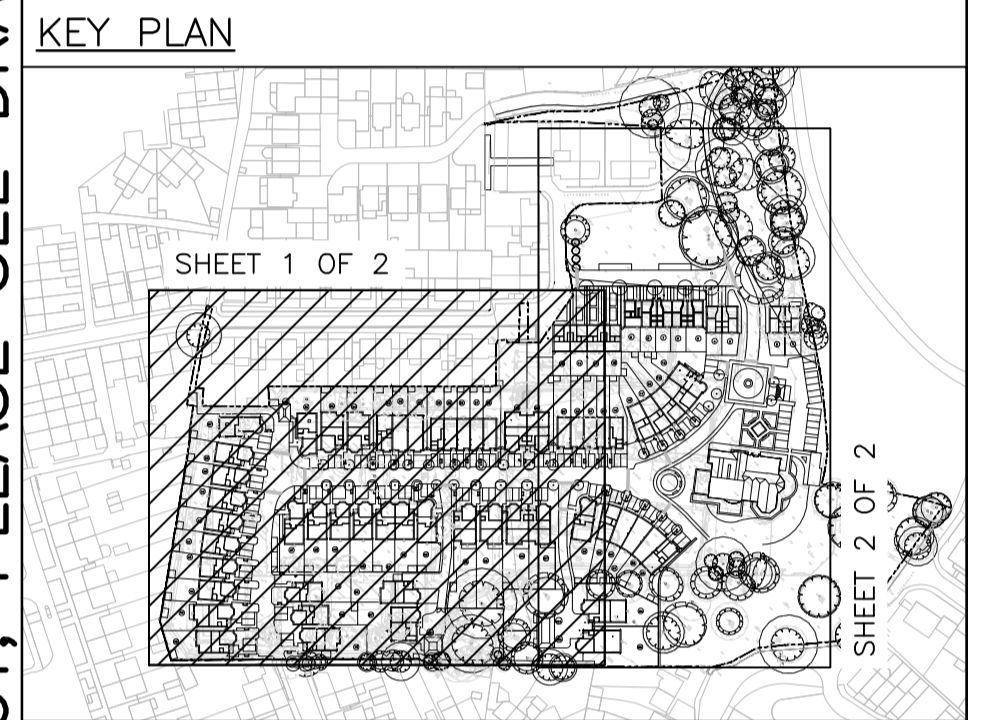

LATEST REVISIONS ARE 'TAGGED' WITH THIS INDICATOR. HOWEVER, ALL USERS OF THIS DRAWING MUST SATISFY THEMSELVES OF ALL REVISIONS TO ANY PREVIOUS ISSUES, BY COMPARISON OF THIS DRAWING AGAINST OTHER ISSUES, AS IT CANNOT BE GUARANTEED THAT EVERY ITEM OF REVISION HAS BEEN 'TAGGED'.

Rev	Date	Description	Drawn & Checked	Checked
05.02.16	FIRST ISSUE		DM	SC

LATCHMERE HOUSE

Title

PRIVATE DRAINAGE LAYOUT SHEET 1 OF 2

Client

BERKELEY HOMES (WEST LONDON) LIMITED

Architect

BROOKES ARCHITECTS

RLT

RLT ENGINEERING CONSULTANTS LTD
 CIVIL AND STRUCTURAL CONSULTING ENGINEERS
 2 ST. PETER'S COURT
 MIDDLEBOROUGH
 COLCHESTER, ESSEX, CO1 1WD
 T: 01206 768655
 F: 01206 768656
 E: email@rltengcon.co.uk

ISO 9001 REGISTERED FIRM

FOUL WATER

- SOIL & VENT PIPE (SVP)
- KITCHEN SINK (KSW)
- TOILET (WC)
- WASH HAND BASIN (WHB)
- GULLY
- GULLY CONCRETE ENCASED
- FOUL GULLY (TRAPPED)
- SHALLOW ACCESS CHAMBER
- MEDIUM INSPECTION CHAMBER (SEE COMBINATION)
- MEDIUM INSPECTION CHAMBER WITH BACKDROP
- ADOPTABLE FOUL MANHOLE

SURFACE WATER

- RAINWATER DOWNPIPE (RWP)
- SMALL INSPECTION CHAMBER (SEE COMBINATION)
- MEDIUM INSPECTION CHAMBER (SEE COMBINATION)
- CATCHPIT INSPECTION CHAMBER
- PRIVATE GULLY
- PRIVATE ROAD GULLY
- RODDING POINT
- CONCRETE PROTECTION TO PIPE
- PRIVATE STORM WATER MANHOLE (SEE MANHOLE SCHEDULES)
- MEDIUM INSPECTION CHAMBER WITH BACKDROP
- ADOPTABLE STORM MANHOLE

'OSMA' POLYPROPYLENE INSPECTION CHAMBERS

- (ref A) 250 DIAMETER, MAXIMUM 0.6m DEEP. 100# MAIN CHANNEL, 100# CONNECTIONS. 'OSMA' REF. 4D.960
- (ref B) 450 DIAMETER, MAXIMUM 1.2m DEEP. 100# MAIN CHANNEL, 100# CONNECTIONS. 'OSMA' REF. 4D.922
- (ref C) 450 DIAMETER, MAXIMUM 1.2m DEEP. 150# MAIN CHANNEL, 100# CONNECTIONS. 'OSMA' REF. 6UR.929
- (ref D) 450 DIAMETER, MAXIMUM 1.2m DEEP. 150# MAIN CHANNEL, 150# CONNECTIONS. 'OSMA' REF. 6UR.928
- (ref E) 460 DIAMETER, MAXIMUM 3.0m DEEP. 160# MAIN CHANNEL, 160# CONNECTIONS & 110# CONNECTIONS
- (ref F) 600 DIAMETER, MAXIMUM 3.0m DEEP. 225/300# MAIN CHANNEL, 160# CONNECTIONS

NOTE: REF. E, F & G MUST BE FITTED WITH SCREWED DOWN SEALED COVER WITH A NON MAN ENTRY ACCESS

NOTE THAT THE USE OF TAPERS MAY BE NECESSARY AT SOME CHAMBERS TO FACILITATE THE USE OF STANDARD POLYPROPYLENE CHAMBERS.

150/80 SIZE GRADIENT

1.8m SERVICE CORRIDOR

PERMEABLE PAVING

AQUACELL CELLULAR SOAKAWAYS

OPEN ENDED CONNECTION

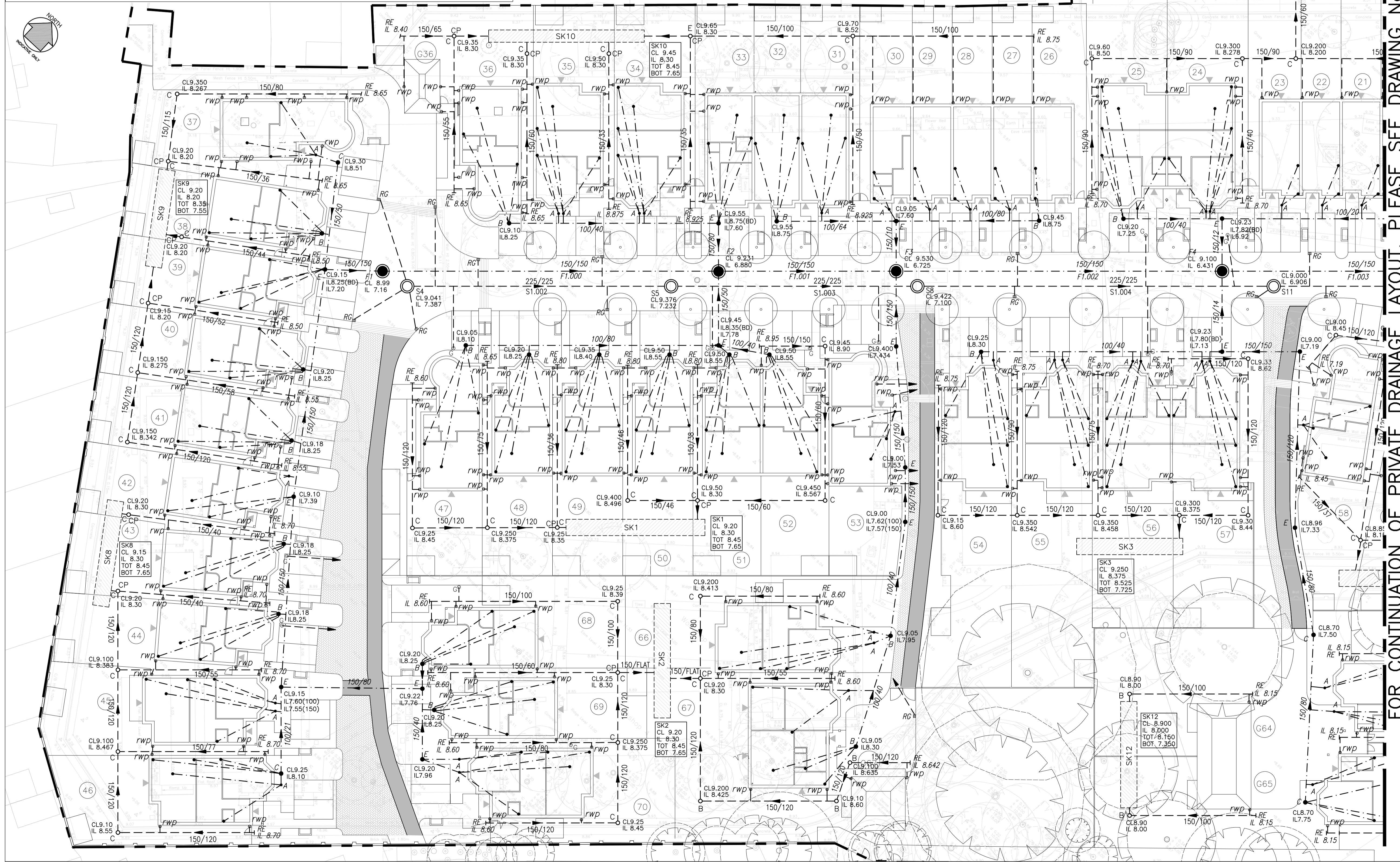

FOR CONTINUATION OF PRIVATE DRAINAGE LAYOUT, PLEASE SEE DRAWING No 1509/03/02