

**1** 3D VIEW  
 LEVEL 1 CONCOURSE VIEW 1

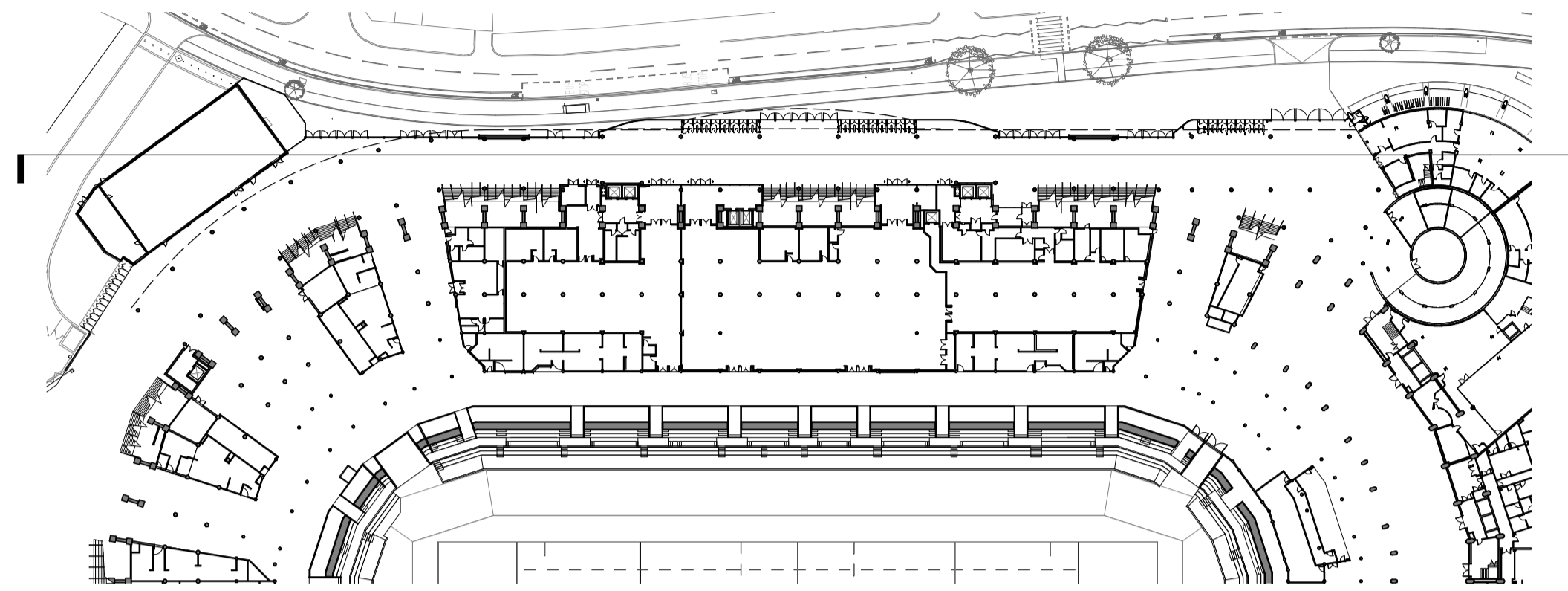

**2** PLAN  
 KEY TO ELEVATION OF GROUND/FIRST FLOOR 1:1000

- 1 ALUMINIUM SHINGLE RAINSCREEN CLADDING
- 2 DOUBLED GLAZED CURTAIN WALL SYSTEM WITH SOLAR CONTROL AND TINTED GLASS - COLOUR LIGHT GREEN
- 3 GLAZED BACK PAINTED SPANDREL PANEL INFILLS TO CURTAIN WALLING
- 4 PORCELAIN RAINSCREEN CLADDING
- 5 PPC LOUVRES DARK GREY
- 6 SILICONE JOINTS TO MULLIONS AND TRANSOMS
- 7 PPC ALUMINIUM FINNS TO CURTAIN WALL MULLIONS COLOUR TO MATCH CURTAIN WALL FRAME
- 8 PORCELAIN SOLID PANELS WITH EXPRESSED HORIZONTAL PATTERN AND PORCELAIN TOP PANEL WITH SLOTTED HOLES TO ALLOW THE MECHANICAL VENTILATION
- 9 PRESSED ALUMINIUM ROOF EDGE PROFILE (WHITE COLOUR)
- 10 PRESSED METAL VERTICAL FINNS (WHITE COLOUR)
- 11 PPC METAL FLASHING TO THE TOP OF THE TURNSTILES AND GATES FASCIA EDGE
- 12 LAMINATED GLAZED SCREEN TO 2.5M ABOVE FFL WITH GALVANIZED VERTICALS
- 13 STANDING SEAM ROOF
- 14 PPC MONORAIL SYSTEM TO PERIMETER EDGE FOR CLEANING AND MAINTENANCE VIA ABSAILING
- 15 GLAZED DOOR FOR SERVICE ACCESS
- 16 STAINLESS STEEL CABLES GUARDING
- 17 PORCELAIN TILES WITH EXPRESSED HORIZONTAL PATTERN
- 18 STANDING SEAM CANOPY WITH ALUMINIUM SOFFIT PANELS
- 19 WHITE PAINTED CIRCULAR HOLLOW SECTION STEEL PERIMETER COLUMNS
- 20 PRESSED METAL FLASHING DETAIL TO ROOF PARAPET - COLOUR TO MATCH LOUVRES
- 21 PRESSED METAL FLASHING DETAIL TO WINDOWS REVEALS COLOUR TO MATCH CURTAIN WALL FRAMING
- 22 EXIT GATES WITH GALVANISED AND POWDER COATED DOUBLE MESH INFILL PANELS
- 23 HPL RAINSCREEN CLADDING
- 24 WAYFINDING TO TURNSTILES AND GATES
- 25 GALVANISED AND POWDER COATED DOUBLE MESH SECURITY FENCING WITH VERTICAL POST
- 26 FIBRE CEMENT BOARD



**3** ELEVATION  
 CONCOURSE NORTH EAST ELEVATION 1:200

+18.725 m FFL (03)  
 +15.325 m FFL (02A)  
 +12.435 m FFL (02)  
 +9.372 m FFL (01)

Existing facade 4 3 5 2 Side barrier 3 2 Glazed double doors 4 Solid metal double doors

**NOTES**  
 To be read in conjunction with the following drawing series:  
 010,020,030,110,120,140,200,240,300,340,800.

**PLANNING**  
 Client RFU  
 Project TWICKENHAM STADIUM EAST STAND EXTENSION  
 Drawing title DETAILED ELEVATIONS

**KSS** Scale at A1  
 As indicated  
 File ref  
 East Stand Extension  
 Drawn by Date drawn  
 London 1 James Street Sevenoaks 7 Blighs Walk  
 London W1U 1DR Sevenoaks TN13 1DB  
 T+44(0)20 7907 2222 F+44(0)1732 467 841  
 Checked by Date checked  
 PY 14.07.16

SCALE  
 0m 2 4 10 20

Project number Drawing number Revision  
 15735 340 P01