

Revisions			
A	10.06.16	Draft Issue to Planning Consultants	AE PY
B	17.06.16	Draft Issue to RFU	AE PY

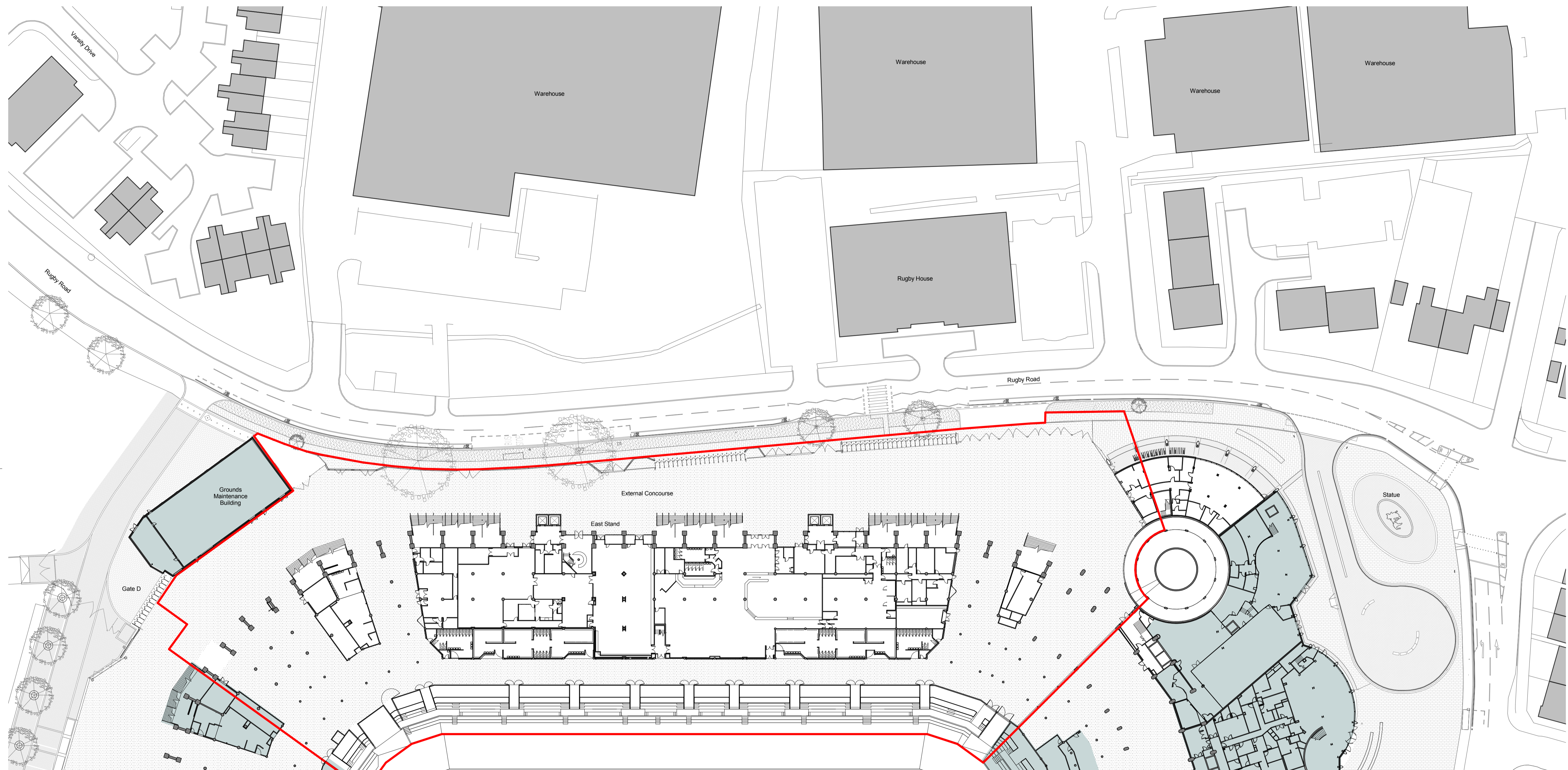
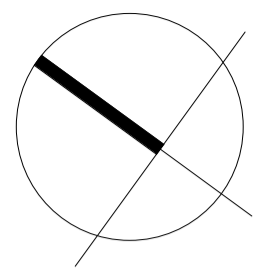

**NOTES**

To be read in conjunction with drawings 006-007.

**KEY**

- Existing fence & turnstile line
  - Tarmac
  - Existing concrete block paving (see image 1 drawing 006)
  - Proposed concrete block paving to match existing at south stand
  - Proposed small concrete block paving (similar to south stand, see image 2 drawing 006)
  - Resin bonded aggregate with integrated uplights (similar to south stand, see image 3 drawing 006)
- NOTE: PLEASE REFER TO DRAWING 007 FOR LANDSCAPE SECTIONS

**KEY**

- Development Boundary
- Site Ownership Boundary
- Area out of scope

**KEY PLAN**

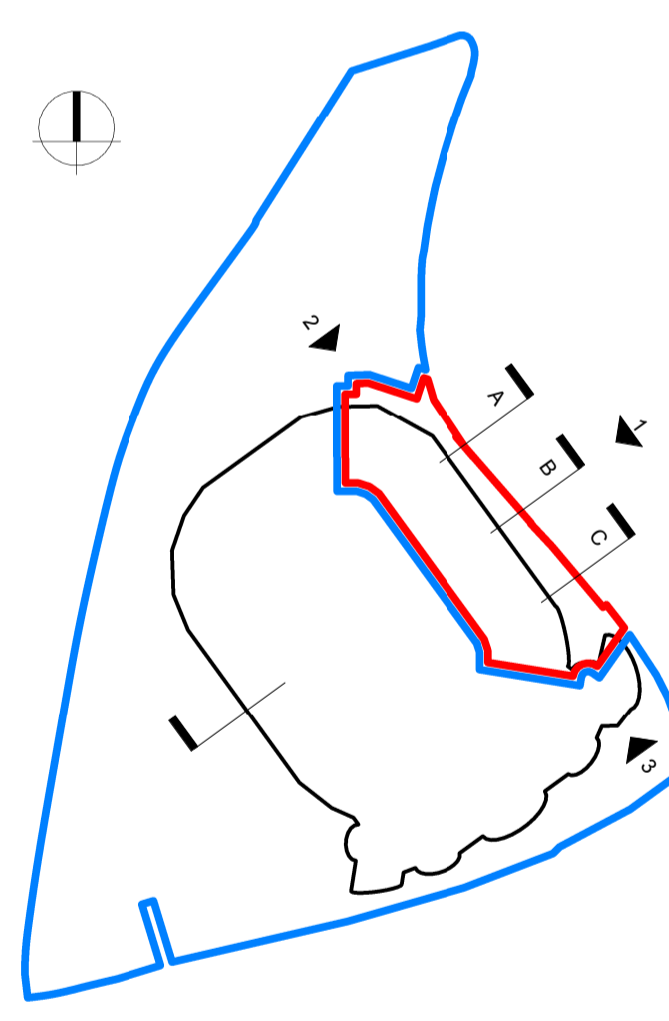

**PLANNING**

Client  
 RFU  
 Project  
**TWICKENHAM STADIUM  
 EAST STAND EXTENSION**  
 Drawing title  
**EXISTING SITE TOPOGRAPHIC PLAN**

**KISS** *Work in progress*

Scale at A1  
**1 : 500**

File ref  
 East Stand Extension

Drawn by  
 AE 10.06.16

Checked by  
 PY 10.06.16

Project number  
**15735**

Drawing number  
**005**

Revision  
**B**

