

Appendix F

Existing and Proposed External Landscaping Plans

Revisions			
A	10.06.16	Draft Issue to Planning Consultants	AE PY
B	17.06.16	Draft Issue to RFU	AE PY

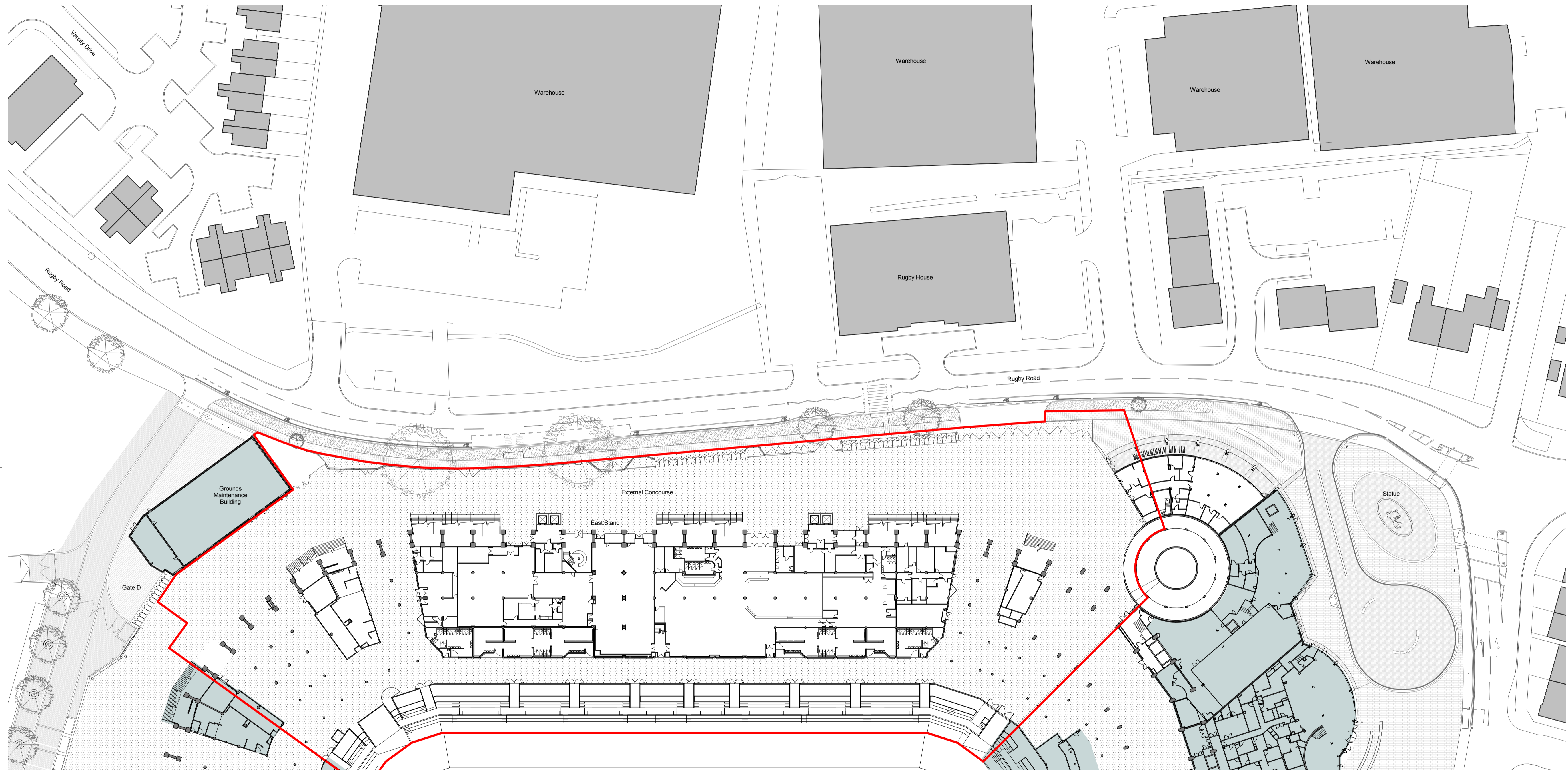
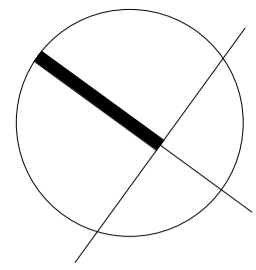

NOTES

To be read in conjunction with drawings 006-007.

KEY

- Existing fence & turnstile line
 - Tarmac
 - Existing concrete block paving (see image 1 drawing 006)
 - Proposed concrete block paving to match existing at south stand
 - Proposed small concrete block paving (similar to south stand, see image 2 drawing 006)
 - Resin bonded aggregate with integrated uplights (similar to south stand, see image 3 drawing 006)
- NOTE: PLEASE REFER TO DRAWING 007 FOR LANDSCAPE SECTIONS

KEY

- Development Boundary
- Site Ownership Boundary
- Area out of scope

KEY PLAN

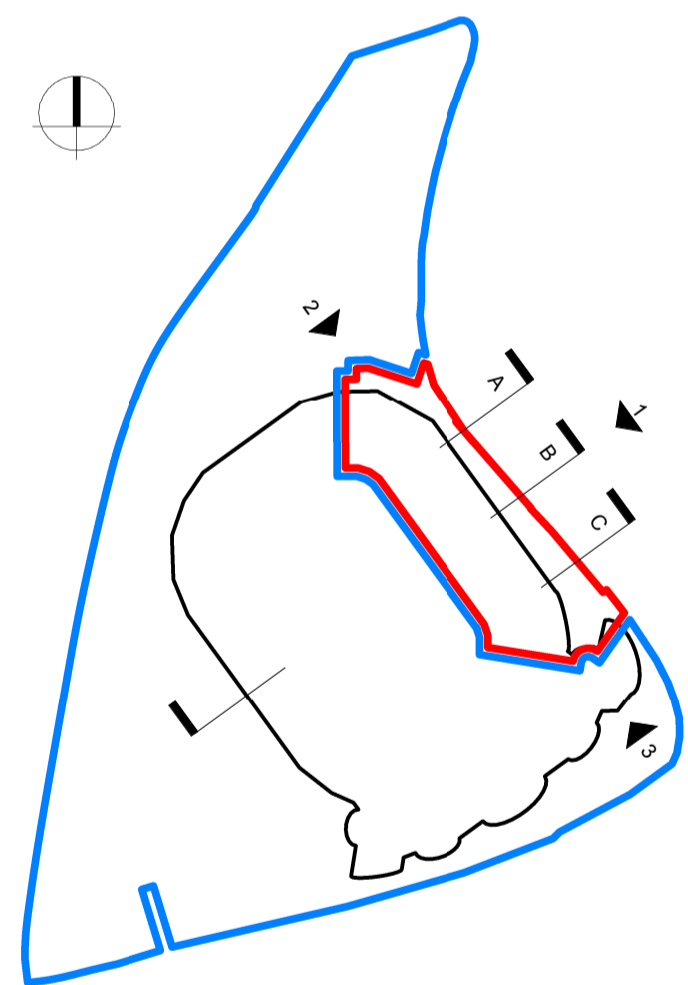

PLANNING

Client
 RFU
 Project
**TWICKENHAM STADIUM
 EAST STAND EXTENSION**
 Drawing title
EXISTING SITE TOPOGRAPHIC PLAN

KISS *Work in progress*

Scale at A1
1 : 500

File ref
 East Stand Extension

Drawn by
 Date drawn

Checked by
 Date checked

Project number
 Drawing number
 Revision

London 1 James Street London W1U 1DR +44(0)20 7907 2222 F+44(0)20 7907 2299	Sevenshaws 7 Sevenshaws Walk Sevenshaws TN13 1DB +44(0)20 7907 2222 F+44(0)1732 467 841	AE 10.06.16	PY 10.06.16
15735	005	B	

