



Borehole Log

Borehole No.

CP1

Sheet 1 of 2

Project Name: Hampton Hill

Project No.
51831

Co-ords: -

Hole Type
CP

Location: Former offices and studios, 65b High Street, Hampton Hill, Hampton, Greater London

Level:

Scale
1:50

Client: HBPW LLP

Dates: 19/05/2016 - 19/05/2016

Logged By
AJ

Well	Water Strikes	Samples and In Situ Testing			Depth (m)	Level (m)	Legend	Stratum Description
		Depth (m)	Type	Results				
		0.20 - 1.20	B		0.05 0.20		MADE GROUND (bituminous surfacing) MADE GROUND (crushed stone) MADE GROUND (crushed brick and concrete)	
		1.20		N=43 (6,10/9,10,12,12)	1.30			Dense SAND and GRVEL
		1.20 - 2.00	B					
			2.50		N=31 (5,7/8,7,7,9)			
			4.00		N=37 (6,10/8,10,9,10)			
			4.50	B				
			5.50		N=22 (7,6/5,4,6,7)	5.60		Very stiff bluish grey CLAY (London Clay)
			5.60 - 6.00	B				
			6.00 - 6.45	U				
			7.50		N=42 (7,9/10,10,11,11)			
		9.00 - 9.45	U					
		9.45 - 9.60	D					

Continued on next sheet

Remarks

Waiting for access - 1.5 hours, hand excavated trial pit from 0.00m to 1.20m - 1 hour





Borehole Log

Borehole No.

CP1

Sheet 2 of 2

Project Name: Hampton Hill

Project No.
51831

Co-ords: -

Hole Type
CP

Location: Former offices and studios, 65b High Street, Hampton Hill, Hampton, Greater London

Level:

Scale
1:50

Client: HBPW LLP

Dates: 19/05/2016 - 19/05/2016

Logged By
AJ

Well	Water Strikes	Samples and In Situ Testing			Depth (m)	Level (m)	Legend	Stratum Description
		Depth (m)	Type	Results				
		10.50		N=55 (9,12/12,13,14,16)				
		12.00 - 12.60	U					
		13.50		N=51 (11,11/11,13,13,14)				
		14.60		N=60 (12,13/14,15,15,16)				
					15.05			
								End of borehole at 15.05 m

Remarks
Waiting for access - 1.5 hours, hand excavated trial pit from 0.00m to 1.20m - 1 hour





Borehole Log

Borehole No.

CP2

Sheet 1 of 2

Project Name: Hampton Hill

Project No.
51831

Co-ords: -

Hole Type
CP

Location: Former offices and studios, 65b High Street, Hampton Hill, Hampton, Greater London

Level:

Scale
1:50

Client: HBPW LLP

Dates: 20/05/2016 - 20/05/2016

Logged By
AJ

Well	Water Strikes	Samples and In Situ Testing			Depth (m)	Level (m)	Legend	Stratum Description
		Depth (m)	Type	Results				
		0.40 - 1.20	B	N=5 (1,2/1,2,1,1)	0.05 0.20 0.40		MADE GROUND (Bituminous surface) MADE GROUND (Crushed Stone) MADE GROUND (Concrete) MADE GROUND (Ash and Stone fill)	
		1.20			1.80		Medium dense becoming dense SAND and GRAVEL	
		2.50 2.50 - 3.50	B	N=28 (6,7/7,6,8,7)				
		4.00			5.60			
		5.50 5.60 - 6.00	B	N=23 (6,8/7,6,5,5)				
		6.00 - 6.45	U					
		6.45 - 6.60	D					
		7.00 - 7.45	U					
		7.45 - 7.60	D					
		8.50						
	10.00 - 10.45	U						

Continued on next sheet

Remarks
Hand excavation - 1 Hr





Borehole Log

Borehole No.

CP2

Sheet 2 of 2

Project Name: Hampton Hill

Project No.
51831

Co-ords: -

Hole Type
CP

Location: Former offices and studios, 65b High Street, Hampton Hill, Hampton, Greater London

Level:

Scale
1:50

Client: HBPW LLP

Dates: 20/05/2016 - 20/05/2016

Logged By
AJ

Well	Water Strikes	Samples and In Situ Testing			Depth (m)	Level (m)	Legend	Stratum Description
		Depth (m)	Type	Results				
		10.45 - 10.60	D					
		11.50		N=43 (9,10/11,10,10,12)				
		13.00		N=50 (8,9/10,12,13,15)				
		14.00 - 14.60	U					
		14.60		N=57 (10,12/13,14,14,16)	15.05			
End of borehole at 15.05 m								

Remarks
Hand excavation - 1 Hr



Appendix B

Drainage Strategy Drawings

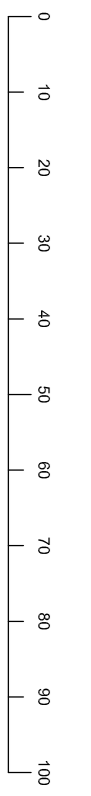
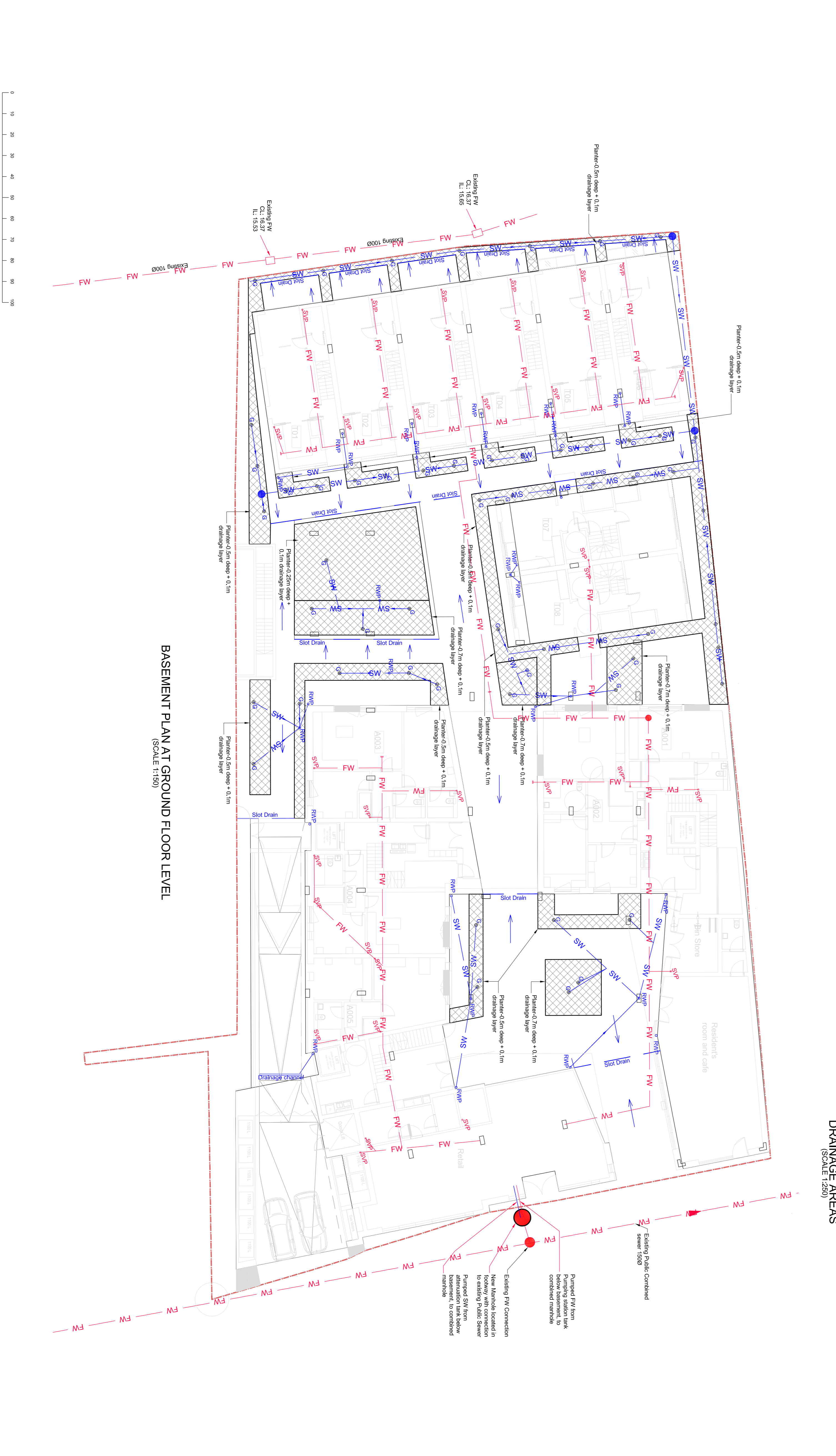
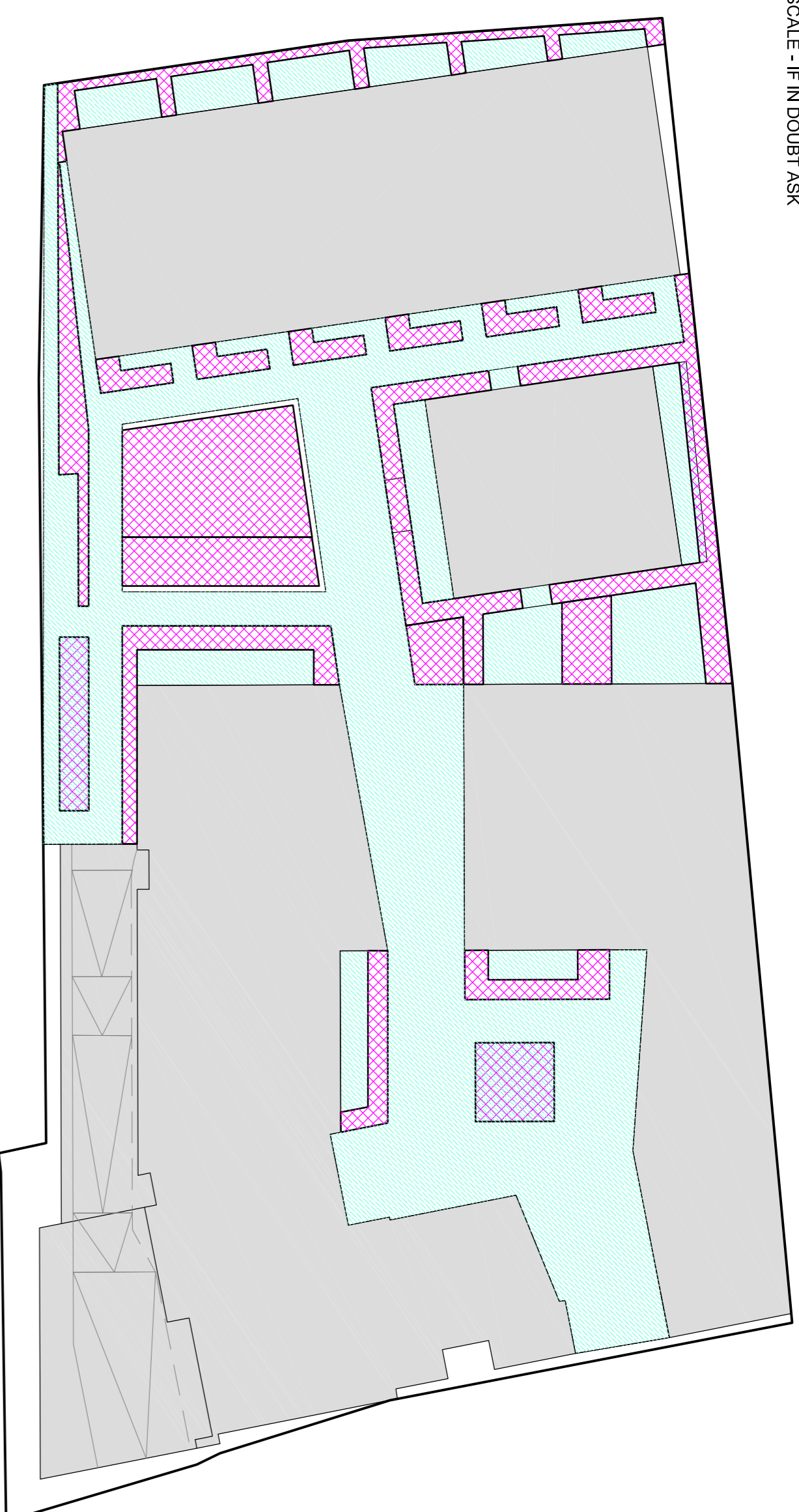
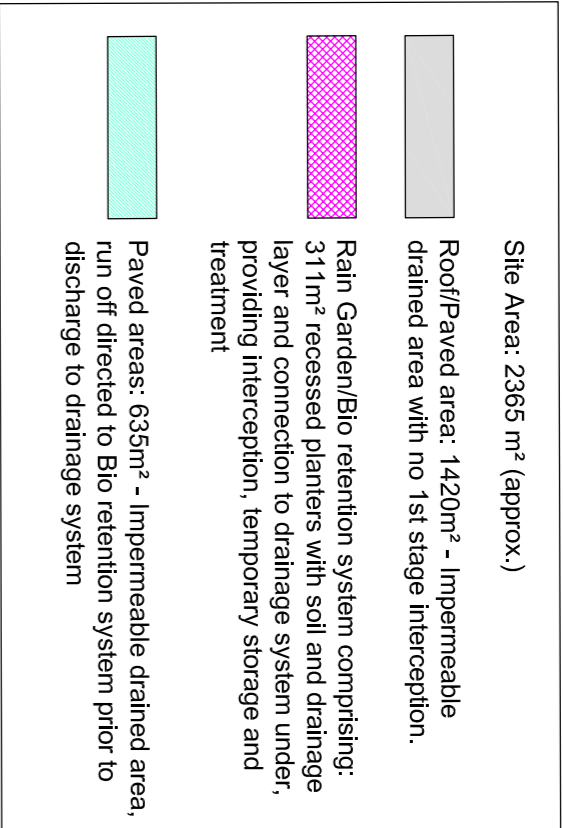
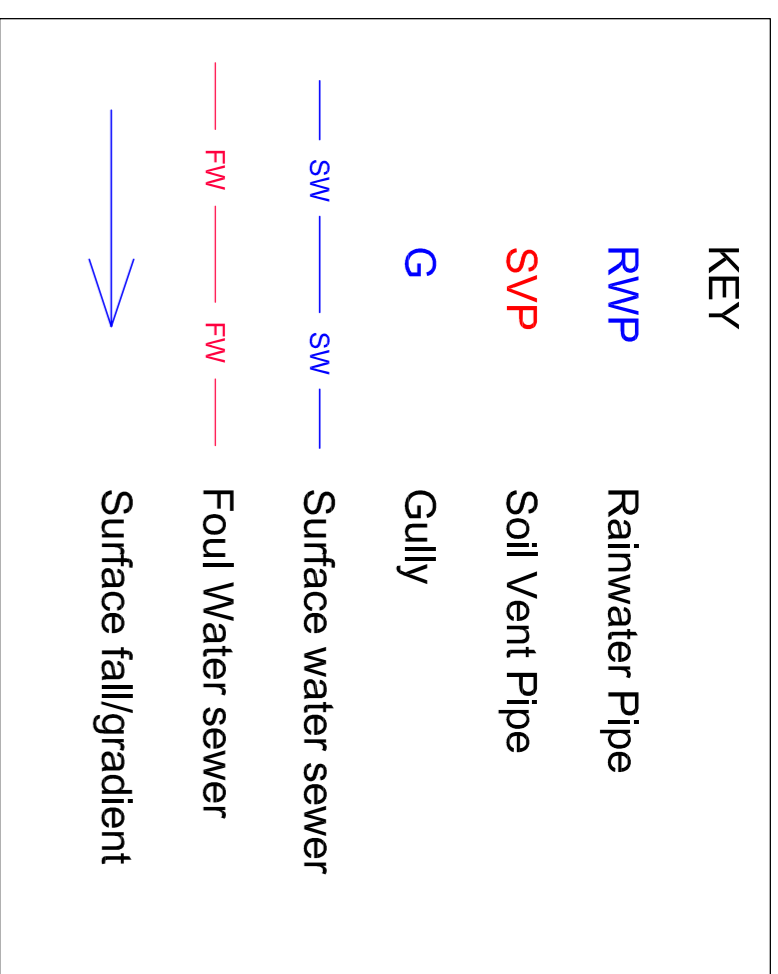

General Notes

1. DO NOT SCALE.
2. This drawing is to be read in conjunction with all other relevant drawings and details.
3. Should there be any conflict between the details indicated on this drawing and those indicated on other drawings the Engineer should be informed PRIOR to construction on site.
4. Until technical approval has been obtained from the relevant Authority, it should be understood that all drawings issued are for information only and are not to be used for construction of any part of the site unless specifically approved in writing by the Authority.
5. All dimensions are in millimetres unless otherwise stated.
6. All access and gradients to be in accordance with Building Regulations Part M: Access to and use of buildings.
7. Drainage to be in accordance with Building Regulations Part H: Drainage and Waste Disposal & relevant British Standards.
8. Linear drainage keep clean sizing and gully capacity are to be confirmed by manufacturer.
9. Where banking steeper than 1:3 is proposed, appropriate slope stabilisation measures are to be provided.
10. Gravel margin around building perimeter to ensure the integrity of the SW at drain distribution.
11. Contractor to obtain any necessary approvals from the water authority prior to operation.
12. External threshold drains to be provided at level access to buildings where necessary due to approach gradients.
13. All planting within 5m of proposed drainage to be specified so as not to cause root damage to drainages, or be provided with suitable root protection measures.
14. Any positions of RWP's and foul connection points shown are for information only and to be confirmed by others - refer to architects drawings for setting out information.
15. Cover class to manholes/inspection chambers are to suit anticipated vehicle loadings in accordance with BS EN 124 (D400) where potential for HGV loading. C250/B125 in concrete/gully/rail/road covers may be used only in cases as accessible by vehicles.
16. Durable concrete should be specified in accordance with the requirements of BS EN 12400 and BS EN 12401. Design Class and required Aggressive Chemical Environment for Concrete Class to be confirmed by SI.
17. Before handover, all manholes shall be inspected, all rubble removed, and the whole system shall be thoroughly flushed and cleaned.

HEALTH, SAFETY AND ENVIRONMENTAL INFORMATION

In addition to the hazards/risks associated with the types of work detailed on this drawing please note the following:

Construction:

- 1) 2)
- 3)

etc

Cleaning / Maintenance:

- 1)
- 2)
- 3)

etc

Demolition:

- 1)
- 2)
- 3)

etc

It is assumed that all works will be carried out by a competent contractor working, where appropriate, to an approved method statement.

Layout updated	B	18.10.16	HP	EP	RWP
Drainage updated	A	14.10.16	HP	EP	RWP
1st Issue	L	27.05.16	HP	EP	RWP
DESCRIPTION	REV	DATE	BY	CHECKED	APP'D
			BR	CHWD	HPW

43 Bridgwater
Weston Park
Bridgwater, Somerset
BS22 7JX
Tel: (01777) 869886
Fax: (01777) 862491

HBPW
LLP
Civil & Structural Engineering Services

CLIENT
GREAT PLANET LTD

PROJECT
63-71 HIGH STREET
HAMPTON HILL

DRAWING TITLE
DRAINAGE LAYOUT AT GROUND FLOOR LEVEL

DRAWN	EP	DATE	MAY 2016
PROJECT ENGINEER	EP	SCALE	AS SHOWN @ A1
CHECKED	SS	APPROVED	EP
DRAWING NUMBER	SLS0500_401	REVISION	B

General Notes

1. DO NOT SCALE.
2. This drawing is to be read in conjunction with all other relevant drawings and details.
3. Should there be any conflict between the details indicated on this drawing and those indicated on other drawings the Engineer should be informed PRIOR to construction on site.
4. Until technical approval has been obtained from the relevant Authority, it should be understood that all drawings issued are for information only and are not to be used for construction on site until such approval has been given. It is entirely at the owner's risk.
5. All dimensions are in millimetres unless otherwise stated.
6. All access and gradients to be in accordance with Building Regulations Part M1. Access to and use of buildings.
7. Drainage to be in accordance with Building Regulations Part H; Drainage and Waste Disposal & relevant British Standards.
8. Linear drainage keep drain sizing and gully capacity are to be confirmed by manufacturer.
9. Where banking steeper than 1:3 is proposed, appropriate slope stabilisation measures are to be provided.
10. Gravel margin around building perimeter to ensure the integrity of the DPC at drain location.
11. Contractor to obtain any necessary approvals from the water authority prior to operation.
12. External threshold drains to be provided at level access to buildings where necessary due to approach gradients.
13. All planting within 5m of proposed drainage to be specified so as not to cause root damage to drainages, or be provided with suitable root protection measures.
14. Any positions of RMPs and foul connection points shown are for information only and to be confirmed by others - refer to architects drawings for setting out information.
15. Cover class to manholes/inspection chambers are to suit anticipated vehicle loadings in accordance with BS EN 124 (D400) where potential for HGV loading. CS50(B) 125 in cover/gully/raile for cases 1/5 covers may be used only in cases not accessible by vehicles.
16. Staked concrete should be specified in accordance with the Aggressive Ground (Part 8.13) Design Substrate Class and required Aggressive Chemical Environment for Concrete Class to be confirmed by SI.
17. Before handover, all manholes shall be inspected, all rubble removed, and the whole system shall be thoroughly flushed and cleaned.

HEALTH, SAFETY AND ENVIRONMENTAL INFORMATION

In addition to the hazards/risks associated with the types of work detailed on this drawing please note the following:

- Construction:
- 1) 1)
 - 2) 2)
 - 3) 3)
- etc
- Cleaning / Maintenance:
- 1) 1)
 - 2) 2)
 - 3) 3)
- etc

Demolition:

- 1) 1)
- 2) 2)
- 3) 3)

etc

It is assumed that all works will be carried out by a competent contractor working, where appropriate, to an approved method statement

HBPW
LLP
 43 Bridgegate
 Redford
 Edinburgh
 EH2 7JX
 Tel: (01777) 869886
 Civil & Structural Engineering Services Fax: (01777) 862491

STATUS		PLANNING		CLIENT		PROJECT		DRAWING TITLE	
PLANNING		PLANNING		GREAT PLANET LTD		69-71 HIGH STREET HAMPTON HILL		DRAINAGE LAYOUT AT BASEMENT FLOOR LEVEL	
DRAWN	EP	DATE	MAY 2016	PROJECT ENGINEER	EP	CHECKED	SS	SCALE	AS SHOWN @ A1
APPROVED	EP	DRAWING NUMBER	SLS0500.002	REVISION	B				

KEY

- RWP Rainwater Pipe
- SVP Soil Vent Pipe
- G Gully
- SW Surface water sewer
- FW Foul Water sewer
- Surface fall/gradient

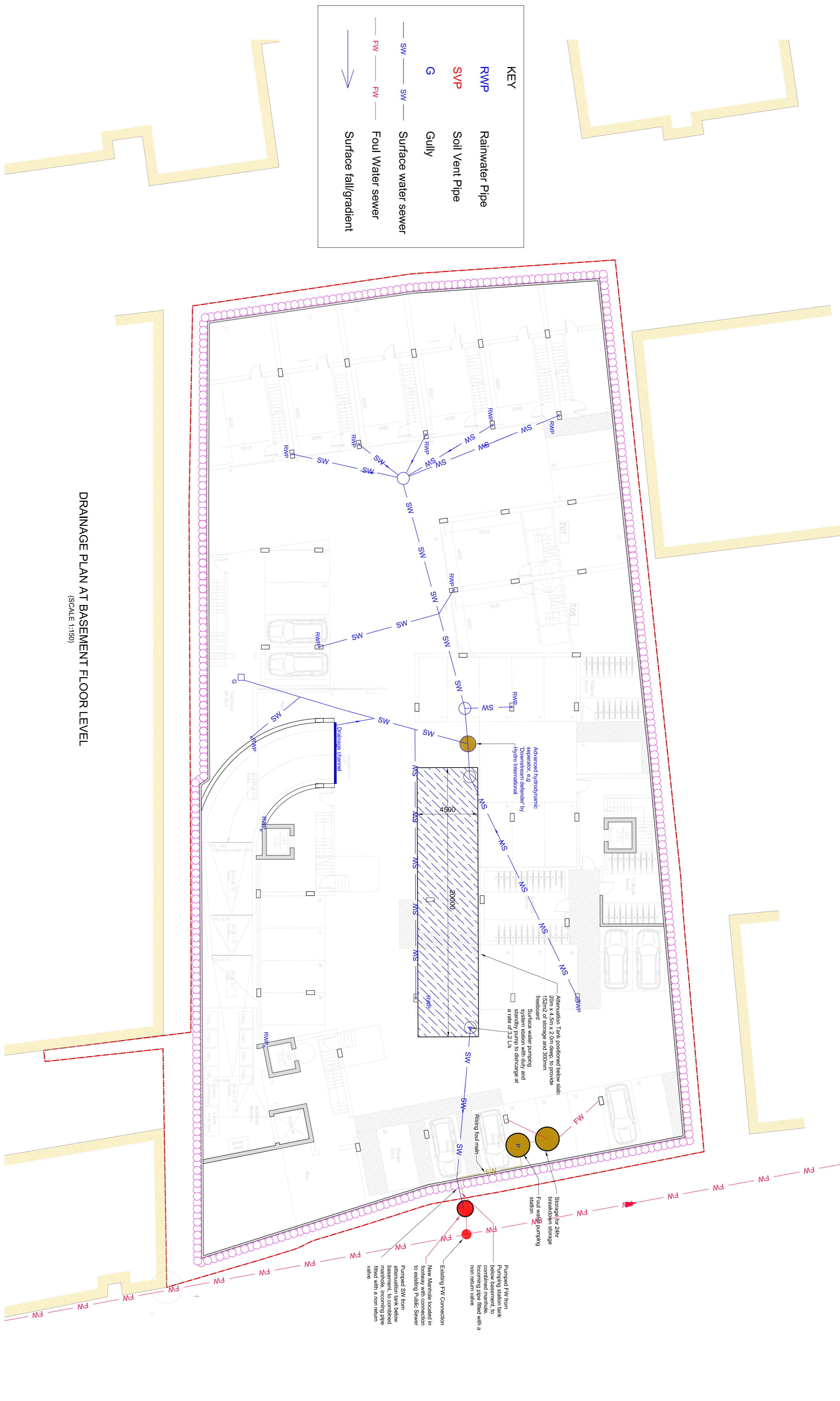

DRAINAGE PLAN AT BASEMENT FLOOR LEVEL
 (SCALE 1:150)

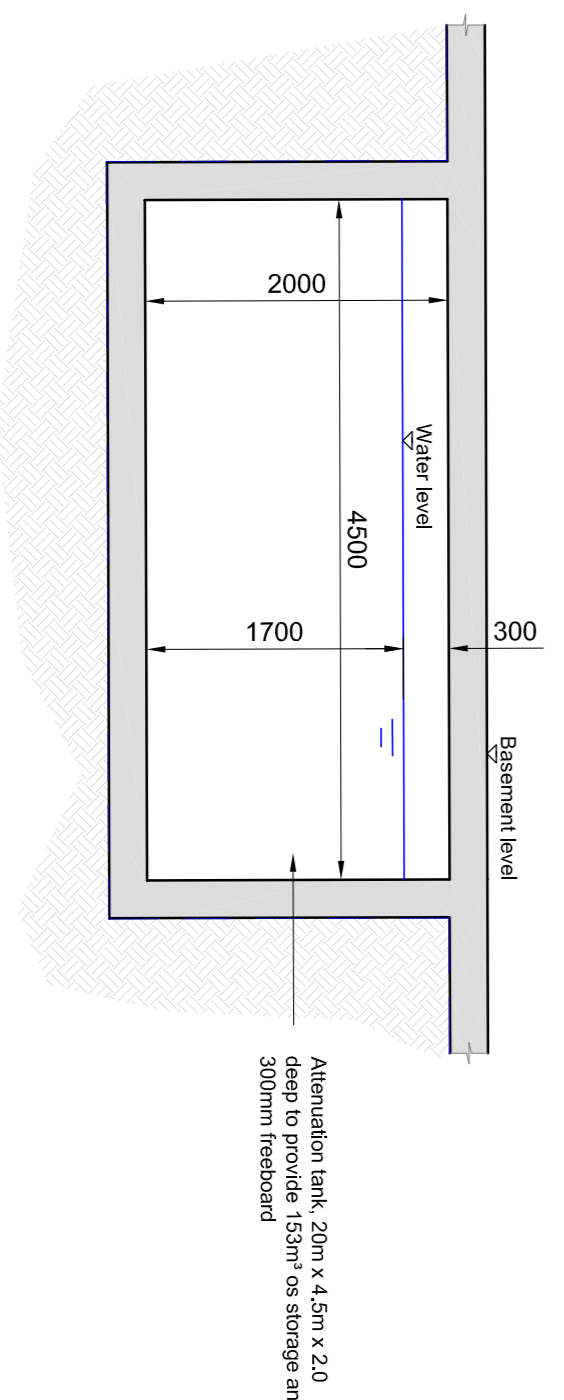

TYPICAL SECTION THROUGH ATTENUATION TANK
 (SCALE 1:50)

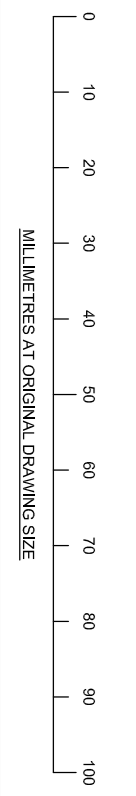

Appendix C

Substructure drawings