

06/0632/LBC

| Environmental Protection and Customer Services | Refer to: |
|--|-------------|
| PLANNING | Consist to: |
| 01 MAR 2005 | |
| | VIP |

| Rev | Date | By | Amendment |
|-----|----------|----|---|
| A | 27/05/04 | | Glazings and doors amended New floor in the colonnade amended Height of the floor over the cafe servery gridded |
| B | 14/06/04 | | Section C to be demolished amended Servery/computer room/store amended |
| C | 07/07/04 | | Re drawn incorporating comments from planning and conservation departments |
| D | 13/07/04 | | Sections amended |
| E | 11/04/05 | | Sections amended to new design |
| F | 26/04/05 | | More information added to sections |
| G | 05/05/05 | | Sections C/C & H/H amended and detail references added |
| H | 05/05/05 | | Sections J / J & I / I added to drawing |

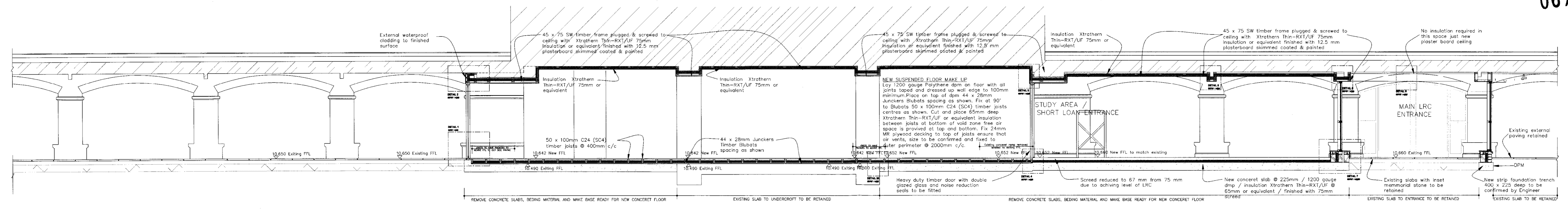

SECTION G / G

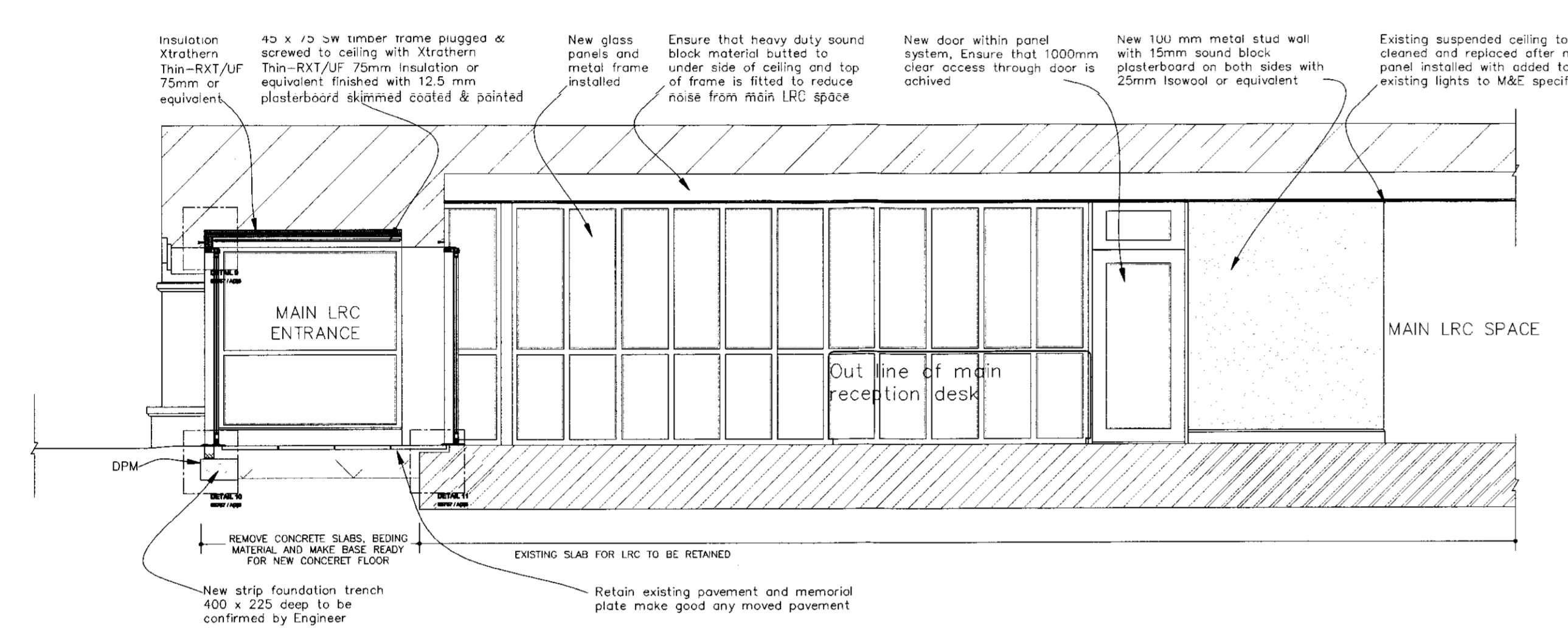

SECTION F / F

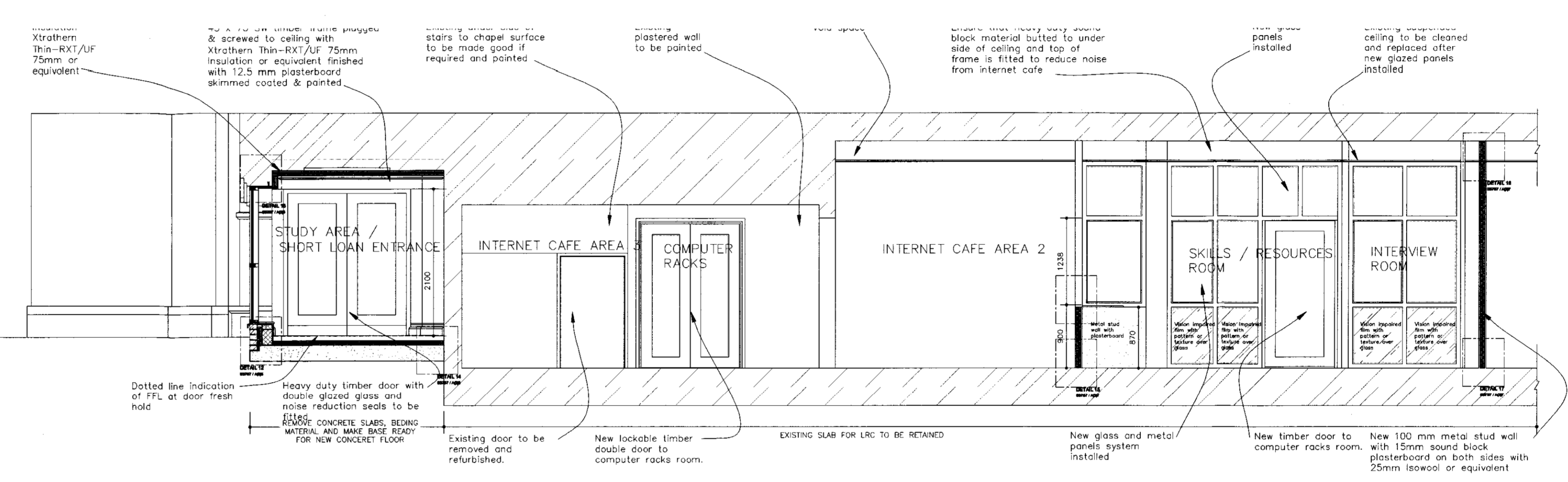

SECTION E / E

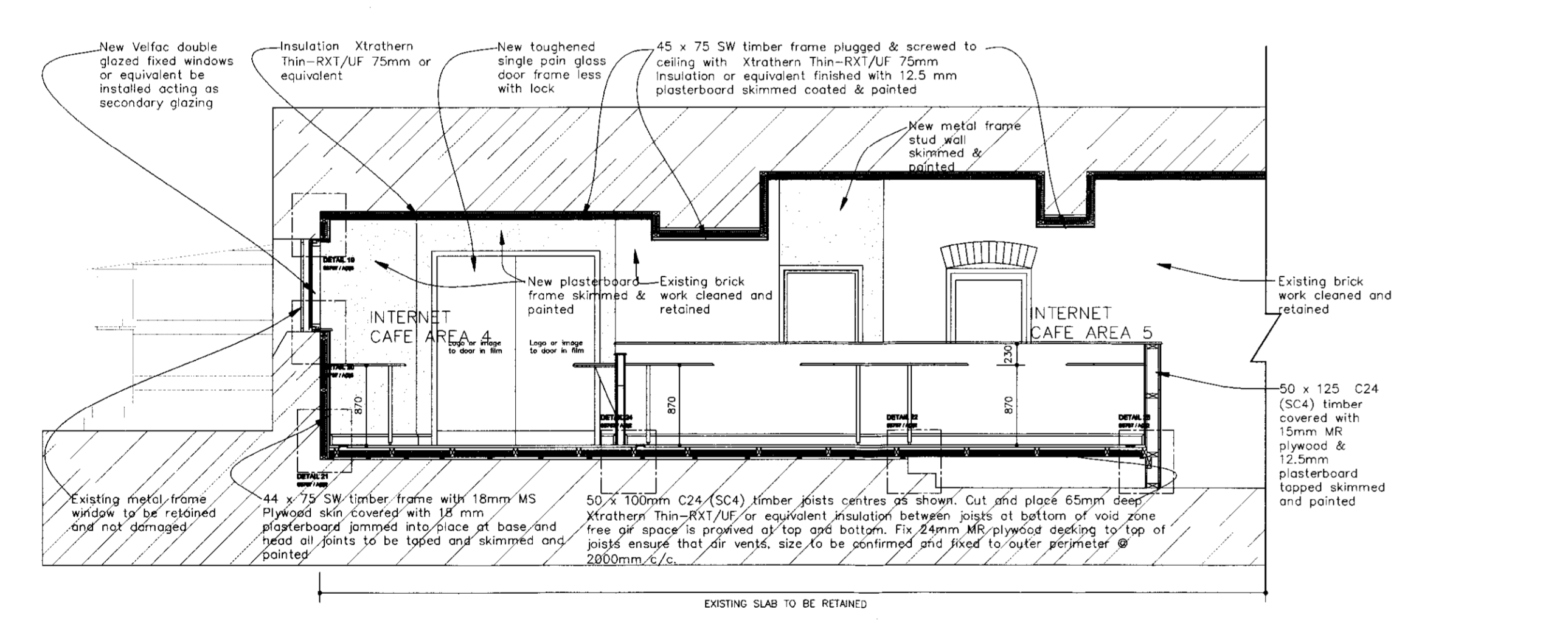

SECTION C / C

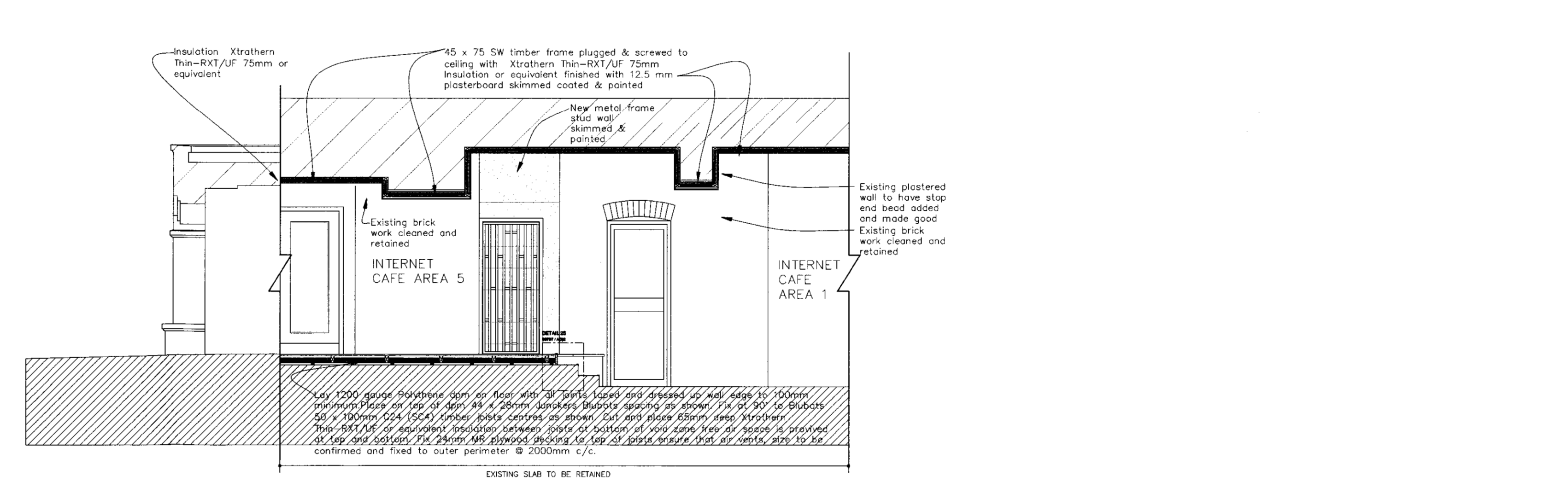

SECTION H / H

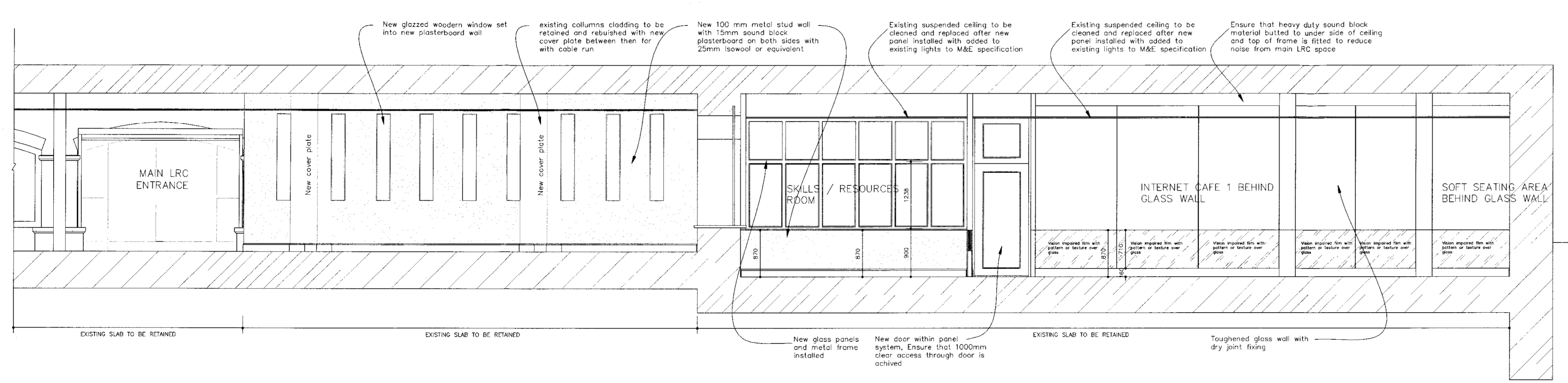

SECTION J / J

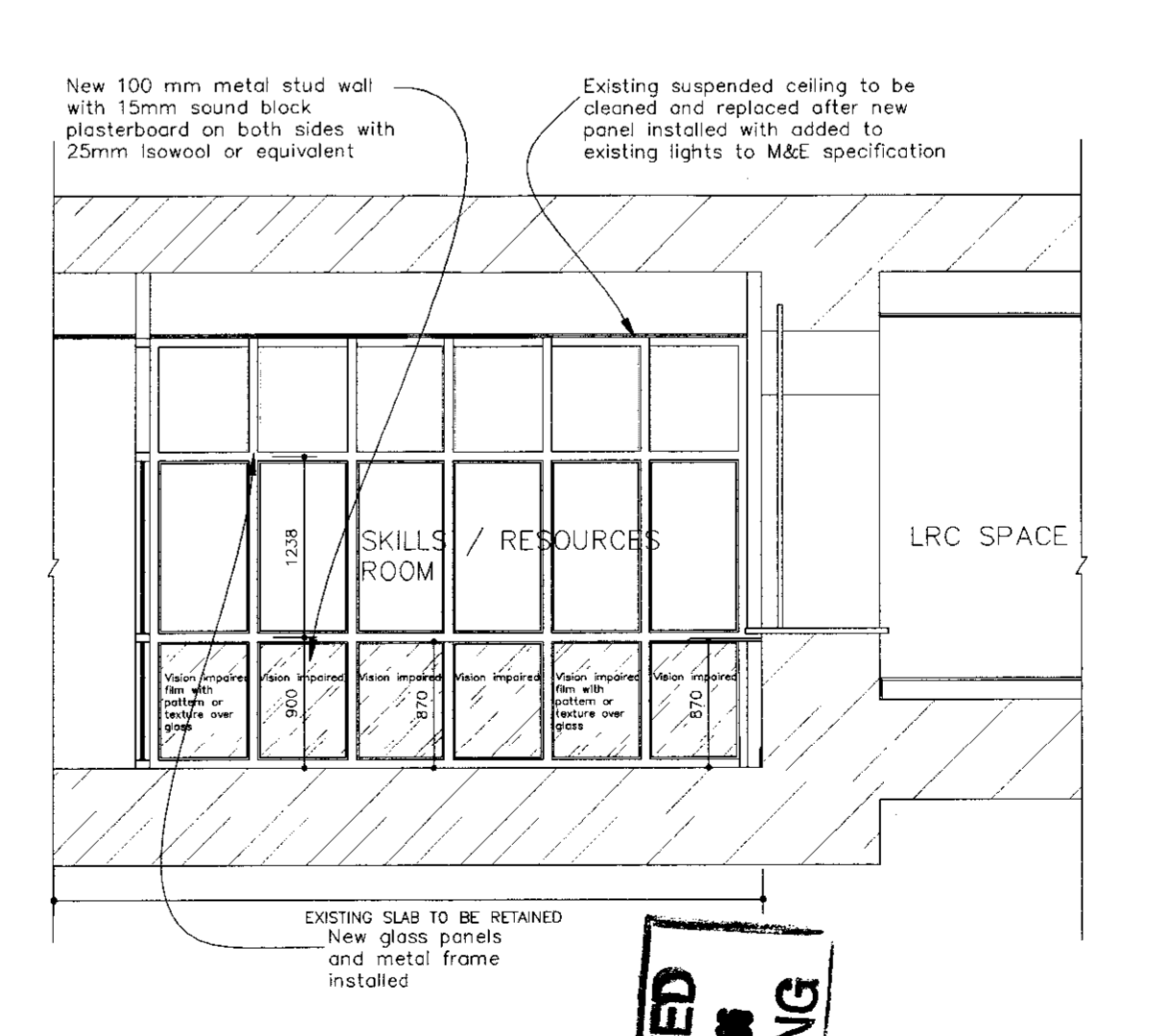

SECTION I / I

LEGEND

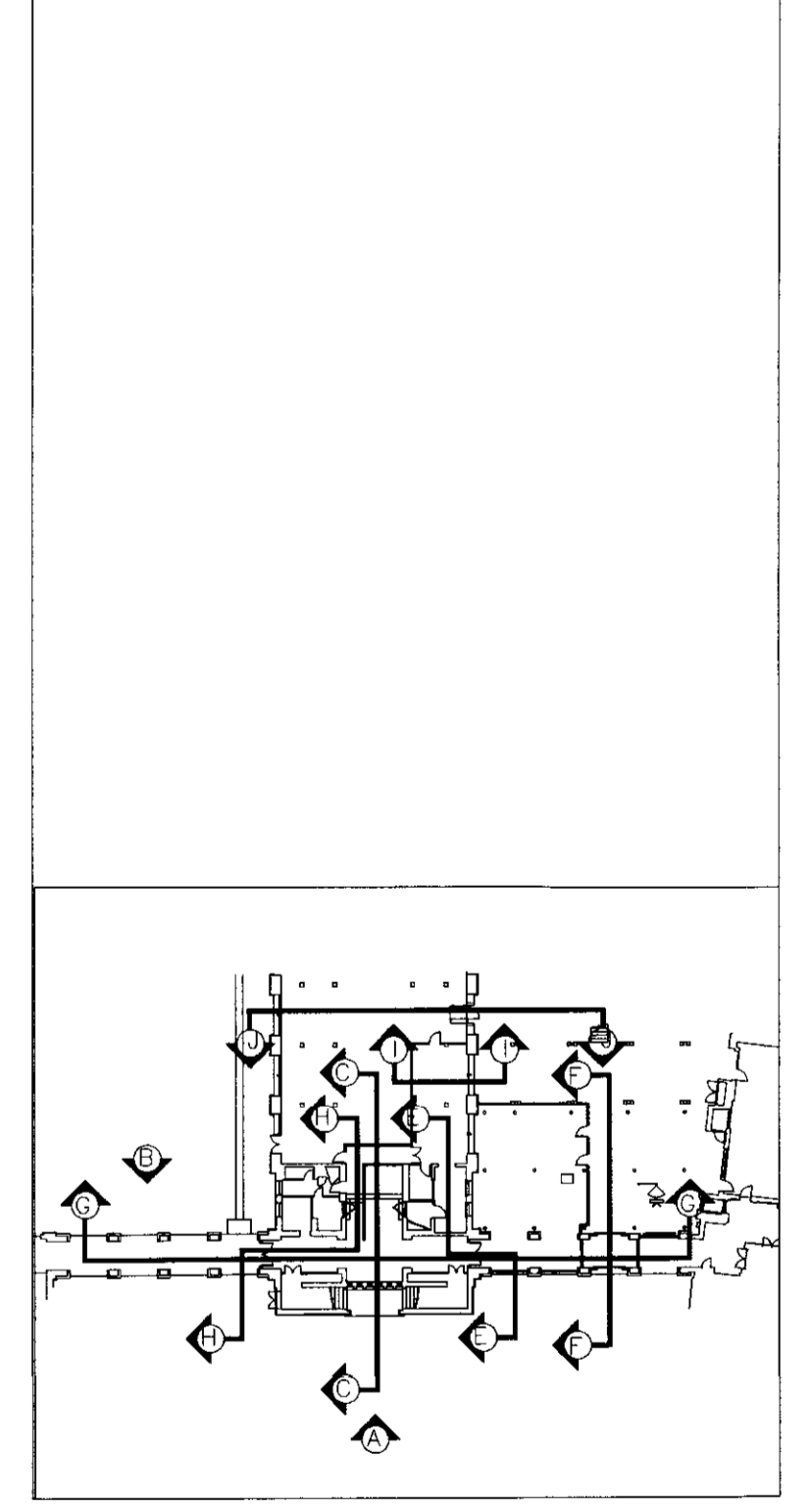

TRIBAL A member of Tribal Group plc

Harwell London Brighton Cardiff Rochdale
 Bristol Exeter CapeTown Liverpool Dardford

NIGHTINGALE architects
 associates

Block A, Littlebrook Business Park
 Dardford, Kent
 DN1 5PZ

Client: ST. MARY'S COLLEGE TWICKENHAM

Project: ALTERATIONS TO CHAPEL UNDERCROFT AND LRC

Drawing: PROPOSED ELEVATIONS/SECTIONS

Date: May2004 Scale: 1:50@A0

Project No: 03767 Drawing No: L(0)11 Revision: H

RECEIVED
 01 MAR 2005
 PLANNING