

Railway



To be demolished



Existing buildings



Boundary line

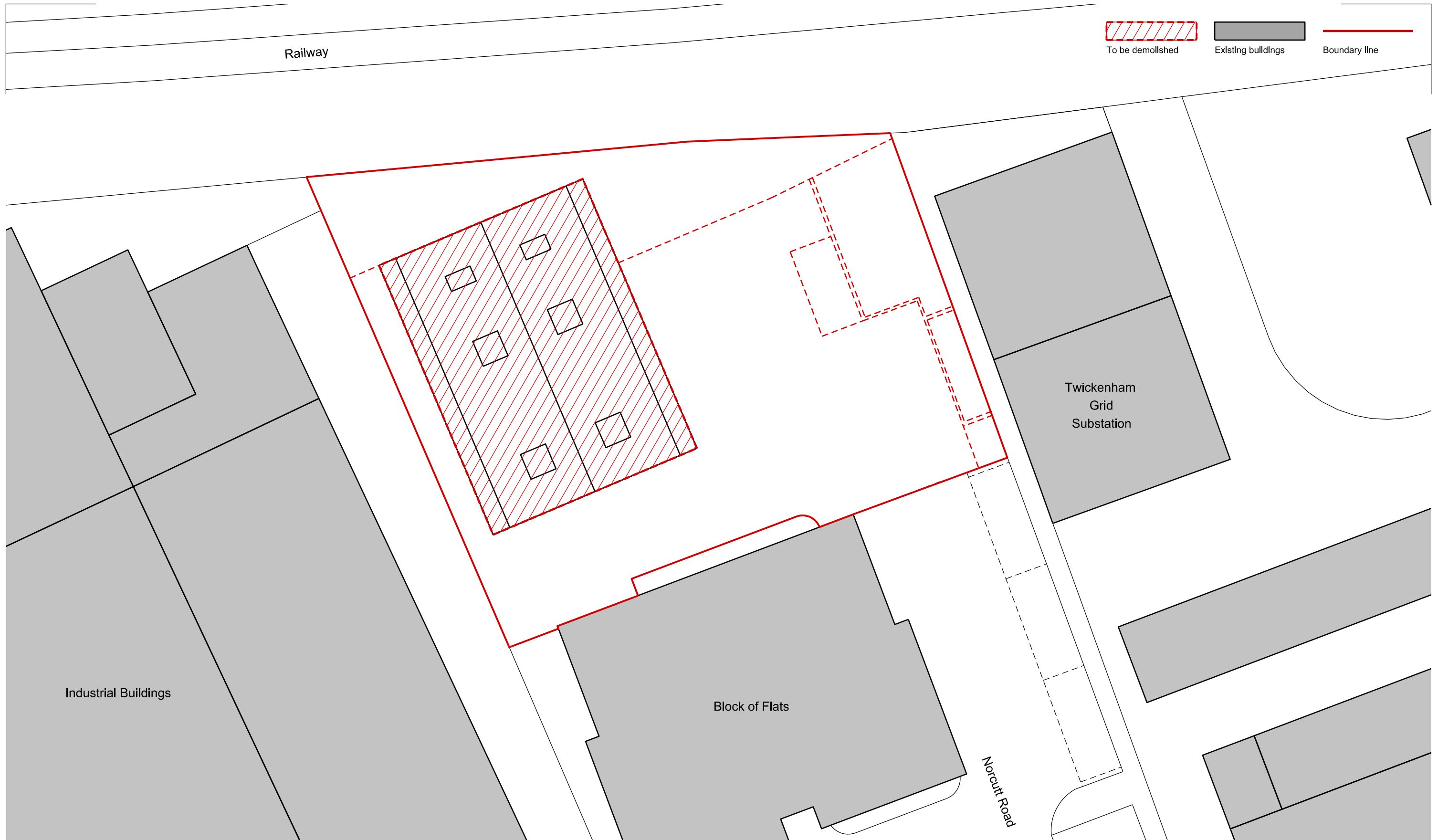

General Notes:

Do not scale from this drawing. Use marked dimensions.
Should any discrepancies be noted, please inform this office.
This drawing is copyright of Matthew Allchurch Architects Limited



Scale Bar:

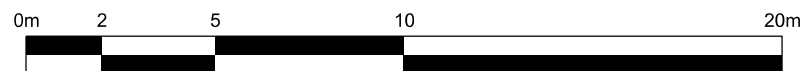

0	Issued for Planning
Rev:	Description:

15/03/17	CS	GS
Date	Drn by:	Ckd by:

Client:

Lockcorp Ltd

Project Name:

Lockcorp House, 75 Norcutt Road, TW2 6SR

Drawing Title:

Demolition Plan

Project No:	Drawing No:	Revision:	Scale:	Date:
JJ01	P_031	0	1:200 @ A3	Feb 2017
Drawn By:	Checked By:	Status:		
CS	GS	Planning		



the boathouse design studio
 27 ferry road teddington tw11 9nn
 t: 020 8973 0050
 e: Info@maa-architects.com
 w: www.maa-architects.com