

1 Typical Elevation of Door  
310 Scale: 1:15 @ A3

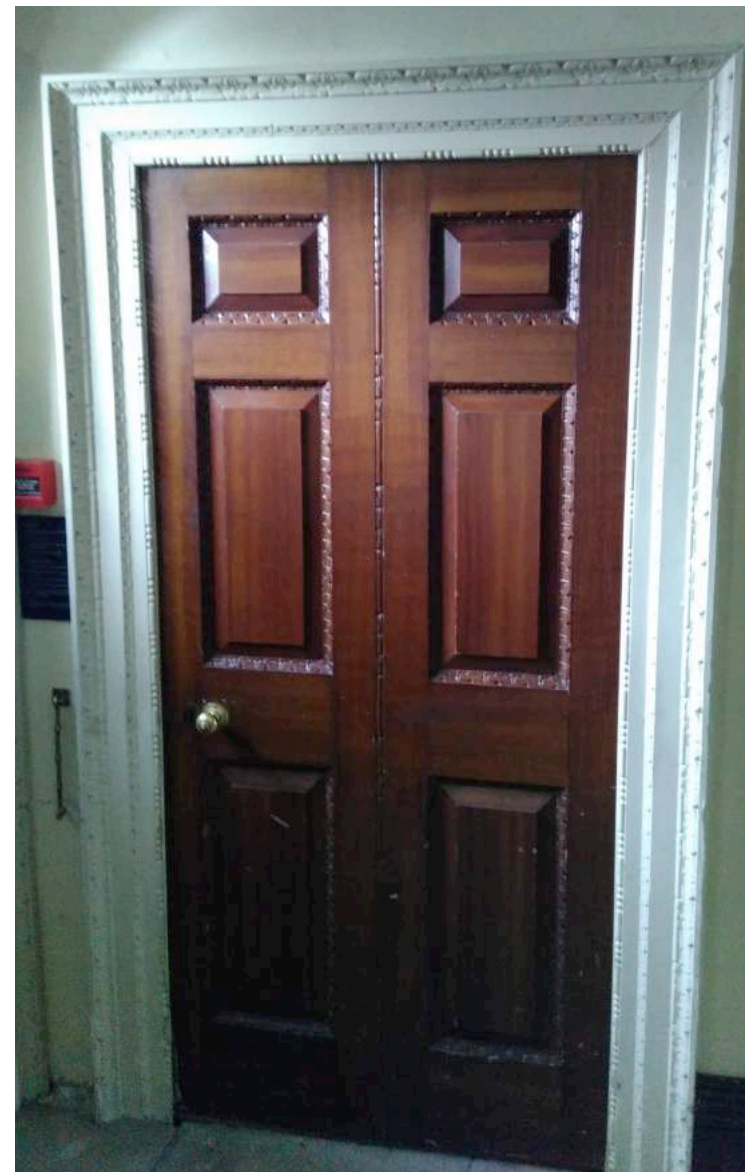

2 Photograph of Typical Door  
310 Scale: not to scale @ A3

**Notes**

1. Fire Seal to Jamb & Head of Door, Lorient Finesse 15 x 4 mm: cut out channel for fire seal in indicated location & fit seal in place to manufacturers requirements. At hinges or other interruptions, notch seal around ironmongery to provide a continuous seal. Seal colour to match colour of frame finish, they are available in a range of finishes, assume that European Walnut (W018) will be used. The fins are to be clear. To be confirmed by Architect onsite prior to works.
2. Intumescent Paint, Envirograf Product 103; prepare timber as required by manufacturer (but retaining all existing paint layers) and paint with 'Product 103' clear intumescent paint kit, finish with the 'matt' top coat option. Where non-clear finish is required, paint with 'Product 103' coloured paint in required colour, finish with the 'matt' top coat option. Paint door leafs on both sides of door.
3. Hinges: Carefully unscrew the existing hinges, use an appropriately sized screwdriver to avoiding burring or damage to the existing screws. Set these aside for reuse. Cut Intumescent Cloth (Envirograf Product 71) to suit the size of the hinge rebate, ensure that cloth is cut neatly so that it is not visible once hinge is reinstated. Place cloth in place in rebate. Reinstall hinges using the existing screws, if screws are new (Philips, Pozi, BZP), reinstall with new unplated 'Mild Steel' Wood Screws to match Gauge, length and head type (assume slotted countersunk), these are available from [www.screwsline.co.uk](http://www.screwsline.co.uk). Where hinges are new and inappropriate, replace with new hinges to Architect's Approval, assume for pricing Royde & Tucker Bronze Plate H100 Hinges are to be used.
4. Door Knobs: Carefully unscrew the existing knobs and plates, use an appropriately sized screwdriver to avoiding burring or damage to the existing screws. Set these aside for reuse. Cut Intumescent Cloth (Envirograf Product 71) to suit the diameter of the knob plate, ensure that cloth is cut neatly so that it is not visible once knob is reinstated. Place cloth in place. Reinstall knobs using the existing screws, if screws are new (Philips, Pozi, BZP), reinstall with new Screws to match material, Gauge, length and head type, these are available from [www.screwsline.co.uk](http://www.screwsline.co.uk).
5. Echutzcheon Plate: Carefully unscrew the existing eschutzcheon plates, use an appropriately sized screwdriver to avoiding burring or damage to the existing screws. Set these aside for reuse. Cut Intumescent Cloth (Envirograf Product 71) to suit the diameter of plate, ensure that cloth is cut neatly so that it is not visible once plate is reinstated. Place cloth in place. Reinstall plates using the existing screws, if screws are new (Philips, Pozi, BZP), reinstall with new Screws to match material, Gauge, length and head type, these are available from [www.screwsline.co.uk](http://www.screwsline.co.uk).
6. Lock Case, Forend Plate & Strike Plate: Carefully unscrew and remove the existing lock assembly, use an appropriately sized screwdriver to avoiding burring or damage to the existing screws. Set these aside for reuse. Cut Intumescent Cloth (Envirograf Product 71) to fully wrap the lock case and to fit snugly behind the forend and strike plates. Ensure that cloth is cut neatly so that it is not visible once the lock is reinstated. Place cloth in place. Reinstall lock assembly using the existing screws, if screws are new (Philips, Pozi, BZP), reinstall with new Screws to match material, Gauge, length and head type, these are available from [www.screwsline.co.uk](http://www.screwsline.co.uk).

DO NOT SCALE THIS DRAWING USE DIMENSIONS ONLY  
VERIFY ALL DIMENSIONS ON SITE BEFORE COMMENCING ANY WORK OR SHOP DRAWINGS  
INFORM THE ARCHITECT BEFORE ANY WORK STARTS IF THIS DRAWING EXCEEDS THE QUANTITIES IN ANY WAY

Revision Date

DRAWING ISSUE STATUS	REVISION N°	DATE	SIGNED
RISK ASSESSMENT UNDERTAKEN			
PLANNING APPLICATION N° 1			
PLANNING APPLICATION N° 2			
PLANNING CONSENT			
LISTED BLDG APPLICATION			
LISTED BLDG CONSENT			
DAC APPROVAL			
BLDG CONTROL APPLICATION			
BLDG CONTROL APPROVAL			
TENDER DOCUMENT			
CONTRACT DOCUMENT			

CLIENT  
English Heritage

PROJECT  
Marble Hill House

TITLE  
Main House:  
Fire upgrading works to sensitive  
historic doors.



**Acanthus  
Clews  
architects**

SCALE  
1:100 @ A3

DATE  
December 2016

JOB N°  
16\_132

DRAWN  
HS

DRAWING N°  
310

Acanthus House  
57 Hightown Road  
Banbury • Oxfordshire  
OX16 9BE  
Tel: 01295 702600  
Fax: 01295 702601  
[architects@acanthusclews.co.uk](mailto:architects@acanthusclews.co.uk)  
[www.acanthusclews.co.uk](http://www.acanthusclews.co.uk)

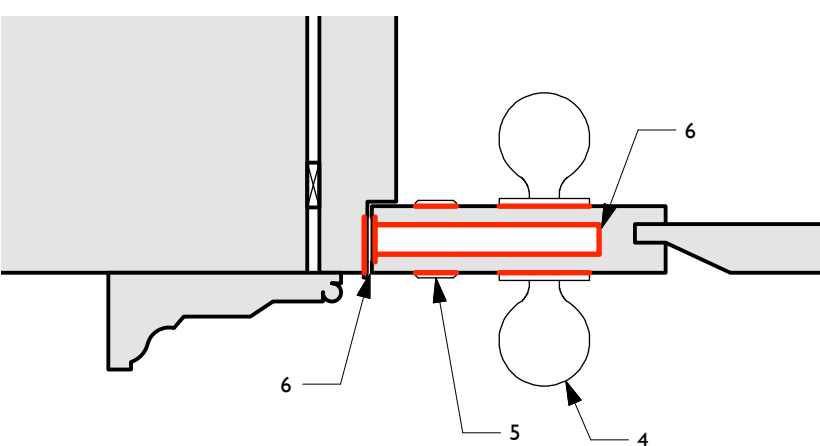

3 Works to Lock Assembly  
310 Scale: 1:5 @ A3

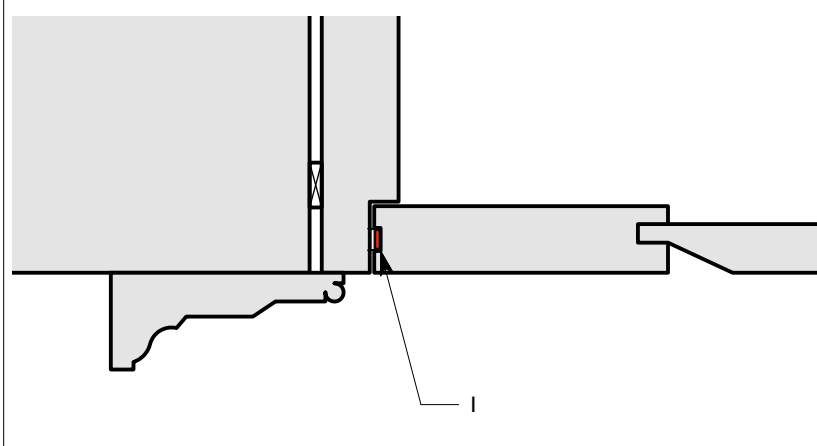

4 Works to Door Edge Generally  
310 Scale: 1:5 @ A3

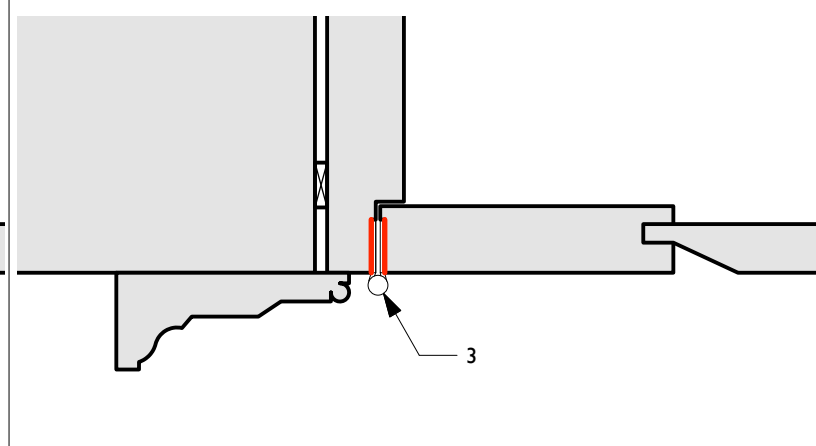

5 Works to Hinge Assembly  
310 Scale: 1:5 @ A3