

The south-west quarter contained a ninepin bowling alley and paths through a wilderness of trees and shrub planting.

South-west Quarter

Key considerations and opportunities for this area:

- Restore the ninepin alley in the western compartment of the middle terrace, to complete the Bridgeman and Pope landscape of the early 18th century.
- Improve habitats and biodiversity promote access to nature.
- Reintroduce gravel path network within the wilderness.
- Coppice existing yews and holly to regenerate planting stock.
- Create evergreen enclosures and hedging.
- Remove dilapidated timber palisade fencing.
- Explore opportunities for managed extensive volunteer tree planting projects.
- Recreate the planted palisade.
- Provision of a weatherproof buggy store.

Key:

- Existing tree canopy
- Proposed avenue trees
- Proposed orchard trees
- Proposed specimen trees
- Proposed grove trees
- Proposed hedges
- Amenity grassland
- Wetland habitats
- Wilderness
- Flower garden
- Thicket
- Existing paths
- Proposed 'wiggle' paths

1. Planted palisade  
 2. Reformed terraces  
 3. Ninepin alley  
 5. Grove planting  
 6. Reconfigured carriage circle  
 12. Buggy store

H. Marble Hill House

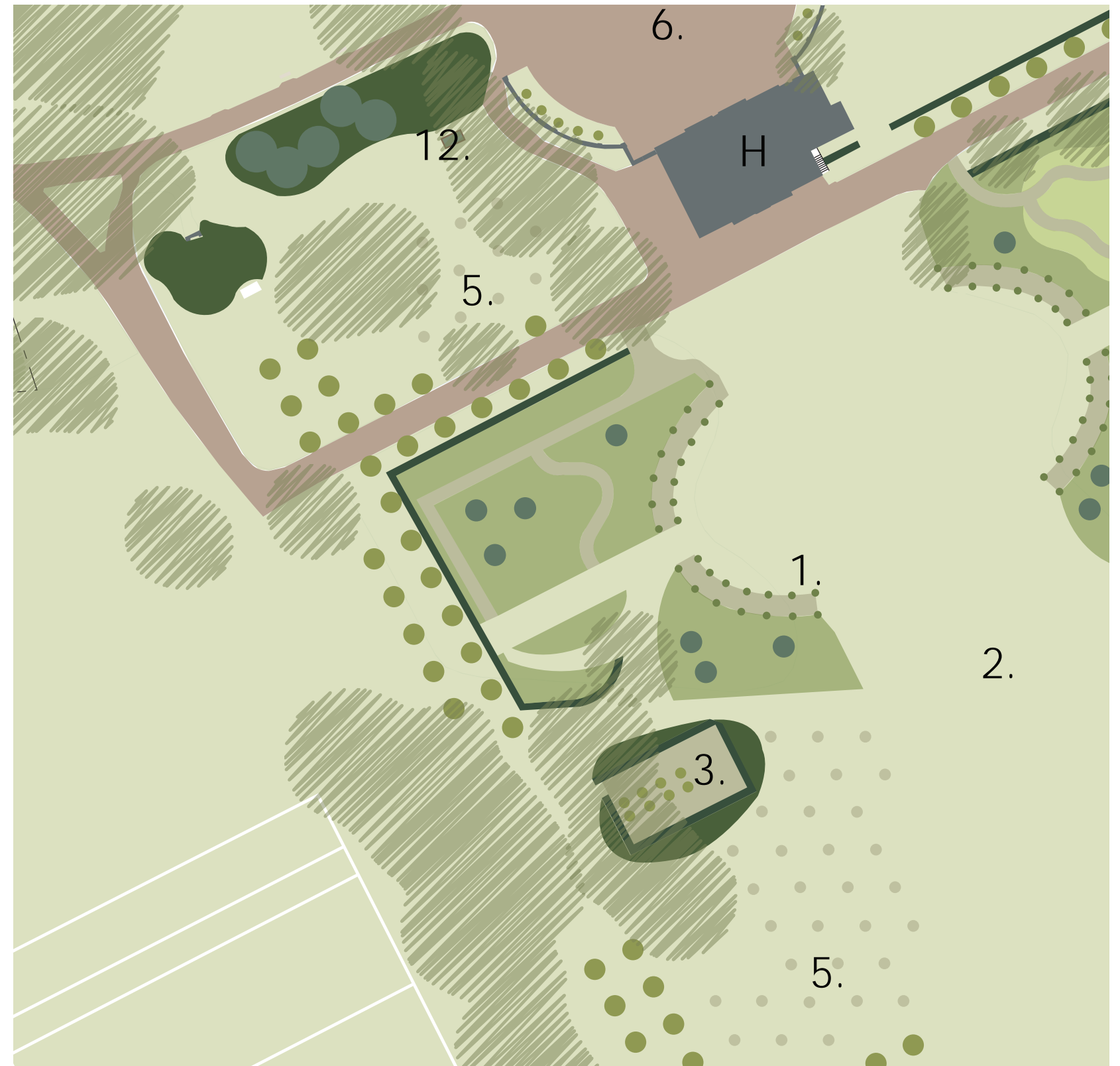

Detail of proposed landscape plan - Ref - 581\_PL\_L\_01

