

| Rev | Date      | By  | Description  |
|-----|-----------|-----|--|
| P1  | Dec 2015  | LJB | Preliminary Issue  |
| P2  | Feb 2016  | CS  | Preliminary Issue Amended as indicated & Plot references added                                     |
| P3  | Sept 2016 | LJB | Preliminary Issue BT services added and service routes amended to co-ordinate with drainage layout |

**GENERAL NOTES:**  
INDICATIVE LAYOUT ONLY SUBJECT TO FINAL DESIGN BY SUPPLYING AUTHORITIES

**DETAILS OF CABLE & TV NETWORK TO BE CONFIRMED**

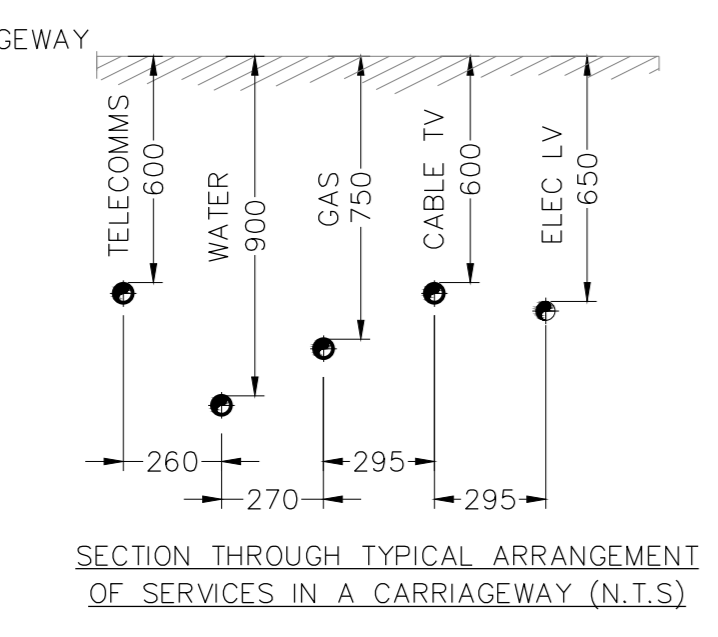
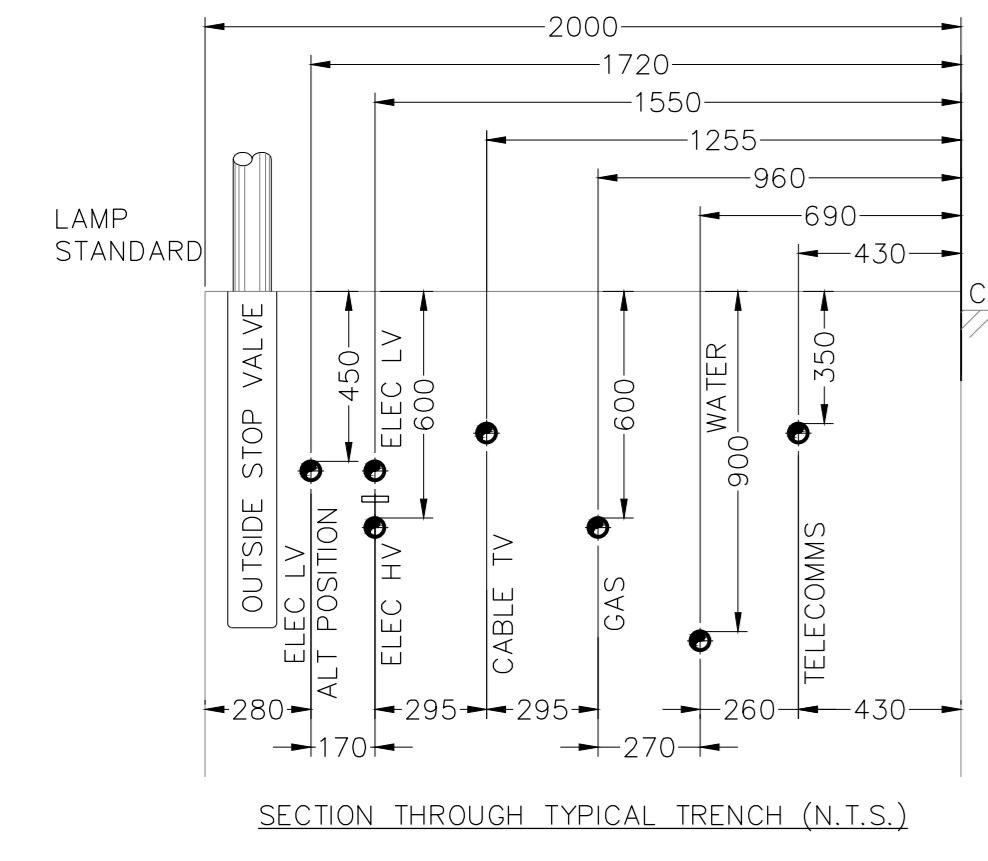

- LEGEND:**
- MCW — PROPOSED SUPPLY AUTHORITY PIPEWORK
  - GAS — PROPOSED GAS SUPPLY
  - GAS — SERVICE TO BE DUCTED FOR ROAD CROSSING
  - HV — PROPOSED ELEC SUPPLY - HIGH VOLTAGE
  - LV — PROPOSED ELEC SUPPLY - LOW VOLTAGE
  - FEEDER PILLAR
  - LV LINK BOX
  - LV POC
  - BT BT SUPPLY
  - BT SERVICE TO BE DUCTED FOR ROAD CROSSING
  - LOCATION OF BT JOINT BOX
  - WASH OUT
  - WATER METER
  - FIRE HYDRANT
  - DUCT ROAD CROSSING 1250 RIGIDUCT 450 BGL

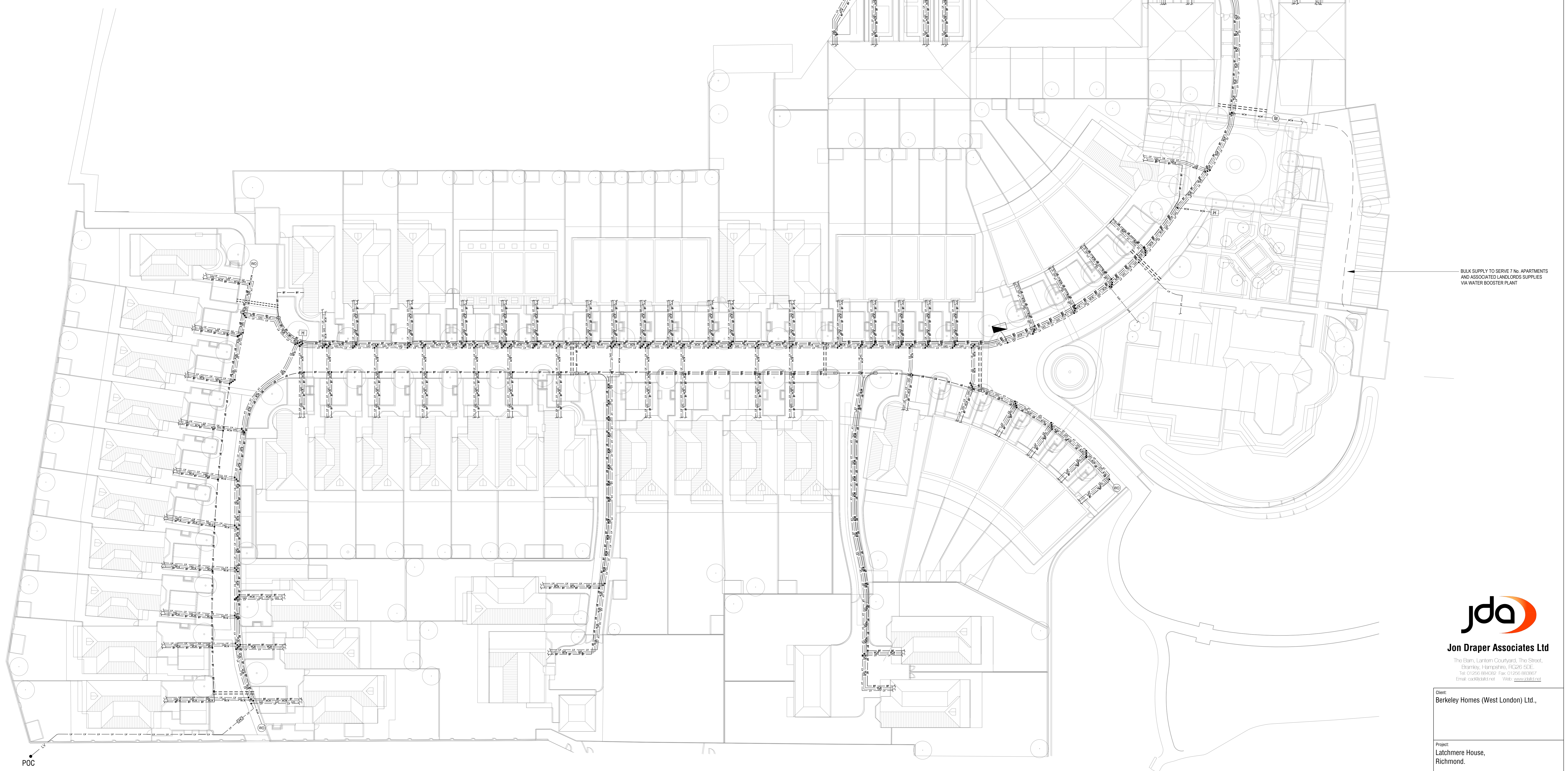

**Jon Draper Associates Ltd**  
The Barn, Luram Courtyard, The Street,  
Epsom, Hampshire, RG20 0DE.  
Tel: 01256 884252 Fax: 01256 883907  
Email: cda@jda.net Web: www.jda.net

Client:  
Berkeley Homes (West London) Ltd.,

Project:  
Latchmere House,  
Richmond.

Title:  
SITE SERVICES  
COMBINED PLAN

Date:  
November 2015

Drawn:  
LJB

Checked:  
LJB

Scale @ A4:  
1:250

Xref:  
X\_Latchmere Masterplan Roof\_23\_11\_15\_X\_Base 05\_23\_11\_15

Drawing Status:  
PRELIMINARY

Drawing Number:  
D1258/IF/600

Rev:  
P3