

EXISTING INFORMATION PROVIDED BY CLIENT

ALL WORKS TO BE IN ACCORDANCE WITH CURRENT BUILDING REGULATIONS AND TO BE READ AND CONSTRUCTED IN CONJUNCTION WITH A SCHEDULE OF WORKS DOCUMENT AND STRUCTURAL ENGINEER'S INFORMATION

ALL DEMOLITION TO BE APPROVED BY STRUCTURAL ENGINEER PRIOR TO COMMENCEMENT

ALL DIMENSIONS, EXISTING LEVELS, DRAIN RUNS AND SITE CONDITIONS TO BE VERIFIED ON SITE BY CONTRACTOR PRIOR TO CONSTRUCTION, AND ANY DISCREPANCIES MADE KNOWN

RE-ROUTING OF EXISTING AND RUNNING OF NEW DRAINAGE TO BE TO CONTRACTOR'S DESIGN

DRAWINGS ARE FOR PLANNING PURPOSES ONLY AND ARE NOT ISSUED FOR CONSTRUCTION

COPYRIGHT FLOWER MICHELIN LLP 2017 ©

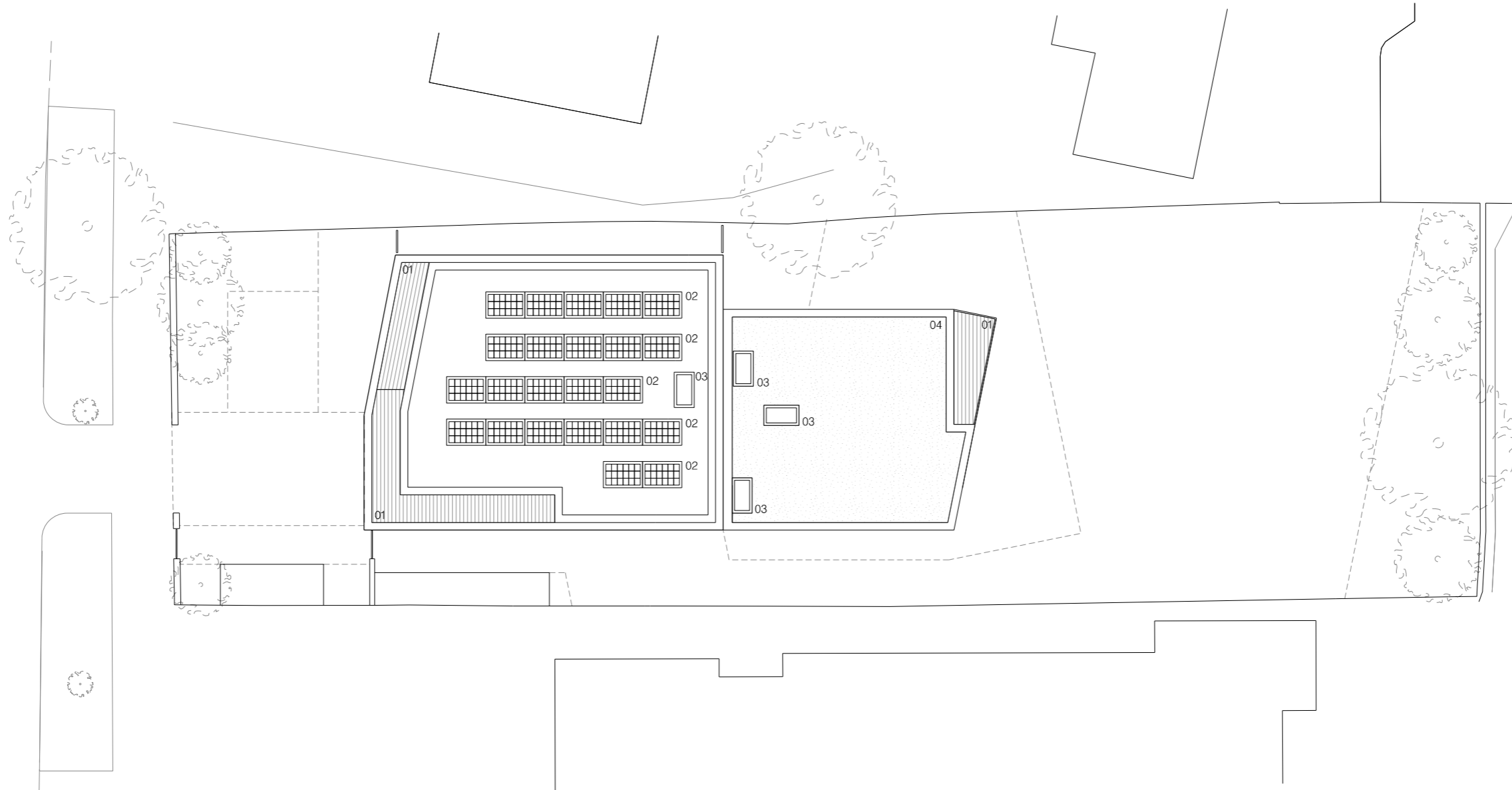

- 01 BALCONY BELOW
- 02 PHOTOVOLTAIC PANELS
- 03 ROOFLIGHT
- 04 SEDUM ROOF LAID TO FALLS

Rev. C Drawing revised to Case Officer comments.

Rev. B Drawing revised to Case Officer comments.

Rev. A Drawing revised to show PV panels to roof

