

**FOUL WATER**

- SOIL & VENT PIPE (SVP)
- KITCHEN SINK (KSW)
- TOILET (WC)
- WASH HAND BASIN (WHB)
- AIR ADMITTANCE VALVE
- GULLY
- GULLY CONCRETE ENCASED
- FOUL GULLY (TRAPPED)
- SHALLOW ACCESS CHAMBER
- SMALL INSPECTION CHAMBER (SEE COMBINATION)
- MEDIUM INSPECTION CHAMBER WITH BACKDROP
- MEDIUM INSPECTION CHAMBER (SEE COMBINATION)
- ADOPTABLE FOUL MANHOLE

**SURFACE WATER**

- RAINWATER DOWNPIPE (RWP)
- SMALL INSPECTION CHAMBER (SEE COMBINATION)
- MEDIUM INSPECTION CHAMBER (SEE COMBINATION)
- CATCHPIT INSPECTION CHAMBER
- 'PRIVATE DRIVE' GULLY
- 'PRIVATE ROAD' GULLY
- RODDING POINT
- CONCRETE PROTECTION TO PIPE
- PRIVATE STORM WATER MANHOLE (SEE MANHOLE SCHEDULES)
- MEDIUM INSPECTION CHAMBER WITH BACKDROP
- ADOPTABLE STORM MANHOLE

**'OSMA' POLYPROPYLENE INSPECTION CHAMBERS**

(ref A) ← 250 DIAMETER, MAXIMUM 0.9m DEEP. 100# MAIN CHANNEL, 100# CONNECTIONS. 'OSMA' REF. 4D.960

(ref B) ← 450 DIAMETER, MAXIMUM 1.2m DEEP. 100# MAIN CHANNEL, 100# CONNECTIONS. 'OSMA' REF. 4D.922

(ref C) ← 450 DIAMETER, MAXIMUM 1.2m DEEP. 150# MAIN CHANNEL, 100# CONNECTIONS. 'OSMA' REF. 6UR.929

(ref D) ← 450 DIAMETER, MAXIMUM 1.2m DEEP. 150# MAIN CHANNEL, 150# CONNECTIONS. 'OSMA' REF. 6UR.928

(ref E) ← 460 DIAMETER, MAXIMUM 3.0m DEEP. 160# MAIN CHANNEL, 160# CONNECTIONS & 110# CONNECTIONS

(ref F) ← 600 DIAMETER, MAXIMUM 3.0m DEEP. 225/300# MAIN CHANNEL, 160# CONNECTIONS

NOTE: REF E, F & G MUST BE FITTED WITH SCREWED DOWN SEALED COVER WITH A NON MAIN ENTRY ACCESS

NOTE THAT THE USE OF TAPERS MAY BE NECESSARY AT SOME CHAMBERS TO FACILITATE THE USE OF STANDARD POLYPROPYLENE CHAMBERS.

• SVP DENOTES CONNECTION TO BE VENTED TO AIR

**GENERAL NOTES**

1. THIS DRAWING IS TO BE READ IN CONJUNCTION WITH THE ARCHITECTS, SPECIALISTS AND ENGINEERS DRAWINGS AND SPECIFICATIONS. ANY DISCREPANCIES ARE TO BE REPORTED TO THE ARCHITECT/ENGINEER IMMEDIATELY.

**AQUACELL CELLULAR SOAKAWAY DETAILS**

- SK1 - 27m x 2.5m x 0.8m DEEP = 54m<sup>3</sup>
- SK2 - 14m x 2m x 0.8m DEEP = 22.4m<sup>3</sup>
- SK3 - 13m x 2m x 0.8m DEEP = 20.8m<sup>3</sup>
- SK4 - 14m x 2m x 0.8m DEEP = 22.4m<sup>3</sup>
- SK5 - 20m x 2.5m x 0.8m DEEP = 40m<sup>3</sup>
- SK6 - 12m x 3m x 0.8m DEEP = 28.8m<sup>3</sup>
- SK7 - 6m x 1m x 0.8m DEEP = 4.8m<sup>3</sup>
- SK8 - 13m x 2m x 0.8m DEEP = 20.8m<sup>3</sup>
- SK9 - 12m x 2m x 0.8m DEEP = 19.2m<sup>3</sup>
- SK10 - 19m x 1.5m x 0.8m DEEP = 22.8m<sup>3</sup>
- SK11 - 8m x 2m x 0.8m DEEP = 12.8m<sup>3</sup>
- SK12 - 13m x 2m x 0.8m DEEP = 20.8m<sup>3</sup>
- HSK1 - 200m<sup>2</sup> x 1.2m DEEP = 240m<sup>3</sup>
- HSK2 - 11m x 10m x 1.2m DEEP = 132m<sup>3</sup>

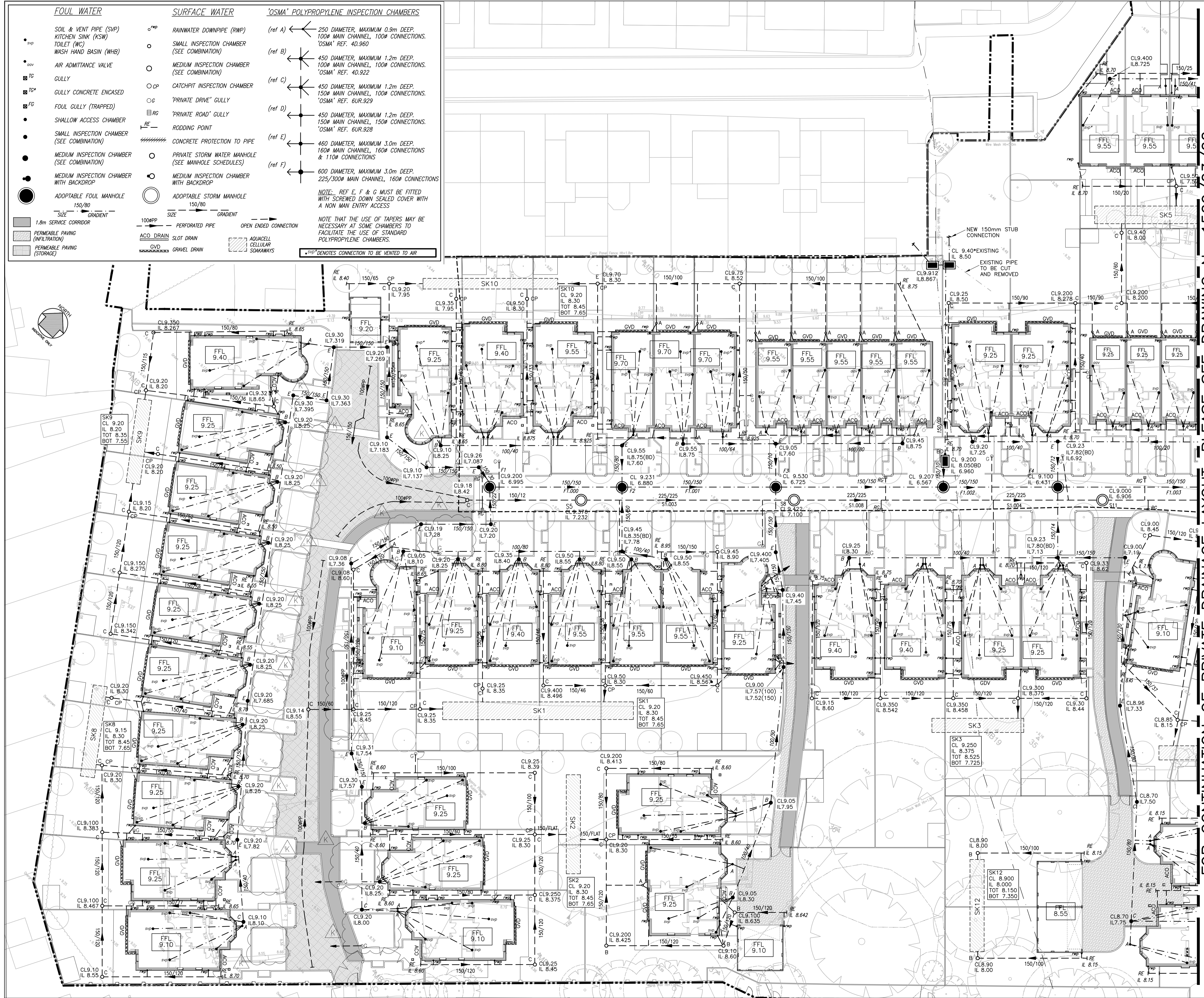
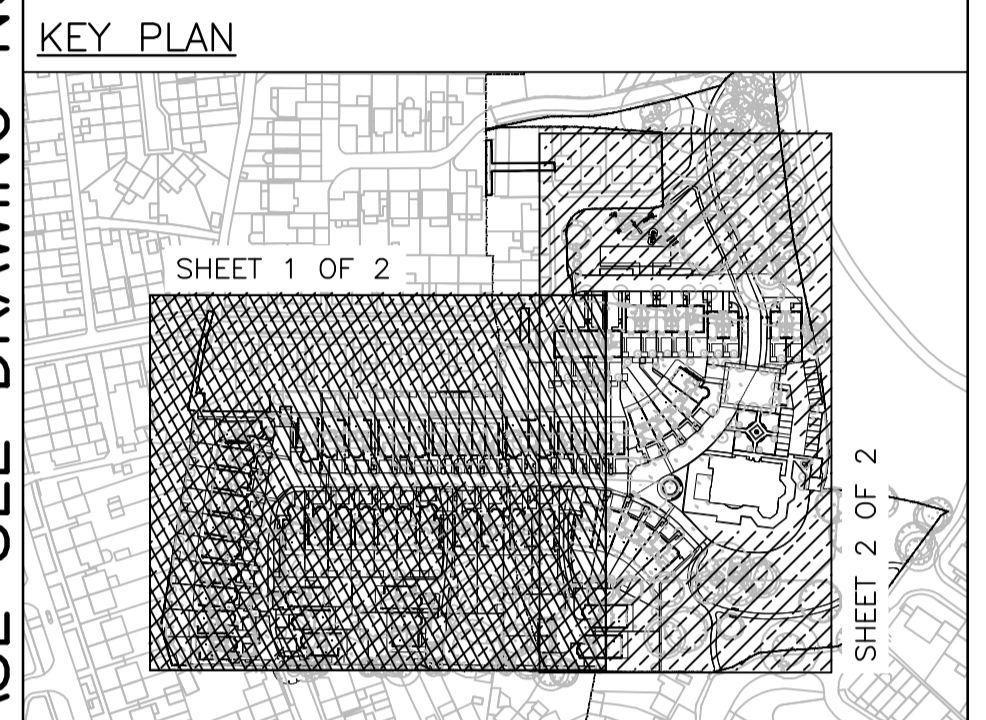

**REVISIONS**

Rev	Date	Description	Drawn & Checked
K	28.07.17	PERMEABLE PAVING AREAS AMENDED	DM SC
J	16.03.17	DRAINAGE AMENDED TO AVOID HOUSE FOUNDATION	DM JCU
H	05.01.17	DRAINAGE ADDED TO COLLECT LATCHMERE CLOSE EXISTING UNITS	AZA SC
G	06.12.16	PHASE 2 BUILDING POSITIONS & ROAD ALIGNMENT AMENDED. PERMEABLE PAVING AREA UPDATED. DRAINAGE LAYOUT UPDATED TO SUIT	DM SC
F	29.09.16	IN ABEYANCE NOTE ADDED	DM SC
E	05.09.16	STORM NETWORK ADDED. DRAINAGE UPDATED TO LATEST ARCH MODEL	AZ/RM SC
D	06.07.16	HOUSE TYPE E3 UPDATED. NOTES AMENDED	DM/AZ SC
C	06.06.16	TENDER ISSUE REMOVED	DM SC
B	27.05.16	DRAINAGE LAYOUT REVISED FOR PHASE 1	RM JCU
A	14.03.16	SLOT DRAINS ADDED TO ALL FRONT & REAR ENTRANCES (NOT CLOUDED FOR CLARITY)	DM SC

Revisions: 05.02.16 FIRST ISSUE DM SC

**LATCHMERE HOUSE**

Title

**PRIVATE DRAINAGE LAYOUT**

SHEET 1 OF 2

Client

**BERKELEY HOMES (WEST LONDON) LIMITED**

Architect

**BROOKES ARCHITECTS**

**RLT**

RLT ENGINEERING CONSULTANTS LTD  
 CIVIL AND STRUCTURAL CONSULTING ENGINEERS  
 2 ST PETER'S COURT  
 COLCHESTER, ESSEX, CO1 1WG  
 T: 01206 768655  
 F: 01206 768656  
 E: email@rltengcon.co.uk

ISO 9001 REGISTERED FIRM

FOR CONTINUATION OF PRIVATE DRAINAGE LAYOUT, PLEASE SEE DRAWING No 1509/03/02