

PLAN A

SEE PLAN A FOR CONTINUATION

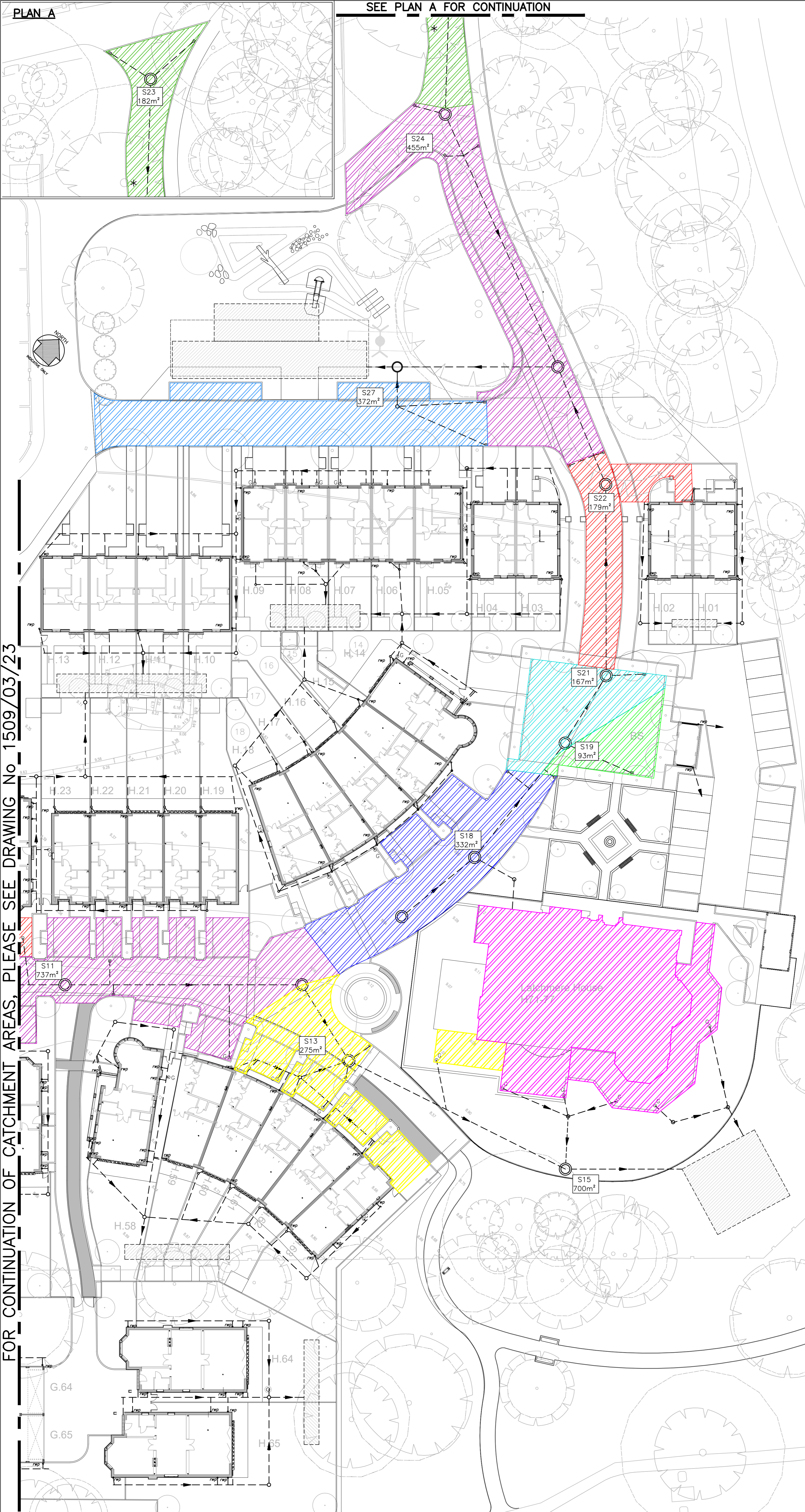

IMPERMEABLE AREAS (ha)	
MH S4	0.096
MH S5	0.005
MH S8	0.020
MH S11	0.073
MH S13	0.027
MH S15	0.070
MH S18	0.032
MH S19	0.009
MH S21	0.017
MH S22	0.018
MH S23	0.018
MH S24	0.046
MH S27	0.037
TOTAL IMPERMEABLE AREA = 0.468ha	

FOR CONTINUATION OF CATCHMENT AREAS, PLEASE SEE DRAWING No 1509/03/23

DO NOT SCALE HARD COPIES OF THIS DRAWING OR INTERPOLATE CAD VISIONS. ONLY STATED DIMENSIONS AND COORDINATES ARE TO BE RELIED UPON. COPYRIGHT RESERVED

KEY PLAN

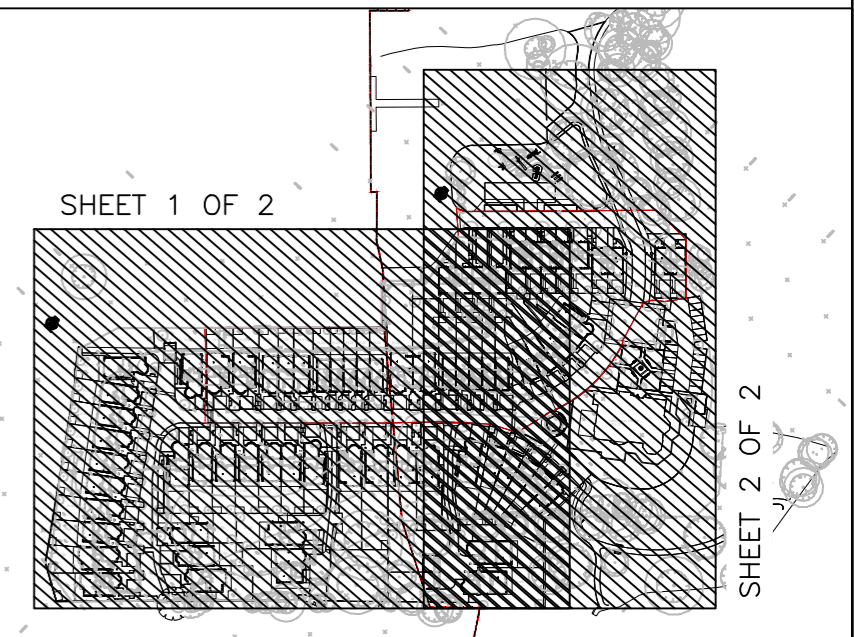

LATEST REVISIONS ARE 'TAGGED' WITH THIS INDICATOR. HOWEVER, ALL USERS OF THIS DRAWING MUST SATISFY THEMSELVES OF ALL REVISIONS TO ANY PREVIOUS ISSUES, BY COMPARISON OF THIS DRAWING AGAINST OTHER ISSUES, AS IT CANNOT BE GUARANTEED THAT EVERY ITEM OF REVISION HAS BEEN 'TAGGED'.

Rev	Date	Description	Drawn & Checked	Checked
Revisions				
Date	28.07.17	FIRST ISSUE	AHA	SCO
Project	LATCHMERE HOUSE			

Title

**CATCHMENT AREAS**  
SHEET 2 OF 2

Client

**BERKELEY HOMES**  
(WEST LONDON) LIMITED

Architect

**BROOKES ARCHITECTS**

RLT

RLT ENGINEERING CONSULTANTS LTD  
 CIVIL AND STRUCTURAL CONSULTING ENGINEERS  
 2 ST PETER'S COURT  
 MIDDLEBOROUGH  
 COLCHESTER, ESSEX, CO1 1WD  
 T: 01206 768655  
 F: 01206 768656  
 E: email@rltengcon.co.uk

ISO 9001  
REGISTERED FIRM