

WEST PLAYING FIELDS

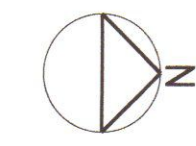

08/1760/OUT

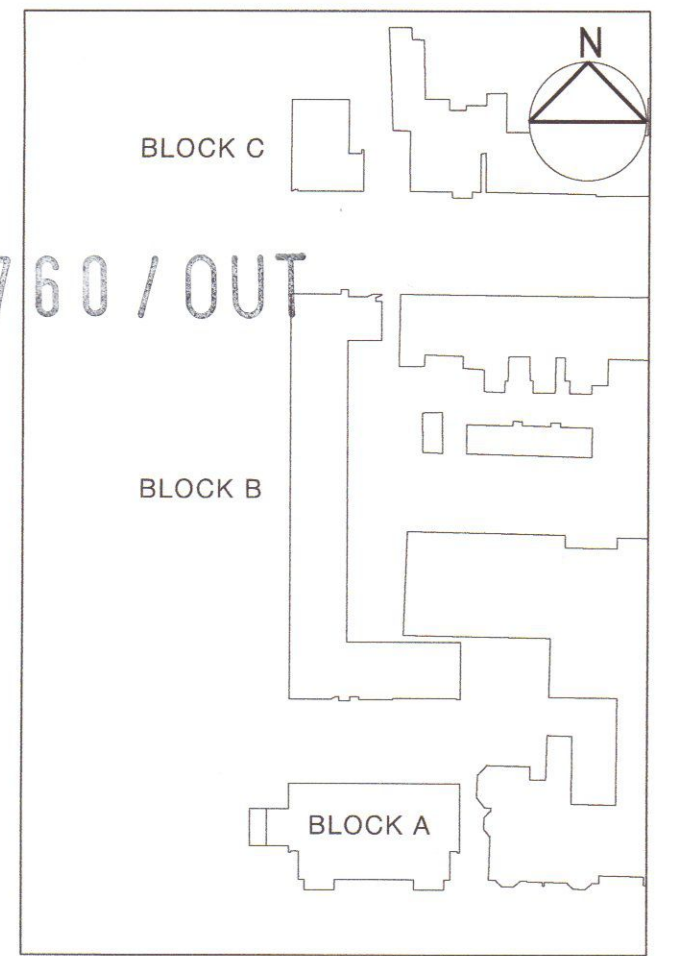

Study Bedrooms	16
Studio Apartments	4
1 Bedroom Apartment	2
2 Bedroom Apartment	5
3 Bedroom Apartment	6
Car Parking Spaces	25
Secure Cycle Storage	54

- Trees Existing Retained
- Trees Existing Removed in detailed submission
- Trees Proposed Relocated
- Trees Proposed
- Landscaping Proposed

SPS DRIVEWAY

LONSDALE ROAD

GLENTHAM ROAD

LILLIAN ROAD

RECEIVED
21 JUL 2008
PLANNING

PL6 18.07.08	SS	Block A lightwell amendments	pt
PL6 15.04.08	SS	Lightwell amendments	pt
PL4 26.03.08	SS	Consultation amendments	pt
PL3 05.03.08	SS	Block A+B+C amendments	pt
PL2 22.08.07	RNH	Block B amendments	pt
PL1 31.07.07	RNH	Block A and B amendments	pt
PL 11.05.07	LB	Planning submission	pt

Patel Taylor
 53 Rowstone Street
 London EC1V 2ND
 Tel: +44 (0) 20 7278 2323
 Fax: +44 (0) 20 7278 6242
 pta@pateltaylor.co.uk

Architecture Landscape Urban Design

Client
ST. PAUL'S SCHOOL

Project
ST. PAUL'S SCHOOL RESIDENTIAL

Title
GROUND FLOOR PLAN SHOWING TREES
RETAINED, REMOVED, RELOCATED AND
PROPOSED

Job No 317A Drwg No PSD 20.008 Rev PL6

Scale 1:200 @ A1 Date 29.01.07 Sheet A1

Drawn lb Checked pt

Do not scale. All dimensions to be checked on site and errors to be reported to architect. Illustrated material subject to copyright.