

08/1760/OUT

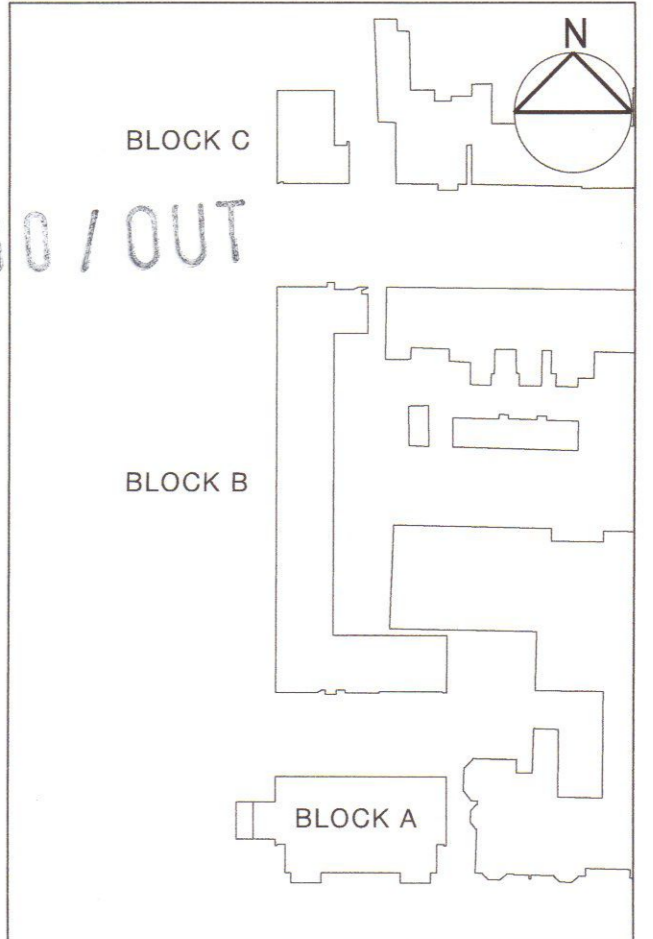

Study Bedrooms	16
Studio Apartments	4
1 Bedroom Apartment	2
2 Bedroom Apartment	5
3 Bedroom Apartment	6
Car Parking Spaces	25
Secure Cycle Storage	54

Application Site Boundary for proposal submitted in detail

Conservation Area

RECEIVED
21 JUL 2008
PLANNING

PL5	18.07.08	SS	Block A lightwell revision	PT
PL4	26.03.08	SS	Consultation Amendments	PT
PL3	05.03.08	SS	Block A+B+C amendments	PT
PL2	22.08.07	RNH	Block B amendments	PT
PL1	31.07.07	RNH	Block A and B amendments	PT
PL	09.05.07	LB	Planning Submission	PT
P3	24.01.07	RNH	Block A and block B amendments	PT
P2	07.12.06	RNH	Block A amendments	PT

Patel Taylor
53 Rawstone Street
London EC1V 7JQ
Tel +44 (0) 20 7278 2323
Fax +44 (0) 20 7278 5242
ps@pateltaylor.co.uk

Architecture Landscape Urban Design

Client
ST. PAUL'S SCHOOL

Project
ST. PAUL'S SCHOOL RESIDENTIAL

Title
SITE PLAN

Job No	317A	Drwg No	NoPSD 20.100	Rev	PL5
Scale	1:1000	Date	18.08.05	Sheet	A1
Drawn	JB	Checked			pt

Do not scale. All dimensions to be checked on site and errors to be reported to architect. Illustrated material subject to copyright.