

Rev	Date	By	Amendment
A	27/05/04	va	Extent of staircase to be demolished amended Fire escape added in the rear of reprographics room Position of anti theft barrier and turn stile changed Glazings and doors amended Servery/computer room/store amended
B	04/06/04	va	Extent of staircase to be demolished amended Servery/computer room/store amended New fire escape in the LRC added
C	07/07/04	va	Re draw incorporating comments from planning and conservation departments
D	16/12/04	JB	Re draw incorporating client comments
E	17/12/04	JB	Re draw incorporating client comments
F	11/04/05	MH	Re draw incorporating new design
G	25/04/05	MH	Drawing updated
H	05/05/05	MH	Panel with plasterboard fixed to internal wall facing exterior spaces
I	21/04/06	MH	Raised floor on ground floor changed from timber to metal deck.

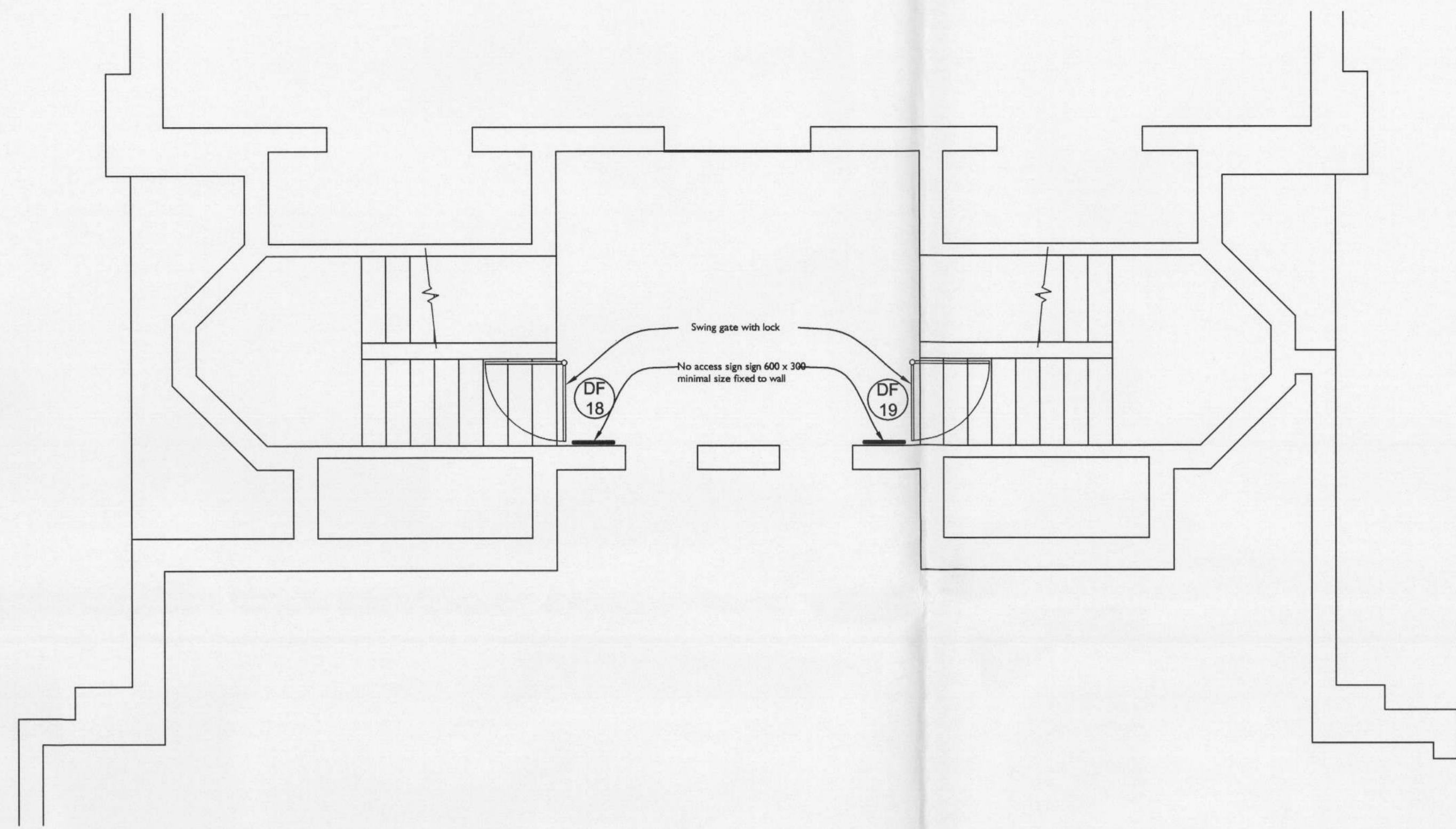

SECOND FLOOR PLAN

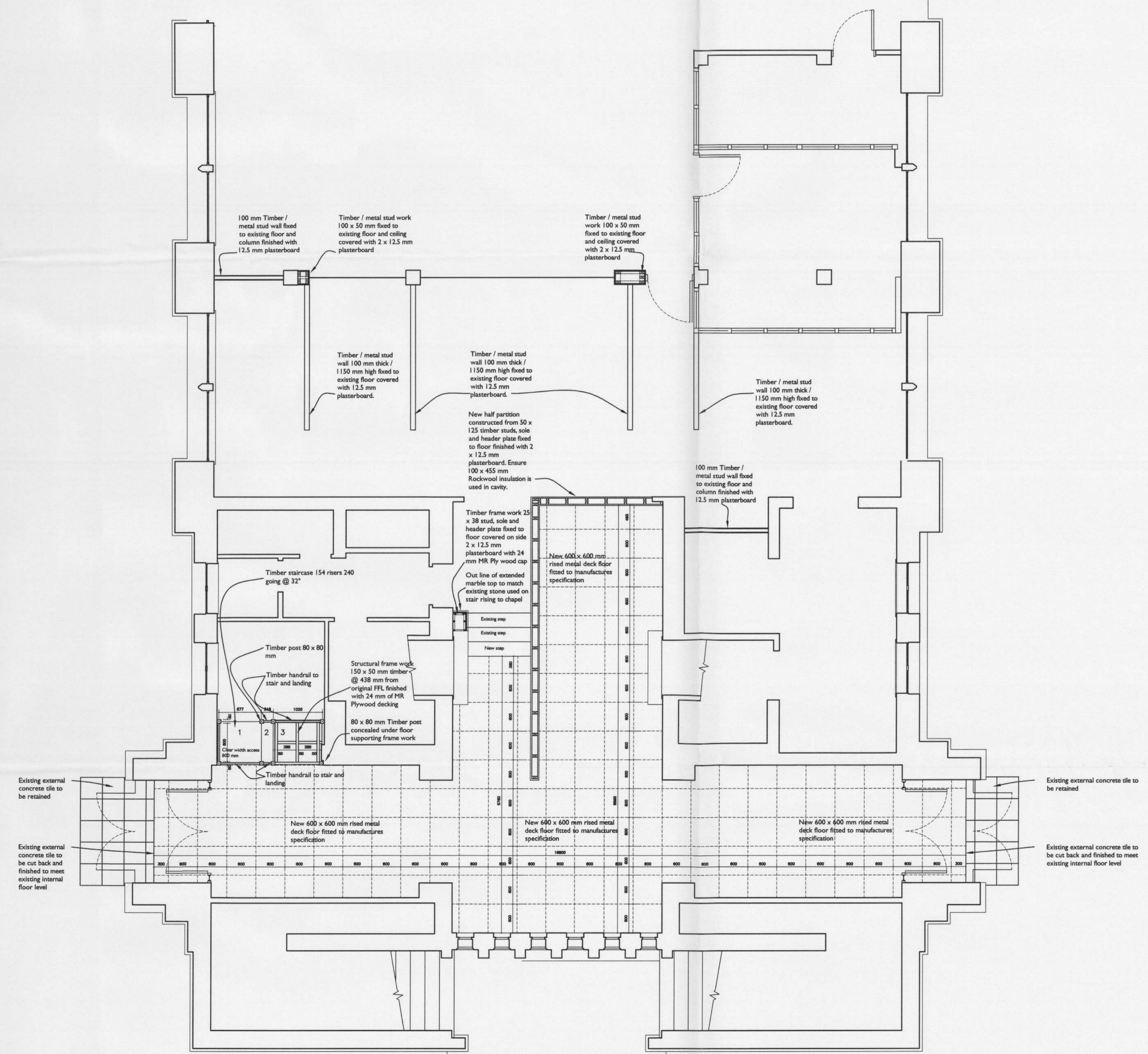

GROUND FLOOR RAISED TIMBER FLOOR

LEGEND

06/1368/LBC



Harwell London Brighton Cardiff Rochdale  
 Bristol Exeter CapeTown Liverpool Dartford

NIGHTINGALE architects  
 associate: ■■■■■

Block A Littlebrook Business Park  
 Dartford, Kent.  
 DN1 9PZ  
 Tel: +44 (0)13 2262 7888  
 Fax: +44 (0)13 2220 9155  
 Email: darford@nightingaleassociates.com

Client: St. MARY'S COLLEGE TWICKENHAM

Project: ALTERATIONS TO CHAPEL UNDERCROFT AND LRC

Drawing: PROPOSED RAISED GROUND FLOOR SECOND FLOOR ACCESS GATES

Date: May2004 Scale: 1:50@A0  
 Drawn by: MH  
 Checked by:

Project No: 03767 Drawing No: L(0)05 Revision: I

FOR THE ARCHITECT  
 RICHMOND UPON THAMES  
 D & M J 2006  
 PLANNING