

06/16/26/LBC

RECEIVED
17 JUN 2006
PLANNING
RECONSTRUCTION

ALTERATION
REINCORPORATION
STRIP OUT

DATE	REVISION	COMMENT	AP	SG
08.06.06		LISTED BUILDING CONSENT		

THIS DRAWING IS COPYRIGHT PETER INSKIP + PETER JENKINS ARCHITECTS LTD AND MUST NOT BE USED FOR PURPOSES OTHER THAN IN RELATION TO THIS PROJECT UNLESS AUTHORIZED BY THE PRACTICE. THIS DRAWING MUST NOT BE SCALED - WORK TO FIGURED DIMENSIONS ONLY. THIS DRAWING MUST BE READ IN CONJUNCTION WITH THE SPECIFICATION.

STRAWBERRY HILL HOUSE

TITLE
GROUND FLOOR AS EXISTING WITH STRIP OUT

DWG NO SHT GA 010
SCALE 1 : 100 @ A2
DATE FEB 2006

H:\Strawberry Hill\Strawberry Hill Phase II\General Management\EXISTING\Plan\GHT GA 010.dgn

PETER INSKIP + PETER JENKINS ARCHITECTS LTD
19 - 23 WHITE LION STREET LONDON N1 9PD
TELEPHONE 020 7833 4002 FAX 020 7278 5343

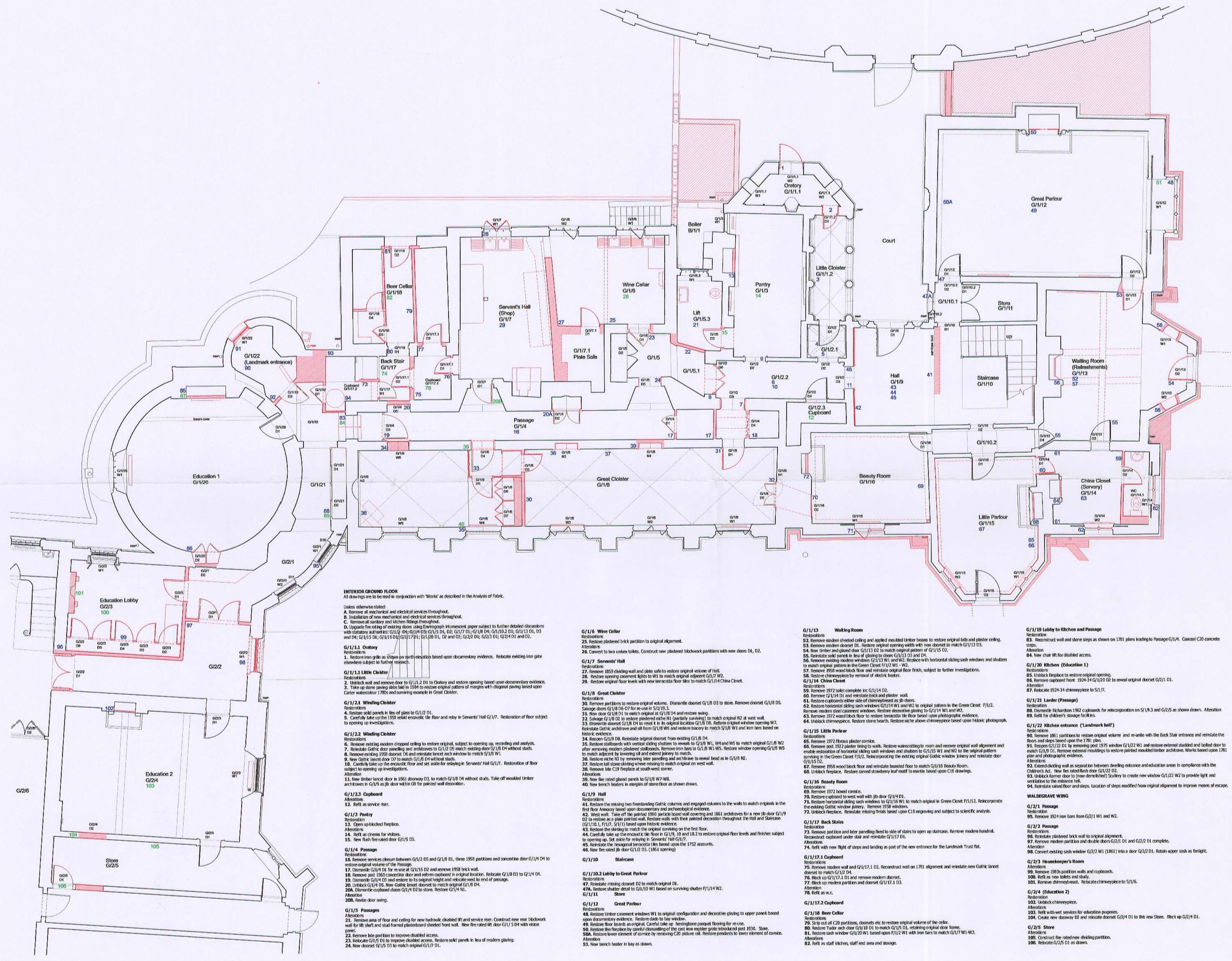

INTERIOR GROUND FLOOR

All drawings are to be read in conjunction with 'Works' as described in the Analysis of Fabric.

- Unless otherwise stated:
 - Remove all mechanical and electrical services throughout.
 - Installation of new mechanical and electrical services throughout.
 - Remove all sanitary and kitchen fittings throughout.
 - Upgrade the ceiling of each key space using Eternograph vitreous enamel paper subject to further detailed discussions with statutory authorities: G/1/2, D4; G/1/4 D3; G/1/5 DL, D2, G/1/7 D1, G/1/8 D4; G/1/9 D2, D1; G/1/13 DL, D3 and D4; G/1/15 D1; G/1/16 D1; G/1/17 D1; G/1/18 D1, D2 and D3; G/2/2 D1; G/2/3 D1; G/2/4 D1 and D2.

G/1/1.1 Oratory
Restoration:
1. Restore iron grille as shown on north elevation based on documentary evidence. Rebate existing iron grille elsewhere subject to further research.

G/1/1.1 Little Cloister
Restoration:
2. Unblock wall and remove door to G/1/1.2 D1 to Oratory and restore opening based upon documentary evidence.
3. Take up stone paving slabs laid in 1984 to restore original pattern of margins with diagonal paving based upon Carter watercolour 1780s and surviving concrete in Great Cloister.

G/1/2.1 Window Cloister
Restoration:
4. Restore solid panels in lieu of glass to G/1/2 D1.
5. Carefully take up the 1959 retail enclosure tie floor and relay in Servant's Hall G/1/7. Restoration of floor subject to opening up investigations.

G/1/2.2 Window Cloister
Restoration:
6. Remove existing modern dropped ceiling to restore original, subject to opening up, recording and analysis.
7. Reinstall Gothic door paneling and architraves to G/1/2 D2 to match existing door G/1/8 D4 without studs.
8. Remove existing 1959 doorset D5 and restate lancet each window to match S/1/8 W1.
9. New Gothic lancet door D7 to match G/1/8 D4 without studs.
10. Carefully take up the concrete floor and set aside for relaying in Servant's Hall G/1/7. Restoration of floor subject to opening up investigations.

G/1/2.3 Cupboard
Restoration:
11. Restore iron grille as shown on north elevation based on documentary evidence. Rebate existing iron grille elsewhere subject to further research.

G/1/3 Pantry
Restoration:
12. Refit as service riser.

G/1/4 Passage
Restoration:
13. Open up blocked fireplace.
14. Refit as chimney for visitors.
15. New flush fire-rated door G/1/5 D3.

G/1/5 Passages
Restoration:
16. Remove services (skirting between G/1/2 D5 and G/1/8 D1, three 1958 partitions and concrete door G/1/4 D4) to restore original volume of the Passage.
17. Demolish G/1/4 D1 for re-use at G/1/16 D2 and remove 1958 brick wall.
18. Remove post-1960 concrete door and reform cupboard in original location. Rebate G/1/8 D3 to G/1/4 D1.
19. Demolish G/1/4 D2 and restore to its original height and rebate wood to end of passage.
20. Unblock G/1/4 D5. New Gothic lancet doorset to match original G/1/8 D4.
21. Demolish cupboard doors G/1/4 D2 to stone. Restore G/1/4 W1.
22. Refit door swing.

G/1/6 Beer Cellar
Restoration:
23. Reinstall Gothic door paneling and architraves to G/1/6 D2 to match existing door G/1/8 D4 without studs.
24. New doorset G/1/6 D3 to match original G/1/7 D1.

G/1/7 Servant's Hall
Restoration:
25. Restore plastered brick partition to original alignment.
26. Convert to two unisex toilets. Construct new plastered brickwork partitions with new doors D1, D2.

G/1/8 Great Cloister
Restoration:
27. Remove partitions to restore original volume. Demolish doorset G/1/8 D3 to stone. Remove doorset G/1/8 D5. Salvage door G/1/8 D6 for re-use in S/1/9 S1.
28. Remove partitions with vertical sliding shutters to reveal to G/1/8 W1, W4 and W5 to match original G/1/8 W2.
29. New door G/1/8 D1 to match original at G/1/8 D4 and restore swing.
30. Salvage G/1/8 D2 to restore plastered niche N1 (partially surviving) to match original N2 at west wall.
31. Demolish doorset G/1/8 D4 to reveal it in its original location G/1/8 D4. Rebuild original window opening W7. Reinstall Gothic architrave and sill from G/1/8 W6 and restore tracery to match S/1/8 W1 and iron bars based on historic evidence.
32. Reopen G/1/8 D8. Reinstall original doorset from existing G/1/8 D4.
33. Restore skilboards with vertical sliding shutters to reveal to G/1/8 W1, W4 and W5 to match original G/1/8 W2 to match existing by lowering sill and extend primery to match.
34. Restore niche N3 by removing later paneling and architrave to reveal head as in G/1/8 W2.
35. Restore tall stone skilboard when missing to match original on west wall.
36. Remove late C19 fireplace at south-west corner.
37. New fire rated glazed panels to G/1/8 W7-W8.
38. New trench leaders in margins of stone floor as shown down.

G/1/9 Hall
Restoration:
39. Restore the missing two freestanding Gothic columns and engaged columns to the walls to match originals in the first floor Annexe based upon documentary and archaeological evidence.
40. Block walls. Take off the painted 1960s partition wall covering and 1861 architraves for a new jib door G/1/9 D2 to restore as a plain partition wall. Restore walls with their painted decoration throughout the Hall and Staircase G/1/10, F/1/1, F/1/11 based upon historic evidence.
41. Restore the skirting to match the original surviving on the first floor.
42. Carefully take up the concrete tie floor in G/1/9, 10 and 12 to restore original floor levels and finishes subject to opening up. Set aside for relaying in Servant's Hall G/1/7.
43. Reinstall the hexagonal terracotta tiles based upon the 1752 accounts.
44. New fire rated jib door G/1/9 D2. (1861 opening).

G/1/10 Staircase
Restoration:
45. Restore iron handrail to Great Parlour.
46. Reinstall missing doorset D2 to match original D1.
47. Restore shutter detail to G/1/10 W1 based on surviving shutter F/1/4 W2.

G/1/11 Store
Restoration:
48. Refit as w.c.

G/1/12 Beer Cellar
Restoration:
49. Reinstall timber casement window W1 to original configuration and decorative glazing to upper panel based upon documentary evidence. Restore dado to bay window.
50. Restore floor beams as original. Careful take up hemingstone pavement flooring for re-use.
51. Restore the fireplace by careful dismantling of the post-war register grate hindering post-1930. Stone.
52. Restore lower element of cornice by removing C20 picture rail. Restore pendants to lower element of cornice.
53. New trench leaders in bay as shown.

G/1/13 Waiting Room
Restoration:
54. Remove modern sheeted ceiling and applied moulded timber beams to restore original lath and plaster ceiling.
55. Remove modern doorset D1. Restore original opening width with new doorset to match G/1/13 D3.
56. New timber and glazed floor G/1/13 D2 to match original pattern of G/1/15 D2.
57. Reinstall solid panels in lieu of glazing to doors G/1/13 D3 and D4.
58. Remove existing modern window G/1/13 W1 and W2. Reinstall with horizontal sliding sash windows and shutters to match original pattern in the Green Cloist F/1/2 W1 - W2.
59. Remove 1958 wood block floor and restate original floor finish, subject to further investigations.
60. Restore cupboard either side of chimney breast as jib doors.
61. Restore cupboards either side of chimney breast as jib doors.
62. Remove G/1/14 D1 and restate brick and plaster wall.
63. Restore horizontal sliding sash windows G/1/14 W1 and W2 to original pattern in the Green Cloist F/1/2.
64. Remove modern steel casement windows. Restore decorative glazing to G/1/14 W1 and W2.
65. Remove 1972 wood block floor to restore terracotta tile floor based upon photographic evidence.
66. Unblock fireplace. Restore stone hearth. Restore niche above chimney piece based upon historic photographs.

G/1/15 Little Parlour
Restoration:
67. Remove 1972 toilet complete inc G/1/14 D2.
68. Remove G/1/14 D1 and restate brick and plaster wall.
69. Restore cupboards either side of chimney breast as jib doors.
70. Restore horizontal sliding sash windows G/1/14 W1 and W2 to original pattern in the Green Cloist F/1/2.
71. Remove modern steel casement windows. Restore decorative glazing to G/1/14 W1 and W2.
72. Remove 1972 wood block floor to restore terracotta tile floor based upon photographic evidence.
73. Unblock fireplace. Restore stone hearth. Restore niche above chimney piece based upon historic photographs.

G/1/16 Beauty Room
Restoration:
74. Refit with new light of steps and landing as part of the new entrance for the Landmark Trust flat.

G/1/17 Back Stairs
Restoration:
75. Remove partition and later paneling fixed to side of stairs to open up staircase. Remove modern handrail. Reconstruct upper stair and restate G/1/17 D1.
76. Refit with new light of steps and landing as part of the new entrance for the Landmark Trust flat.

G/1/17.1 Beer Cellar
Restoration:
77. Restore iron handrail to Great Parlour.
78. Refit as w.c.

G/1/17.2 Beer Cellar
Restoration:
79. Remove modern sheeted ceiling and applied moulded timber beams to restore original lath and plaster ceiling.
80. Remove modern doorset D1. Restore original opening width with new doorset to match G/1/17 D3.
81. New timber and glazed floor G/1/17 D2 to match original pattern of G/1/15 D2.
82. Reinstall solid panels in lieu of glazing to doors G/1/17 D3 and D4.
83. Remove existing modern window G/1/17 W1 and W2. Reinstall with horizontal sliding sash windows and shutters to match original pattern in the Green Cloist F/1/2 W1 - W2.
84. Remove 1958 wood block floor and restate original floor finish, subject to further investigations.
85. Restore cupboard either side of chimney breast as jib doors.
86. Restore cupboards either side of chimney breast as jib doors.
87. Restore horizontal sliding sash windows G/1/17 W1 and W2 to original pattern in the Green Cloist F/1/2.
88. Remove modern steel casement windows. Restore decorative glazing to G/1/17 W1 and W2.
89. Remove 1972 wood block floor to restore terracotta tile floor based upon photographic evidence.
90. Unblock fireplace. Restore stone hearth. Restore niche above chimney piece based upon historic photographs.

G/1/19 Lobby to Kitchen and Passage
Restoration:
91. Reconstruct wall and stone steps as shown on 1781 plans leading to Passage G/1/4. Conceal C20 concrete steps.
92. Unblock fireplace to restore original opening.
93. Remove cupboard front 1924-34 G/1/20 D2 to reveal original doorset G/2/1 D1.
94. Unblock fireplace. Restore stone hearth. Restore niche above chimney piece based upon historic photographs.

G/1/20 Kitchen (Education 1)
Restoration:
95. Unblock fireplace to restore original opening.
96. Remove cupboard front 1924-34 G/1/20 D2 to reveal original doorset G/2/1 D1.
97. Reinstall 1924-34 chimney piece to S/1/7.

G/1/21 Larder (Passage)
Restoration:
98. Demolish 18th century 1962 cupboards for reincorporation on S/1/3 D and G/2/5 as shown down. Alteration
99. Refit for children's storage facilities.

G/1/22 Kitchen entrance (Landmark half)
Restoration:
100. Remove 1861 partitions to restore original volume and re-entice with the Back Stair entrance and restate the floor and steps based upon the 1781 plan.
101. Reopen G/1/22 D1 by removing post-1975 window G/1/22 W1 and restore external studded and bolted door to match G/1/9 D1. Remove external mouldings to restore painted moulded timber architrave. Works based upon 1781 plan and photographic evidence.
102. Eased skilboard wall as separator between dwelling entrance and education areas in compliance with the Children's Act. New fire rated flush door G/1/22 D2.
103. Unblock former door to (now demolished) Scullery to create new window G/1/22 W2 to provide light and ventilation to the entrance hall.
104. Reinstall raised floor and steps. Location of steps modified from original alignment to improve means of escape.

WALDEGRAVE WING
Restoration:
105. Remove 1924 iron bars from G/2/1 W1 and W2.

G/2/1 Passage
Restoration:
106. Refit as w.c.

G/2/2 Passage
Restoration:
107. Reinstall plastered brick wall to original alignment.
108. Refit as new toilets and study.
109. Remove chimney breast. Reinstall chimney piece to S/1/6.

G/2/3 Housekeeper's Room
Restoration:
110. Refit with wet services for education purposes.
111. Create new doorway D2 and restate doorset G/2/4 D1 to this new store. Block up G/2/4 D1.

G/2/4 Education 2
Restoration:
112. Unblock chimney piece.
113. Refit with wet services for education purposes.
114. Create new doorway D2 and restate doorset G/2/4 D1 to this new store. Block up G/2/4 D1.

G/2/5 Store
Restoration:
115. Construct fire rated new dividing partition.
116. Rebate G/2/5 D1 as down.