

Lighting - Technical Notes

The proposed external lighting associated with the proposed new buildings, access ways, roadways and landscape will be designed taking note of the required design and regulatory requirements alongside any associated adverse impact on light pollution.

As such, a balanced approach to the project is proposed so as to achieve a high quality light environment for the users and one which minimises any light pollution or nuisance.

Light spillage has and will be considered on surrounding properties to minimise excessive light and impact on receptors.

Light pollution from spill light into the night sky has been considered with zero light output above 90° cut-off.

Adjacent transport routes have been considered and no adverse impact will occur to these.

The lighting design follows the CIBSE - SLL Guidance and Secured by Design principles to assist to minimise crime and vandalism. Any roadway lighting will be designed in accordance with BS 5489 and assessed for compliance.

Lighting will be time clock/daylight link controlled and only operate when required to meet the design needs.

All luminaires will use the LED light sources to minimise energy in use, maximise lamp life and reduce in life maintenance costs.

Colour rendition will be good/very good to ensure any CCTV coverage is clear and visually the landscape and architectural material colours read true. In accordance with BS 5266 Emergency Light Facilities will be integral to luminaires adjacent building escape doors and any designated external escape routes.

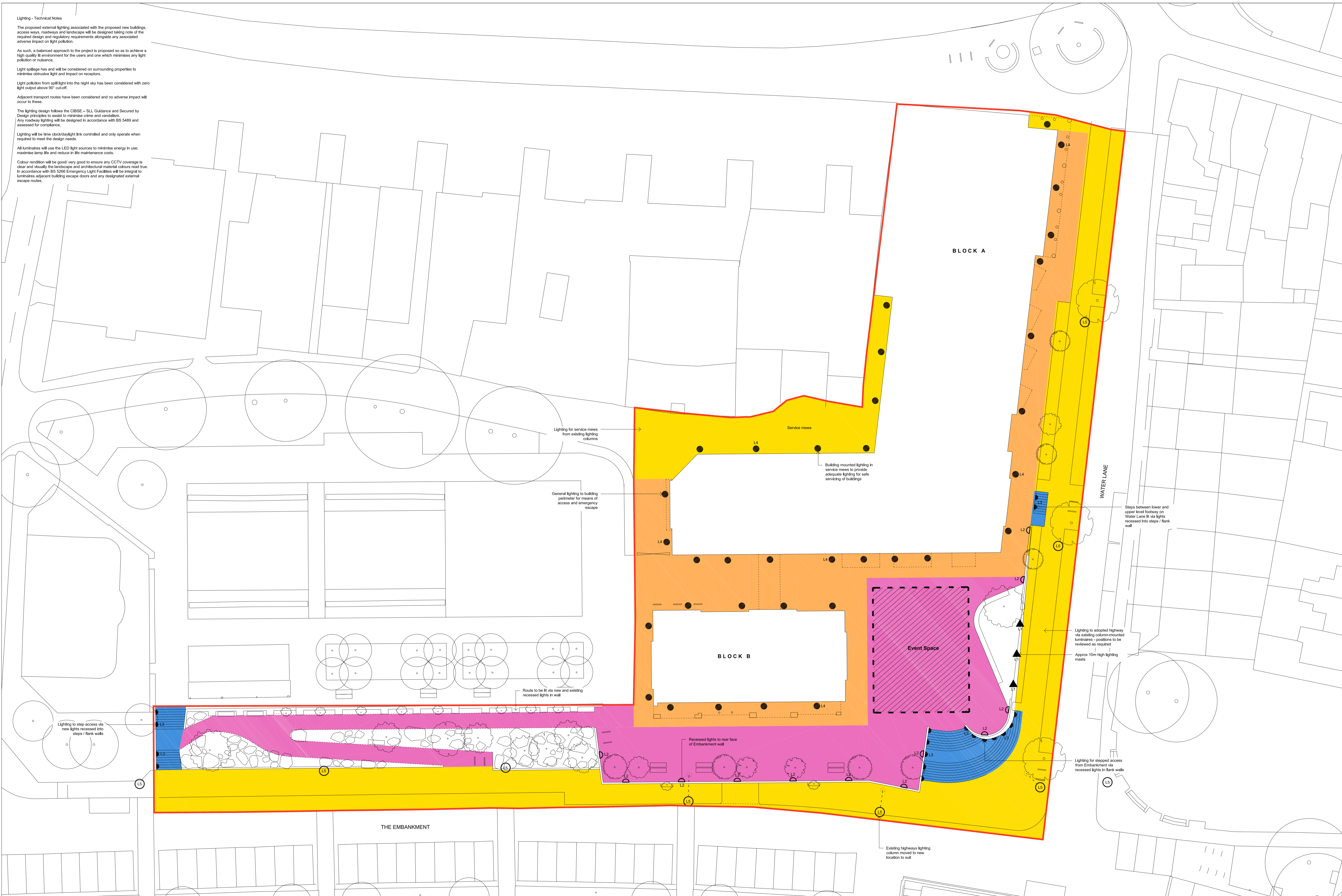

LUC Originator
 43 Chalton Street, London, NW1 1JD
 +44 (0)20 7383 5784
 london@landuse.co.uk
 www.landuse.co.uk

Iss	Date	Description	Dm	Chk
2	171121	for Planning	JDB	EP
1	171112	First Issue	JDB	EP

Notes
 Do not scale from this drawing
 All dimensions are drawn in millimeters
 Drawing & design copyright LUC
 Reproduction of this drawing in whole or in part is prohibited without prior permission.

Key

- Adopted Highway lighting to appropriate standards
- Lighting to steps
- General pedestrian area lighting
- Pedestrian areas

Notes

- Area for event lighting to be lit by switcheable high level lighting
- Approx 9m high event lighting masts, bespoke in corten steel
- Recessed bronze wall luminaire by Bega or similar
- Recessed luminaire for walls and stairs by Bega or similar
- Building mounted luminaire by Bega or similar
- Existing / relocated highways lighting column

Scale @ A1
 1:200

0 1 2 5 10 15

Project / Client
Twickenham Rediscovered Programme
 for London Borough of Richmond Upon Thames

Drawing Title
Lighting Strategy

Status
 for Planning

Job Nr
 7085

Drawing Nr
 LUC-LD PLN 201

Issue
 2