

AS EXISTING

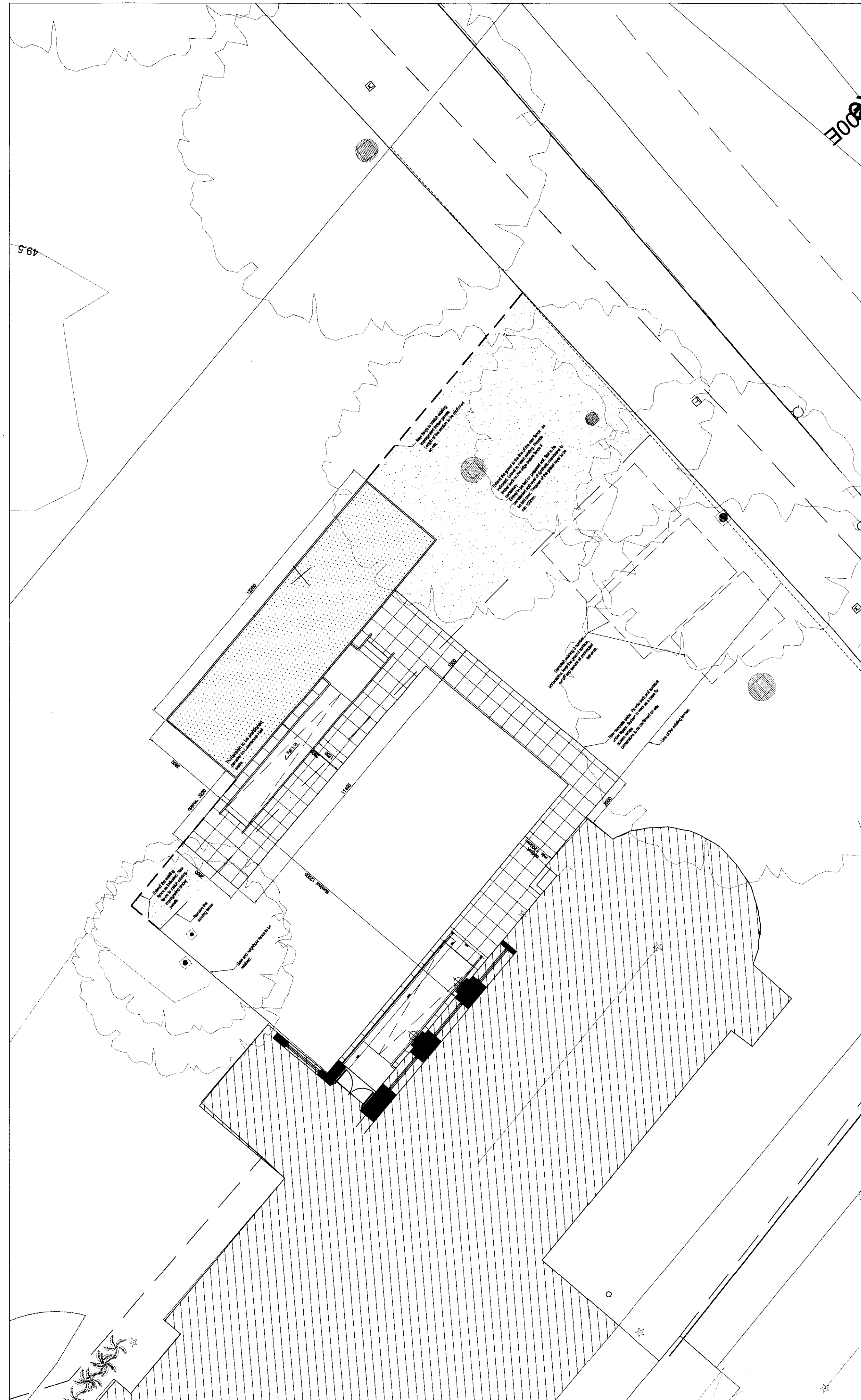

AS PROPOSED

DO NOT SCALE - ASK FOR DIMENSION  
 USE ONLY FOR PURPOSE INDICATED BELOW

1:100 2m 4m 6m 8m 10m  
 1:10 200mm 400mm 600mm 800mm 1000mm  
 1:50 1m 2m 3m 4m 5m  
 1:5 100mm 200mm 300mm 400mm 500mm

SCALE BARS FOR MICROFILM PURPOSES ONLY

- Notes:
1. The indicated position of the portacabin and walkways is an illustration of the existing situation on site.
  2. With regards to the attached Badger Report (point 3.2.) non further movements of the items are envisaged. All additional actions to be carried out with regard to the Badger Report (point 4.0.).
  3. New timber fence to be introduced as indicated on the drawing. All works to be carried out using hand tools.
  4. New plants to the indicated cleared area will be introduced - subject for a separate project.

06/2009/ FUL



ref revision draw checked

Capita Norman + Dawbarn  
 1 Princes Street London WC1V 6DW  
 T +44 (0)20 7421 1480 F +44 (0)20 7421 1461  
 www.cnd.co.uk mail@cnd.co.uk

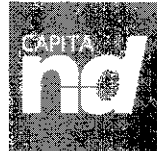

Architects + Engineers

client: West London Mental Health NHS Trust  
 project title: Cassell Hospital  
 Relocation of space from old day unit

drawing title: Temporary Building  
 Proposed & Existing Site Plan

drawn by: SS date: 06.06.06 scale: 1:100 @ A1

checked by: date: authorized by: date:

issue status: design  BoI  construction  record

drawing number: 2346.1/A/050/004

revision:

This drawing may not be used or reproduced without written consent. Copyright design and patents act 1988  
 No dimensions to be scaled from this drawing. Copyright reserved. NDF A11.

X:\Projects\0000\_00\Drawings