

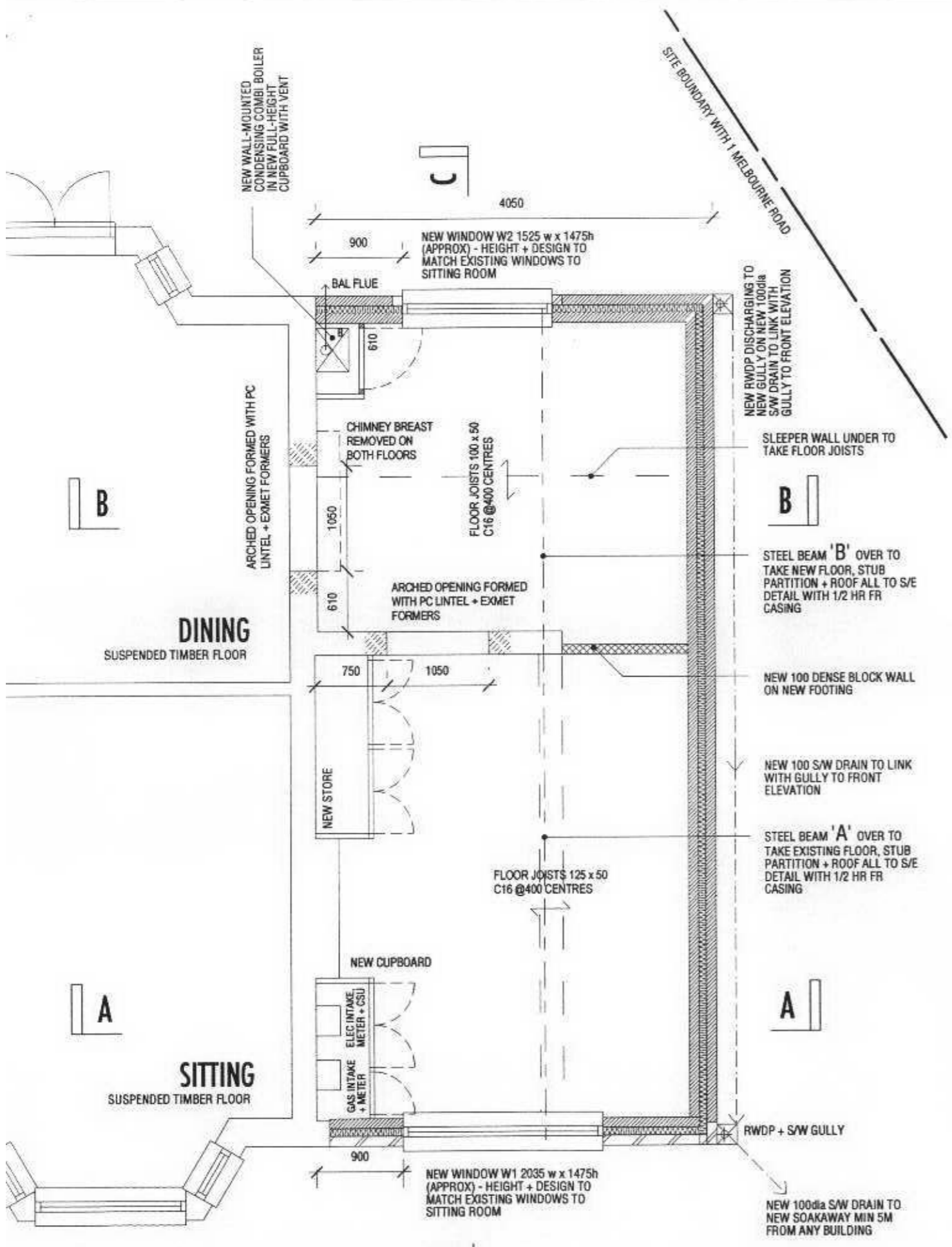

06 / 2114 / HOT

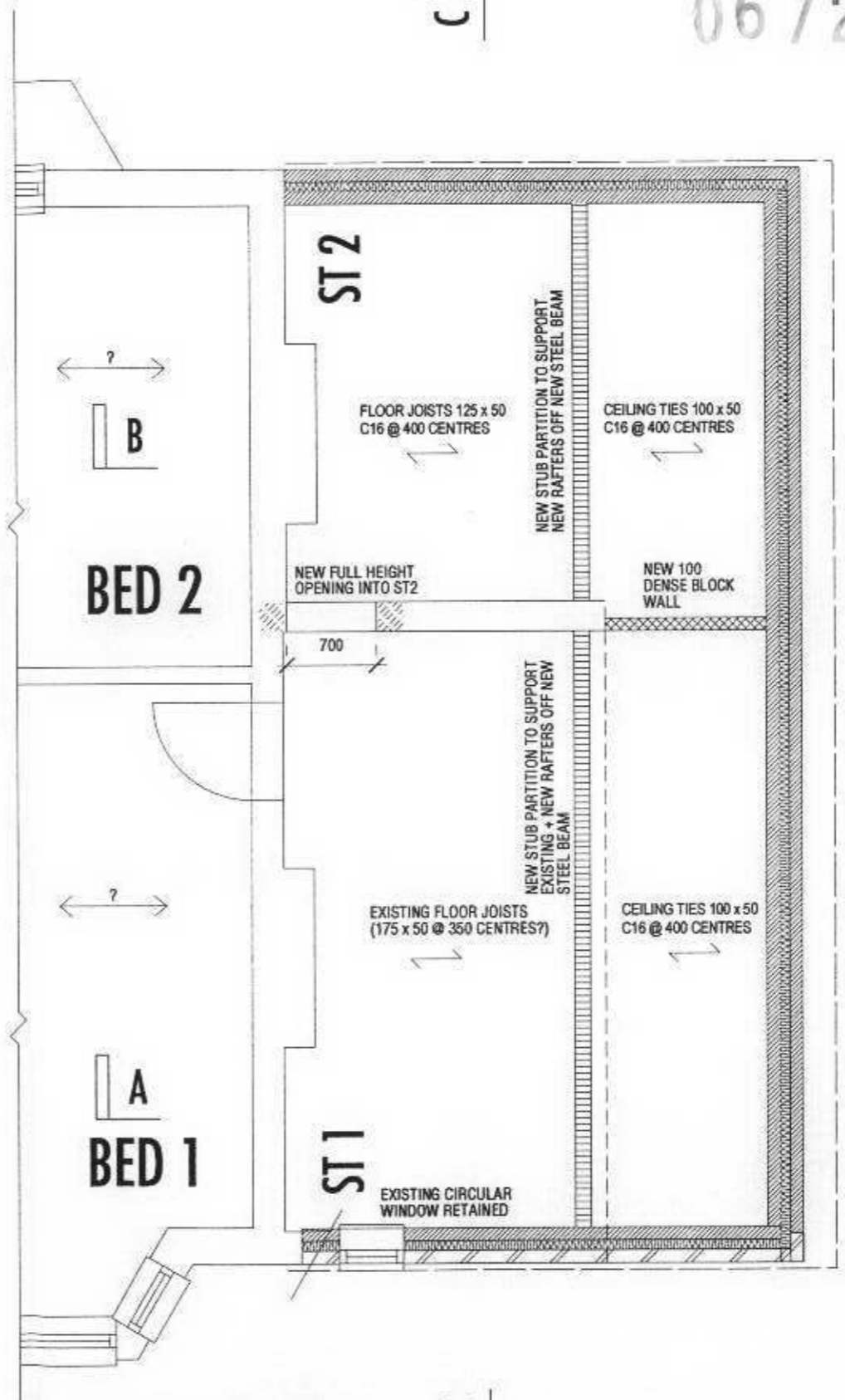

GROUND FLOOR PLAN



FIRST FLOOR PLAN

LOANED BY MR. RICHMOND LUPON THAM
03 JUN 2006
PLANNING

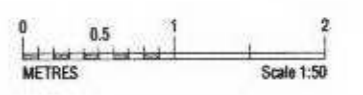

BASED ON INFORMATION SUPPLIED BY CLIENT. DO NOT SCALE - ALL DIMENSIONS TO BE VERIFIED ON SITE. DRAWING IS THE COPYRIGHT OF THE ARCHITECT + UNAUTHORISED REPRODUCTION IS FORBIDDEN

4 BROOMFIELD ROAD
TEDDINGTON TW11 9QU

PROPOSED SINGLE STOREY FLANK EXTENSION TO EXISTING TWO-STOREY DETACHED HOUSE

GROUND + FIRST FLOOR DETAIL PLANS

TO BE READ IN CONJUNCTION WITH DRAWINGS Nos 770.01, 02, 03, 04, 05, 06 + SPECIFICATION

CLIENT MR. + MRS. W. ARMSTRONG

SCALE 1:50
DATE June 06
DWG No 770.04
REV