

FIGURES

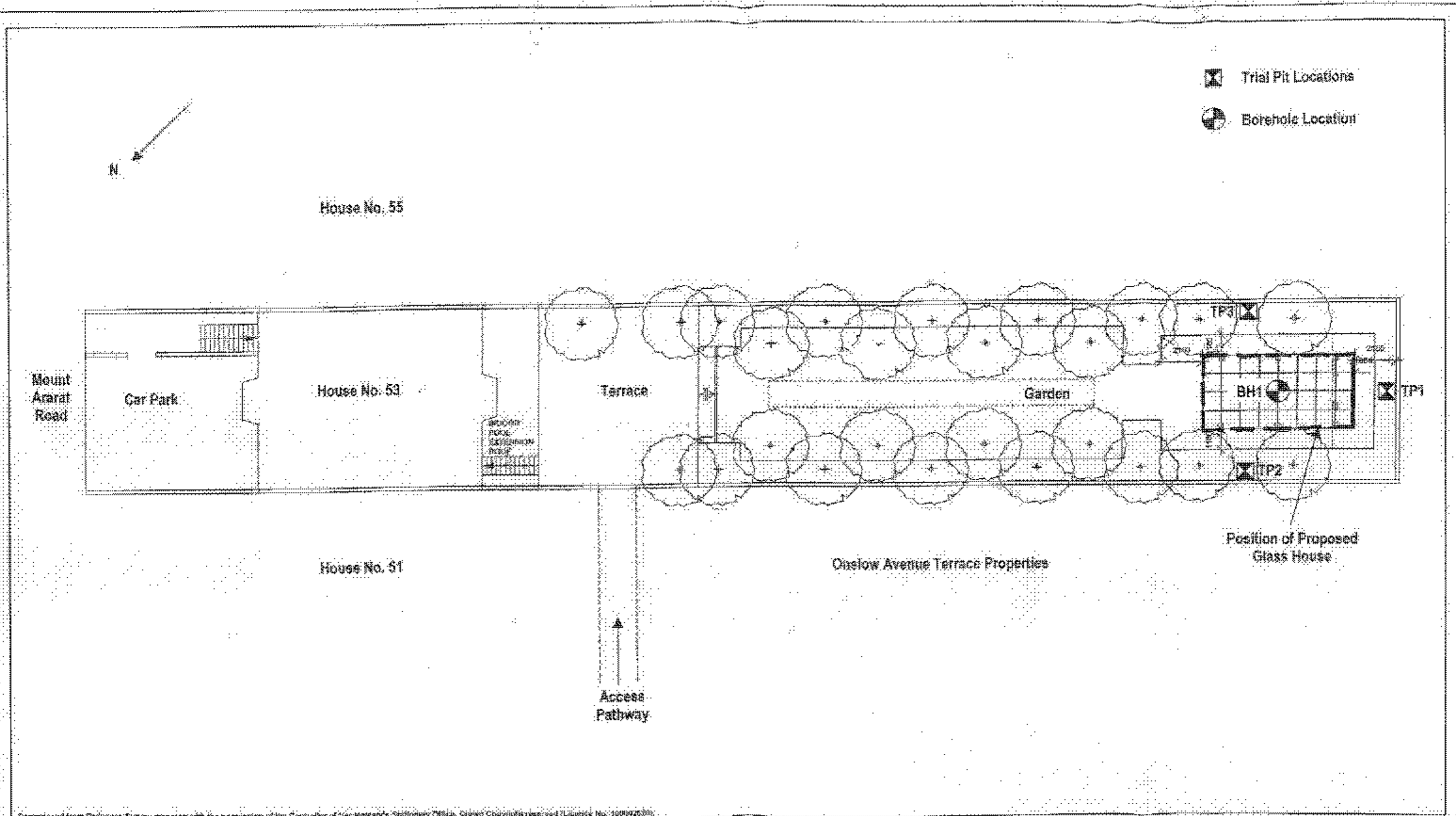

Reproduced from Ordnance Survey mapping with the permission of the Controller of Her Majesty's Stationery Office. Crown Copyright reserved (License No: 100092530)

Site: Ackorman Glass House	Client: Jane Wernick Associates Limited
Source: Adapted from Drawing GARDEN SITE PLAN 2.20.041105	Scale: Not to Scale



SITE LAYOUT PLAN

Job No:	34961
Fig No:	2

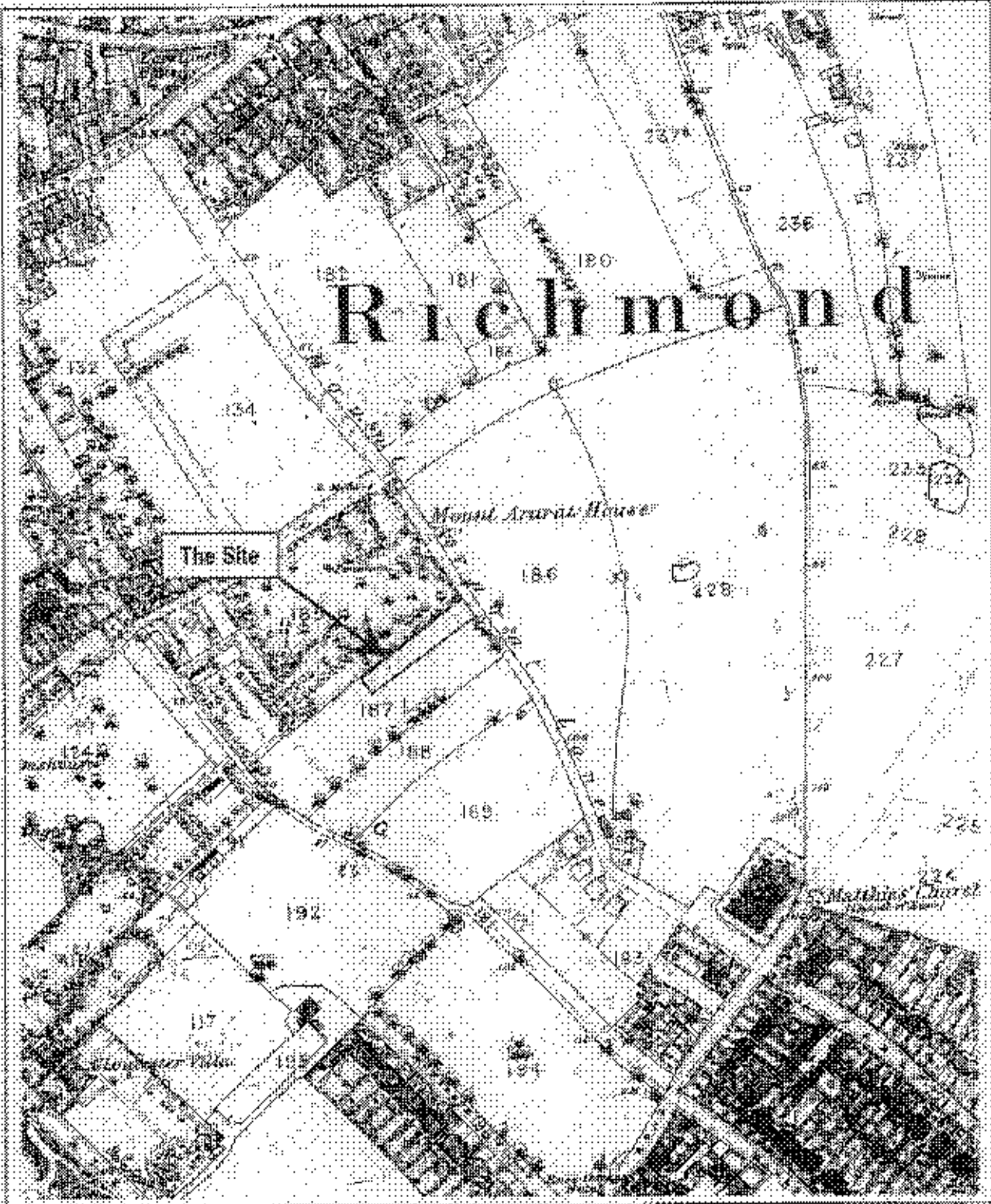

Reproduced from Ordnance Survey Mapping with the permission of the Controller of Her Majesty's Stationery Office. Errors Copyright reserved. (Licence No. 100028229)

Site: Ackerman Glass House	Client: Jane Wernick Associates
Source: Ordnance Survey County Series	Scale: Not to Scale

STATS

EXTRACT FROM
HISTORICAL MAP DATED
1866

Job No: 34961

Fig No: 3

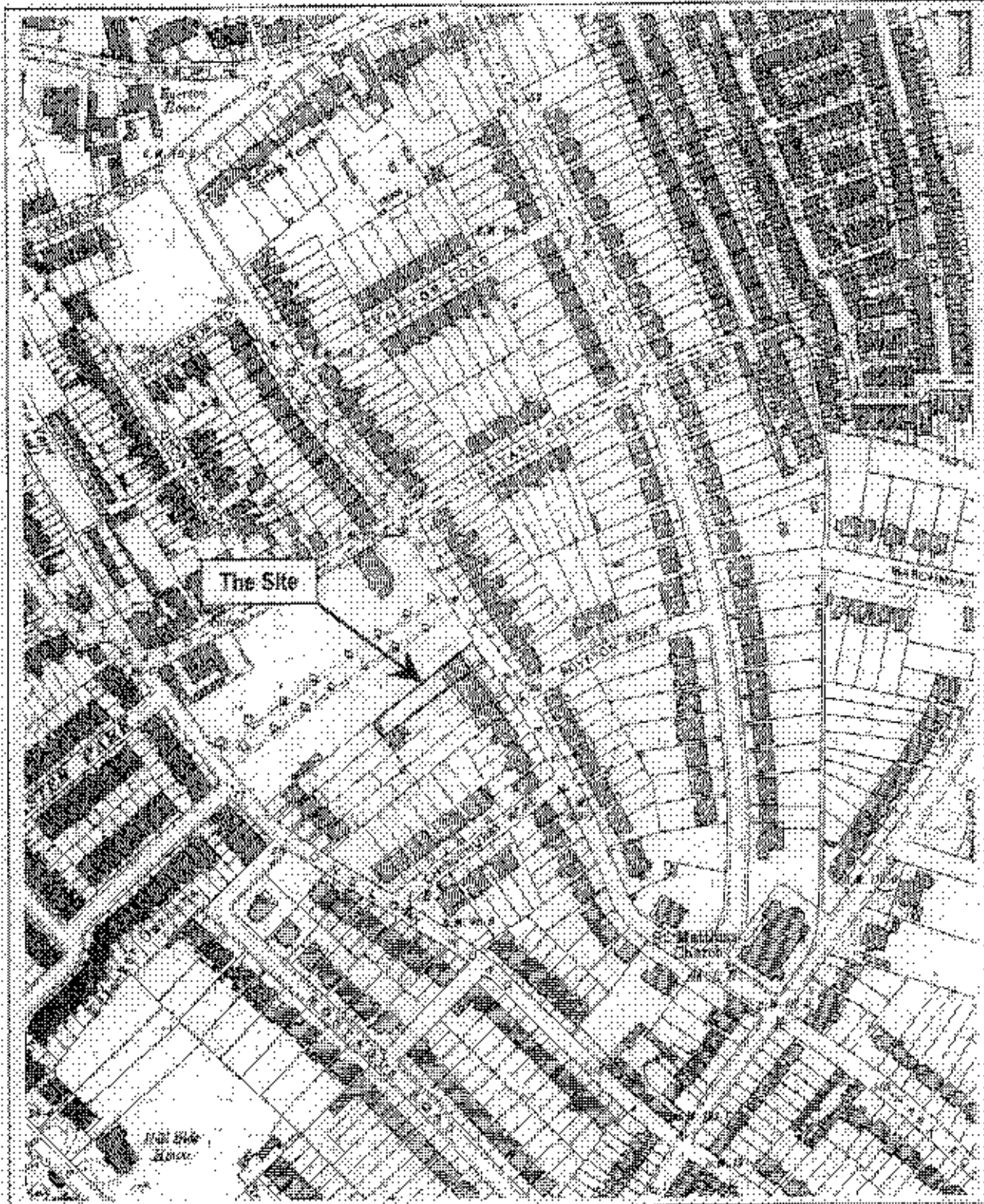

Reproduced from Ordnance Survey mapping with the permission of the Controller of Her Majesty's Stationery Office. Crown Copyright reserved (Licence No. 101061620).

Site: Ackerman Glass House	Client: Jane Wernick Associates Limited
Source: Ordnance Survey County Series	Scale: Not to Scale

STATS

EXTRACT FROM
HISTORICAL MAP DATED
1894-1898

Job No: 34961
Fig No: 4

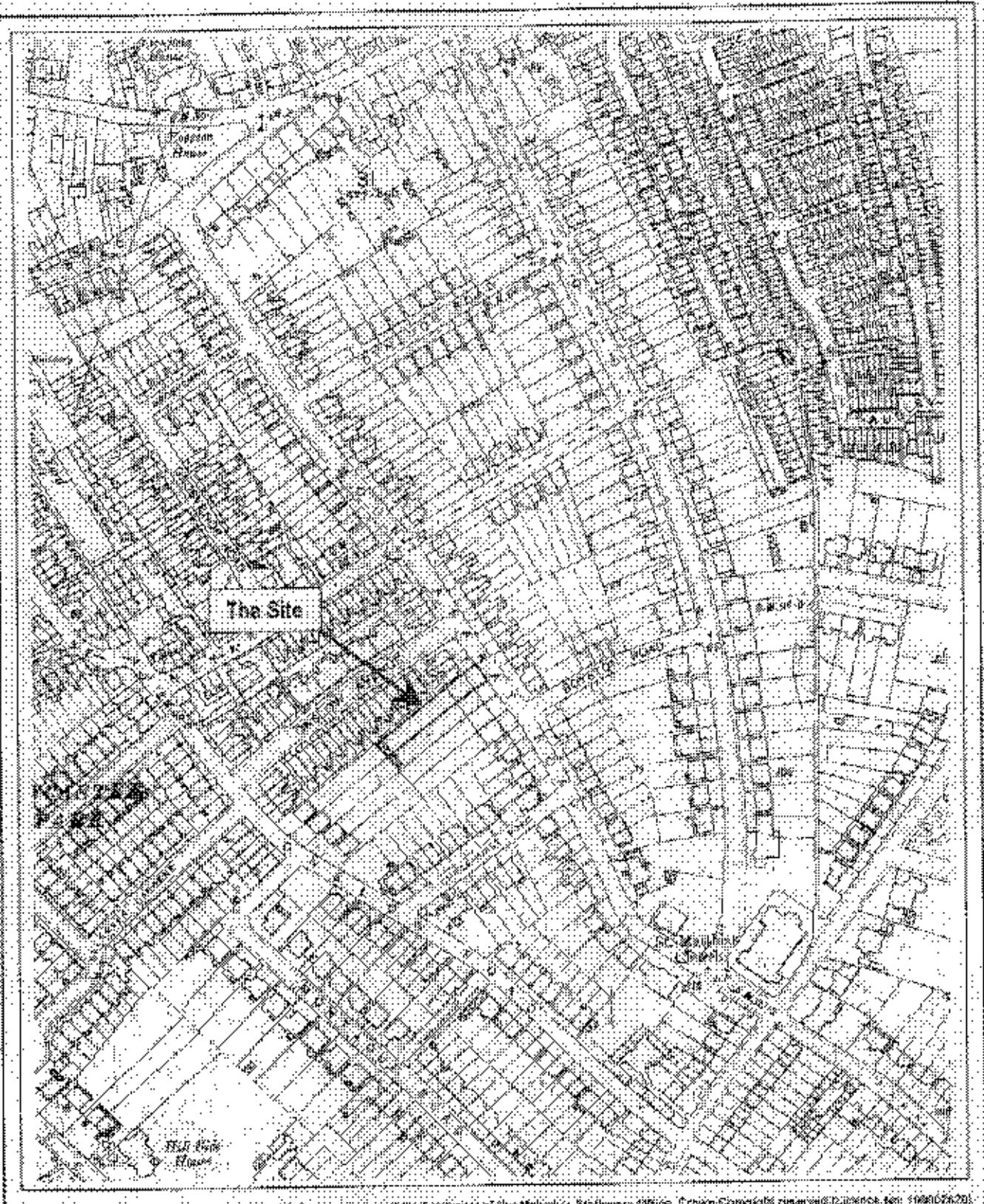

Reproduced from Ordnance Survey mapping with the permission of the Controller of the Majesty's Stationery Office. Crown Copyright reserved (Reference No: 100015620)

Site: Ackerman Glass House	Client: Jane Wernick Associates Limited
Source: Ordnance Survey County Series	Scale: Not to Scale

STATS

EXTRACT FROM
HISTORICAL MAP DATED
1911-1913

Job No: 34961
Fig No: 5

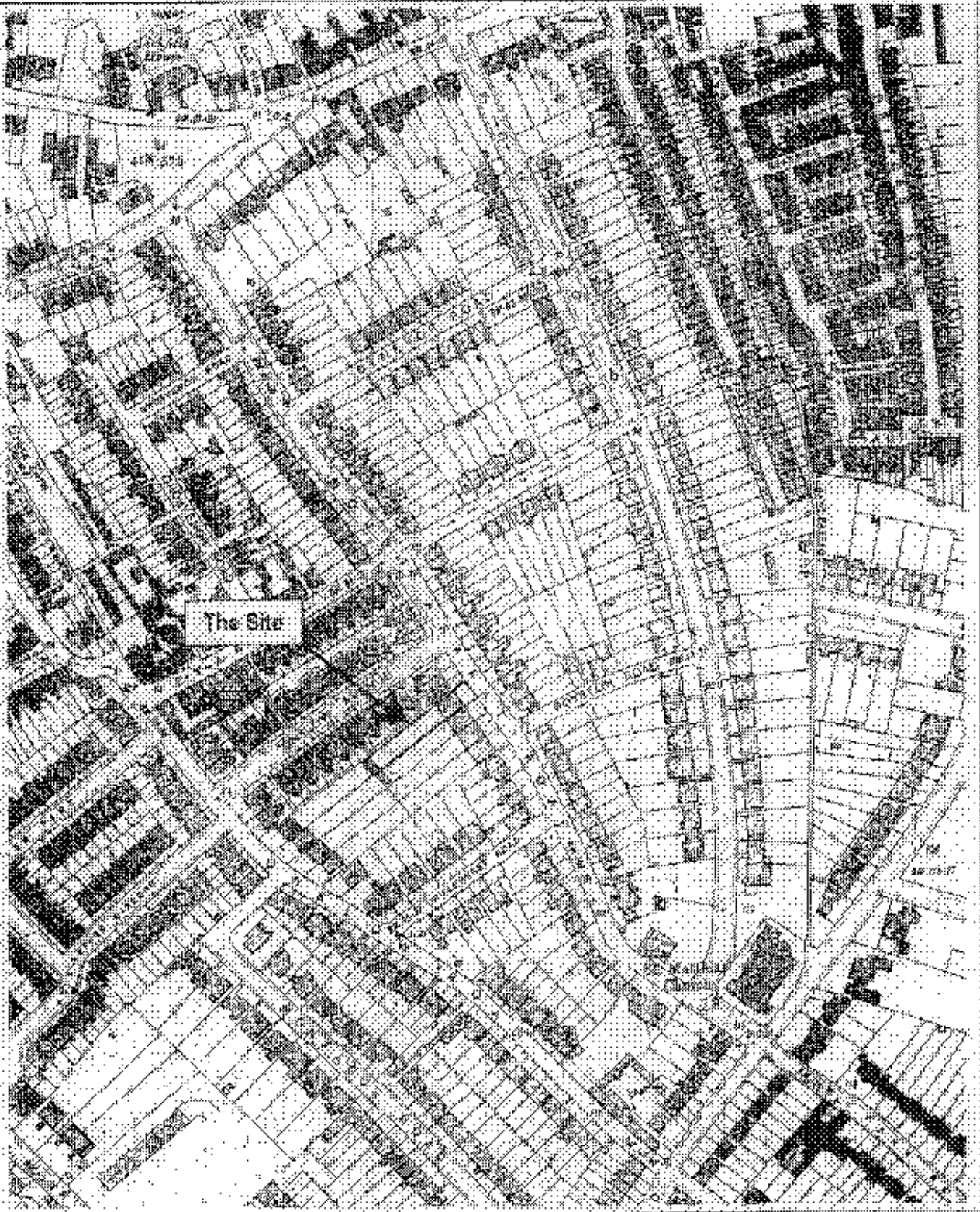

Reproduced from Ordnance Survey maps with the permission of the Controller of Her Majesty's Stationery Office. Crown Copyright reserved (Licence No. AB0002120)

Site: Ackerman Glass House	Client: Jane Wernick Associates Limited
Source: Ordnance Survey County Series	Scale: Not to Scale

STATS

EXTRACT FROM
HISTORICAL MAP DATED
1933-1934

Job No: 34961

Fig No: 6

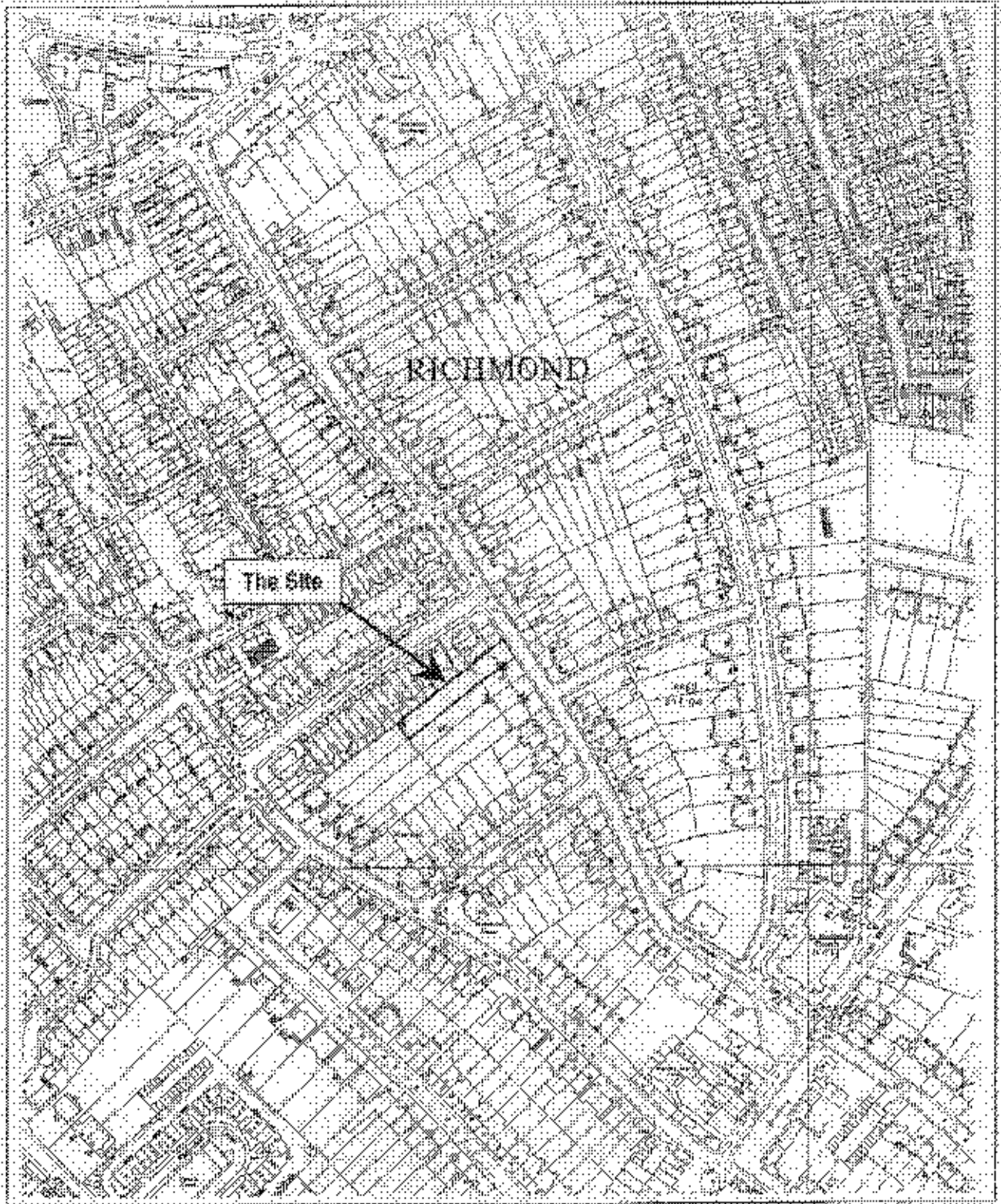

Reproduced from Ordnance Survey mapping with the permission of the Controller of Her Majesty's Stationery Office. Crown Copyright reserved. Licence No. 100002020

Site: Ackerman Glass House	Client: Jane Wernick Associates Limited
Source: Ordnance Survey County Series	Scale: Not to Scale

STATS

EXTRACT FROM
HISTORICAL MAP DATED
1959-1960

Job No: 34961
Fig No: 7

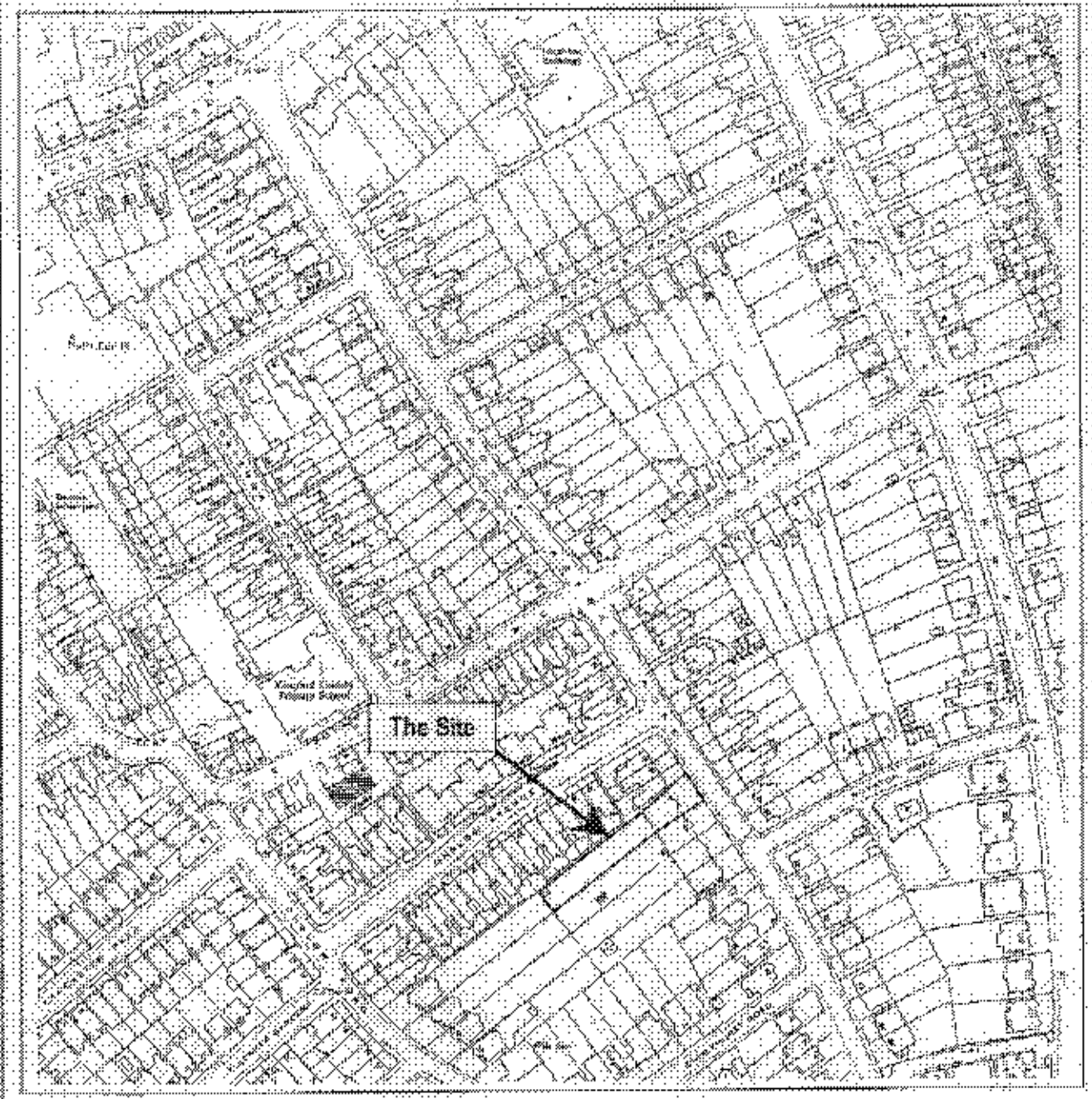

Reproduced from Ordnance Survey mapping with the permission of the Controller of Her Majesty's Stationery Office. Crown Copyright Material License No: 100026226.

Site: Ackerman Glass House	Client: Jane Wernick Associates Limited
Source: Ordnance Survey County Series	Scale: Not to Scale



**EXTRACT FROM
HISTORICAL MAP DATED
1982**

Job No:	34961
Fig No:	8

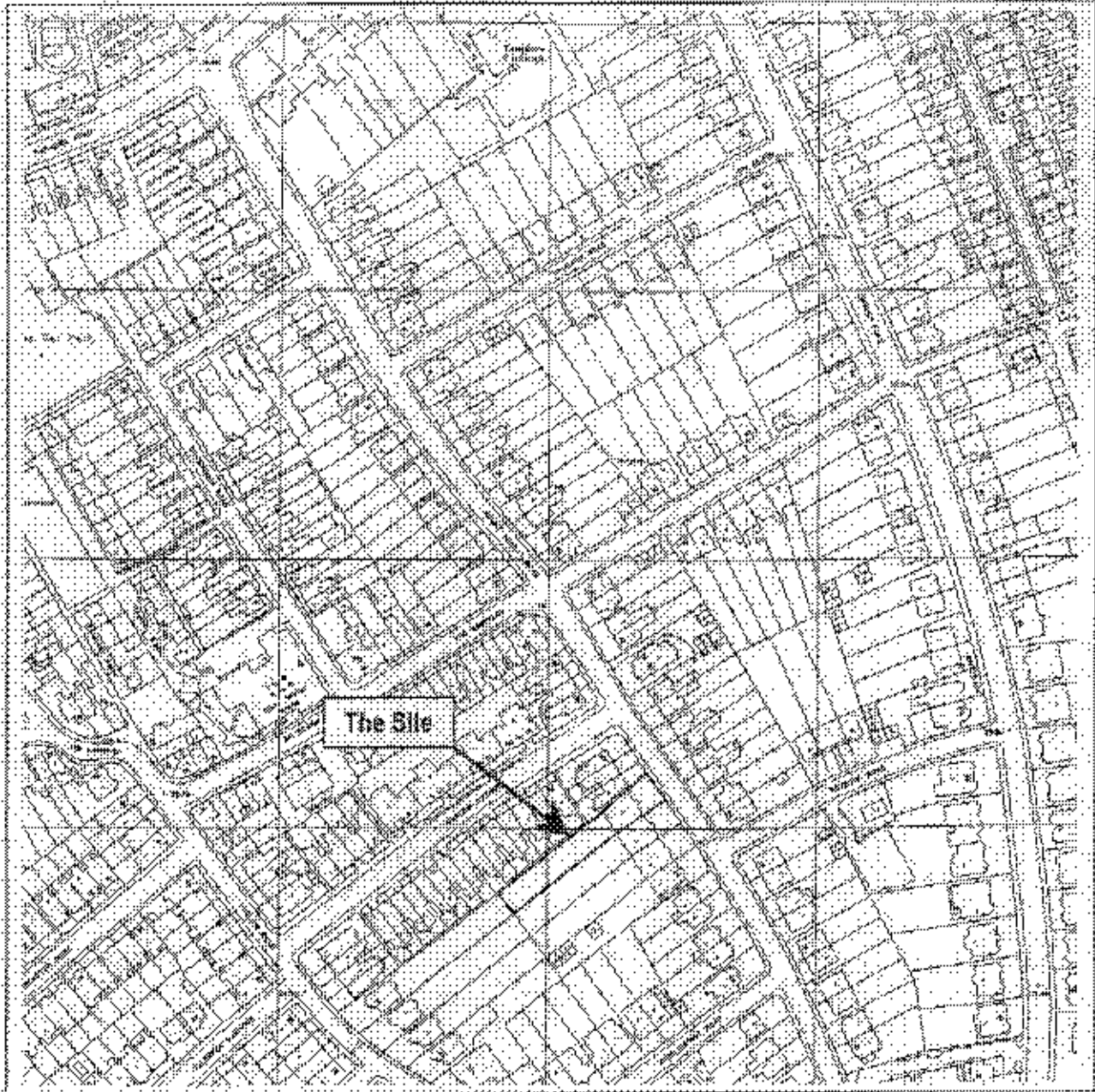

Reproduced from Ordnance Survey maps with the permission of the Controller of Her Majesty's Stationery Office. Crown Copyright (Her Majesty's Licence No. 1010228/20)

Site: Ackerman Glass House	Client: Jane Wernick Associates Limited
Source: Ordnance Survey County Series	Scale: Not to Scale

STATS

EXTRACT FROM
HISTORICAL MAP DATED
1996

Job No: 34961

Fig No: 9

STATS

Specialist Engineering, Materials and Environmental Consultants

MOISTURE CONTENT vs DEPTH

Site:
53 Mount Ararat Road, Richmond, TW10 6PL

Client:
Jane Wernick Associates Ltd.

Job Number:	34961
Figure:	10

Natural Moisture Content (%)

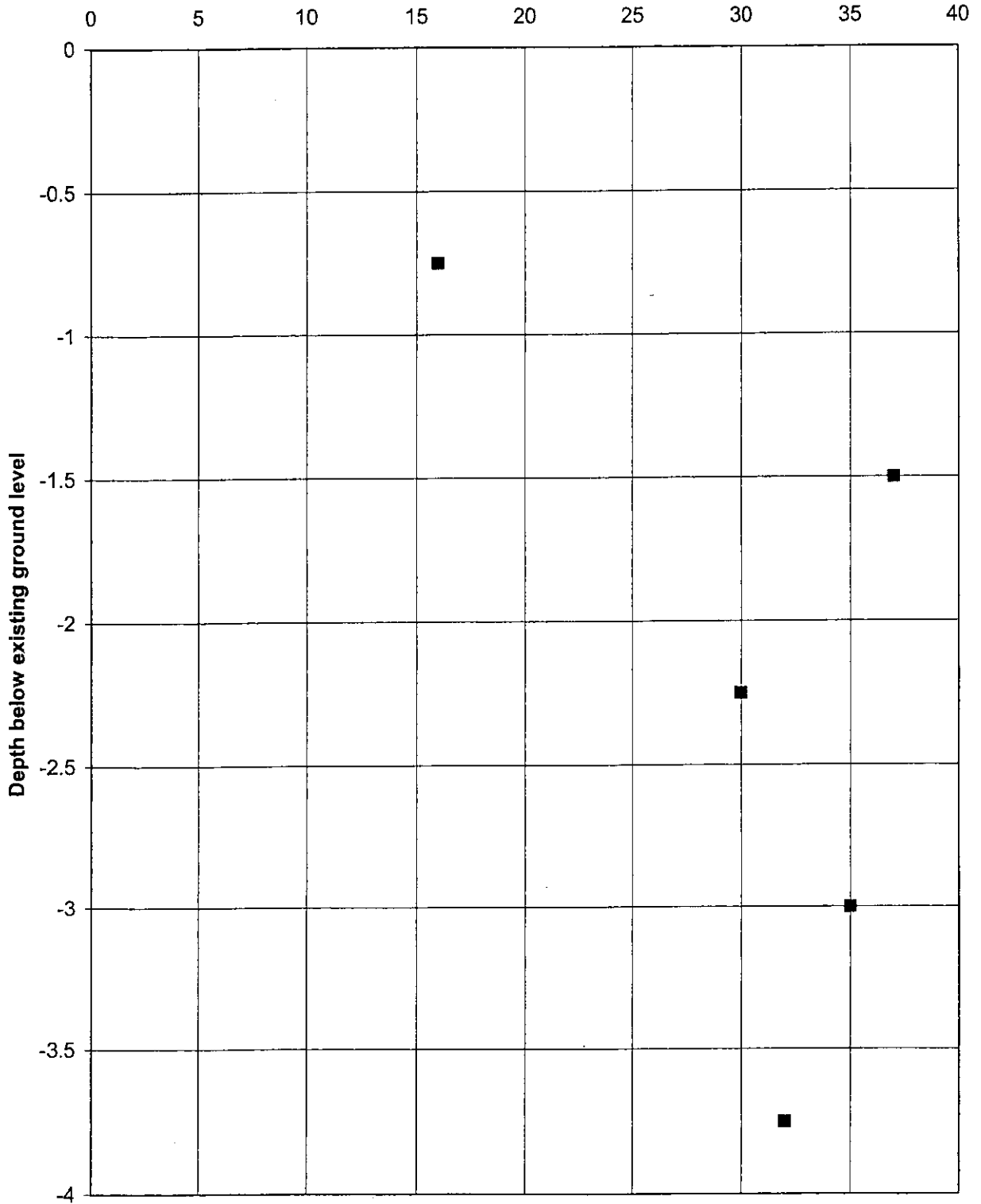

■ BH1 London Clay ■ BH1 Made Ground

MODIFIED PLASTICITY CLASSIFICATION CHART

Site:
53 Mount Ararat Road, Richmond, TW10 6PL

Client:
Jane Wernick Associates Ltd.

Job Number: 34961
Figure: 11

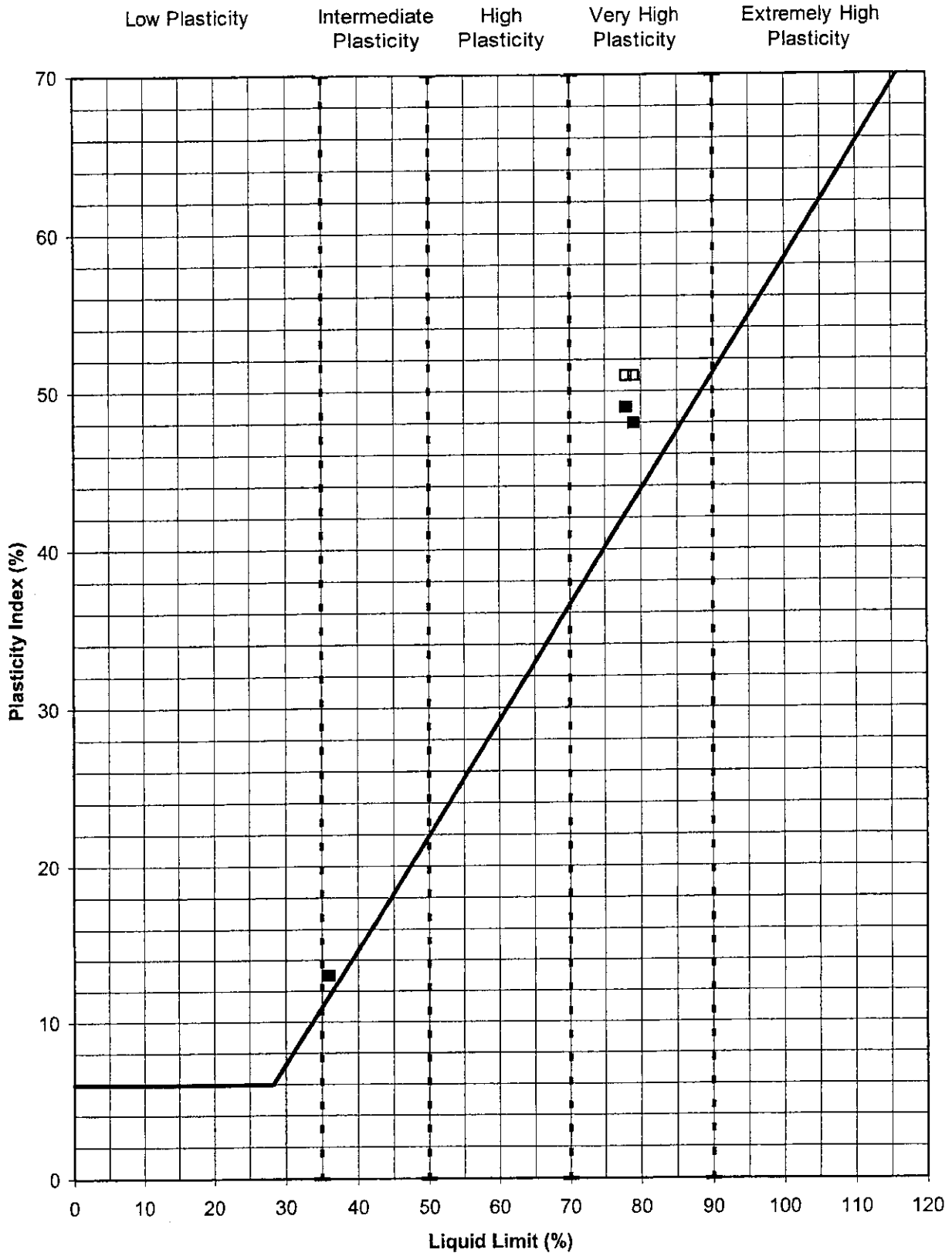

— A - Line
 ■ BH1 London Clay
 □ BH1 Reworked London Clay
 - - - Classifications
 ■ BH1 Made Ground