

SEE PLAN A FOR CONTINUATION

FOR CONTINUATION OF EXTERNAL FINISHES LAYOUT, PLEASE SEE DRAWING No 1509/03/03

KEY:

HN0.1	VEHICULAR ACCESS, IMPERMEABLE ROAD SURFACE
HN0.2	IMPERMEABLE VEHICULAR ACCESS
HN0.2a	IMPERMEABLE VEHICULAR ACCESS
HN0.3	PERMEABLE PRIVATE VEHICULAR ACCESS
HN0.4	IMPERMEABLE VEHICULAR ACCESS
HN0.5	IMPERMEABLE CAR PARKING BAYS
HN0.6	IMPERMEABLE RUMBLE STRIP - GRANITE SETTS
HN0.7	IMPERMEABLE FOOTWAY
HN0.8	IMPERMEABLE SURFACE PRIVATE PATHS
HN0.9	IMPERMEABLE PRIVATE FOOTPATHS
HN0.10	IMPERMEABLE GARDEN PATIOS
HN0.11	IMPERMEABLE SELF-BINDING GRAVEL
HN0.12	IMPERMEABLE SERVICE CORRIDOR
HN0.13	PERMEABLE VEHICLE ACCESS
HN0.14	IMPERMEABLE RUMBLE STRIP
HN0.15	IMPERMEABLE GRANITE SETTS
HN0.16	IMPERMEABLE SERVICE CORRIDOR
HN0.17	IMPERMEABLE VEHICULAR ACCESS
HN0.18	IMPERMEABLE PRIVATE FOOTPATH
HN0.19	PERMEABLE PRIVATE FOOTPATH

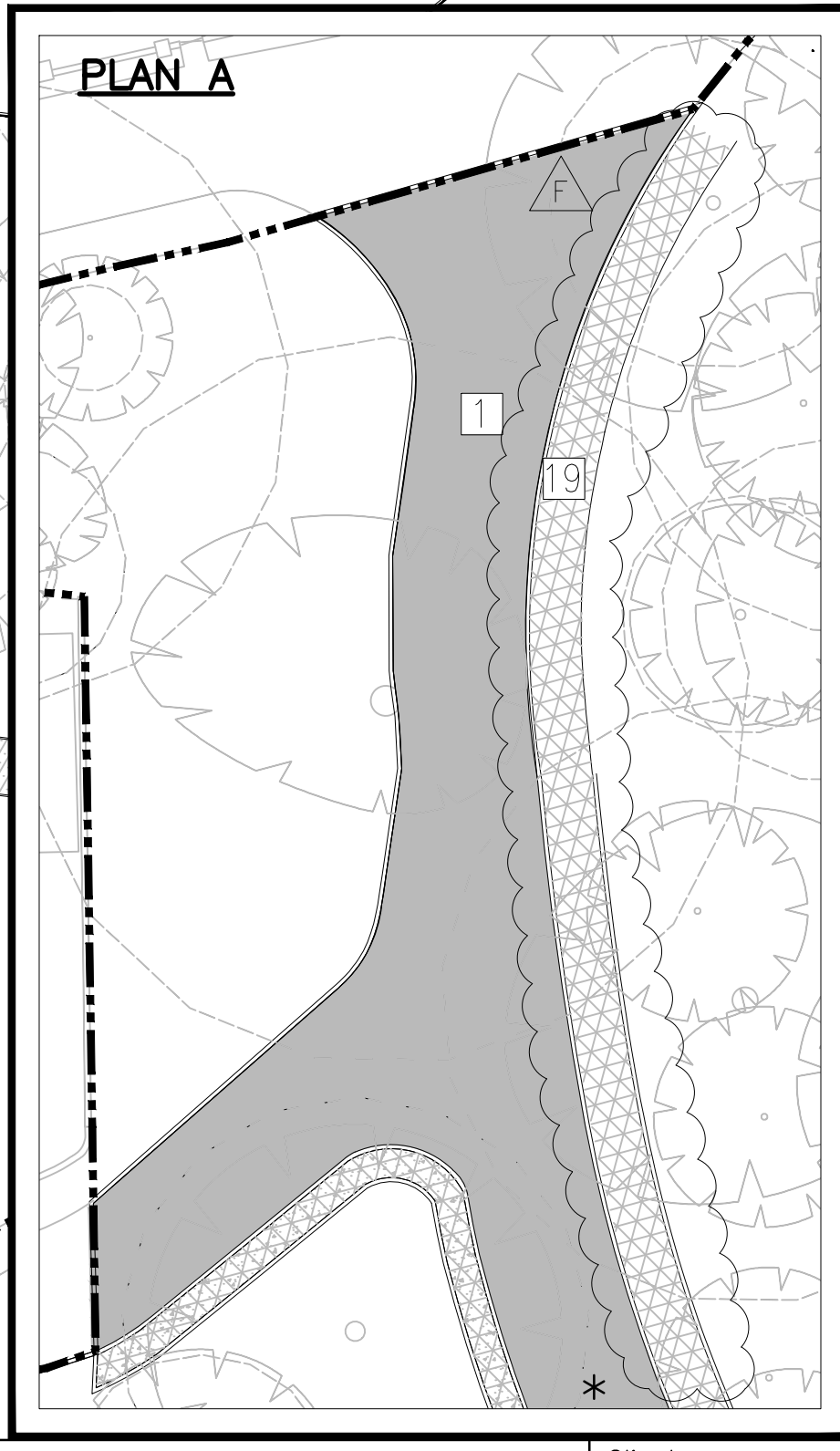

DO NOT SCALE HARD COPIES OF THIS DRAWING OR INTERMEDIATE CAD VERSIONS. ONLY STATED DIMENSIONS AND COORDINATES ARE TO BE RELIED UPON.

COPYRIGHT RESERVED

GENERAL NOTES
 1. THIS DRAWING IS TO BE READ IN CONJUNCTION WITH THE ARCHITECTS, SPECIALISTS AND ENGINEERS DRAWINGS AND SPECIFICATIONS. ANY DISCREPANCIES ARE TO BE REPORTED TO THE ARCHITECT/ENGINEER IMMEDIATELY.

LATEST REVISIONS ARE 'TAGGED' WITH THIS INDICATOR. HOWEVER, ALL USERS OF THIS DRAWING MUST SATISFY THEMSELVES OF ALL REVISIONS TO ANY PREVIOUS ISSUES, BY COMPARISON OF THIS DRAWING AGAINST OTHER ISSUES, AS IT CANNOT BE GUARANTEED THAT EVERY ITEM OF REVISION HAS BEEN 'TAGGED'.

Rev	Date	Description	Drawn & Checked
J			
H			
G	18.10.18	KEY AMENDED FOR PLANNING PURPOSES ONLY	
F	28.07.17	SURFACE FINISHES UPDATED	DM SC
E	11.01.17	SURFACE FINISHES UPDATED	DM SC
D	21.12.16	ROAD 1 SURFACE FINISH UPDATED	DM SC
C	06.12.16	FINISHES UPDATED TO SUIT LATEST SITE LAYOUT	DM SC
B	29.09.16	ROAD UPDATED TO PERMEABLE PAVING, FINISHES AMENDED TO SUIT IN ABEYANCE NOTE ADDED	DM JCU
A	27.05.16	EXTERNAL FINISHES LAYOUT REVISED FOR PHASE 1 (NOT CLOUDED FOR CLARITY).	RM JCU
Revisions			
Date	05.02.16	FIRST ISSUE	AZ SC

Project
LATCHMERE HOUSE

Title
EXTERNAL FINISHES LAYOUT SHEET 2 OF 2

Architect
BROOKES ARCHITECTS

Client
BERKELEY HOMES (WEST LONDON) LIMITED

RLT
 RLT ENGINEERING CONSULTANTS LTD
 CIVIL AND STRUCTURAL CONSULTING ENGINEERS
 2 ST PETER'S COURT MIDDLEBOROUGH COLCHESTER, ESSEX, CO1 1WD
 T: 01206 768655 F: 01206 768656 E: email@rltengcon.co.uk

ISO 9001 REGISTERED FIRM

Dwg No. 1509/03/04 Scales: 1:250 @ A1 Rev: G