

Tree schedule

Tree No	Species	Category	RPA Radius	Tree Works
All retained trees & hedges				
T1	Acacia	C	3.0	-
G2	Yew	B	5.4	-
T3	Norway maple	B	5.1	-
T4	Maple sp	B	9.6	-
T5	Oak	C	1.2	-
T6	Maple sp	B	7.5	-
T7	Norway maple	C	3.6	-
T8	Maple sp	B	5.7	Remove subject to consultation with LPA regarding visibility splays. Refer to transport assessment
T9	Lime	B	6.6	Remove subject to consultation with LPA regarding visibility splays. Refer to transport assessment
T10	Cotoneaster	C	2.4	Fell for development
T11	Maple sp	C	2.4	Fell for development
T12	Lime	B	6.6	Remove subject to consultation with LPA regarding visibility splays. Refer to transport assessment
T13	Lime	B	6.6	Remove subject to consultation with LPA regarding visibility splays. Refer to transport assessment
T14	Maple sp	B	3.9	Remove subject to consultation with LPA regarding visibility splays. Refer to transport assessment
T15	Norway maple	B	6.6	-
T16	Norway maple	C	5.7	-
T17	Norway maple	C	5.7	-
T18	Norway maple	B	4.8	Remove subject to consultation with LPA regarding visibility splays. Refer to transport assessment
T19	Maple sp	B	4.8	Remove subject to consultation with LPA regarding visibility splays. Refer to transport assessment
T20	Oak	C	4.8	-
T21	Norway maple	B	5.1	-
T22	Alder	B	6.0	-
T23	Whitebeam	C	3.6	-
T24	Lawson cypress	C	2.4	-
T25	Goat willow	C	3.6	-
T26	Lawson cypress	C	1.8	-
T27	Lawson cypress	C	1.8	-
T28	Lawson cypress	C	2.4	Fell for development
T29	Norway maple	C	1.2	-
T30	Birch	C	2.4	-
G31	Lime	C	6.6	-
G32	Cypress sp, spruce, fruit sp, birch, pine	C	1.8	-
G33	Lime	B	7.2	-
T34	Lime	C	4.2	-
T35	Laurel	C	3.6	-
T36	Elder	C	2.4	-
T37	Lime	B	7.8	-
T38	Ash sp	B	6.6	-
T39	Ash sp	C	2.4	Remove subject to consultation with LPA regarding visibility splays. Refer to transport assessment
T40	Unknown sp	C	0.6	Remove subject to consultation with LPA regarding visibility splays. Refer to transport assessment
T41	Lime	B	8.4	Remove subject to consultation with LPA regarding visibility splays. Refer to transport assessment
T42	Lime	B	9.9	Remove subject to consultation with LPA regarding visibility splays. Refer to transport assessment
T43	Ash sp	B	4.8	-
T44	Lime	B	9.0	-
T45	Unknown sp	C	0.6	-
T46	Ash sp	B	4.8	-
T47	Cherry	C	4.8	-
T48	Lime	B	7.2	-
H49	Beech	C	1.8	Fell for development (part)
T50	Ash sp	C	2.7	-
T51	Maple sp	C	8.4	-
T52	Poplar	C	4.8	-
G53	Elm sp	C	1.8	-
T54	Sycamore	B	8.4	-
T55	Apple	C	4.8	-
G56	Elm sp	C	1.8	-
T57	Sycamore	C	3.0	-
T58	Lombardy poplar	B	3.6	-
T59	Lombardy poplar	B	6.0	-
T60	Lombardy poplar	B	3.6	-
T61	Lombardy poplar	B	6.0	-
G62	Elm sp	C	1.8	-
T63	Laburnum	C	2.4	-
G64	Elm sp	C	1.8	-
T65	Norway maple	B	8.4	-
T66	Purple plum	C	4.8	-
G67	Elder, elm sp	C	1.8	-
T68	Lime	B	4.2	-
T69	Fruit sp	U	3.0	Fell for management
T70	Norway maple	B	7.8	-
G71	Elm sp	U	1.8	Fell for management
T72	Cherry	C	6.6	-
T73	Cherry	C	3.0	-
G74	Elm, elder	U	2.4	Fell for management
T75	Lime	B	5.4	-
T76	Norway maple	B	6.3	-
T77	Fruit sp	C	1.8	-
T78	Norway maple	B	8.4	-
G79	Elm sp, elder	C	1.2	Fell for development (part)
T80	Lime	B	7.2	Minor pruning of secondary and tertiary low branches to provide adequate clearance over the new access of up to 4m for construction vehicles
T81	Lime	B	7.2	Minor pruning of secondary and tertiary low branches to provide adequate clearance over the new access of up to 4m for construction vehicles
G82	Holly, maple sp, elm, fruit sp	C	3.6	-
T83	Lombardy poplar	C	4.2	-
T84	Lime	B	5.4	-
T85	Oak	C	2.4	-
T86	Laurel	C	3.0	-
T87	Pine sp	B	3.6	-

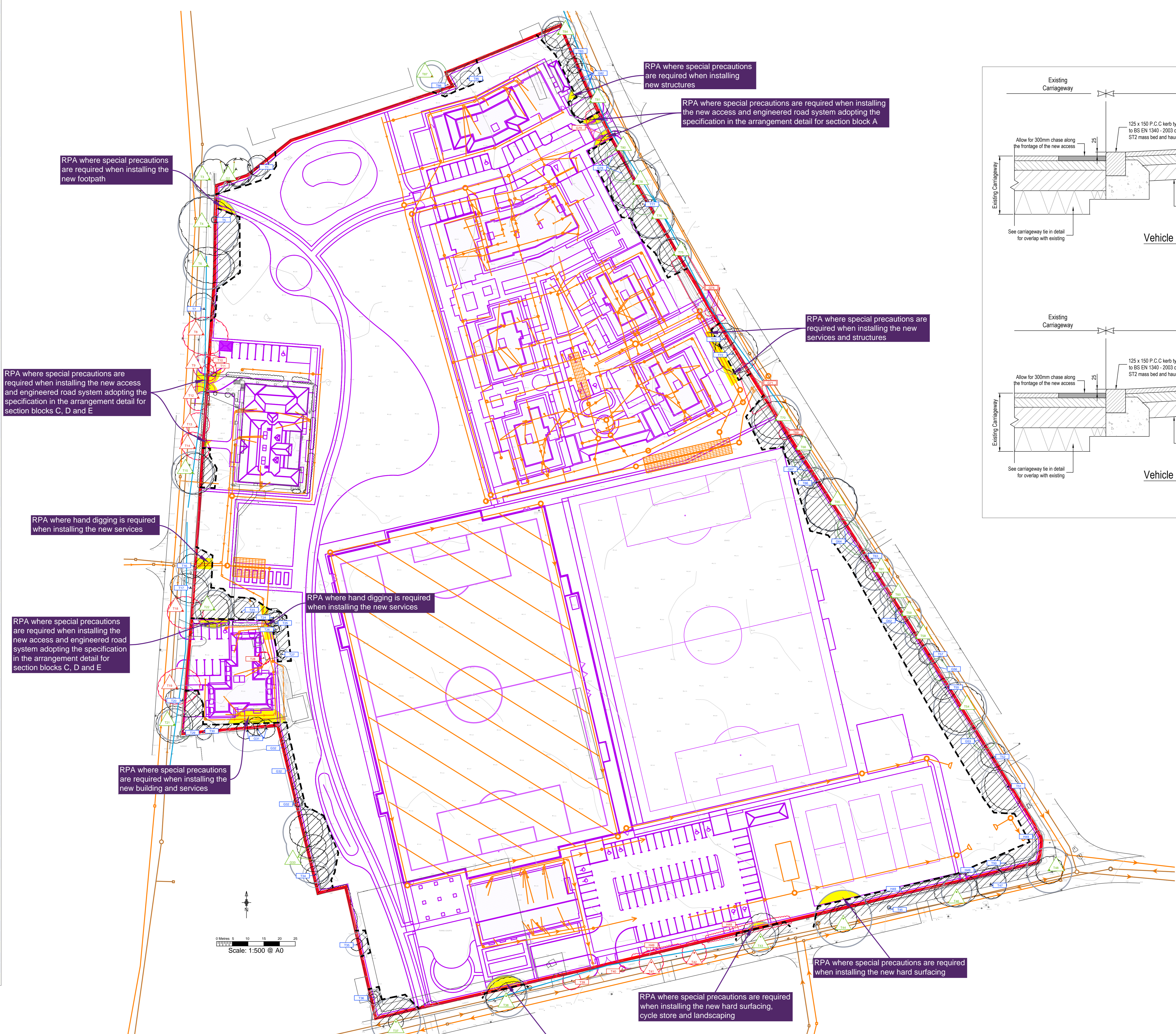

Trees 8, 9, 12, 13, 14, 18, 19, 39, 40, 41 and 42 possibly need to be removed subject to consultation with the LPA regarding location of visibility splays. Refer to transport assessment.

	BS category B	Trees of moderate quality		Construction exclusion zone (CEZ) to be protected by fencing and/or ground protection
	BS category C	Trees of low quality		Precautionary areas
	BS category U	Trees unsuitable for retention		Proposed services
	Trees to be removed			Visibility splays
	Proposed layout			Root protection area (RPA) boundaries for category B trees
	Estimated tree positions not included on original land survey and/or adjusted crown spreads			Root protection area (RPA) boundaries for category C trees

Tree protection
Location of trees, categorisation & protection/management proposals at Teddington Sports field, Udney Park Road, Teddington, London

Permission is granted to scale from this drawing for Local Authority Planning Approval purposes relating to tree protection measures only. Where applicable this drawing is to be read in conjunction with the arboricultural report. This drawing is the copyright of Barreil Tree Consultancy 2017. ©

This drawing to be reproduced in colour only.

Barreil Plan Ref: 16050-BT4
Provided Plan Refs: LDS13279-TP1, 900-P200, 3336 005 Rev P3, 3336 006 Rev P3, 3336 007 Rev P3, 3336 008 Rev P3 & 3336 009 Rev P3 & 3336 005 Rev P1

barreil
TREE CONSULTANCY

Field House, Fordingbridge Business Park,
Astonford Road, Fordingbridge SP11 8Y
Tel: 01423 451470 Fax: 01423 453449
www.barreiltree.co.uk

