

- Notes:**
1. This drawing is to be read in conjunction with all relevant architects, engineers and specialist sub-contractors drawings and the specification.
 2. All setting out to be in accordance with the schedules, any discrepancies between the engineers and the architects drawings to be referred to the architect before proceeding. Dimensions must not be scaled.
 3. Refer to drawing JB-3336-055 for the external works construction details.

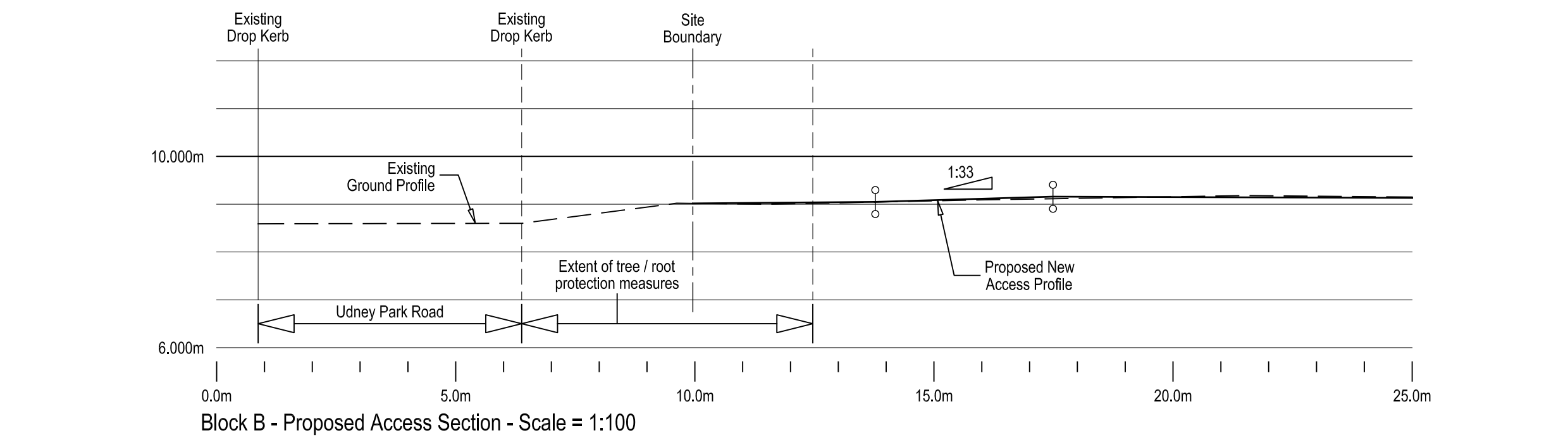

External Works Legend

- Construction Exclusion Zone Protected by Fencing
- Precautionary Areas Hand Digging Only
- Permeable Block Paved Areas
- Existing Ground Levels
- Proposed Ground Levels

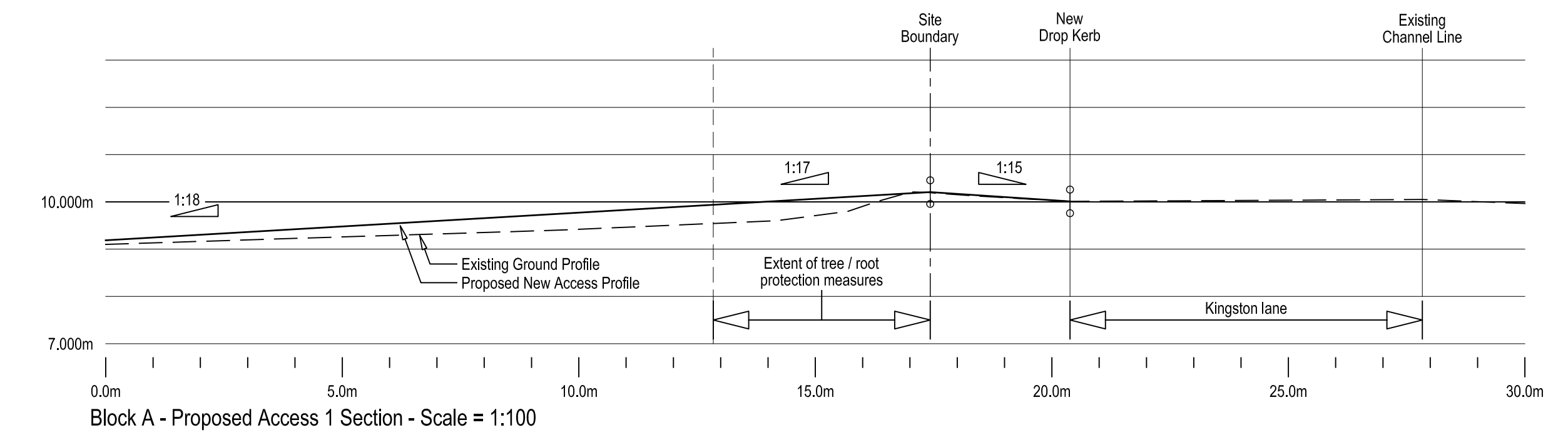
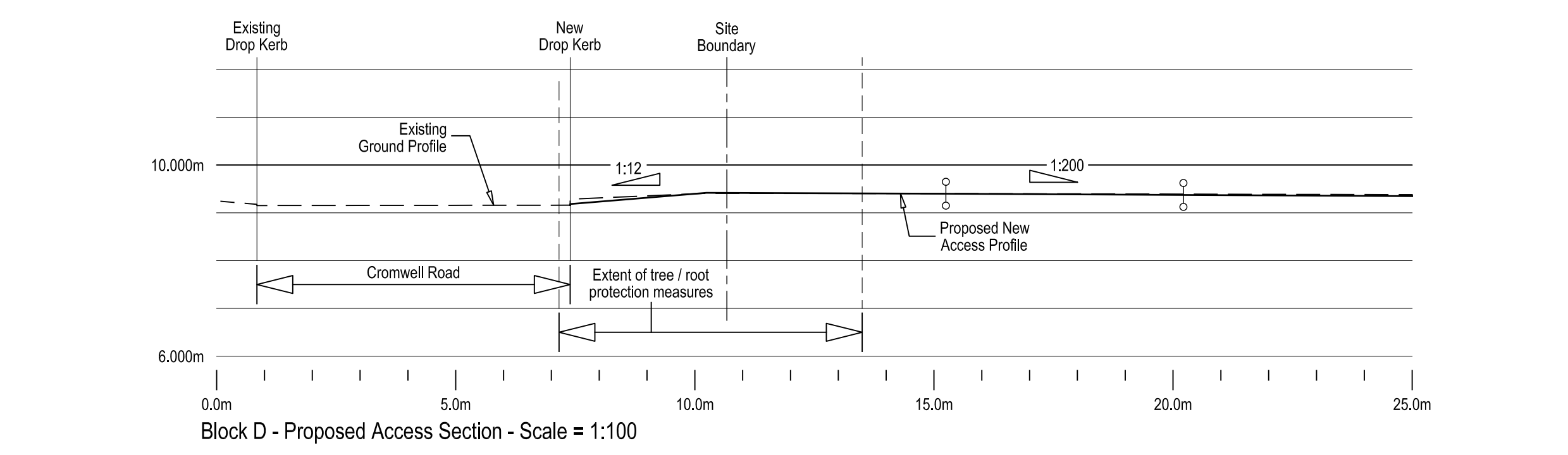
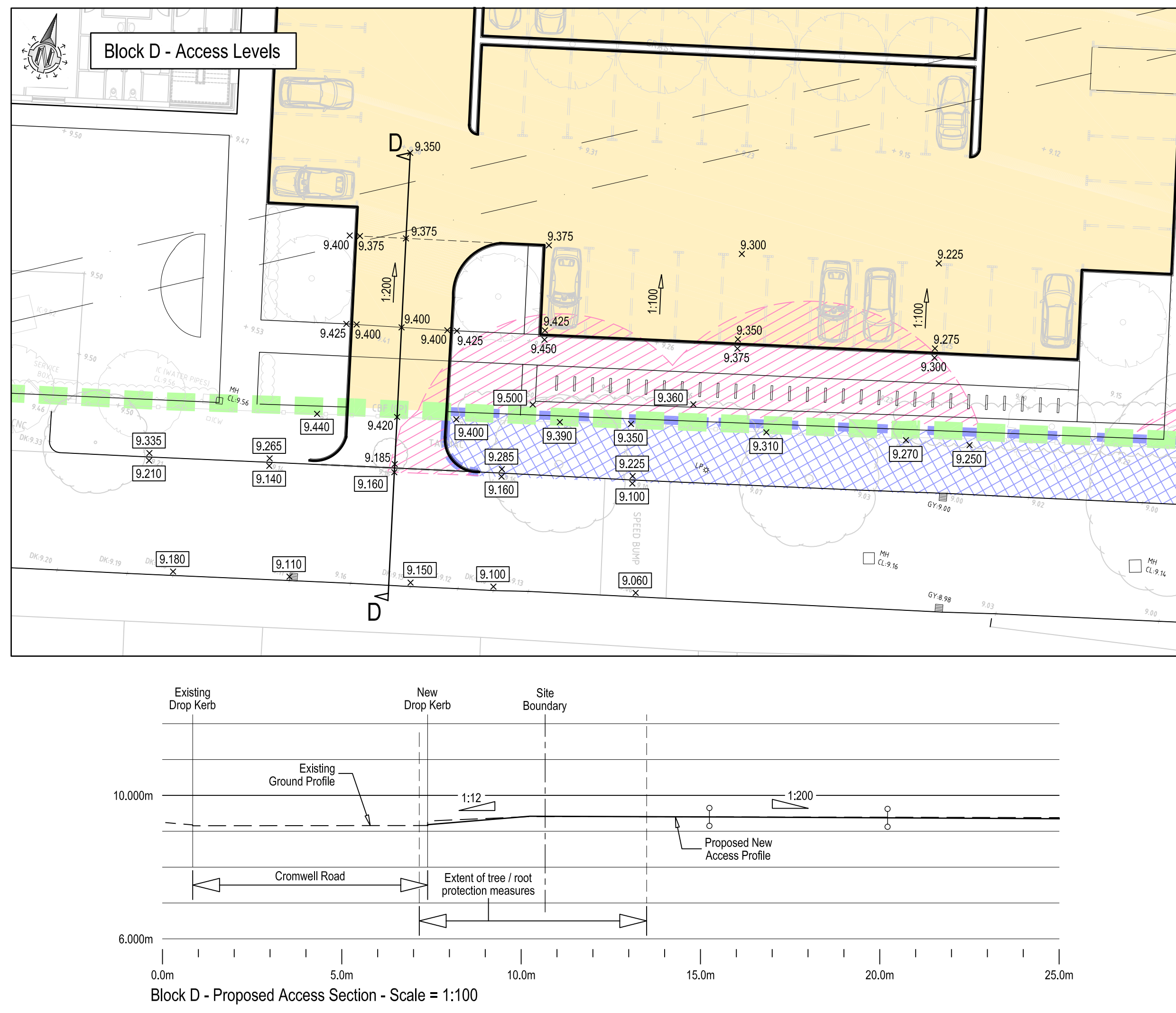
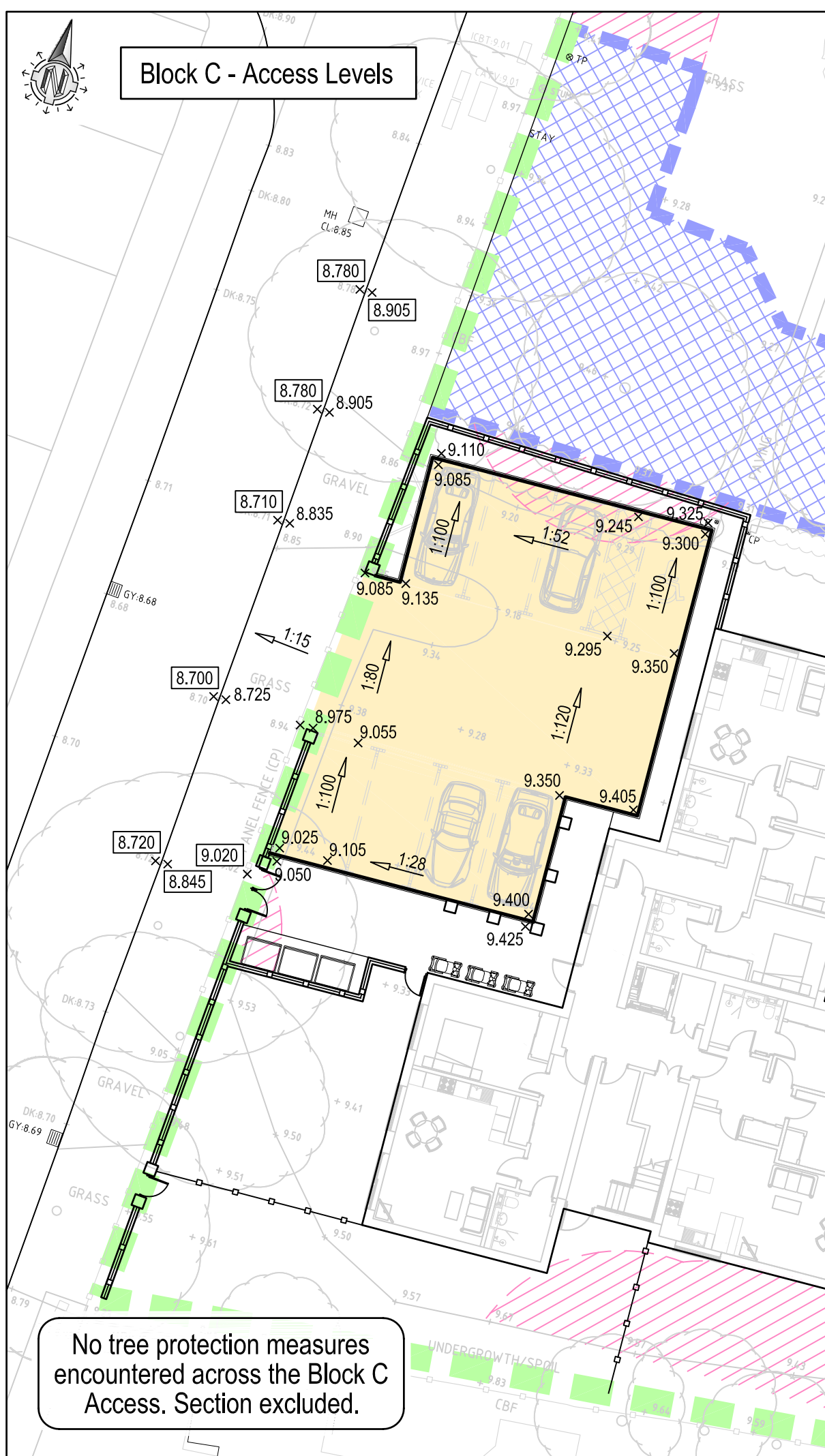
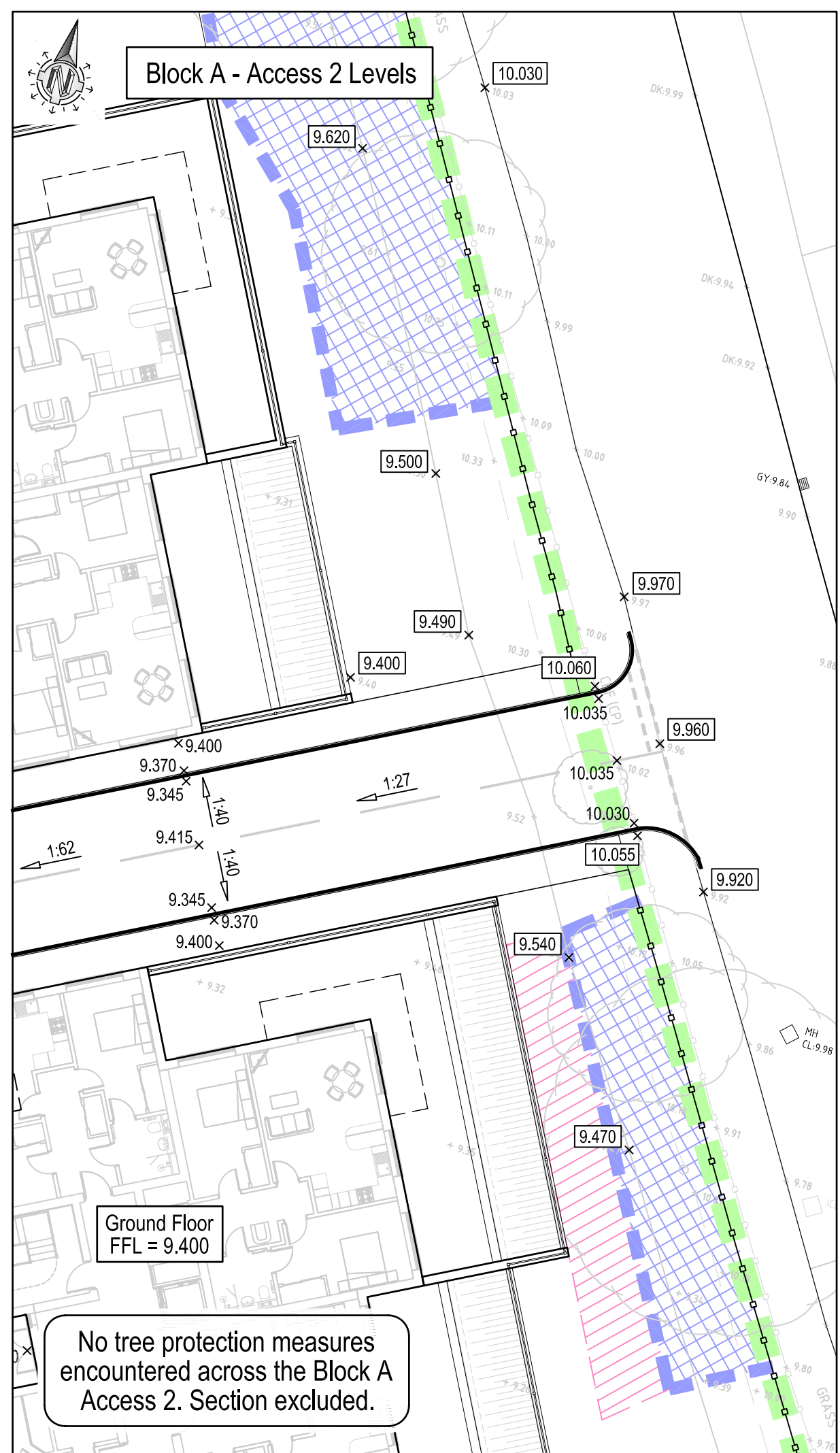

P1	17.07.17	Drawn	GEB
Rev.	Date	Description	Issued By

Planning

calcinotto

CONSULTING STRUCTURAL CIVIL AND ENVIRONMENTAL ENGINEERS
 ADDRESS : 2nd Floor, Jonsen House, 43 Commercial Road, Poole, Dorset BH14 0HD
 T: 0044 1202 237237 W: www.calcinotto.co.uk E: admin@calcinotto.co.uk

Client: **Quantum Land and Property Limited**

Project Title: **Former ICL Private Ground**

Drawing Title: **Proposed Site Access Levels and Sections Through Tree Protection Zones**

Drawn by	GEB	Project No.	3336	Drwg No. (Rev)	016 P1
Scale	1:200				
Date	Jul'17				