

LEGEND

GENERAL

- Site Ownership Boundary
- Site Planning Application Boundary
- School Planning Application Boundary
- Existing Surface Level
- Proposed Surface Level
- Top of Wall Level
- Finished Floor Level (Internal)
- Stairs Up

PAVING

- Paving Type 1
- Paving Type 2
- Paving Type 3
- Paving Type 4
- Paving Type 5
- Paving Type 6
- Paving Type 7
- Paving Type 8
- Paving Type 9
- Paving Type 10
- Paving Type 11
- Paving Type 12
- Paving Type 13

STRUCTURES

- Fence Type 1
- Fence Type 2
- Fence Type 3
- Wall Type 1
- Wall Type 2
- Wall Type 3
- New Riverwall
- Masonry pier
- Existing Riverwall Retained
- Gate Type 1

FURNITURE

- Bollard Type 1
- Seat Type 1
- Seat Type 2
- Cycle Stand Type 1
- Handrail Type 1
- Tree Surround Type 1
- Bin Type 1

FEATURE

- Metrol Railway Track

LIGHTING

- Lighting Column
- Lighting Mast
- Lighting Mast
- Lighting Column
- Sports Lighting Column

PLANTING

- Short Mown Grass
- Planting Mix
- Rain Garden Planting
- Low Shrub Planting
- Wedge Type 1
- Existing Trees to be Retained
- Proposed Trees

Rev	Details	By	Date
D00	Issued for Information	RJ	03.11.2017
D01	Issued for Information	RJ	07.11.2017
D02	Issued for Information	GP	01.12.2017
D03	Issued for Information	RJ	11.01.2018
D04	Issued for Planning	RJ	02.02.2018
D05	Issued for Planning	RJ	09.02.2018

Notes

- Do not scale from drawing, use figured dimensions only
- All dimensions to be checked onsite
- This drawing to be read in conjunction with all other Gillespies drawings and specifications

0 5 10 25 50 m

Site plan

Project title: **STAG BREWERY**

Drawing number: **P10736-00-001-101**

Drawing Status: **DESIGN** Revision: **D04**

Date: 03.11.17 Scale: 1:500 @ A0 Drawn: RJ Checked: RC

Client: **DARTMOUTH CAPITAL**

Address: House 90-100 Snythe Street, London E9 6JU

GILLESPIES

1 St John's Square, London, ECH 4DH
 P: 0207 2532929 F: 0207 2533000 E: design.team@gillespies.co.uk



Drawing 4: Proposed Chalkers Corner Landscape GA Plan (Gillespies drawing no. P10736-00-001-111 Revision D03)

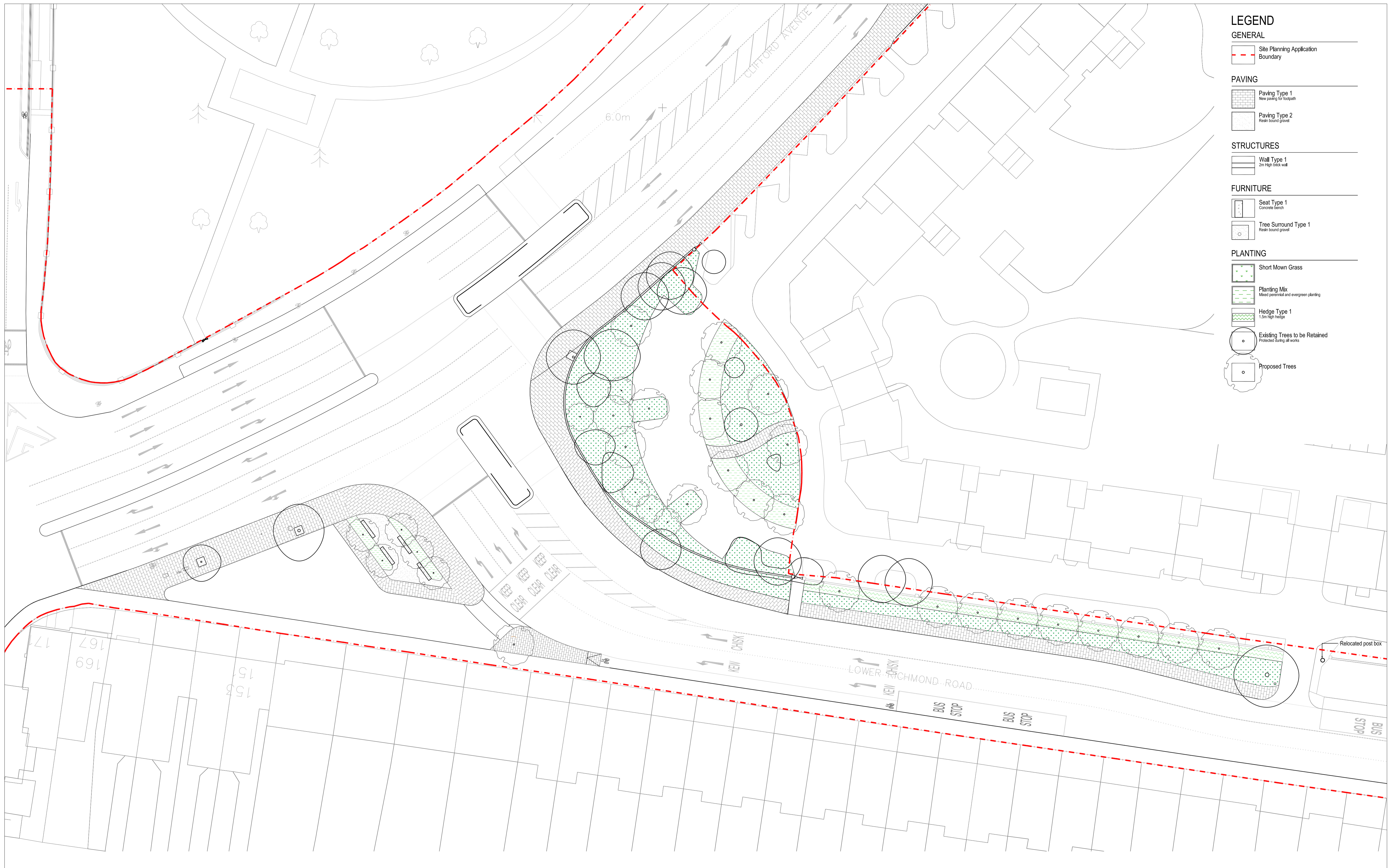

LEGEND

GENERAL

- Site Planning Application Boundary

PAVING

- Paving Type 1
New paving for footpath
- Paving Type 2
Resin bound gravel

STRUCTURES

- Wall Type 1
2m High brick wall

FURNITURE

- Seat Type 1
Concrete bench
- Tree Surround Type 1
Resin bound gravel

PLANTING

- Short Mown Grass
- Planting Mix
Mixed potential and evergreen planting
- Hedge Type 1
1.5m high hedge
- Existing Trees to be Retained
Protected during all works
- Proposed Trees

rev	details	by	date
D00	Issue for Information	RJ	07.11.2017
D01	Issue for Planning	RJ	25.01.2018
D02	Issue for Planning	RJ	02.02.2018
D03	Issue for Planning	RJ	09.02.2018

Notes

- 1.0 Do not scale from drawing, use figured dimensions only
- 1.1 All dimensions to be checked onsite
- 1.2 This drawing to be read in conjunction with all other Gillespies drawings and specifications

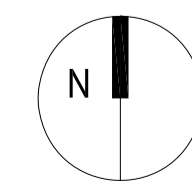

Project title
STAG BREWERY

Drawing title
Proposed Chalkers Corner Landscape GA Plan

Drawing number
P10736-00-001-111

Drawing Status
DESIGN

Date
07.11.17

Scale
1:250 @ A1

Revision
D03

Drawn
RJ

Checked
RC

© copyright GILLESPIES LLP, all rights reserved

Client
DARTMOUTH CAPITAL
Alameda House, 90-100 Sydney Street, London SW10 6NU

GILLESPIES
1 St Johns Square, London EC1M 4EH
P: 020 7253 2020 E: design.london@gillespies.com



Drawing 5: Tree Removal and Protection Plan (Sheet 1 of 2) (ref.10667-WIE-ZZ-XX-DR-L-7703-P02)

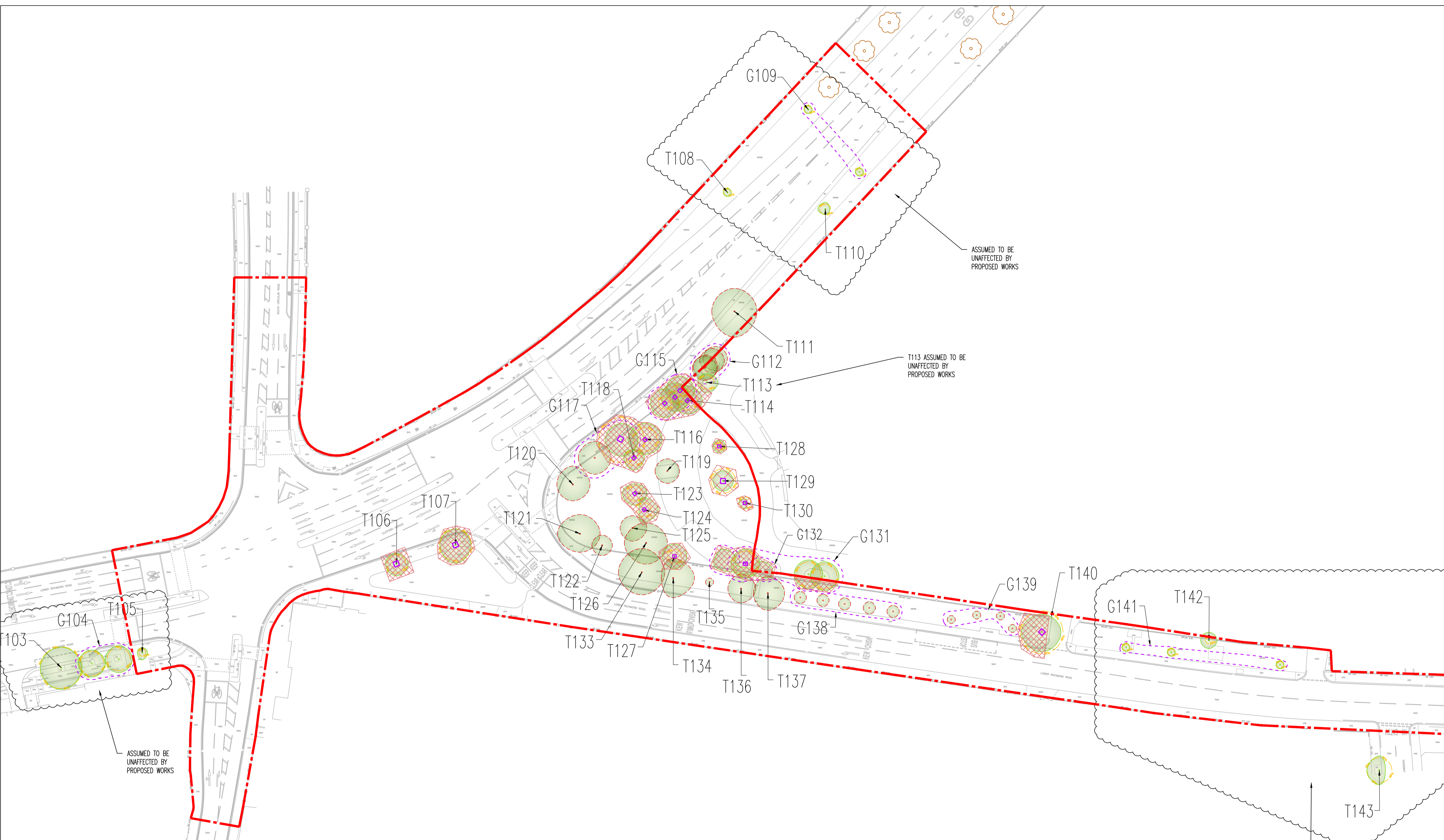

LEGEND

- TREES, GROUPS OR HEDGES TO BE RETAINED
- TREES, GROUPS OR HEDGES TO BE REMOVED
- ROOT PROTECTION AREAS (RPA)
- TREE PROTECTION Refer to Detail.
- CONSTRUCTION WORKING AREA (Including Demolition) Refer to notes for details.
- INDICATIVE EXTENT OF GROUPED FEATURE(S)
- SITE BOUNDARY
- TREES OUTSIDE OF SURVEY AREA

NOTES:

Successful retention of the eastern tree in G117 subject to detailed design of proposed retaining wall

ROOT PROTECTION AREA
 Root Protection Areas are calculated in accordance with BS5837: 2012. The precise morphology and disposition of roots may not be fully reflected by these areas, particularly where there are hard standings, however they provide a good indication of potential root constraint.

THIS DRAWING SHOULD BE READ IN CONJUNCTION WITH WATERMAN ARBORICULTURAL SURVEY REPORT

Rev	Date	Description	By
P01	09.02.18	PLANNING ISSUE	MC
	28.11.17	FOR COMMENT ISSUE	DD

Project: STAG BREWERY, MORTLAKE

TREE REMOVAL AND PROTECTION PLAN (SHEET 1 of 2)

Client: DARTMOUTH CAPITAL ADVISORS LTD



Merchants House Wapping Road Bristol BS1 4RW
 1 0117 937 8200
 mail@watermangroup.com www.watermangroup.com

PLANNING

Designed By	RA	Checked By	RA	Waterman Ref	WIE10667
Drawn By	DD	Date	NOVEMBER 2017	Scales @ A1	1:500

Project - Originator - Volume - Level - Type - Role - Number
 10667-WIE-ZZ-XX-DR-L-7703-P02 P02

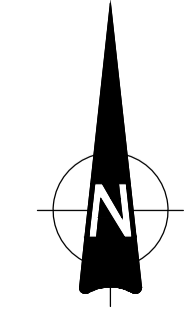
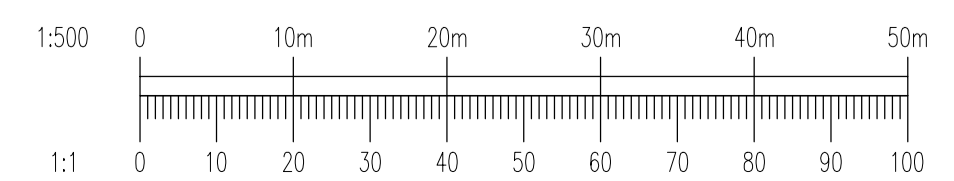
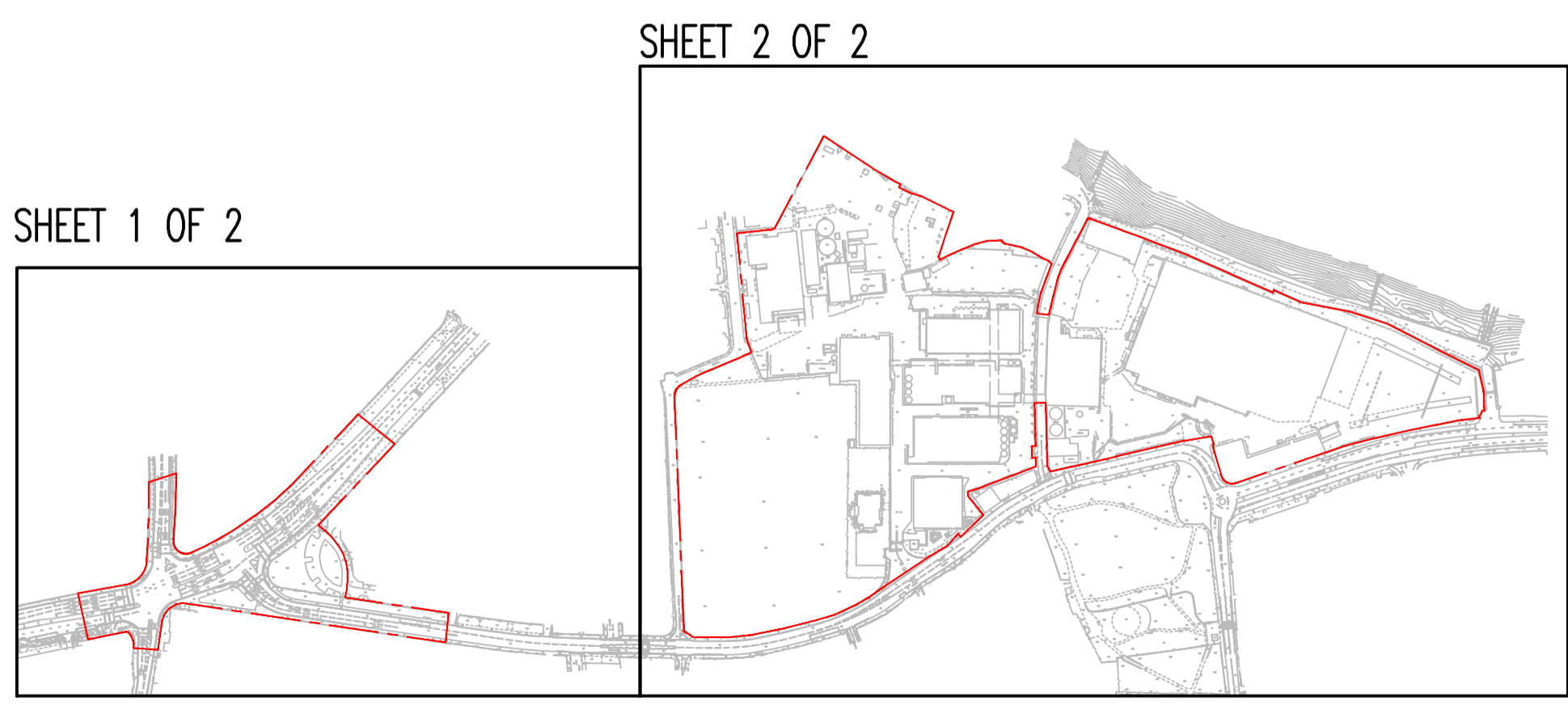



Drawing 6: Tree Removal and Protection Plan (Sheet 2 of 2) (ref. 10667-WIE-ZZ-XX-DR-L-7704-P02)

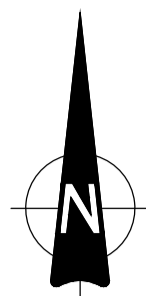

Trees outside Site Boundary considered to be unaffected by the proposed development.

Trees outside Site Boundary considered to be unaffected by the proposed development.

LEGEND

- TREES, GROUPS OR HEDGES TO BE RETAINED
Subject to detailed design.
- TREES, GROUPS OR HEDGES TO BE REMOVED
- ROOT PROTECTION AREAS (RPA)
- TREE PROTECTION
Refer to Detail.
Location of tree protection systems for retained trees subject to detailed design and therefore not shown (excludes School Application B where detail is shown)
- CONSTRUCTION WORKING AREA (including Demolition)
Refer to notes for details.
Subject to detailed design and therefore not shown (excludes School Application B where detail is shown)
- INDICATIVE EXTENT OF GROUPED FEATURE(S)
- SITE BOUNDARY
- TREES OUTSIDE OF SURVEY AREA

NOTES:

ROOT PROTECTION AREA
Root Protection Areas are calculated in accordance with BS5837: 2012. The precise morphology and disposition of roots may not be fully reflected by these areas, particularly where there are hard standings, however they provide a good indication of potential root constraint.

THIS DRAWING SHOULD BE READ IN CONJUNCTION WITH WATERMAN ARBORICULTURAL SURVEY REPORT

SHEET 2 OF 2

SHEET 1 OF 2

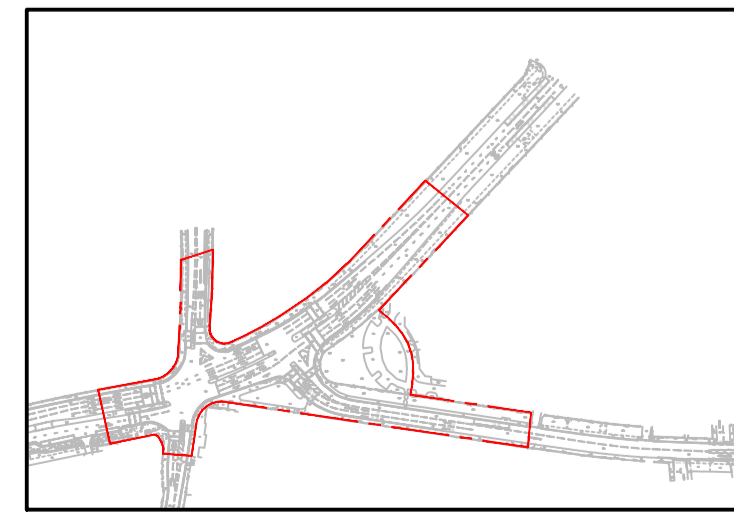

P02	09.02.18	PLANNING ISSUE	MC
P07	28.11.17	FOR COMMENT ISSUE	LB
Rev	Date	Description	By

Project: STAG BREWERY, MORTLAKE

TREE REMOVAL AND PROTECTION PLAN (SHEET 2 of 2)

Client: DARTMOUTH CAPITAL ADVISORS LTD



Merchants House Wapping Road Bristol BS1 4RW
0117 937 8200
mail@watermangroup.com www.watermangroup.com

PLANNING

Designed By	RA	Checked By	RA	Waterman Ref	WIE10667
Drawn By	LB	Date	NOVEMBER 2017	Scales @ A1	NOT TO SCALE

Project - Originator - Volume - Level - Type - Role - Number	Revision
10667-WIE-ZZ-XX-DR-L-7704	P02



APPENDICES

A. Cascade Chart for Tree Quality Assessment (extract from BS5837:2012)

TREES FOR REMOVAL				
Category and Definition	Criteria			Identification on Plan
<p>Category U</p> <p>Those in such a condition that they cannot realistically be retained as living trees in the context of the current land use for longer than 10 years.</p>	<ul style="list-style-type: none"> Trees that have a serious, irremediable, structural defect, such that their early loss is expected due to collapse, including those that will become unviable after removal of other category trees (i.e. where, for whatever reason, the loss of companion shelter cannot be mitigated by pruning); Trees that are dead or are showing signs of significant, immediate, and irreversible overall decline; and Trees infected with pathogens of significance to the health and/or safety of other trees nearby, or very low quality trees suppressing adjacent trees of better quality. <p>NOTE: Category U trees can have existing or potential conservation value which it might be desirable to preserve.</p>			DARK RED
TREES TO BE CONSIDERED FOR RETENTION				
Category and Definition	Criteria - Subcategories			Identification on Plan
	1 Mainly Arboricultural Values	2 Mainly Landscape Values	3 Mainly Cultural Values, including Conservation	
<p>Category A</p> <p>Trees of high quality with an estimated remaining life expectancy minimum of at least 40 years.</p>	Trees that are particularly good examples of their species, especially if rare or unusual, or essential components of groups, or of formal or semi-formal arboricultural features (e.g. the dominant and / or principal trees within an avenue).	Trees, groups or woodlands of particular visual importance as arboricultural and / or landscape features.	Trees, groups or woodlands of significant conservation, historical, commemorative or other value (e.g. veteran trees or wood-pasture).	LIGHT GREEN
<p>Category B</p> <p>Trees of moderate quality with an estimated remaining life expectancy of at least 20 years.</p>	Trees that might be included in category A, but are downgraded because of impaired condition (e.g. presence of significant though remediable defects, including unsympathetic past management and storm damage), such that they are unlikely to be suitable for retention for beyond 40 years; or trees lacking the special quality necessary to merit the category A designation.	Trees present in numbers, usually as groups or woodlands, such that they attract a higher collective rating than they might as individuals; or trees occurring as collectives but situated so as to make little visual contribution to the wider locality.	Trees with material conservation or other cultural value.	MID BLUE
<p>Category C</p> <p>Trees of low quality with an estimated remaining life expectancy of at least 10 years, or young trees with a stem diameter below 150mm.</p>	Unremarkable trees of very limited merit or such impaired condition that they do not qualify in higher categories.	Trees present in groups or woodlands, but without this conferring on them significantly greater collective landscape value; and/or trees offering low or only temporary / transient landscape benefits.	Trees with no material conservation or other cultural value.	GREY

B. Tree Survey Table

Ref. No	Species	Est. Height (m)	Stem Dia. (mm)	Canopy Spread (m)				First significant branch (m)	Canopy Clearance (m)	Physiological Condition	Age	Observations and Conditions	Preliminary Management Recommendations	Est. Remaining Contribution (yrs)	Category
				N	S	E	W								
T1	False acacia (<i>Robinia pseudoacacia</i>)	8.0	325	2.3*	3.6	3.8	3.1	2.5 Av.	2.2 (E)	Poor	EM	Growing in small island tree pit near north west Site boundary of the Stag Brewery component of the Site on edge of hardstanding. Thin canopy with bark loss and pruning wounds visible. May be dead? A large secondary branch is torn away at the base with extensive decay visible.	Of nominal habitat value in decline / as standing deadwood.	<10	C2/3

Ref. No	Species	Est. Height (m)	Stem Dia. (mm)	Canopy Spread (m)				First significant branch (m)	Canopy Clearance (m)	Physiological Condition	Age	Observations and Conditions	Preliminary Management Recommendations	Est. Remaining Contribution (yrs)	Category
				N	S	E	W								
T2	Sycamore (<i>Acer pseudoplatanus</i>)	10.0	M/S (4), 205, 160, 180, 200	1.2*	4.5	4.1	4.3	2.0 (S)	2.5 (S)	Fair	SM	Growing in small island tree pit near north west Site boundary of the Stag Brewery component of the Site on edge of hardstanding area. Multi-stem (M/S) from base with 4 main trunks rising up. Occasional historic pruning wounds visible on N side over footpath with cavities visible. Minor ivy growth becoming established.	Of general amenity / screening value on Site boundary and potential habitat value to bats. Monitor trunk junctions for weakness and pruning wounds for signs of decay. Sever ivy and remove from lower 1m of trunk.	20+	C2/3

Ref. No	Species	Est. Height (m)	Stem Dia. (mm)	Canopy Spread (m)				First significant branch (m)	Canopy Clearance (m)	Physiological Condition	Age	Observations and Conditions	Preliminary Management Recommendations	Est. Remaining Contribution (yrs)	Category
				N	S	E	W								
T3	London Plane (<i>Platanus x hispanica</i>)	14.0	735	8.0*	9.0	8.5	9.2	4.0 (W)	Av. 3.5	Fair / Good	M	Growing in small island tree pit near north west Site boundary of the Stag Brewery component of the Site on edge of hardstanding. Balanced form. Some ivy becoming established on main trunk. Historic pruning wounds visible with large wound on E side at 4m Ht. with wound wood development but decay also visible.	Of significant amenity value and potential on Site boundary. Sever ivy at base and remove from lower 1m of trunk. Monitor pruning wounds for decay.	40+	A2
T4	London Plane (<i>Platanus hispanica</i>)	14.0	470	3.0*	8.0	7.7	7.4	2.4 (S)	3.0 (S)	Fair / Good	EM	Growing in small island tree pit near north west Site boundary of the Stag Brewery component of the Site and beginning to compete with T5. Canopy slightly bias to S with some historic pruning wounds visible with wound wood development. Ivy becoming established on main trunk.	Of amenity value and potential on Site boundary. Sever ivy at base and remove from lower 1m of trunk. Monitor pruning wounds for signs of decay.	40+	B2

Ref. No	Species	Est. Height (m)	Stem Dia. (mm)	Canopy Spread (m)				First significant branch (m)	Canopy Clearance (m)	Physiological Condition	Age	Observations and Conditions	Preliminary Management Recommendations	Est. Remaining Contribution (yrs)	Category
				N	S	E	W								
T5	London Plane (<i>Platanus x hispanica</i>)	13.0	540	7.3	7.0	8.2	8.3	2.0 (N&S)	4.0 Av.	Fair / Good	M	Growing in small island tree pit within area of hard standing in the north west of the Stag Brewery component of the Site. Balanced form and beginning to compete with T4 and T6. Minor historic pruning wounds visible.	Of amenity value and potential as part of semi-formed group. Monitor pruning wounds for signs of decay.	40+	B2
T6	Fastigate Hornbeam (<i>Carpinus betulus</i> 'Fastigiata')	13.0	375	4.8	3.6	4.7	3.3	1.7 Av.	3.0 Av.	Fair / Good	EM	Growing in small island tree pit within area of hard standing in the north west of the Stag Brewery component of the Site. General balanced form and beginning to compete with T5. Some historic pruning wounds and mechanical damage with modest wound wood development.	Of amenity value and potential as part of semi-formed group. Monitor pruning wounds for signs of decay.	40+	B2

Ref. No	Species	Est. Height (m)	Stem Dia. (mm)	Canopy Spread (m)				First significant branch (m)	Canopy Clearance (m)	Physiological Condition	Age	Observations and Conditions	Preliminary Management Recommendations	Est. Remaining Contribution (yrs)	Category
				N	S	E	W								
T7	London Plane (<i>Platanus x hispanica</i>)	14.0	525	8.2	6.8	6.7	9.7	Av. 4.0	Av. 3.0	Fair / Good	M	Growing within an island tree pit within area of hardstanding in the north west of the Stag Brewery component of the Site. Open grown with a generally balanced canopy. Minor historic pruning wounds visible with wound wood development.	Of amenity value and potential to location. Monitor pruning wounds for decay.	40+	B2
T8	London Plane (<i>Platanus x hispanica</i>)	11.0	405	7.5	6.6	7.7	2.7	2.5 (S)	2.5 (S)	Fair / Good	EM	Growing in linear area of soft landscaping within hardstanding as part of a short line of similar aged trees in the north west of the Stag Brewery component of the Site. Loose kerb edges present around tree pit. Beginning to compete with adjacent tree. Historic pruning wounds visible with some wound wood development.	Of amenity value and potential as part of an informal group. Monitor pruning wounds for signs of decay.	40+	B2

Ref. No	Species	Est. Height (m)	Stem Dia. (mm)	Canopy Spread (m)				First significant branch (m)	Canopy Clearance (m)	Physiological Condition	Age	Observations and Conditions	Preliminary Management Recommendations	Est. Remaining Contribution (yrs)	Category
				N	S	E	W								
T9	London Plane (<i>Platanus x hispanica</i>)	13.0	425	8.5	7.1	4.9	3.2	3.5 (S)	3.0 (S)	Fair / Good	EM	Growing in linear area of soft landscaping within hardstanding as part of a short line of similar aged trees in the north west of the Stag Brewery component of the Site. Loose kerb edges present around tree pit. Beginning to compete with adjacent trees. Historic pruning wounds visible with some wound wood development but some cavity formation.	Of amenity value and potential as part of an informal group and of potential habitat value to bats. Monitor pruning wounds for signs of decay. In the longer term, consider for removal to allow for the development of adjacent T8 and T10.	20+	B2/3

Ref. No	Species	Est. Height (m)	Stem Dia. (mm)	Canopy Spread (m)				First significant branch (m)	Canopy Clearance (m)	Physiological Condition	Age	Observations and Conditions	Preliminary Management Recommendations	Est. Remaining Contribution (yrs)	Category
				N	S	E	W								
T10	London Plane (<i>Platanus x hispanica</i>)	13.0	455	8.4	6.7	2.3	5.2	4.0 (NE)	3.5 (S)	Fair / Good	EM	Growing in linear area of soft landscaping within hardstanding as part of a short line of similar aged trees in the north west of the Stag Brewery component of the Site. Loose kerb edges present around tree pit. Beginning to compete with adjacent trees. Historic pruning wounds visible with some wound wood development but some cavity formation.	Of amenity value and potential as part of an informal group. Monitor pruning wounds for signs of decay.	40+	B2
T11	London Plane (<i>Platanus x hispanica</i>)	12.0	410	7.7	6.4	28	6.3	3.5 (S)	Av. (3.0)	Fair / Good	EM	Growing in linear area of soft landscaping within hardstanding as part of a short line of similar aged trees in the north west of the Stag Brewery component of the Site. Beginning to compete with adjacent trees. Minor historic pruning wounds visible now mostly occluded.	Of amenity value and potential as part of an informal group. Monitor pruning wounds for signs of decay.	40+	B2

Ref. No	Species	Est. Height (m)	Stem Dia. (mm)	Canopy Spread (m)				First significant branch (m)	Canopy Clearance (m)	Physiological Condition	Age	Observations and Conditions	Preliminary Management Recommendations	Est. Remaining Contribution (yrs)	Category
				N	S	E	W								
T12	Sycamore (<i>Acer pseudoplatanus</i>)	6.0	265	4.2	3.7	3.1	3.1	Av. 2.3	2.2 Av.	Fair	SM	Younger tree growing on edge of area of soft landscaping set within hardstanding in the north west of the Stag Brewery component of the Site. Beginning to compete with adjacent tree. Historic pruning wounds and mechanical damage visible, especially to S side at base with decay occurring.	Of general amenity value. Consider for removal to allow the development of adjacent tree.	10+	U
T13	Small-leaved Lime (<i>Tilia cordata</i>)	5.0	Av. 20No. x 40 (1,400* at base of trunk).	Av. 2m				0.0	0.0	Fair	OM	Stump of large tree growing in linear area of soft landscaping in the north west of the Stag Brewery component of the Site. Now regenerating vigorously as an impromptu coppice stool with much hollowed/decayed base. Estimated approx. 3-5 years regrowth/regeneration since coppicing.	Of arboricultural interest/potential . Monitor decay and manage as a coppice stool.	20+	C1

Ref. No	Species	Est. Height (m)	Stem Dia. (mm)	Canopy Spread (m)				First significant branch (m)	Canopy Clearance (m)	Physiological Condition	Age	Observations and Conditions	Preliminary Management Recommendations	Est. Remaining Contribution (yrs)	Category
				N	S	E	W								
T14	London Plane (<i>Platanus x hispanica</i>)	12.0	415	7.4	6.5	6.6	2.5	Av. 3.0	1.7 (N)	Fair / Good	EM	Growing in linear area of soft landscaping within area of hard standing in the north west of the Stag Brewery component of the Site. Beginning to compete with adjacent tree. Historic pruning wounds with wound wood developing and occasional crossing branches. Branch tops are touching temporary cabin roof to north.	Of amenity value in association with adjacent trees. Monitor pruning wounds for decay.	40+	B2
T15	London Plane (<i>Platanus x hispanica</i>)	12.0	285	7.3	5.0	3.7	4.1	3.0 (E)	2.5 (N)	Fair / Good	SM	Growing in area of soft landscaping within area of hard standing in the north west of the Stag Brewery component of the Site. Beginning to compete with adjacent tree. Slight lean to west.	Of general amenity value in association with adjacent trees. In the longer term consider for removal to allow for the development of adjacent T14.	20+	B2

Ref. No	Species	Est. Height (m)	Stem Dia. (mm)	Canopy Spread (m)				First significant branch (m)	Canopy Clearance (m)	Physiological Condition	Age	Observations and Conditions	Preliminary Management Recommendations	Est. Remaining Contribution (yrs)	Category
				N	S	E	W								
T16	Sycamore (<i>Acer pseudoplatanus</i>)	10.0	240 + 200	4.5	4.6	4.4	2.5	1.8 (SW)	2.5 (S)	Fair	EM	Growing in linear area of soft landscaping within area of hardstanding in the north west of the Stag Brewery component of the Site. Beginning to compete with adjacent tree. Forks into two main trunks at approx. 0.6m Ht. with third trunk now lost with wound wood, decay and a cavity visible. Shallow surface roots visible to north side. Leader shoot has been torn out of one of the trunks at high level.	Of general amenity value to Site in association with adjacent trees. Monitor mechanical damage for decay.	20+	C2
T17	Sycamore (<i>Acer pseudoplatanus</i>)	10.0	260	3.4	3.3	3.9	3.3	2.0 (E)	2.0 (S)	Fair	SM	Growing in linear area of soft landscaping within area of hard standing in the north west of the Stag Brewery component of the Site. Beginning to compete with adjacent trees. Many crossing/twisted branches and mechanical damage visible including large linear wound – may be from a historical lightning strike with wound wood development. Some pruning wounds visible.	Of general amenity value to Site in association with adjacent trees. Monitor mechanical wounds for decay. Consider formative pruning to alleviate crossing branches.	20+	C2

Ref. No	Species	Est. Height (m)	Stem Dia. (mm)	Canopy Spread (m)				First significant branch (m)	Canopy Clearance (m)	Physiological Condition	Age	Observations and Conditions	Preliminary Management Recommendations	Est. Remaining Contribution (yrs)	Category
				N	S	E	W								
T18	Small-leaved Lime (<i>Tilia cordata</i>)	5.0	200No. x 30Av* (1,200* & 1,000* at base of trunk)	Average 3.5				0.0	0.1 Av.	Fair	OM	Stump of large tree growing in linear area of soft landscaping in the north west of the Stag Brewery component of the Site. Now regenerating vigorously as an impromptu coppice stool with much hollowed/decayed base. Estimated approx. 3-5 years regrowth/regeneration since coppicing.	Of arboricultural interest/potential . Monitor decay and manage as a coppice stool.	20+	C1
T19	Sycamore (<i>Acer pseudoplatanus</i>)	10.0	245	3.5* (1.2 from fence)	3.6	3.3	4.5	2.0 Av.	3.0 (E&W)	Fair / Good	SM	Self-sown tree (?) growing on Site boundary on edge of area of hardstanding in the north west of the Stag Brewery component of the Site. General balanced form with historic pruning wounds visible and minor suckers to base. Some shallow surface roots visible with minor deflection to adjacent hard surfaces.	Of amenity and screening value on Site boundary. Remove sucker growth and monitor pruning wounds for decay and adjacent surfaces for further deflection.	20+	C2

Ref. No	Species	Est. Height (m)	Stem Dia. (mm)	Canopy Spread (m)				First significant branch (m)	Canopy Clearance (m)	Physiological Condition	Age	Observations and Conditions	Preliminary Management Recommendations	Est. Remaining Contribution (yrs)	Category
				N	S	E	W								
T20	Wild Cherry (<i>Prunus avium</i>)	11.0	260	4.0* (Over-hanging boundary wall)	2.7	4.0* (Over boundary wall)	5.4	Av. 2.5	0.0 (W)	Fair / Good	SM	Growing on Site boundary on edge of area of hard standing in the north west of the Stag Brewery component of the Site. Generally balanced canopy with occasional crossing branches and low canopy tips. Occasional historic pruning wounds and little / no wound wood development visible and possible decay on north and north west sides.	Of general amenity and screening value on Site boundary. Monitor pruning wounds for decay.	20+	C2
T21	Whitebeam (<i>Sorbus aria</i>)	7.0	225	2.4	3.0	2.3	2.8	1.8 (W)	1.8 (W)	Fair / Good	SM	Growing near Site boundary on edge of area of hard standing in the north west of the Stag Brewery component of the Site. Generally balanced canopy and some historic pruning wounds but little wound wood visible. Suckering from base from hawthorn (<i>Crataegus sp.</i>) rootstock. Base of trunk partly hidden by deep layer of leaf litter.	Of general amenity and screening value on Site boundary. Monitor pruning wounds for decay. Remove suckers and remove leaf litter from base of trunk.	20+	C2

Ref. No	Species	Est. Height (m)	Stem Dia. (mm)	Canopy Spread (m)				First significant branch (m)	Canopy Clearance (m)	Physiological Condition	Age	Observations and Conditions	Preliminary Management Recommendations	Est. Remaining Contribution (yrs)	Category
				N	S	E	W								
T22	Whitebeam (<i>Sorbus aria</i>)	6.0	125	2.9	2.6	2.6	2.2	2.2 (S)	1.6 (N&S)	Fair / Good	Y	Young tree growing on edge of area of hardstanding in the north west of the Stag Brewery component of the Site. Still tied to stakes with generally balanced canopy. Deflection to adjacent hard surfacing from root development.	Of general amenity value. Monitor deflection to adjacent surfaces. Remove all stakes and ties.	10+	C2
T23	Himalayan Birch (<i>Betula utilis</i>)	7.0	260	Av. 3.5 Branches				4.0 (N&S)	4.0 Av.	Poor	EM	Dead in-situ with fallen branches / limbs at base located in the north west of the Stag Brewery component of the Site. Birch polypore (<i>Piptoporus betulinus</i>) bracket fungus visible on main stem.	Of nominal value as deadwood resource.	<10	C3
T24	Wild Cherry (<i>Prunus avium</i>)	7.0	230	4.5	4.4	4.0	4.0*	Av. 2.3	2.0 Av.	Fair / Good	SM	Growing on edge of area of hardstanding in the north west of the Stag Brewery component of the Site. Canopy biased to west with occasional pruning wounds and torn branch stubs visible. Low hanging canopy tips.	Of general amenity value. Monitor pruning wounds for decay. Consider removal of adjacent concrete surface to improve growing conditions.	20+	C2

Ref. No	Species	Est. Height (m)	Stem Dia. (mm)	Canopy Spread (m)				First significant branch (m)	Canopy Clearance (m)	Physiological Condition	Age	Observations and Conditions	Preliminary Management Recommendations	Est. Remaining Contribution (yrs)	Category
				N	S	E	W								
T25	London Plane (<i>Platanus x hispanica</i>)	14.0	545	7.0	8.0*	9.0	7.7	2.5 (S)	2.0 (E&W)	Fair / Good	M	Growing on edge of area of hard standing in short line of similar aged trees in the north west of the Stag Brewery component of the Site. Some historic pruning wounds visible and regeneration overhanging adjacent building. Beginning to compete with adjacent T26.	Of general amenity value. Monitor pruning wounds for decay. Consider removal of adjacent concrete surface to improve growing conditions.	40+	B2

Ref. No	Species	Est. Height (m)	Stem Dia. (mm)	Canopy Spread (m)				First significant branch (m)	Canopy Clearance (m)	Physiological Condition	Age	Observations and Conditions	Preliminary Management Recommendations	Est. Remaining Contribution (yrs)	Category
				N	S	E	W								
T26	London Plane (<i>Platanus x hispanica</i>)	13.0	420	7.0	5.0	7.1	8.4	3.5 Av	2.0 (E&W)	Fair / Good	EM	Growing on edge of area of hard standing in short line of similar aged trees in the north west of the Stag Brewery component of the Site. Some historic pruning wounds visible with regeneration. Minor crossing branches within canopy.	Of general amenity value. Monitor pruning wounds for decay. Consider removal of adjacent concrete surface to improve growing conditions. Consider formative pruning to alleviate crossing branches.	40+	B2

Ref. No	Species	Est. Height (m)	Stem Dia. (mm)	Canopy Spread (m)				First significant branch (m)	Canopy Clearance (m)	Physiological Condition	Age	Observations and Conditions	Preliminary Management Recommendations	Est. Remaining Contribution (yrs)	Category
				N	S	E	W								
T27	London Plane (<i>Platanus x hispanica</i>)	13.0	480	6.5	5.3	7.6	5.1	5.0 (W)	3.5 Av.	Fair / Good	EM	Growing on edge of area of hard standing in short line of similar aged trees in the north west of the Stag Brewery component of the Site. Some historic pruning wounds visible with regeneration.	Of general amenity value. Monitor pruning wounds for decay. Consider removal of adjacent concrete surface to improve growing conditions.	40+	B2
T28	Ash (<i>Fraxinus excelsior</i>)	15.0+	300	4.7	3.7	1.0	4.3	3.0 (N)	5.0 (N&W)	Fair / Good	M	Growing in low raised planted within area of hard standing in the north west of the Stag Brewery component of the Site. Competing / suppressed by adjacent T29. Minor deflection to adjacent retaining wall to west and south and hard surface to north through root development.	Of general amenity value. Consider for removal to allow development of adjacent T29.	10+	U

Ref. No	Species	Est. Height (m)	Stem Dia. (mm)	Canopy Spread (m)				First significant branch (m)	Canopy Clearance (m)	Physiological Condition	Age	Observations and Conditions	Preliminary Management Recommendations	Est. Remaining Contribution (yrs)	Category
				N	S	E	W								
T29	London Plane (<i>Platanus x hispanica</i>)	15.0+	670	9.6	7.9	9.1	7.4	3.5 (NE & SW)	3.0 (N)	Fair / Good	M	Growing in low raised planting bed in close proximity to T28 and T30 in the north west of the Stag Brewery component of the Site. Beginning to compete with / suppress adjacent trees. Deflection / damage to wall to north and north west sides. Generally high canopy with occasional historic pruning wounds now mostly occluded. Some deflection to hard surface to north.	Of high amenity and screening value near Site boundary. Monitor pruning wounds for decay and retaining wall for further damage / deflection.	40+	A2
T30	Whitebeam (<i>Sorbus aria</i>)	6.0	195	1.8	4.4	3.2	2.5	1.7 Av.	2.0 (S)	Fair	Y	Growing in low raised planting bed in the north west of the Stag Brewery component of the Site. In close proximity to T29 and being suppressed by it resulting in a canopy biased to the south. Historic pruning wounds with some wound wood development but also cavities and decay visible.	Of general amenity value. Consider for removal to allow for the development of adjacent T29.	10+	U

Ref. No	Species	Est. Height (m)	Stem Dia. (mm)	Canopy Spread (m)				First significant branch (m)	Canopy Clearance (m)	Physiological Condition	Age	Observations and Conditions	Preliminary Management Recommendations	Est. Remaining Contribution (yrs)	Category
				N	S	E	W								
T31	London Plane (<i>Platanus x hispanica</i>)	11.0	370	5.7	5.5*	3.9	5.2	4.0 (S)	3.0 (N&S)	Fair / Good	SM	Growing within kerbed tree pit adjacent to internal boundary wall and within area of hardstanding in the north west of the Stag Brewery component of the Site. Minor historic pruning wounds visible. Canopy overhangs adjacent building and is beginning to compete with adjacent T32.	Of general amenity value within the Site in association with adjacent trees.	20+	C2
T32	Swedish Whitebeam (<i>Sorbus x intermedia</i>)	7.0	280	3.3	2.3*	2.8	2.9	Av. 2m	Av 3.0	Fair / Good	SM	Growing within kerbed tree pit adjacent to internal boundary wall and within area of hardstanding in the north west of the Stag Brewery component of the Site. Historic pruning wounds visible on lower trunk and canopy with wound wood and possible decay visible.	Of general amenity value within the Site in association with adjacent trees. Monitor pruning wounds for decay.	10+	C2
T33	London Plane (<i>Platanus x hispanica</i>)	9.0	190	2.7	2.4*	4.2	2.3	3.0 (E&W)	1.8 (E)	Fair / Good	Y	Growing within kerbed tree pit adjacent to internal boundary wall and within area of hardstanding in the north west of the Stag Brewery component of the Site. Minor historic pruning wounds visible. Leans to west.	Of general amenity value in association with adjacent trees.	20+	C2

Ref. No	Species	Est. Height (m)	Stem Dia. (mm)	Canopy Spread (m)				First significant branch (m)	Canopy Clearance (m)	Physiological Condition	Age	Observations and Conditions	Preliminary Management Recommendations	Est. Remaining Contribution (yrs)	Category
				N	S	E	W								
T34	London Plane (<i>Platanus x hispanica</i>)	8.0	230	4.6	3.1*	3.7	3.9	3.2 (N&S)	2.0 (N&E)	Fair / Good	Y	Growing within kerbed tree pit adjacent to internal boundary wall and within area of hardstanding in the north west of the Stag Brewery component of the Site. Minor historic pruning wounds visible. Leans to west.	Of general amenity value in association with adjacent trees.	20+	C2
T35	Unidentified species	11.0	190	2.0	1.4	2.0	2.1	1.8 (E)	1.6 (N)	Fair	Y	Growing within small informal tree put within area of precast concrete access / loading area in the north west of the Stag Brewery component of the Site. Thin canopy with historic pruning wounds and wound wood / decay visible.	Of nominal potential habitat value to roosting bats.	10+	C2/3

Ref. No	Species	Est. Height (m)	Stem Dia. (mm)	Canopy Spread (m)				First significant branch (m)	Canopy Clearance (m)	Physiological Condition	Age	Observations and Conditions	Preliminary Management Recommendations	Est. Remaining Contribution (yrs)	Category
				N	S	E	W								
T36	Ash (<i>Fraxinus excelsior</i>)	11.0	180	1.3	1.9	2.7	1.5	3.0 (S)	4.0 (S)	Fair / Poor	Y	Growing within small informal tree pit within area of precast concrete access / loading area in the north west of the Stag Brewery component of the Site. Numerous historic pruning and mechanical wounds including a large linear wound to the trunk on the south side with a large cavity and decay present (likely the result of vehicular impact). Deadwood present within canopy.	Of habitat value in decline.	10+	C3
T37	Sycamore (<i>Acer pseudoplatanus</i>)	15.0	370* Over Ivy	5.0*	5.6	5.5	5.2	4.0 (S)	4.0 (S)	Fair / Good	EM	Growing in belt of soft landscaping adjacent to car park and Site boundary wall in the north west of the Stag Brewery component of the Site. In competition with T38 and growing to the west. Heavy ivy growth covering main trunk and lower canopy, limiting further inspection.	Of general screening and amenity value within the Site and of potential habitat value to bats. Consider severing ivy and removing from lower 1.0m of trunk and re-inspect.	20+	C2/3

Ref. No	Species	Est. Height (m)	Stem Dia. (mm)	Canopy Spread (m)				First significant branch (m)	Canopy Clearance (m)	Physiological Condition	Age	Observations and Conditions	Preliminary Management Recommendations	Est. Remaining Contribution (yrs)	Category
				N	S	E	W								
T38	Ornamental Fruit Tree	12.0	190* Over Ivy	1.5	1.8	1.5	1.8	2.5 (S)	3.0 (S)	Fair	Y	Growing in belt of soft landscaping adjacent to car park and Site boundary wall in the north west of the Stag Brewery component of the Site. In competition with T37 and growing to the west. Heavy ivy growth covering main trunk and lower canopy, limiting further inspection.	Of general screening and amenity value within the Site and of potential habitat value to bats. Consider severing ivy and removing from lower 1m of trunk and re-inspecting.	10+	C2/3
T39	Elder (<i>Sambucus nigra</i>)	8.0	235	2.0*	2.6	1.8	3.7	Av. 2.0	1.8 (W)	Fair	M	Growing in belt of soft landscaping adjacent to carpark and beginning to compete with T38 and T40 in the north west of the Stag Brewery component of the Site. Thinning canopy.	Of general screening and amenity value within Site.	20+	C2

Ref. No	Species	Est. Height (m)	Stem Dia. (mm)	Canopy Spread (m)				First significant branch (m)	Canopy Clearance (m)	Physiological Condition	Age	Observations and Conditions	Preliminary Management Recommendations	Est. Remaining Contribution (yrs)	Category
				N	S	E	W								
T40	Holly (<i>Ilex aquifolium</i>)	7.0	160*	2.4	2.8	3.2	2.7	Av. 2.5	1.4 (E)	Fair / Good	Y	Growing within belt of soft landscaping adjacent to carpark and boundary wall in the north west of the Stag Brewery component of the Site. Slightly suppressed by adjacent T37. Ivy becoming established on main trunk.	Of general screening and amenity value within Site. Sever ivy at base and remove from lower 1m of trunk.	10+	C2/3
T41	London Plane (<i>Platanus x hispanica</i>)	7.0	1400* (At base of trunk)	3.2 Av.				0.1 Av (M/S)	0.1 Av.	Fair/ Poor	OM	Felled tree stump with vigorous regeneration with several main shoots rising up in mutual competition located in the north west of the Stag Brewery component of the Site. Decay visible within main stool.	Of screening value and arboricultural interest. Monitor stool for decay and consider management as a coppice stool.	20+	C1/2

Ref. No	Species	Est. Height (m)	Stem Dia. (mm)	Canopy Spread (m)				First significant branch (m)	Canopy Clearance (m)	Physiological Condition	Age	Observations and Conditions	Preliminary Management Recommendations	Est. Remaining Contribution (yrs)	Category
				N	S	E	W								
G42	2No. Ash (<i>Fraxinus excelsior</i>), 6No. Tree of Heaven (<i>Ailanthus altissima</i>)	10.0 to 15.0+	300-370	5.0 Av. (Ash 7.5 Av.)				Varies	3.0 (min. S extent)	Fair	SM to EM	Belt of trees in mutual competition growing adjacent to boundary wall and carpark in the north west of the Stag Brewery component of the Site. Slightly thin canopied within group. Some ivy becoming established on trunk and suckering growth present on the tree of heaven specimens. High canopies on all.	Of amenity and screening value as a group. Consider thinning out to allow for the development of better specimens. Sever ivy at base and remove from lower 1m of trunk.	20+	B2

Ref. No	Species	Est. Height (m)	Stem Dia. (mm)	Canopy Spread (m)				First significant branch (m)	Canopy Clearance (m)	Physiological Condition	Age	Observations and Conditions	Preliminary Management Recommendations	Est. Remaining Contribution (yrs)	Category
				N	S	E	W								
T43	Tree of Heaven (<i>Alianthus altissima</i>)	15.0+	1100* + 400* stump @ base to E with regeneration	4.0*	4.0	6.2	4.7	5.0 (E)	5.0 (E)	Fair	OM?	Growing on boundary between car park and public highway (Ship Lane) in the north west of the Stag Brewery component of the Site. Within a narrow / linear planting bed as part of a short line of similar aged trees. Large secondary trunk to east removed previously with heavy regeneration and suckers. Slightly high / thin canopy and in competition with adjacent tree. Historic pruning wounds now mostly occluded.	Of amenity and screening value on boundary. Monitor pruning wounds for signs of decay. Remove suckering growth from base.	20+	B2

Ref. No	Species	Est. Height (m)	Stem Dia. (mm)	Canopy Spread (m)				First significant branch (m)	Canopy Clearance (m)	Physiological Condition	Age	Observations and Conditions	Preliminary Management Recommendations	Est. Remaining Contribution (yrs)	Category
				N	S	E	W								
T44	Tree of Heaven (<i>Alianthus altissima</i>)	15.0+	300* & 520*	3.1	3.6	6.3	4.8	6.0 (S)	8.0 (E)	Fair	M	Growing on boundary between car park and public highway (Ship Lane) in the north west of the Stag Brewery component of the Site. Within narrow/linear planting bed as part of a short line of similar aged trees. Low fork with two trunks twisted / crossing at approx. 2.0m Ht. In competition with adjacent tree with slightly thin / high canopy and suckering growth present at base. Historic pruning wounds visible with wound wood developing.	Of amenity and screening value on boundary. Monitor pruning wounds for signs of decay and remove suckering growth from base.	20+	B2

Ref. No	Species	Est. Height (m)	Stem Dia. (mm)	Canopy Spread (m)				First significant branch (m)	Canopy Clearance (m)	Physiological Condition	Age	Observations and Conditions	Preliminary Management Recommendations	Est. Remaining Contribution (yrs)	Category
				N	S	E	W								
T45	Tree of Heaven (<i>Alianthus altissima</i>)	15.0+	250* & 340	3.3	4.1	5.8	6.1	4.0 (W)	6.0 (N)	Fair	M	Growing on boundary between car park and public highway (Ship Lane) in the north west of the Stag Brewery component of the Site. Within narrow / linear planting bed as part of a short line of similar aged trees. Forks at base into two main trunks. In competition with adjacent trees with slightly high/open canopy developing. Historic pruning wounds visible with wound wood development. Suckering growth present at base.	Of amenity and screening value on boundary. Monitor pruning wounds for signs of decay and remove suckering growth from base.	20+	B2

Ref. No	Species	Est. Height (m)	Stem Dia. (mm)	Canopy Spread (m)				First significant branch (m)	Canopy Clearance (m)	Physiological Condition	Age	Observations and Conditions	Preliminary Management Recommendations	Est. Remaining Contribution (yrs)	Category
				N	S	E	W								
T46	Tree of Heaven (<i>Alianthus altissima</i>)	15.0+	205 & 435	3.2	5.2	4.9	5.7	5.0 (E)	3.0 (W)	Fair	M	Growing on boundary between car park and public highway (Ship Lane) in the north west of the Stag Brewery component of the Site. Within narrow / linear planting bed as part of a short line of similar aged trees. Forks at base into two main trunks. In competition with adjacent trees with slightly high / open canopy developing. Historic pruning wounds visible with wound wood development. Suckering growth present at base.	Of amenity and screening value on boundary. Monitor pruning wounds for signs of decay and remove suckering growth from base.	20+	B2
G47	3No. Holly (<i>Ilex aquifolium</i>)	5.0 to 11.0	250* Av.	2.5 Av.				Varies	Varies	Fair / Poor to Fair / Good	M?	Growing within linear planting bed on boundary between carpark and public highway (Ship Lane) in the north west of the Stag Brewery component of the Site. Forms understory to T43-T46. Variable quality with lost leader / dieback in central tree and northern-most tree is suppressed by adjacent tree.	Of general screening value on Site boundary.	10+	C2

Ref. No	Species	Est. Height (m)	Stem Dia. (mm)	Canopy Spread (m)				First significant branch (m)	Canopy Clearance (m)	Physiological Condition	Age	Observations and Conditions	Preliminary Management Recommendations	Est. Remaining Contribution (yrs)	Category
				N	S	E	W								
T48	London Plane (<i>Platanus x hispanica</i>)	15.0+	555	7.3	3.4	6.6	7.5	3.0 Av.	6.0 (E)	Fair	M	Growing in informal tree pit (approx. 1.2 x 1.5m in size) within area of precast concrete surfaced loading area and adjacent to Site boundary wall west of Ship Lane in the Stag Brewery component of the Site (approx. 0.5m east). Beginning to compete with adjacent tree. Historic pruning wounds and mechanical damage on lower trunk at 1.0-2.0m Ht on W and SW sides with wound wood development but cavities and decay also present. Canopy overhangs road on east side.	Of amenity and screening value on boundary as part of a line of similar aged trees. Monitor pruning wounds and mechanical damage for decay. Consider removal of some concrete at base to improve growing conditions.	40+	A2

Ref. No	Species	Est. Height (m)	Stem Dia. (mm)	Canopy Spread (m)				First significant branch (m)	Canopy Clearance (m)	Physiological Condition	Age	Observations and Conditions	Preliminary Management Recommendations	Est. Remaining Contribution (yrs)	Category
				N	S	E	W								
T49	London Plane (<i>Platanus x hispanica</i>)	15.0+	525	7.2	5.4	5.0	7.1	3.0 (E)	5.0 (E)	Fair / Good	M	Growing in informal tree pit (approx. 1.2 x 1.5m in size) within area of precast concrete surfaced loading area and adjacent to Site boundary wall west of Ship Lane in the Stag Brewery component of the Site (approx. 0.5m east). Beginning to compete with adjacent trees. Historic pruning wounds visible. Canopy overhangs road on east side. Possible water pocket at large branch junction at approx. 3.0m Ht.	Of amenity and screening value as a single line of trees. Monitor pruning wounds for decay and inspect trunk junction for presence of water and possible decay. Consider removal of some concrete at base to improve growing conditions.	40+	A2

Ref. No	Species	Est. Height (m)	Stem Dia. (mm)	Canopy Spread (m)				First significant branch (m)	Canopy Clearance (m)	Physiological Condition	Age	Observations and Conditions	Preliminary Management Recommendations	Est. Remaining Contribution (yrs)	Category
				N	S	E	W								
T50	London Plane (<i>Platanus x hispanica</i>)	15.0+	370	3.2	7.9	3.7	6.2	4.0 (SW & NE)	3.0 (S)	Fair / Good	EM	Growing in informal tree pit (approx. 1.2 x 1.5m in size) within area of precast concrete surfaced loading area and adjacent to Site boundary wall west of Ship Lane in the Stag Brewery component of the Site (approx. 0.5m east). Beginning to compete with adjacent trees. Minor historic pruning wounds. Canopy overhangs road on east side.	Of amenity and screening value on boundary as a single line of trees. Monitor pruning wounds for signs of decay. Consider removal of some concrete at base to improve growing conditions.	40+	A2
T51	London Plane (<i>Platanus x hispanica</i>)	15.0+	620	8.5	4.3	7.1	3.9	3.0 (NE)	3.0 (E)	Fair / Good	M	Growing in informal tree pit (approx. 1.2 x 1.5m in size) within area of precast concrete surfaced loading area and adjacent to Site boundary wall west of Ship Lane in the Stag Brewery component of the Site (approx. 0.5m east). In competition with adjacent trees. Minor historic pruning wounds throughout with canopy reduction wounds on west side adjacent to building. Canopy overhangs road on east side.	Of amenity and screening value on boundary as a single line of trees. Monitor pruning wounds for signs of decay. Consider removal of some concrete at base to improve growing conditions.	40+	A2

Ref. No	Species	Est. Height (m)	Stem Dia. (mm)	Canopy Spread (m)				First significant branch (m)	Canopy Clearance (m)	Physiological Condition	Age	Observations and Conditions	Preliminary Management Recommendations	Est. Remaining Contribution (yrs)	Category
				N	S	E	W								
T52	London Plane (<i>Platanus x hispanica</i>)	15.0+	550	4.6	3.2	7.2	2.6	3.0 (NE)	3.0 (E)	Fair / Good	M	Growing in informal tree pit (approx. 1.2 x 1.5m in size) within area of precast concrete surfaced loading area and adjacent to Site boundary wall west of Ship Lane in the Stag Brewery component of the Site (approx. 0.5m east). Beginning to compete with adjacent trees. Historic pruning and canopy reduction wounds visible on W side. Overhangs road on east side. Large birds nest in upper canopy.	Of amenity and screening value on boundary as a single line of trees. Monitor pruning wounds for signs of decay. Consider removal of some concrete surface at base to improve growing conditions and prevent trunk development becoming fouled.	40+	A2

Ref. No	Species	Est. Height (m)	Stem Dia. (mm)	Canopy Spread (m)				First significant branch (m)	Canopy Clearance (m)	Physiological Condition	Age	Observations and Conditions	Preliminary Management Recommendations	Est. Remaining Contribution (yrs)	Category
				N	S	E	W								
T53	London Plane (<i>Platanus x hispanica</i>)	15.0+	450	2.4	3.2	8.0	1.4	3.0 (E)	8.0 (E)	Fair / Good	EM	Growing in informal tree pit (approx. 1.2 x 1.5m in size) within area of precast concrete surfaced loading area and adjacent to Site boundary wall west of Ship Lane in the Stag Brewery component of the Site (approx. 0.5m east). Beginning to compete with adjacent trees. Historic pruning and canopy reduction wounds visible on west side. Overhangs road on east side. Large birds nest in upper canopy.	Of amenity and screening value on boundary as a single line of trees. Monitor pruning wounds for signs of decay. Consider removal of some concrete surface at base to improve growing conditions and prevent trunk development becoming fouled.	40+	A2

Ref. No	Species	Est. Height (m)	Stem Dia. (mm)	Canopy Spread (m)				First significant branch (m)	Canopy Clearance (m)	Physiological Condition	Age	Observations and Conditions	Preliminary Management Recommendations	Est. Remaining Contribution (yrs)	Category
				N	S	E	W								
T54	London Plane (<i>Platanus x hispanica</i>)	15.0+	520	1.9	5.5	7.8	5.0	4.0 (E)	7.0 (E)	Fair / Good	M	Growing in informal tree pit (approx. 1.2 x 1.5m in size) within area of precast concrete surfaced loading area and adjacent to Site boundary wall west of Ship Lane in the Stag Brewery component of the Site (approx. 0.5m east). Beginning to compete with adjacent trees. Historic pruning and canopy reduction wounds visible on west side. Overhangs road on east side. Large birds nest in upper canopy.	Of amenity and screening value on boundary as a single line of trees. Monitor pruning wounds for signs of decay. Consider removal of some concrete surface at base to improve growing conditions and prevent trunk development becoming fouled.	40+	A2

Ref. No	Species	Est. Height (m)	Stem Dia. (mm)	Canopy Spread (m)				First significant branch (m)	Canopy Clearance (m)	Physiological Condition	Age	Observations and Conditions	Preliminary Management Recommendations	Est. Remaining Contribution (yrs)	Category
				N	S	E	W								
T55	London Plane (<i>Platanus x hispanica</i>)	15.0+	565	4.7*	5.4	6.1	7.6	5.0 (S&E)	3.5 (W)	Fair / Good	M	Growing in informal tree pit (approx. 1.2 x 1.5m in size) within area of precast concrete surfaced loading area and adjacent to Site boundary wall west of Ship Lane in the Stag Brewery component of the Site (approx. 0.5m east). Beginning to compete with adjacent trees. Historic pruning and canopy reduction wounds visible on west side. Overhangs road on east side. Large birds nest in upper canopy.	Of amenity and screening value on boundary as a single line of trees. Monitor pruning wounds for signs of decay. Consider removal of some concrete surface at base to improve growing conditions and prevent trunk development becoming fouled.	40+	A2

Ref. No	Species	Est. Height (m)	Stem Dia. (mm)	Canopy Spread (m)				First significant branch (m)	Canopy Clearance (m)	Physiological Condition	Age	Observations and Conditions	Preliminary Management Recommendations	Est. Remaining Contribution (yrs)	Category
				N	S	E	W								
T56	London Plane (<i>Platanus x hispanica</i>)	15.0+	445	3.2	7.2	5.8	7.7	2.5 Av.	4.0 Av	Fair / Good	EM	Growing in informal tree pit (approx. 1.2 x 1.5m in size) within area of precast concrete surfaced loading area and adjacent to Site boundary wall west of Ship Lane in the Stag Brewery component of the Site (approx. 0.5m east). Beginning to compete with adjacent trees. Minor historic pruning wounds visible. Overhangs road to east side.	Of amenity and screening value on boundary as a single line of trees. Monitor pruning wounds for signs of decay. Consider removal of some concrete surface at base to improve growing conditions and prevent trunk development becoming fouled.	40+	A2

Ref. No	Species	Est. Height (m)	Stem Dia. (mm)	Canopy Spread (m)				First significant branch (m)	Canopy Clearance (m)	Physiological Condition	Age	Observations and Conditions	Preliminary Management Recommendations	Est. Remaining Contribution (yrs)	Category
				N	S	E	W								
T57	London Plane (<i>Platanus x hispanica</i>)	15.0+	600	6.8	6.5	7.6	7.5	4.0 (N)	3.0 (N)	Fair / Good	M	Growing in informal tree pit (approx. 1.2 x 1.5m in size) within area of precast concrete surfaced loading area and adjacent to Site boundary wall west of Ship Lane in the Stag Brewery component of the Site (approx. 0.5m east). Beginning to compete with adjacent trees. Minor historic pruning wounds visible. Overhangs road to east side.	Of amenity and screening value on boundary as a single line of trees. Monitor pruning wounds for signs of decay. Consider removal of some concrete surface at base to improve growing conditions and prevent trunk development becoming fouled.	40+	A2

Note: G58 as identified in original survey was resurveyed in April 2017 in detail and labelled accordingly below to include both individual trees and tree groups.

Ref. No	Species	Est. Height (m)	Stem Dia. (mm)	Canopy Spread (m)				First significant branch (m)	Canopy Clearance (m)	Physiological Condition	Age	Observations and Conditions	Preliminary Management Recommendations	Est. Remaining Contribution (yrs)	Category
				N	S	E	W								
G58a	5No. Ash (<i>Fraxinus excelsior</i>) 1No. Sycamore (<i>Acer pseudoplatanus</i>)	Av. 12.0	Av. 150	Av. 2.5				Av. 1.5	Av. 0.5	Fair	SM	Growing in riverbank and from adjacent retaining wall to the north east of the Stag Brewery component of the Site causing a large amount of deflection and structural movement of wall. Eastern Ash is m/s in form. Crossing and fused branches to some.	Of nominal amenity value to location in association with adjacent trees. Consider for removal to allow inspection and repair of retaining wall.	10+	C2
G58b	1No. Sycamore (<i>Acer pseudoplatanus</i>)	15.0+	M/S (3) Av. 375	Av. 5.5				1.5 (N)	0.0 (S)	Good	SM - EM	Growing on top of river bank causing some deflection to retaining wall to the north east of the Stag Brewery component of the Site. Some canopy reduction noted to lower branches. Exposed shallow surface roots noted on south side.	Of general amenity value to location in association with adjacent trees. Monitor wounds for signs of decay. Consider for removal to allow for inspection/repair to retaining river wall.	10+	C2

Ref. No	Species	Est. Height (m)	Stem Dia. (mm)	Canopy Spread (m)				First significant branch (m)	Canopy Clearance (m)	Physiological Condition	Age	Observations and Conditions	Preliminary Management Recommendations	Est. Remaining Contribution (yrs)	Category
				N	S	E	W								
G58c	1No. Elder (<i>Sambucus nigra</i>)	6.0	M/S (3) Av. 70	2.0	0.0 (wall)	2.0	2.0	0.0	0.0	Fair	SM	Located within strip of soft landscape adjacent to Site boundary wall to the north east of the Stag Brewery component of the Site. M/S In form and scrubby in appearance.	Of nominal amenity value to location.	10+	C2/3
G58d	1No. Goat Willow (<i>Salix caprea</i>)	8.0	M/S (4) Av. 250	Av. 3.0				0.0	0.0	Fair	SM	Growing on top of riverbank adjacent to tow path to the north east of the Stag Brewery component of the Site. Scrubby in form and causing deflection to retaining wall. Some deadwood present in canopy.	Of general amenity value to location in association with adjacent trees. Monitor deflection to retaining wall.	10+	C2
G58e	1No. Ash (<i>Fraxinus excelsior</i>)	10.0	225	4.1	4.2	4.0	3.8	2.0 (E)	0.5 (E)	Fair / Good	SM	Growing on top of river bank adjacent to tow path to the north east of the Stag Brewery component of the Site. Some deadwood present within canopy.	Of nominal amenity value to location. Monitor for signs of Ash Dieback Disease (<i>Hymenoscyphus fraxineus</i>).	20+	C2

Ref. No	Species	Est. Height (m)	Stem Dia. (mm)	Canopy Spread (m)				First significant branch (m)	Canopy Clearance (m)	Physiological Condition	Age	Observations and Conditions	Preliminary Management Recommendations	Est. Remaining Contribution (yrs)	Category
				N	S	E	W								
G58f	1No. Ash (<i>Fraxinus excelsior</i>)	12.0	M/S (2) Av. 260	Av. 4.0				2.0 (S)	2.0 (S)	Fair	EM	Growing on top of river bank adjacent to tow path to the north east of the Stag Brewery component of the Site. Ivy growth to 8.0m Ht on trunk. Minor exposed shallow surface roots on S side.	Of general amenity value to location in association with adjacent trees. Monitor for signs of Ash Dieback Disease (<i>Hymenoscyphus fraxineus</i>)	20+	C2
G58g	1No. Sycamore (<i>Acer pseudoplatanus</i>)	15.0	M/S (3) Av. 300	6.2	6.1	4.5	4.1	0.5 (N)	0.5 (N)	Good / Fair	SM	Growing on top of river bank on edge of tow path to the north east of the Stag Brewery component of the Site. In competition with G58h. Causing deflection to adjacent retaining wall. Deadwood present in lower canopy.	Of general amenity value to location. Consider for removal to allow inspection and repair of retaining wall.	10+	B2

Ref. No	Species	Est. Height (m)	Stem Dia. (mm)	Canopy Spread (m)				First significant branch (m)	Canopy Clearance (m)	Physiological Condition	Age	Observations and Conditions	Preliminary Management Recommendations	Est. Remaining Contribution (yrs)	Category
				N	S	E	W								
G58h	1No. Ash (<i>Fraxinus excelsior</i>)	15.0	190	0.5	5.5	5.2	4.9	2.0 (S)	3.0 (S)	Fair	SM	Growing on top of river bank on edge of tow path to the north east of the Stag Brewery component of the Site. Leans to south from competition with G58g. Minor exposed shallow surface roots.	Of nominal amenity value in association with adjacent trees. Monitor for signs of Ash Dieback Disease (<i>Hymenoscyphus fraxineus</i>).	10+	C2
G58i	1No. Ash (<i>Fraxinus excelsior</i>)	12.0	235	Av. 3.0				1.0 (W)	0.0 (N)	Fair	SM	Growing on top of river bank on edge of tow path to the north east of the Stag Brewery component of the Site. Torn branch stubs on south side.	Of nominal amenity value to location. Monitor for signs of Ash Dieback Disease (<i>Hymenoscyphus fraxineus</i>).	10+	C2

Ref. No	Species	Est. Height (m)	Stem Dia. (mm)	Canopy Spread (m)				First significant branch (m)	Canopy Clearance (m)	Physiological Condition	Age	Observations and Conditions	Preliminary Management Recommendations	Est. Remaining Contribution (yrs)	Category
				N	S	E	W								
G58j	2No. Ash (<i>Fraxinus excelsior</i>)	Av. 8.0	Av. 110	Av. 2.5				0.0	0.5 (N)	Fair	SM	Growing on top of river bank and from retaining wall to the north east of the Stag Brewery component of the Site causing deflection. Deadwood and torn branches in lower canopy.	Of nominal amenity value to location. Consider for removal to allow for inspection and repair of retaining wall. Monitor for signs of Ash Dieback Disease (<i>Hymenoscyphus fraxineus</i>).	10+	C2

Ref. No	Species	Est. Height (m)	Stem Dia. (mm)	Canopy Spread (m)				First significant branch (m)	Canopy Clearance (m)	Physiological Condition	Age	Observations and Conditions	Preliminary Management Recommendations	Est. Remaining Contribution (yrs)	Category
				N	S	E	W								
G58k	Sycamore (<i>Acer pseudoplatanus</i>) Elder (<i>Sambucus nigra</i>) Cherry (<i>Prunus sp.</i>) Ash (<i>Fraxinus excelsior</i>) Elm (<i>Ulmus sp.</i>) Hawthorn (<i>Crataegus monogyna</i>)	Av. 12.0	<70 - 450	Av. 4.0				-	-	Poor / Good	Y - EM	Growing at the top of river bank and from retaining wall to the north east of the Stag Brewery component of the Site. Ivy (<i>Hedera helix</i>) growth to some trunks which has been severed at base and removed from lower 1.0m of trunks in several cases. In mutual competition and becoming drawn-up as a result. Some deflection noted to retaining wall. Exposed shallow surface roots noted on south side within towpath.	Of general amenity value to location as a group. Monitor for signs of Ash Dieback Disease (<i>Hymenoscyphus fraxineus</i>) and Dutch Elm Disease (<i>Ophiostoma novo-ulmi</i>).	20+	B2
G58l	1No. Sycamore (<i>Acer pseudoplatanus</i>)	15.0+	M/S (4) Av. 210	Av. 6.0				0.0	0.0	Fair / Good	EM	Growing on top of river bank to the north east of the Stag Brewery component of the Site. Large exposed shallow surface root on north side before river wall with further exposed shallow surface roots to east. M/S in form. Some deadwood in canopy and beginning to compete with adjacent trees.	Of general amenity value to location. Consider formative pruning to remove deadwood from canopy.	20+	B2

Ref. No	Species	Est. Height (m)	Stem Dia. (mm)	Canopy Spread (m)				First significant branch (m)	Canopy Clearance (m)	Physiological Condition	Age	Observations and Conditions	Preliminary Management Recommendations	Est. Remaining Contribution (yrs)	Category
				N	S	E	W								
G58m	2No. Sycamore (<i>Acer pseudoplatanus</i>)	Av. 15.0	Av. 270	Av. 3.5				Av. 1.0	Av. 1.0	Fair / Good	SM	Located within the top of the retaining river wall in the north east of the Stag Brewery component of the Site. Dead branch stubs in lower canopy. West specimen is M/S in form. Some exposed shallow surface roots noted.	Of nominal amenity value to location in association with adjacent trees.	20+	C2
G58n	Elm (<i>Ulmus sp.</i>) Hawthorn (<i>Crataegus monogyna</i>) Sycamore (<i>Acer pseudoplatanus</i>) Elder (<i>Sambucus nigra</i>)	Av. 10.0	<70 to 250	Av. 3.0				-	-	Fair / Good	Y - SM	Group of young saplings growing between retaining river wall and tow path to the north east of the Stag Brewery component of the Site.	Of nominal amenity value but potential to increase with age. Monitor Elm for signs of Dutch Elm Disease (<i>Ophiostoma novo-ulmi</i>)	40+	C2
G58o	1No. Ash (<i>Fraxinus excelsior</i>)	10.0	360	Av. 3.5				0.5 (E)	0.0 (E)	Fair	SM - EM	Growing on top of river bank to the north east of the Stag Brewery component of the Site. Minor ivy (<i>Hedera helix</i>) growth to trunk. Deadwood in lower canopy.	Of nominal amenity value to location. Monitor for signs of Ash Dieback Disease (<i>Hymenoscyphus fraxineus</i>).	20+	C2

Ref. No	Species	Est. Height (m)	Stem Dia. (mm)	Canopy Spread (m)				First significant branch (m)	Canopy Clearance (m)	Physiological Condition	Age	Observations and Conditions	Preliminary Management Recommendations	Est. Remaining Contribution (yrs)	Category
				N	S	E	W								
G58p	1No. Sycamore (<i>Acer pseudoplatanus</i>)	15.0+	M/S (2) Av. 450	Av. 5.0				0.5 (E)	0.0 (E)	Fair	SM - EM	Growing from top of retaining wall in the north east of the Stag Brewery component of the Site and causing deflection. Historic damage to S side of S branches with some wound wood noted but also signs of decay. Minor Ivy (<i>Hedera helix</i>) growth noted.	Of nominal amenity value to location in association with adjacent trees. Monitor wounds for signs of decay.	20+	C2
G58q	3No. Ash (<i>Fraxinus excelsior</i>) 4No. Sycamore (<i>Acer pseudoplatanus</i>)	Av. 12.0	Av. 300	Av. 4.5				-	-	Fair	SM	Growing on top of river bank and from retaining river wall to the north east of the Stag Brewery component of the Site causing deflection in places. Some m/s in form. In mutual competition.	Of nominal amenity value to location in association with adjacent trees. Monitor for signs of Ash Dieback Disease (<i>Hymenoscyphus fraxineus</i>).	20+	C2
G58r	1No. Goat Willow (<i>Salix caprea</i>)	5.00	M/S (10) Av. 90	Av. 2.5				0.0	0.0	Fair	SM	Growing from retaining river wall to the north east of the Stag Brewery component of the Site. Scrubby and m/s in form. Crossing branches and deadwood within.	Of nominal amenity value. Consider for removal to allow retaining wall to be inspected/repair ed.	10+	C2

Ref. No	Species	Est. Height (m)	Stem Dia. (mm)	Canopy Spread (m)				First significant branch (m)	Canopy Clearance (m)	Physiological Condition	Age	Observations and Conditions	Preliminary Management Recommendations	Est. Remaining Contribution (yrs)	Category
				N	S	E	W								
G58s	1No. Hornbeam (<i>Carpinus betulus</i>)	15.0+	465	Av. 6.5				0.5 (N)	1.0 (N)	Fair	EM	Located within an area of soft landscape adjacent to tow path to the north east of the Stag Brewery component of the Site. Historic pruning wounds to lower canopy with some torn branches Exposed shallow surface roots. Canopy extends over Site boundary wall and into Site.	Of general amenity value to location. Monitor pruning wounds and exposed shallow surface roots for signs of decay. Consider formative pruning to tidy torn branches.	20+	B2
G58t	1No. Hornbeam (<i>Carpinus betulus</i>)	12.0	550	Av. 6.5				0.25 (N)	0.0 (N)	Fair	EM - M	Located within an area of soft landscape adjacent to tow path to the north east of the Stag Brewery component of the Site. Minor Ivy (<i>Hedera helix</i>) growth to trunk. Some torn branches in lower canopy with decay noted. Exposed shallow surface roots to south. Generally balanced form.	Of general amenity value to location. Consider formative pruning to tidy torn branches and therefore decay.	20+	B2

Ref. No	Species	Est. Height (m)	Stem Dia. (mm)	Canopy Spread (m)				First significant branch (m)	Canopy Clearance (m)	Physiological Condition	Age	Observations and Conditions	Preliminary Management Recommendations	Est. Remaining Contribution (yrs)	Category
				N	S	E	W								
G58u	1No. Hornbeam (<i>Carpinus betulus</i>)	12.0	270	Av. 4.5				1.0 (N)	0.5 (S)	Fair	SM	Located to the north east of the Stag Brewery component of the Site within area of mown grass. Historic pruning wound on trunk with minor wound wood development and some branch stubs with decay noted.	Of general amenity value to location. Consider formative pruning to tidy torn branches and therefore decay. Monitor pruning wounds for signs of decay.	20+	B2
G58v	1No. Ash (<i>Fraxinus excelsior</i>)	8.0	130	Av. 1.0				1.5 (N)	3.0 (N)	Fair	Y - SM	Located to the north east of the Stag Brewery component of the Site within area of mown grass. Exposed shallow surface roots on south side. Historic limb scar at 2.0m Ht. on west side with some wound wood development but decay also noted.	Of general nominal amenity value to location in association with adjacent trees. Monitor wound for signs of decay and tree for signs of Ash Dieback Disease (<i>Hymenoscyphus fraxineus</i>).	20+	C2

Ref. No	Species	Est. Height (m)	Stem Dia. (mm)	Canopy Spread (m)				First significant branch (m)	Canopy Clearance (m)	Physiological Condition	Age	Observations and Conditions	Preliminary Management Recommendations	Est. Remaining Contribution (yrs)	Category
				N	S	E	W								
G58 W	1No. Ash (<i>Fraxinus excelsior</i>)	10.0	M/S (3) Av. 210	Av. 3.0				1.5 (E)	1.5 (E)	Fair	SM	Located to the north east of the Stag Brewery component of the Site within area of mown grass. Nettles to 0.4m Ht. at base preventing inspection. M/S from base. Some historic pruning wounds and torn branches noted.	Of general amenity value to location. Monitor pruning wounds for signs of decay and consider formative pruning to tidy torn branches. Monitor for signs of Ash Dieback Disease (<i>Hymenoscyphus fraxineus</i>)	20+	B2
T59	Fastigate Oak (<i>Quercus robur</i> 'Fastigiata')	13.0	195	1.5 Av.				Av. 2m	Av. 2m	Fair / Good	Y	Growing in small tree pit within pavement area at the back of kerb along Mortlake High Street, to the south of the Stag Brewery component of the Site.	Of amenity value and potential. Consider formative pruning to progressively raise canopy above carriageway.	20+	C2

Ref. No	Species	Est. Height (m)	Stem Dia. (mm)	Canopy Spread (m)				First significant branch (m)	Canopy Clearance (m)	Physiological Condition	Age	Observations and Conditions	Preliminary Management Recommendations	Est. Remaining Contribution (yrs)	Category
				N	S	E	W								
T60	Norway Maple (<i>Acer platanoides</i>)	6.0	95	0.75 Av.				Av 2m	Av. 2m	Fair	SM?	Young tree growing in small tree put within pavement at the back of kerb along Mortlake High Street, to the south of the Stag Brewery component of the Site. Lost leader at 2.5m Ht. Still tied to tree stake.	Of amenity value and potential to location. Consider formative pruning to progressively raise canopy above carriageway. Remove redundant tree stakes and ties.	10+	C2
T61	Himalayan Birch (<i>Betula utilis</i>)	12.0	240*	3.3	4.4	5.2	3.3	2m (E)	1.8 (S)	Fair	SM?	Growing in triangular raised brick planter adjacent to pavement along Lower Richmond Road, in the south of the Stag Brewery component of the Site. Historic pruning wounds mostly occluded.	Of general amenity value to adjacent streetscape. Consider modest formative pruning to raise canopy above adjacent pavement and highway.	10+	C2

Ref. No	Species	Est. Height (m)	Stem Dia. (mm)	Canopy Spread (m)				First significant branch (m)	Canopy Clearance (m)	Physiological Condition	Age	Observations and Conditions	Preliminary Management Recommendations	Est. Remaining Contribution (yrs)	Category
				N	S	E	W								
T62	Himalayan Birch (<i>Betula utilis</i>)	9.0	230 @ 1.2m Ht.	3.1	4.3	3.9	2.9	Av. 1.4	0.5 (From planter)	Fair	SM	Low branching tree growing in raised brick planter adjacent to pavement in the south west of the Stag Brewery component of the Site. Of slightly crooked form.	Of general amenity value to adjacent streetscape.	10+	C2
T63	Red Horse Chestnut (<i>Aesculus x carnea</i>)	6.0	255	3.7	3.4	3.7	3.9	Av. 2.0	Av 1.6	Fair	SM	Growing in grass verge area bounding office car park in the south west of the Stag Brewery component of the Site. Appears to be infected with Bleeding Canker of Horse Chestnut (BCHC) (<i>Pseudomonas syringae</i> pv <i>aesculi</i>) with cracked/flaking bark noted. Occasional pruning stubs and dead wood also.	Of general amenity value to location. Monitor symptoms of BCHC with regards to tree safety and health.	10+	C2

Ref. No	Species	Est. Height (m)	Stem Dia. (mm)	Canopy Spread (m)				First significant branch (m)	Canopy Clearance (m)	Physiological Condition	Age	Observations and Conditions	Preliminary Management Recommendations	Est. Remaining Contribution (yrs)	Category
				N	S	E	W								
T64	London Plane (<i>Platanus x hispanica</i>)	11.0	345	6.3	5.0	5.7	4.7	5.5 (NE)	1.5 Av	Fair / Good	SM	Growing in grass verge areas bounding office car park in the south west of the Stag Brewery component of the Site. Generally balanced form with low hanging canopy tips.	Of amenity value and potential to location. Consider formative pruning to raise canopy tips and prevent conflict with adjacent sports pitch and car park operations and maintenance.	40+	B2
T65	Red Horse Chestnut (<i>Aesculus x carnea</i>)	6.0	255	4.0	3.8	3.1	3.9	1.9 (N)	Av. 2.0	Fair / Poor	SM	Growing in grass verge area bounding office car park in the south west of the Stag Brewery component of the Site. Appears to be infected with Bleeding Canker of Horse Chestnut (BCHC) (<i>Pseudomonas syringae</i> pv <i>aesculi</i>) with heavy cracking of bark back to heartwood noted. Occasional pruning stubs and general dead wood also.	Of general amenity value to location. Monitor symptoms of BCHC with regards to tree safety and health.	10+	C2

Ref. No	Species	Est. Height (m)	Stem Dia. (mm)	Canopy Spread (m)				First significant branch (m)	Canopy Clearance (m)	Physiological Condition	Age	Observations and Conditions	Preliminary Management Recommendations	Est. Remaining Contribution (yrs)	Category
				N	S	E	W								
T66	Red Horse Chestnut (<i>Aesculus x carnea</i>)	8.0	425 @ 1.0m Ht.	7.2	3.5	5.1	4.3	1.7 (N)	Av 2.0	Poor	EM	Growing in grass verge area bounding office car park in the south west of the Stag Brewery component of the Site. Infected with BHC with heavy cracking of bark back to heartwood and decay and regeneration visible. Possible weak branch junction for limb overhanging car park space to the north.	Of general amenity value to location. Monitor symptoms of BHC with regards to tree safety and health. Inspect branch overhanging car park for safety.	<10	C2

Ref. No	Species	Est. Height (m)	Stem Dia. (mm)	Canopy Spread (m)				First significant branch (m)	Canopy Clearance (m)	Physiological Condition	Age	Observations and Conditions	Preliminary Management Recommendations	Est. Remaining Contribution (yrs)	Category
				N	S	E	W								
T67	Red Horse Chestnut (<i>Aesculus x carnea</i>)	10.0	525	3.9	4.5*	4.6	3.6	4.5 (N)	2.0 (NE)	Fair	M	Growing within area of mown grass on south western boundary of the Stag Brewery component of the Site with sports pitch to north and highway and pavement to south forming part of a line of similar aged trees. Cracking of bark suggests potential infection with BHC. Historic pruning wounds and wound wood development but also decay and cavities visible. Generally balanced form.	Of amenity value on Site boundary as part of a larger group and of potential habitat value to bats. Monitor pruning wounds for decay and monitor symptoms of BHC. Inspect for safety with regards to adjacent pavement and highway.	20+	B2/3

Ref. No	Species	Est. Height (m)	Stem Dia. (mm)	Canopy Spread (m)				First significant branch (m)	Canopy Clearance (m)	Physiological Condition	Age	Observations and Conditions	Preliminary Management Recommendations	Est. Remaining Contribution (yrs)	Category
				N	S	E	W								
T68	Red Horse Chestnut (<i>Aesculus x carnea</i>)	9.0	470	3.2	3.5*	4.6	3.7	2.5 (W)	2.5 (N)	Fair	M	Growing within area of mown grass on south western boundary of the Stag Brewery component of the Site with sports pitch to north and highway and pavement to south forming part of a line of similar aged trees. Cracking of bark suggests potential infection with BCHC. Historic pruning wounds and wound wood development but also decay and cavities visible. Cavity and decay present at base of trunk on west side. Generally balanced form.	Of amenity value on Site boundary as part of a larger group and of potential habitat value to bats. Monitor pruning wounds for decay and monitor symptoms of BCHC. Inspect for safety with regards to adjacent pavement and highway.	20+	B2/3

Ref. No	Species	Est. Height (m)	Stem Dia. (mm)	Canopy Spread (m)				First significant branch (m)	Canopy Clearance (m)	Physiological Condition	Age	Observations and Conditions	Preliminary Management Recommendations	Est. Remaining Contribution (yrs)	Category
				N	S	E	W								
T69	Pink Hawthorn (<i>Crataegus laevigatus</i> 'Rosea Flore Pleno')	9.0	390	3.4	3.0*	3.4	3.5	2.0 (E)	1.2 (E)	Fair	M	Growing within area of mown grass on south western boundary of the Stag Brewery component of the Site with sports pitch to north and highway and pavement to south forming part of a line of similar aged trees. Forks at approx. 1.5m Ht. with large cavity and decay at junction. Historic pruning wounds visible in canopy with regeneration also present.	Of amenity value on Site boundary as part of line of trees. Monitor the extent of decay in cavity and assess for safety in relation to proximity to highway.	10+	C2

Ref. No	Species	Est. Height (m)	Stem Dia. (mm)	Canopy Spread (m)				First significant branch (m)	Canopy Clearance (m)	Physiological Condition	Age	Observations and Conditions	Preliminary Management Recommendations	Est. Remaining Contribution (yrs)	Category
				N	S	E	W								
T70	Red Horse Chestnut (<i>Aesculus x carnea</i>)	9.0	465	4.0	4.0*	3.6	3.9	2.5 Av.	2.0 (E & W)	Fair	M	Growing within area of mown grass on south western boundary of the Stag Brewery component of the Site with sports pitch to north and highway and pavement to south forming part of a line of similar aged trees. Cracking of bark suggests potential infection with BHC. Historic pruning wounds and wound wood development but also decay and cavities visible. Generally balanced form. Large limb removed on S side at approx. 2.0m Ht with decay visible.	Of amenity value on Site boundary as part of a larger group and of potential habitat value to bats. Monitor pruning wounds for decay and monitor symptoms of BHC. Inspect for safety with regards to adjacent pavement and highway.	20+	B2/3

Ref. No	Species	Est. Height (m)	Stem Dia. (mm)	Canopy Spread (m)				First significant branch (m)	Canopy Clearance (m)	Physiological Condition	Age	Observations and Conditions	Preliminary Management Recommendations	Est. Remaining Contribution (yrs)	Category
				N	S	E	W								
T71	Red Horse Chestnut (<i>Aesculus x carnea</i>)	8.0	465	3.8	4.5*	5.3	3.9	2.3 (W)	Av. 1.8	Fair	M	Growing within area of mown grass on south western boundary of the Stag Brewery component of the Site with sports pitch to north and highway and pavement to south forming part of a line of similar aged trees. Cracking of bark suggests potential infection with BHC. Historic pruning wounds and wound wood development but also decay and cavities visible. Generally balanced form.	Of amenity value on Site boundary as part of a larger group and of potential habitat value to bats. Monitor pruning wounds for decay and monitor symptoms of BHC. Inspect for safety with regards to adjacent pavement and highway.	20+	B2/3

Ref. No	Species	Est. Height (m)	Stem Dia. (mm)	Canopy Spread (m)				First significant branch (m)	Canopy Clearance (m)	Physiological Condition	Age	Observations and Conditions	Preliminary Management Recommendations	Est. Remaining Contribution (yrs)	Category
				N	S	E	W								
T72	Pink Hawthorn (<i>Crataegus laevigatus</i> 'Rosea Flore Pleno')	6.0	375	2.7	3.5*	2.7	3.9	Av 2.0	Av 1.0	Fair	M	Growing within area of mown grass on south western boundary of the Stag Brewery component of the Site with sports pitch to north and highway and pavement to south forming part of a line of similar aged trees. Historically pruned and lopped back with decay, regeneration and cavities visible. Suckers present at base of trunk.	Of amenity value on Site boundary as part of the wider line of trees. Monitor extent of decay in cavities and asses for safety in relation to adjacent highway. Remove suckering growth from base.	20+	C2

Ref. No	Species	Est. Height (m)	Stem Dia. (mm)	Canopy Spread (m)				First significant branch (m)	Canopy Clearance (m)	Physiological Condition	Age	Observations and Conditions	Preliminary Management Recommendations	Est. Remaining Contribution (yrs)	Category
				N	S	E	W								
T73	Pink Hawthorn (<i>Crataegus laevigatus</i> 'Rosea Flore Pleno')	7.0	380 over Ivy	3.5	3.5*	3.0	3.0	Av 1.8 (m/s)	1.6 Av.	Fair	M	Growing within area of mown grass on south western boundary of the Stag Brewery component of the Site with sports pitch to north and highway and pavement to south forming part of a line of similar aged trees. Historic pruning wounds visible with regeneration. Heavy ivy growth established on trunk and within canopy limiting further inspection.	Of amenity value as part of the wider line of trees. Sever ivy at base, remove from lower 1.0m of trunk and re-inspect for safety in relation to location adjacent to highway. Monitor pruning wounds for signs of decay.	20+	B2

Ref. No	Species	Est. Height (m)	Stem Dia. (mm)	Canopy Spread (m)				First significant branch (m)	Canopy Clearance (m)	Physiological Condition	Age	Observations and Conditions	Preliminary Management Recommendations	Est. Remaining Contribution (yrs)	Category
				N	S	E	W								
T74	Red Horse Chestnut (<i>Aesculus x carnea</i>)	10.0	550 over Ivy	4.4	5.0*	4.6	4.7	4.5 (N)	2.0 (W)	Fair	M	Growing within area of mown grass on south western boundary of the Stag Brewery component of the Site with sports pitch to north and highway and pavement to south forming part of a line of similar aged trees. Cracking of bark suggests potential infection with BCHC. Historic pruning wounds and wound wood development but also decay and cavities visible. Generally balanced form. Ivy becoming established on trunk.	Of amenity value on Site boundary as part of a larger group and of potential habitat value to bats. Monitor pruning wounds for decay and monitor symptoms of BCHC. Inspect for safety with regards to adjacent pavement and highway. Sever ivy at base and remove from lower 1.0m of trunk.	20+	B2/3

Ref. No	Species	Est. Height (m)	Stem Dia. (mm)	Canopy Spread (m)				First significant branch (m)	Canopy Clearance (m)	Physiological Condition	Age	Observations and Conditions	Preliminary Management Recommendations	Est. Remaining Contribution (yrs)	Category
				N	S	E	W								
T75	Red Horse Chestnut (<i>Aesculus x carnea</i>)	10.0	540	4.7	4.0*	5.1	3.9	3.5 Av.	1.7 (E)	Fair	M	Growing within area of mown grass on south western boundary of the Stag Brewery component of the Site with sports pitch to north and highway and pavement to south forming part of a line of similar aged trees. Cracking of bark suggests potential infection with BHC. Historic pruning wounds and wound wood development but also decay and cavities visible. Generally balanced form.	Of amenity value on Site boundary as part of a larger group and of potential habitat value to bats. Monitor pruning wounds for decay and monitor symptoms of BHC. Inspect for safety with regards to adjacent pavement and highway.	20+	B2/3

Ref. No	Species	Est. Height (m)	Stem Dia. (mm)	Canopy Spread (m)				First significant branch (m)	Canopy Clearance (m)	Physiological Condition	Age	Observations and Conditions	Preliminary Management Recommendations	Est. Remaining Contribution (yrs)	Category
				N	S	E	W								
T76	Pink Hawthorn (<i>Crataegus laevigatus</i> 'Rosea Flore Pleno')	9.0	440	4.7	4.8*	3.4	3.1	Av. 1.6	1.2 (N)	Fair	M	Growing within area of mown grass on south western boundary of the Stag Brewery component of the Site with sports pitch to north and highway and pavement to south forming part of a line of similar aged trees. Low fork with cavity and decay visible. Further historic pruning wounds and decay present but vigorous growth still.	Of amenity value as part of the line of trees. Inspect cavities to establish extent of decay and inspect for general safety with regards to adjacent pavement and highway.	20+	B2
T77	Red Horse Chestnut (<i>Aesculus x carnea</i>)	10.0	605	4.9	5.0*	4.2	4.5	1.8 (N)	1.8 (N)	Fair / Good	M	Growing within area of mown grass on south western boundary of the Stag Brewery component of the Site with sports pitch to north and highway and pavement to south forming part of a line of similar aged trees. Cracking of bark suggests potential infection with BHC. Modest historic pruning wounds and wound wood development but also minor decay and cavities visible. Generally balanced form.	Of amenity value on Site boundary as part of a larger group. Monitor pruning wounds for decay and monitor symptoms of BHC. Inspect for safety with regards to adjacent pavement and highway.	20+	B2

Ref. No	Species	Est. Height (m)	Stem Dia. (mm)	Canopy Spread (m)				First significant branch (m)	Canopy Clearance (m)	Physiological Condition	Age	Observations and Conditions	Preliminary Management Recommendations	Est. Remaining Contribution (yrs)	Category
				N	S	E	W								
T78	Red Horse Chestnut (<i>Aesculus x carnea</i>)	10.0	580	4.2	4.5*	5.2	4.8	3.0 €	2.5 (SE)	Fair	M	Growing within area of mown grass on south western boundary of the Stag Brewery component of the Site with sports pitch to north and highway and pavement to south forming part of a line of similar aged trees. Cracking of bark suggests potential infection with BCHC. Historic pruning wounds and wound wood development but also decay and cavities visible. Generally balanced form. Minor suckering growth at base from <i>Acer hippocastanum</i> rootstock.	Of amenity value on Site boundary as part of a larger group and of potential habitat value to bats. Monitor pruning wounds for decay and monitor symptoms of BCHC. Inspect for safety with regards to adjacent highway and pavement. Remove sucking growth from base.	20+	B2/3

Ref. No	Species	Est. Height (m)	Stem Dia. (mm)	Canopy Spread (m)				First significant branch (m)	Canopy Clearance (m)	Physiological Condition	Age	Observations and Conditions	Preliminary Management Recommendations	Est. Remaining Contribution (yrs)	Category
				N	S	E	W								
T79	Cockspurthorn (<i>Crataegus crus-galli</i>)	6.0	280*	4.4	4.5*	2.6	2.8	2.0 (S)	2.0 Av	Fair	EM	Growing within area of mown grass on south western boundary of the Stag Brewery component of the Site with sports pitch to north and highway and pavement to south forming part of a line of similar aged trees. Grafted onto <i>C. monogyna</i> rootstock which is now suckering on west side. Crossing branches and historic pruning wounds within canopy with some wound wood, decay and regeneration visible.	Of amenity value as part of the larger line of trees. Remove suckers from base. Monitor pruning wound for signs of decay and inspect for safety with regard to adjacent pavement and highway.	20+	B2
T80	Ornamental Hawthorn (<i>Crataegus sp.</i>)	2.0	6* Av. 20 old shimp 190*	0.5 Av				0.1 Av.	0.3 Av.	Fair / Poor	Y	Located along the south western boundary of the Stag Brewery component of the Site. Felled at 0.3m Ht with vigorous regeneration occurring. Decay in main trunk visible.	Of nominal amenity value. Consider formative pruning to encourage a single, strong leader shoot.	10+	C2

Ref. No	Species	Est. Height (m)	Stem Dia. (mm)	Canopy Spread (m)				First significant branch (m)	Canopy Clearance (m)	Physiological Condition	Age	Observations and Conditions	Preliminary Management Recommendations	Est. Remaining Contribution (yrs)	Category
				N	S	E	W								
T81	Ornamental Hawthorn (<i>Crataegus sp.</i>)	5.0	250*	2.8	3.0*	1.6	2.5	1.7 (W)	0.2 Av.	Fair	EM	Growing within area of mown grass on south western boundary of the Stag Brewery component of the Site with sports pitch to north and highway and pavement to south forming part of a line of similar aged trees. Historic pruning wounds visible and lopped at 2.5m Ht. with some regeneration since. Decay, wound wood and cavities visible. Suckers from <i>C. monogyna</i> rootstock present.	Of amenity value as part of the larger line of trees. Remove suckers from base. Monitor pruning wound for signs of decay and inspect for safety with regard to adjacent pavement and highway.	10+	C2

Ref. No	Species	Est. Height (m)	Stem Dia. (mm)	Canopy Spread (m)				First significant branch (m)	Canopy Clearance (m)	Physiological Condition	Age	Observations and Conditions	Preliminary Management Recommendations	Est. Remaining Contribution (yrs)	Category
				N	S	E	W								
T82	Red Horse Chestnut (<i>Aesculus x camea</i>)	10.0	350	4.5	4.5*	3.9	4.7	3.0 Av.	2.0 Av.	Fair	EM	Growing within area of mown grass on south western boundary of the Stag Brewery component of the Site with sports pitch to north and highway and pavement to south forming part of a line of similar aged trees. Cracking of bark suggests potential infection with BHC. Generally balanced form. Graft point at approx. 1.0m Ht with base girth larger than above section of trunk. Minor historic pruning wounds visible.	Of amenity value on Site boundary as part of a larger group. Monitor symptoms of BHC. Inspect for safety with regards to adjacent pavement and highway.	20+	B2
T83	Wingnut sp. (<i>Pterocarya sp.</i>)?	10.0	525	5.6	5.0	3.7	5.7	3.0 (S)	2.5 Av.	Fair / Good	M	Growing in area of mown grass on western boundary of the Stag Brewery component of the Site on edge of sports pitches bounding Williams Lane. Canopy reduced with approximately 1-2 years regeneration. Further historic pruning wounds with wound wood and some decay visible.	Of amenity value to location in association with adjacent trees. Monitor pruning wounds for signs of decay.	20+	B2

Ref. No	Species	Est. Height (m)	Stem Dia. (mm)	Canopy Spread (m)				First significant branch (m)	Canopy Clearance (m)	Physiological Condition	Age	Observations and Conditions	Preliminary Management Recommendations	Est. Remaining Contribution (yrs)	Category
				N	S	E	W								
T84	London Plane (<i>Platanus x hispanica</i>)	12.0	510	5.7	4.9	4.6	3.9	1.8 (N)	2.0 (S)	Fair / Good	M	Growing in area of mown grass on western boundary of the Stag Brewery component of the Site on edge of sports pitches bounding Williams Lane. An out-grown pollard with crown reduction at a high level and approx. 1-2 years regeneration present. Further historic pruning wounds notes with wound wood, decay and occasional cavities also visible.	Of amenity value to location in association with adjacent trees and of potential habitat value to bats. Monitor pruning wounds for signs of decay.	40+	B2/3
T85	Wingnut sp. (<i>Pterocarya sp.</i>)?	10.0	505	5.0	4.1	3.5	3.3	Av. 2.0	3.5 (S)	Fair / Good	M	Growing in area of mown grass on western boundary of the Stag Brewery component of the Site on edge of sports pitches bounding Williams Lane. Occasional large surface roots to W with mower damage visible.	Of amenity value to location in association with adjacent trees. Monitor pruning wounds for signs of decay.	20+	B2

Ref. No	Species	Est. Height (m)	Stem Dia. (mm)	Canopy Spread (m)				First significant branch (m)	Canopy Clearance (m)	Physiological Condition	Age	Observations and Conditions	Preliminary Management Recommendations	Est. Remaining Contribution (yrs)	Category
				N	S	E	W								
T86	London Plane (<i>Platanus x hispanica</i>)	14.0	470	5.0	5.2	6.3*	5.4	3.7 (S)	3.0 (S)	Good	EM	Growing in area of mown grass on western boundary of the Stag Brewery component of the Site on edge of sports pitches bounding Williams Lane. Historic pruning wounds to main trunk with some wound wood development visible. Large buttress root on W side with some mower damage visible. Generally balanced canopy. Deflection to adjacent macadam surface to south west from shallow root development.	OF amenity value and potential to location in association with adjacent trees. Monitor pruning wounds and buttress wound for signs of decay and adjacent macadam surface for further signs of deflection.	40+	B2

Ref. No	Species	Est. Height (m)	Stem Dia. (mm)	Canopy Spread (m)				First significant branch (m)	Canopy Clearance (m)	Physiological Condition	Age	Observations and Conditions	Preliminary Management Recommendations	Est. Remaining Contribution (yrs)	Category
				N	S	E	W								
T87	Indian Bean Tree (<i>Catalpa bignonioides</i>)	14.0	370	4.8	6.1	5.1	5.9	Av 3.0	3.5 (N)	Fair / Good	EM	Growing within area of mown grass on the edge of the sports pitch within the western part of the Stag Brewery component of the Site. Within a stand of similar aged trees and beginning to compete with these. Historic pruning wounds with wound wood, decay, cavities and fungal brackets visible. Mechanical damage and decay at base on north west side.	Of amenity value as part of larger group. Inspect the extent of decay and consider for removal to allow the development of adjacent trees.	10+	C2
T88	London Plane (<i>Platanus x hispanica</i>)	13.0	315	6.1	4.3	5.0	3.2	2.7 (N)	2.7 (N)	Fair / Good	EM	Growing within area of mown grass on the edge of sports pitch within the western part of the Stag Brewery component of the Site. Within a stand of similar aged trees. In competition with adjacent trees and becoming drawn-up as a result. Minor historic pruning wounds visible.	Of amenity value and potential as part of the larger group. Monitor pruning wounds for signs of decay.	40+	B2

Ref. No	Species	Est. Height (m)	Stem Dia. (mm)	Canopy Spread (m)				First significant branch (m)	Canopy Clearance (m)	Physiological Condition	Age	Observations and Conditions	Preliminary Management Recommendations	Est. Remaining Contribution (yrs)	Category
				N	S	E	W								
T89	Indian Bean Tree (<i>Catalpa bignonioides</i>)	12.0	315	6.9	5.3	5.7	6.0	Av 3.0	2.0 (E)	Fair	EM	Growing within area of mown grass on the edge of sports pitch within the western part of the Stag Brewery component of the Site. Within a stand of similar aged trees. Becoming tall and drawn up in competition with adjacent trees. Possible root girdling visible at base. Historic pruning wounds and dead wood visible within canopy.	Of amenity value as part of larger group. Inspect the extent of decay and consider for removal to allow the development of adjacent trees.	20+	C2
T90	London Plane (<i>Platanus x hispanica</i>)	13.0	480	8.1	7.6	4.0	7.4	4.0 Av.	3.0 (N)	Fair / Good	EM	Growing within area of mown grass on the edge of sports pitch within the western part of the Stag Brewery component of the Site. Within a stand of similar aged trees. In competition with adjacent trees. Historic pruning wounds with wound wood and possible decay visible. Large surface root on E side with mower damage. Birds nest within canopy.	Of amenity value and potential as part of larger group. Monitor pruning wounds and mower damage for signs of decay.	40+	B2

Ref. No	Species	Est. Height (m)	Stem Dia. (mm)	Canopy Spread (m)				First significant branch (m)	Canopy Clearance (m)	Physiological Condition	Age	Observations and Conditions	Preliminary Management Recommendations	Est. Remaining Contribution (yrs)	Category
				N	S	E	W								
T91	Indian Bean Tree (<i>Catalpa bignonioides</i>)	11.0	260	2.6	4.8	4.0	6.4	3.7 (W)	2.5 (W)	Fair / Poor	SM	Growing within area of mown grass on the edge of sports pitch within the western part of the Stag Brewery component of the Site. Within a stand of similar aged trees. In competition with adjacent trees. Upper canopy is torn out at approx. 5.0m Ht. with deadwood and decay visible.	Of general amenity value as part of larger group. Monitor mechanical damage for signs of decay.	10+	C2
T92	Manna Ash (<i>Fraxinus ornus</i>)	10.0	265	4.3	7.1	6.1	6.4	3.0 (S)	2m (N)	Fair	SM	Growing within area of mown grass on the edge of sports pitch within the western part of the Stag Brewery component of the Site. Within a stand of similar aged trees. In competition with adjacent trees. Slightly open and crooked canopy with some historic pruning wounds and torn limbs visible.	Of general amenity value as part of larger group. Monitor mechanical damage for signs of decay.	20+	C2

Ref. No	Species	Est. Height (m)	Stem Dia. (mm)	Canopy Spread (m)				First significant branch (m)	Canopy Clearance (m)	Physiological Condition	Age	Observations and Conditions	Preliminary Management Recommendations	Est. Remaining Contribution (yrs)	Category
				N	S	E	W								
T93	Indian Bean Tree (<i>Catalpa bignonioides</i>)	14.0	395	4.8	6.2	4.2	5.9	3.0 (S)	3.0 (S)	Fair / Good	EM	Growing within area of mown grass on the edge of sports pitch within the western part of the Stag Brewery component of the Site. Within a stand of similar aged trees. In competition with adjacent trees. Some historic pruning wounds with good wound wood development and now mostly occluded.	Of amenity value in association with larger group. Monitor pruning wounds for signs of decay.	20+	B2
T94	London Plane (<i>Platanus x hispanica</i>)	13.0	350	2.8	6.8	4.3	7.2	3.5 (W)	2.5 (W)	Fair / Good	EM	Growing within area of mown grass on the edge of sports pitch within the western part of the Stag Brewery component of the Site. Within a stand of similar aged trees. In competition with adjacent trees. Some historic pruning wounds with good wound wood development and now mostly occluded.	Of amenity value in association with larger group and of potential habitat value to bats. Monitor pruning wounds for signs of decay.	40+	B2/3

Ref. No	Species	Est. Height (m)	Stem Dia. (mm)	Canopy Spread (m)				First significant branch (m)	Canopy Clearance (m)	Physiological Condition	Age	Observations and Conditions	Preliminary Management Recommendations	Est. Remaining Contribution (yrs)	Category
				N	S	E	W								
T95	Manna Ash (<i>Fraxinus ornus</i>)	12.0	250	3.6	3.9	2.6	5.3	3.0 (W)	3.0 (W)	Fair / Good	SM	Growing within area of mown grass on the edge of sports pitch within the western part of the Stag Brewery component of the Site. Within a stand of similar aged trees. In competition with adjacent trees. Some historic pruning wounds with good wood development and now mostly occluded. Wound at base of trunk on east side with wound wood and decay visible. Occasional deadwood within canopy.	Of amenity value in association with larger group. Monitor pruning wounds and trunk wound for signs of decay.	20+	B2
T96	Manna Ash (<i>Fraxinus ornus</i>)	13.0	265	3.4	4.6	4.0	4.4	3.5 (N)	3.0 (N)	Fair / Good	SM	Growing within area of mown grass on the edge of sports pitch within the western part of the Stag Brewery component of the Site. Within a stand of similar aged trees. In competition with adjacent trees. Some historic pruning wounds with good wood development and now mostly occluded.	Of amenity value in association with larger group. Monitor pruning wounds for signs of decay.	20+	B2

Ref. No	Species	Est. Height (m)	Stem Dia. (mm)	Canopy Spread (m)				First significant branch (m)	Canopy Clearance (m)	Physiological Condition	Age	Observations and Conditions	Preliminary Management Recommendations	Est. Remaining Contribution (yrs)	Category
				N	S	E	W								
T97	Indian Bean Tree (<i>Catalpa bignonioides</i>)	12.0	405	5.6	6.7	5.6	5.7	2.5 (S)	2.0 (S)	Fair / Good	EM	Growing within area of mown grass on the edge of sports pitch within the western part of the Stag Brewery component of the Site. Within a stand of similar aged trees. In competition with adjacent trees. Some historic pruning wounds with good wound wood development and now mostly occluded. Trunk wound at 1.0m Ht. on south side with wound wood and decay visible. Shallow surface roots to east with mower damage and possible decay. Deadwood within canopy.	Of amenity value in association with larger group. Monitor pruning wounds for signs of decay.	20+	B2
T98	London Plane (<i>Platanus x hispanica</i>)	13.0	350	5.9	6.3	6.7	4.5	2.5 (SW)	3.0 Av.	Fair / Good	SM	Growing within area of mown grass on the edge of sports pitch within the western part of the Stag Brewery component of the Site. Within a stand of similar aged trees. Historic pruning wounds to trunk and within canopy with little wound wood development. Canopy now biased to west and beginning to compete with adjacent tree.	Of amenity value/potential as part of an informal group. Monitor pruning wounds for signs of decay.	40+	B2

Ref. No	Species	Est. Height (m)	Stem Dia. (mm)	Canopy Spread (m)				First significant branch (m)	Canopy Clearance (m)	Physiological Condition	Age	Observations and Conditions	Preliminary Management Recommendations	Est. Remaining Contribution (yrs)	Category
				N	S	E	W								
T99	Indian Bean Tree (<i>Catalpa bignonioides</i>)	12.0	440	6.1	7.3	6.2	6.5	Av. 2.5	3.0 (S)	Fair / Good	EM	Growing within area of mown grass on the edge of sports pitch within the western part of the Stag Brewery component of the Site. Within a stand of similar aged trees. Historic pruning wounds visible within canopy but little wound wood development. Railings immediately to the west beginning to foul trunk development.	Of amenity value and potential as part of an informal group. Monitor pruning wounds for signs of decay. Remove or adjust railing to prevent long term impacts on trunk development.	20+	B2
T100	Manna Ash (<i>Fraxinus ornus</i>)	12.0	310	4.	5.6	5.4	4.3	3m (SW)	Av. 3.5	Fair / Good	SM	Growing within area of mown grass on the edge of sports pitch within the western part of the Stag Brewery component of the Site. Within a stand of similar aged trees. Historic pruning wounds with wound wood, decay and occasional cavities visible. Some torn branch stubs and deadwood present within canopy.	Of amenity value in association with larger group. Monitor pruning wounds and trunk wound for signs of decay. Tidy torn branch stubs.	20+	B2

Ref. No	Species	Est. Height (m)	Stem Dia. (mm)	Canopy Spread (m)				First significant branch (m)	Canopy Clearance (m)	Physiological Condition	Age	Observations and Conditions	Preliminary Management Recommendations	Est. Remaining Contribution (yrs)	Category
				N	S	E	W								
G101	Ash (<i>Fraxinus excelsior</i>), Stag's Horn Sumach (<i>Rhus typhina</i>), Sycamore (<i>Acer pseudoplanatus</i>), Wild Cherry (<i>Prunus avium</i>)	5.0-10.0	Varies	Varies				Varies	Varies	Fair	Y-SM	Informal self-sown group located within hardstanding redundant alleyway directly north of the Site boundary wall to the north west of the Stag Brewery component of the Site. No direct access possible. Appears unmanaged in form with several canopies overhanging the Site.	Of amenity and screening value to location.	20+	B2
H102	Privet (<i>Ligustrum ovalifolium</i>)	0.75	n/a	Av. 0.5 wide				n/a	n/a	Fair	SM?	Regularly managed hedge located on edge of sports pitch on southern boundary of the Stag Brewery component of the Site.	Of nominal screening and amenity value to location.	40+	C2
T103	Lime (<i>Tilia sp.</i>)	12	425	5.0	5.3	5.1	5.1	2.0 (W)	4.0 (S)	Fair / Good	SM	Located within 1.0x1.5m tree pit in pavement along Lower Richmond Road within the west of the Chalkers Corner component of the Site. Historic pruning wounds, mostly occluded. Canopy lift wounds on all sides. Balanced canopy form. In competition with G104.	Of amenity value as a group. Monitor pruning wounds for signs of decay.	20+	B2

Ref. No	Species	Est. Height (m)	Stem Dia. (mm)	Canopy Spread (m)				First significant branch (m)	Canopy Clearance (m)	Physiological Condition	Age	Observations and Conditions	Preliminary Management Recommendations	Est. Remaining Contribution (yrs)	Category
				N	S	E	W								
G104	2No. Lime (<i>Tilia sp.</i>)	Av. 8.0	250, 235	Av. 3.3				Av. 3.0	Av. 4.0	Fair / Good	SM	Located within 1.0x1.5m tree pit in pavement along Lower Richmond Road within the west of the Chalkers Corner component of the Site. Linear wound on west tree at 1.4-1.7m Ht. with some wound wood development. Lichen growth noted on north side of trunks. Canopy lifting and reduction wounds on all sides.	Of general amenity value in association with adjacent trees. Monitor wounds for signs of decay.	40+	B2
T105	Lime (<i>Tilia sp.</i>)	5.0	75	1.2	1.8	1.2	1.3	1.5 (E)	2.0 (E)	Good	Y	Located within 1.0x1.5m tree pit in pavement along Lower Richmond Road within the west of the Chalkers Corner component of the Site. Stakes and tie still in situ however one stake has rotted at base and is no longer supporting tree. Balanced form.	Of nominal amenity value to location but with potential to increase with age. Remove redundant stakes and ties.	40+	C2

Ref. No	Species	Est. Height (m)	Stem Dia. (mm)	Canopy Spread (m)				First significant branch (m)	Canopy Clearance (m)	Physiological Condition	Age	Observations and Conditions	Preliminary Management Recommendations	Est. Remaining Contribution (yrs)	Category
				N	S	E	W								
T106	Lime (<i>Tilia sp.</i>)	8.0	190	2.5	2.9	2.9	2.7	1.5 (E)	2.0 (E)	Fair / Good	SM	Located within 1.0x1.5m gravel tree pit in pavement along Lower Richmond Road within the south of the Chalkers Corner component of the Site. Historic linear wound on south west side almost occluded. Limb removal at 1.8m Ht. with no wound wood development. Bifurcates at 2.0m Ht.	Of general amenity value to location. Monitor wounds for signs of decay.	40+	B2
T107	Silver Leaved Lime (<i>Tilia petiolaris</i>)	12.0	325	3.9*	4.5	3.7	3.8	1.8 (W)	3.0 (W)	Fair	SM	Located within 1.0x1.5m tree pit in pavement along Lower Richmond Road within the west of the Chalkers Corner component of the Site. Balanced form. Low (2.4m Ht.) branching form. Some linear faults below branch junctions. Scale insects noted.	Of general amenity value to location. Monitor fork junctions for weakness.	20+	B2
T108	Himalayan Birch (<i>Betula utilis</i>)	5.0	75	Av. 1.0				1.0 (N)	0.5 (E)	Fair	Y	Located within mown grass verge along Clifford Avenue within the north of the Chalkers Corner component of the Site.	Of nominal amenity value to location but with potential to increase with age.	40+	C2

Ref. No	Species	Est. Height (m)	Stem Dia. (mm)	Canopy Spread (m)				First significant branch (m)	Canopy Clearance (m)	Physiological Condition	Age	Observations and Conditions	Preliminary Management Recommendations	Est. Remaining Contribution (yrs)	Category
				N	S	E	W								
G109	2No. Whitebeam (<i>Sorbus aria sp.</i>)	Av. 5.0	Av. 75	Av. 1.0				Av. 2.0	Av. 1.5	Poor / Fair	Y	Located within mown grass verge along Clifford Avenue within the north of the Chalkers Corner component of the Site. Historic strimmer damage to bases with signs of decay. Further pruning wounds up trunk	Of nominal amenity value to location but with potential to increase with age. Monitor wounds and decay at base.	20+	C2
T110	Silver Birch (<i>Betula pendula</i>)	10.0	110	1.7	1.2	1.8	1.1	2.0 (S)	1.5 (S)	Fair	Y - SM	Located within mown grass verge along Clifford Avenue within the north of the Chalkers Corner component of the Site. Historic mower damage at base. Historic pruning wounds with varying degrees of wound wood development.	Of nominal amenity value to location but with potential to increase with age. Monitor wounds for signs of decay.	40+	C2
T111	London Plane (<i>Platanus x hispanica</i>)	15.0	410	5.6	6.3	5.5*	5.5*	3.0 (W)	3.5 (N)	Fair / Good	SM	Located within mown grass verge along Clifford Avenue within the north of the Chalkers Corner component of the Site. Balanced canopy. Historic pruning wounds at fork junction with varying degrees of wound wood development. Canopy has previously been reduced on SE side.	Of general amenity value to location. Monitor wounds for signs of decay.	40+	B2

Ref. No	Species	Est. Height (m)	Stem Dia. (mm)	Canopy Spread (m)				First significant branch (m)	Canopy Clearance (m)	Physiological Condition	Age	Observations and Conditions	Preliminary Management Recommendations	Est. Remaining Contribution (yrs)	Category
				N	S	E	W								
G112	4No. Norway Maple (<i>Acer platanoides</i>)	Av. 8.0	100, 120	Av. 3.0				Av. 2.0	Av. 2.0	Good	SM	Located in the Chalkers Corner component of the Site within area of mown grass with 2ft brick boundary wall to north east. In mutual competition. Only two of four trees identified on topographical survey.	Of general amenity value to location as a group. Consider thinning to favour development of better specimens.	40+	C2
T113	Holm Oak (<i>Quercus ilex</i>)	8.0	145	2.1	2.5	2.7	2.1	2.0 (N)	1.2 (N)	Good	SM	Located in the Chalkers Corner component of the Site within area of mown grass. Redundant tree stake present. Notch of bark missing on NW side. Historic pruning wounds on lower trunk with varying degrees of occlusion. Leaf miners noted, likely Zeller's midget moth (<i>Phyllonorycter messaniella</i>).	Of general amenity value to location. Remove redundant tree stake.	20+	C2

Ref. No	Species	Est. Height (m)	Stem Dia. (mm)	Canopy Spread (m)				First significant branch (m)	Canopy Clearance (m)	Physiological Condition	Age	Observations and Conditions	Preliminary Management Recommendations	Est. Remaining Contribution (yrs)	Category
				N	S	E	W								
T114	Holm Oak (<i>Quercus ilex</i>)	12.0	195	3.6	3.3	3.6	3.7	2.5 (E)	1.5 (N)	Fair / Good	SM	Located in the Chalkers Corner component of the Site within area of mown grass. Redundant tree stake present. Limb removal wound at 0.4m Ht. and on upper trunk with limited wound wood development. Leaf miners noted, likely Zeller's midget moth (<i>Phyllonorycter messaniella</i>).	Of general amenity value to location. Remove redundant tree stake.	20+	C2
G115	5No. Norway Maple (<i>Acer platanoides</i>)	Av. 10.0	Av. 125	Av. 3.5				Av. 1.5	Av. 2.0	Fair / Good	SM	Located in the Chalkers Corner component of the Site within area of mown grass adjacent to brick boundary wall with shrubs beneath. Some exposed shallow surface roots and linear wounds on trunk with varying degrees of wound wood development. In mutual competition. Several m/s in form below 0.5m Ht.	Of nominal amenity value as a group. Consider selective thinning to favour the development of fewer specimens.	20+	C2

Ref. No	Species	Est. Height (m)	Stem Dia. (mm)	Canopy Spread (m)				First significant branch (m)	Canopy Clearance (m)	Physiological Condition	Age	Observations and Conditions	Preliminary Management Recommendations	Est. Remaining Contribution (yrs)	Category
				N	S	E	W								
T116	Cherry (<i>Prunus sp.</i>)	12.0	240	4.0	3.6	4.1	4.2	1.5 (E)	2.0 (E)	Good	SM	Located in the Chalkers Corner component of the Site within area of mown grass. Historic pruning wounds to 3.0m Ht. on trunk and within lower branches with minor wound wood development and some decay. Redundant stake has been cut at ground level. Balanced form.	Of general amenity value to location. Monitor wounds and extent of decay.	20+	B2
G117	2No. Cider Gum (<i>Eucalyptus gunnii</i>)	Av. 15.0	460, 365	Av. 4.0				Av. 2.0	Av. 1.5	Fair / Good	SM - EM	Located in the Chalkers Corner component of the Site within area of mown grass adjacent to brick boundary wall. North east tree branches at ground level. Beginning to compete with adjacent trees. Some historic pruning wounds noted.	OF general amenity value to location. Monitor pruning wound for signs of decay.	40+	B2
T118	Holm Oak (<i>Quercus ilex</i>)	8.0	160	2.0	3.0	2.5	2.5	2.5 (W)	2.0 (W)	Good	SM	Located in the Chalkers Corner component of the Site within area of mown grass. Historic pruning wounds at 2.4m Ht. Redundant tree stake cut at ground level. Leaf miners noted, likely Zeller's midget moth (<i>Phyllonorycter messaniella</i>).	Of general amenity value to location. Monitor wounds for signs of decay.	20+	B2

Ref. No	Species	Est. Height (m)	Stem Dia. (mm)	Canopy Spread (m)				First significant branch (m)	Canopy Clearance (m)	Physiological Condition	Age	Observations and Conditions	Preliminary Management Recommendations	Est. Remaining Contribution (yrs)	Category
				N	S	E	W								
T119	Cherry (<i>Prunus</i> sp.)	-	-	-	-	-	-	-	-	-	-	Dead specimen located within the Chalkers Corner component of the Site.	Fell and replace	-	U
T120	Red Norway Maple (<i>Acer platanooides</i> 'Crimson King')	12.0	420	4.5	4.0	4.2	3.9*	2.0 (S)	3.5 (S)	Fair / Good	SM	Located in the Chalkers Corner component of the Site within area of mown grass. Shrubs to 5.0m Ht. on north side. Some deadwood within canopy. Historic pruning wounds in lower canopy with minor wound wood development.	Of general amenity value to location. Monitor wounds for signs of decay. Consider formative pruning to remove deadwood.	20+	C2

Ref. No	Species	Est. Height (m)	Stem Dia. (mm)	Canopy Spread (m)				First significant branch (m)	Canopy Clearance (m)	Physiological Condition	Age	Observations and Conditions	Preliminary Management Recommendations	Est. Remaining Contribution (yrs)	Category
				N	S	E	W								
T121	Cherry (<i>Prunus</i> sp.)	15	680	4.7	4.5*	4.9	5.5	3.5 (W)	2.0 (W)	Fair	M - OM	Located in the Chalkers Corner component of the Site within area of mown grass adjacent to brick boundary wall with shrubs below. Large specimen. Several dead limbs. Historic pruning wounds and limb removal on trunk with varying degrees of occlusion and some decay. White and bracket fungi noted. Tree tag 0001.	Of general amenity value to location. Identify fungi and significance to the health of the tree. Consider formative pruning to remove deadwood given proximity to pavement and carriageway.	20+	B2
T122	Cider Gum (<i>Eucalyptus gunnii</i>)	15	400	Av. 2.5				2.5 (W)	1.5 (S)	Fair	EM - M	Located in the Chalkers Corner component of the Site within area of mown grass adjacent to brick boundary wall with shrubs at base. Linear splits noted in trunk bark.	Of general amenity value to location. Monitor trunk splitting for possible structural issues.	40+	B2

Ref. No	Species	Est. Height (m)	Stem Dia. (mm)	Canopy Spread (m)				First significant branch (m)	Canopy Clearance (m)	Physiological Condition	Age	Observations and Conditions	Preliminary Management Recommendations	Est. Remaining Contribution (yrs)	Category
				N	S	E	W								
T123	Horse Chestnut (<i>Aesculus hippocastanum</i>)	8.0	155	2.3	2.9	2.9	3.1	0.5 (E)	0.25 (e)	Good	SM	Located in the Chalkers Corner component of the Site within area of mown grass. Slight bend to trunk. Historic strimmer damage to base. Minor epicormic growth on trunk from base to 1.0m Ht.	Of general amenity value to location. Remove epicormic growth. Monitor for signs of BCHC.	40+	B2
T124	False Acacia (<i>Robina pseudoacacia</i>)	12.0	145	3.0	3.0	3.5	1.2	1.5 (N)	1.5 (E)	Fair	SM	Located in the Chalkers Corner component of the Site within area of mown grass. Metal tree guard fouling trunk development. Historic pruning wounds with minor wound wood development. Several dead branches.	Of general amenity value to location. Carefully remove tree guard and support with stakes and ties if required.	20+	C2
T125	Red Norway Maple (<i>Acer platanoides</i> 'Crimson King')	10.0	150	3.0	3.2	3.0	3.5	0.5 (E)	2.5 (N)	Fair	SM	Located in the Chalkers Corner component of the Site within area of mown grass. Bifurcates at 0.5m Ht. Minor root girdling noted with a single exposed shallow surface root on west side. Historic pruning wounds on branches. Linear fault below branch fork. In competition with T126.	Of general amenity value to location. Monitor fork junction for weakness.	20+	C2

Ref. No	Species	Est. Height (m)	Stem Dia. (mm)	Canopy Spread (m)				First significant branch (m)	Canopy Clearance (m)	Physiological Condition	Age	Observations and Conditions	Preliminary Management Recommendations	Est. Remaining Contribution (yrs)	Category
				N	S	E	W								
T126	Norway Maple (<i>Acer platanoides</i>)	15.0	410	4.9	5.2	5.2	5.3	1.5 (N)	2.0 (N)	Fair	SM	Located in the Chalkers Corner component of the Site within area of mown grass. Suckering growth at base. Large linear wound on west side with decay noted. Historic pruning wounds with minor wound wood development.	Of nominal amenity value to location. Inspect for safety.	10+	C2
T127	Yew (<i>Taxus baccata</i>)	8.0	M/S (8) Av. 140	Av. 3.0				0.5 (E)	0.0 (E)	Fair	EM - M	Located in the Chalkers Corner component of the Site adjacent to boundary fence of Chertsey Court. In competition with adjacent trees. M/S from base.	Of nominal amenity value to location.	20+	C2
T128	Silver Birch (<i>Betula pendula</i>)	5.0	70	Av. 1.5				1.5 (W)	0.5 (W)	Fair	Y	Located in the Chalkers Corner component of the Site within area of mown grass. Metal tree guard and strimmer guard present. Minor pruning wounds to trunk with limited wound wood development.	Of nominal amenity value to location but with potential to increase with age. Remove metal and strimmer guards when no longer needed.	40+	C2

Ref. No	Species	Est. Height (m)	Stem Dia. (mm)	Canopy Spread (m)				First significant branch (m)	Canopy Clearance (m)	Physiological Condition	Age	Observations and Conditions	Preliminary Management Recommendations	Est. Remaining Contribution (yrs)	Category
				N	S	E	W								
T129	Atlas Cedar (<i>Cedrus atlantica</i>)	12.0	250*	Av. 2.5				0.5 (S)	0 (S)	Fair	EM	Located in the Chalkers Corner component of the Site within area of mown grass. Balanced form. Some deadwood in lower canopy.	Of general amenity value to location.	40+	B2
T130	Ash (<i>Fraxinus excelsior</i>)	8.0	120	1.0	1.5	0.5	1.5	0.25 (W)	0.25 (W)	Fair	Y - SM	Located in the Chalkers Corner component of the Site within area of mown grass. Epicormic growth on trunk.	Of nominal amenity value to location but potential to increase with age. Monitor for signs of Ash Dieback Disease (<i>Hymenoscyphus fraxineus</i>).	40+	C2
G131	3No. Cherry (<i>Prunus sp.</i>)	Av. 10.0	Av. 250	Av. 3.5				Av. 2.5	Av. 2.5	Fair / Good	SM	Located within soft landscape beds along Lower Richmond Road, directly north of the Chalkers Corner component of the Site. Balanced forms. Historic pruning wounds with varying degrees of occlusion.	Of general amenity value to location. Monitor pruning wounds for signs of decay.	20+	B2

Ref. No	Species	Est. Height (m)	Stem Dia. (mm)	Canopy Spread (m)				First significant branch (m)	Canopy Clearance (m)	Physiological Condition	Age	Observations and Conditions	Preliminary Management Recommendations	Est. Remaining Contribution (yrs)	Category
				N	S	E	W								
G132	Plum (<i>Prunus sp.</i>) Norway Maple (<i>Acer platanoides</i>) Cherry Laurel (<i>Prunus laurocerasus</i>) Japanese Laurel (<i>Aucuba japonica</i>)	Av. 10.0	Av. 190	Av. 2.5				Av. 2.0	Av. 1.5	Fair / Good	SM	Located within soft landscaping beds along Lower Richmond Road within the Chalkers Corner component of the Site. Plum is m/s in form. In mutual competition. Cherry laurel to 8.0m Ht.	Of general amenity value to location as a group. Prune cherry laurel to reduce height and competition with G131.	20+	C2
T133	Horse Chestnut (<i>Aesculus hippocastanum</i>)	15.0	460	5.8	5.5	5.6	5.7	1.5 (N)	2.0 (N)	Fair / Good	SM - EM	Located within mown grass verge along Lower Richmond Road within the Chalkers Corner component of the Site. Historic pruning wounds in lower canopy. Twist to trunk. Minor exposed shallow surface roots with some historic mower damage noted. In competition with T134.	Of general amenity value to location. Monitor for signs of BCHC and roots for signs of decay.	20+	B2

Ref. No	Species	Est. Height (m)	Stem Dia. (mm)	Canopy Spread (m)				First significant branch (m)	Canopy Clearance (m)	Physiological Condition	Age	Observations and Conditions	Preliminary Management Recommendations	Est. Remaining Contribution (yrs)	Category
				N	S	E	W								
T134	Italian Alder (<i>Alnus cordata</i>)	15.0+	535	4.8*	4.8*	5.2	2.9	3.0 (W)	3.5 (W)	Fair	SM - EM	Located within mown grass verge along Lower Richmond Road within the Chalkers Corner component of the Site. Trunk leans to SE. Historic pruning wounds on trunk now mostly occluded. In competition with T133.	Of general amenity value to location.	20+	B2
T135	Italian Alder (<i>Alnus cordata</i>)	12.0	310	Av 1.0				3.0 (W)	n/a	Poor	SM	Located within mown grass verge along Lower Richmond Road within the Chalkers Corner component of the Site. Poor condition with cracked and peeling bark. Fungi noted in upper canopy. <5% leaf production. Canopy spread measurements represent dead limbs.	Remove and replace.	<10	U
T136	Red Horse Chestnut (<i>Aesculus x carnea briotii</i>)	15.0	300	3.5	3.5	3.6	3.2	3.0 (W)	2.5 (E)	Fair	SM	Located within mown grass verge along Lower Richmond Road within the Chalkers Corner component of the Site. Large bole at base of trunk. Historic pruning wounds on trunk with no wound wood development.	Of general amenity value to location. Monitor for signs of BCHC.	20+	B2

Ref. No	Species	Est. Height (m)	Stem Dia. (mm)	Canopy Spread (m)				First significant branch (m)	Canopy Clearance (m)	Physiological Condition	Age	Observations and Conditions	Preliminary Management Recommendations	Est. Remaining Contribution (yrs)	Category
				N	S	E	W								
T137	Italian Alder (<i>Alnus cordata</i>)	15.0+	330	4.1	4.2	4.1	3.5	3.0 (E)	2.5 (E)	Fair	SM	Located within mown grass verge along Lower Richmond Road within the Chalkers Corner component of the Site. Leans S but otherwise balanced in form. Minor canopy lift wounds adjacent to carriageway.	Of general amenity value to location. Monitor pruning wounds for signs of decay.	20+	B2
G138	5No. Italian Alder (<i>Alnus cordata</i>)	Av. 10.0	Av. 145	Av. 1.5				Av. 2.0	Av. 2.5	Fair	Y - SM	Located within area of mown grass along Lower Richmond Road within the Chalkers Corner component of the Site. Several specimens in severe decline with only 5-10% leaf production. Large linear wounds to bases of several with limited wound wood development and some decay. Dead limbs present in all.	Remove dead/dying specimens and replace.	<10	U
G139	4No. Italian Alder (<i>Alnus cordata</i>)	Av. 8.0	Av. 120	Av. 1.0				Av. 2.0	n/a	Poor / Dead	Y	Located within area of mown grass along Lower Richmond Road within the Chalkers Corner component of the Site. All in poor condition with 5-10% leaf production.	Remove and replace.	<10	U

Ref. No	Species	Est. Height (m)	Stem Dia. (mm)	Canopy Spread (m)				First significant branch (m)	Canopy Clearance (m)	Physiological Condition	Age	Observations and Conditions	Preliminary Management Recommendations	Est. Remaining Contribution (yrs)	Category
				N	S	E	W								
T140	Red Horse Chestnut (<i>Aesculus x carnea briotii</i>)	12.0	435	4.4	4.8	4.7	4.9	Forks at 1.6	3.0 (S)	Fair / Good	SM	Located on edge of mown grass along Lower Richmond Road within the Chalkers Corner component of the Site.	Of general amenity value to location. Monitor for signs of BCHC.	20+	B2
G141	3No. Italian Alder (<i>Alnus cordata</i>)	Av. 5.0	Av. 70	Av. 1.0				Av. 2.0	Av. 2.0	Poor / Fair	Y	Located on edge of mown grass along Lower Richmond Road (within the Site). Strimmer guards fitted to base. Canopies sparse with limited foliage.	Of nominal amenity value to location. Consider for removal and replacement.	<10	U
T142	Elder (<i>Sambucus nigra</i>)	8.0	M/S (6) Av. 70	Av. 2.0				0.0 (S)	0.5 (S)	Fair	SM	Growing behind and being fouled by utilities cupboard along Lower Richmond Road (within the Site). M/S in form and in competition with adjacent tree which is outside of survey area.	Of nominal amenity value to location.	10+	C2/3

Ref. No	Species	Est. Height (m)	Stem Dia. (mm)	Canopy Spread (m)				First significant branch (m)	Canopy Clearance (m)	Physiological Condition	Age	Observations and Conditions	Preliminary Management Recommendations	Est. Remaining Contribution (yrs)	Category
				N	S	E	W								
T143	Apple (<i>Malus sp.</i>)	12.0	255	3.5	3.5	1.5	3.0	2.0 (W)	2.5 (N)	Fair / Good	SM	Located within 0.5x1.0m tree pit surrounded by macadam and further paving along Lower Richmond Road (immediately south of the Site). Historic pruning wounds mostly occluded. Lower canopy has been reduced.	Of general amenity value to location. Monitor pruning wounds for signs of decay.	20+	B2
T144	Norway Maple (<i>Acer platanoides</i>)	12.0	235	3.2	3.2	3.1	3.0	2.0 (E)	3.0 (N)	Good	SM	Located along Lower Richmond Road (immediately south of the Site) within c.1.0m diameter circular tree pit with concrete grills. Minor deflection noted to macadam surface. Linear wound on north side almost occluded.	Of general amenity value to location. Monitor deflection to macadam. Consider carefully removing and replacing tree grills and re-laying macadam surface.	20+	B2

Ref. No	Species	Est. Height (m)	Stem Dia. (mm)	Canopy Spread (m)				First significant branch (m)	Canopy Clearance (m)	Physiological Condition	Age	Observations and Conditions	Preliminary Management Recommendations	Est. Remaining Contribution (yrs)	Category
				N	S	E	W								
TT14 5	Ash (<i>Fraxinus excelsior</i>)	10.0	2.5	Av. 2.5				1.5 (E)	2.5 (E)	Fair	SM	Located within 1.0x1.0m tree pit in macadam pavement along Mortlake High Street to the east of the Stag Brewery component of the Site. Some deflection noted to macadam. Minor root girdling.	Of general amenity value to location. Monitor for signs of Ash Dieback Disease (<i>Hymenoscyphus fraxineus</i>).	20+	B2
G146	3No. Pear (<i>Pyrus sp.</i>)	Av. 10.0	Av. 190	Av. 1.5				Av. 1.5	Av. 2.0	Fair	SM	Located within 0.4m ² tree pit in central reservation of Mortlake High Street to the east of the Stag Brewery component of the Site. No direct access.	Of general amenity value to location.	40+	B2
G147	1No. Peay (<i>Pyrus sp.</i>), 1No. Norway Maple (<i>Acer platanoides</i>)	3.0	<70	-				-	-	-	-	Located within 0.4m ² tree pits in central reservation of Mortlake High Street to the east of the Stag Brewery component of the Site.	Of nominal amenity value to location.	40+	C2

Ref. No	Species	Est. Height (m)	Stem Dia. (mm)	Canopy Spread (m)				First significant branch (m)	Canopy Clearance (m)	Physiological Condition	Age	Observations and Conditions	Preliminary Management Recommendations	Est. Remaining Contribution (yrs)	Category
				N	S	E	W								
G148	1No. White Beam (<i>Sorbus aria</i>) 1No. Apple (<i>Malus sp.</i>) 1No. Ash (<i>Fraxinus excelsior</i>)	Av. 15.0	Av. 300	Av. 4.5				n/a	n/a	Fair / Good	SM	Located in 1.0x1.5m tree pits in macadam pavement of Mortlake High Street to the east of the Stag Brewery component of the Site. Some deflection noted. Historic pruning wounds to trunks with some wound wood development.	Of general amenity value to location as a group. Monitor Ash for signs of Ash Dieback Disease (<i>Hymenoscyphus fraxineus</i>).	40+	B2
T149	Narrow-leaved Ash (<i>Fraxinus angustifolia</i>)	15.0	210	Av. 3.0				3.0 (N)	4.5 (N)	Good	SM	Located within 1.0x1.5m tree pit in macadam pavement of Mortlake High Street to the east of the Stag Brewery component of the Site. Historic pruning wounds to trunk mostly occluded.	Of general amenity value to location.	40+	B2
G150	2No. English Oak (<i>Quercus robur</i>)	Av. 15.0 +	Av. 440	Av. 5.0				3.0 (E)	5.0 (E)	Good	SM - EM	Located within 1.0x1.5m tree pits in macadam pavement of Mortlake High Street to the east of the Stag Brewery component of the Site. Minor deflection noted to macadam surface. Historic pruning wounds in lower canopy with varying degrees of wound wood development. Recent limb removal on west side.	Of general amenity value to location. Monitor wounds for signs of decay.	40+	B2

Ref. No	Species	Est. Height (m)	Stem Dia. (mm)	Canopy Spread (m)				First significant branch (m)	Canopy Clearance (m)	Physiological Condition	Age	Observations and Conditions	Preliminary Management Recommendations	Est. Remaining Contribution (yrs)	Category
				N	S	E	W								
G151	7No. Pear (<i>Pyrus sp.</i>)	Av. 12.0	110 to 210	Av. 2.5				Av. 2.5	Av. 4.0	Fair	SM	Located within 1.0x1.0m tree pits within macadam pavement of Mortlake High Street to the south east of the Stag Brewery component of the Site. Some minor epicormic growth from bases of several specimens.	Of general amenity value as a group. Consider formative pruning to remove epicormic growth from base.	40+	B2
T152	Pear (<i>Pyrus sp.</i>)	8.0	125	Av. 1.5				1.5 (W)	2.0 (W)	Fair	Y	Located within 0.5m ² tree pit in central reservation of Mortlake High Street to the south east of the Stag Brewery component of the Site. Historic pruning wounds at branch junction with minor wound wood development.	Of nominal amenity value to location but potential to increase with age. Monitor pruning wounds for signs of decay.	20+	C2
T153	Norway Maple (<i>Acer platanoides</i>)	15.0+	455	Av. 6.0				1.5 (W)	1.5 (W)	Good	SM	Located within area of mown grass of Mortlake Green to the south of the Stag Brewery component of the Site. Good buttress root development. In competition with T154.	Of general amenity value in association with adjacent trees.	40+	B2

Ref. No	Species	Est. Height (m)	Stem Dia. (mm)	Canopy Spread (m)				First significant branch (m)	Canopy Clearance (m)	Physiological Condition	Age	Observations and Conditions	Preliminary Management Recommendations	Est. Remaining Contribution (yrs)	Category
				N	S	E	W								
T154	Horse Chestnut (<i>Aesculus hippocastanum</i>)	15.0+	650*	Av. 7.0				3.0 (W)	3.0 (W)	Fair	M	Located within area of mown grass on edge of Mortlake Green to the south of the Stag Brewery component of the Site. Symptoms consistent with Bleeding Canker of Horse Chestnut (BCHC) (<i>Pseudomonas syringae pv aesculi</i>) noted. Bifurcates at 2.0m Ht. Some historic canopy reduction wounds in lower canopy.	Of general amenity value to location. Monitor progress of BCHC.	20+	B2
G155	2No. London Plane (<i>Platanus x hispanica</i>)	20.0+	Av. 1,800	Av. 8.5				Av. 5.0	Av. 4.0	Good	M	Located within area of mown grass on edge of Mortlake Green to the south of the Stag Brewery component of the Site. Impressive trees. Some cavities noted in trunks.	Of great amenity value to location. Monitor cavities for decay and overall health of trees.	40+	A2
G156	3No. Sycamore (<i>Acer pseudoplatanus</i>)	Av. 15.0	Av. 450	Av. 4.0				Av. 3.0	Av. 3.0	Fair	EM	Located within area of mown grass in Mortlake Green to the south of the Stag Brewery component of the Site. In mutual competition. Historic pruning wounds with varying degrees of occlusion.	Of general amenity value to location. Monitor pruning wounds for signs of decay.	40+	B2

Ref. No	Species	Est. Height (m)	Stem Dia. (mm)	Canopy Spread (m)				First significant branch (m)	Canopy Clearance (m)	Physiological Condition	Age	Observations and Conditions	Preliminary Management Recommendations	Est. Remaining Contribution (yrs)	Category
				N	S	E	W								
T157	London Plane (<i>Platanus x hispanica</i>)	15.0+	700*	Av. 5.5				2.5 (W)	2.0 (W)	Fair	EM	Located within area of mown grass on edge of Mortlake Green to the south of the Stag Brewery component of the Site. Some cavities and pruning wounds noted in upper canopy, some of which appear fairly recent.	Of general amenity value to location. Monitor cavities and wounds for signs of decay.	40+	B2
T158	Horse Chestnut (<i>Aesculus hippocastanum</i>)	15.0	M/S (2) Av. 360	Av. 3.0				0.0	0.0	Fair	EM	Located within area of mown grass in Mortlake Green to the south of the Stag Brewery component of the Site. Large amount of epicormic growth. Bifurcates at base. In competition with T157.	Of general amenity value to location. Consider formative pruning to remove epicormic growth. Monitor for signs of bleeding canker of horse chestnut (<i>Pseudomonas syringae pv aesculi</i>).	20+	B2

Ref. No	Species	Est. Height (m)	Stem Dia. (mm)	Canopy Spread (m)				First significant branch (m)	Canopy Clearance (m)	Physiological Condition	Age	Observations and Conditions	Preliminary Management Recommendations	Est. Remaining Contribution (yrs)	Category
				N	S	E	W								
T159	Purple Plum (<i>Prunus cerasifera</i> 'Nigra')	12.0	260	Av. 3.5				1.5 (W)	2.0 (W)	Fair	SM	Located in Mortlake Green to the south of the Stag Brewery component of the Site on the edge of a large shrub group with shrubs to 4.0m Ht. limiting further inspection.	Of general amenity value to location.	40+	B2
T160	False acacia (<i>Robina pseudoacacia</i>)	15.0	M/S (3) Av. 220	Av. 6.0				Base	3.0 (W)	Poor / Fair	SM	Located in Mortlake Green to the south of the Stag Brewery component of the Site within area of shrubs. Sparse canopy with crossing branches and deadwood also noted.	Of nominal amenity value to location in association with adjacent trees. Identify cause of ill-health.	10+	C2
T161	English Oak (<i>Quercus robur</i>)	20.0	560	Av. 7.5				3.0 (W)	4.0 (W)	Good	EM - M	Located in Mortlake Green to the south of the Stag Brewery component of the Site within area of mown grass. Historic wound on W side from 0.2-0.6m Ht. Minor deadwood within canopy.	Of general amenity value to location. Monitor wound for signs of decay.	40+	B2

Ref. No	Species	Est. Height (m)	Stem Dia. (mm)	Canopy Spread (m)				First significant branch (m)	Canopy Clearance (m)	Physiological Condition	Age	Observations and Conditions	Preliminary Management Recommendations	Est. Remaining Contribution (yrs)	Category
				N	S	E	W								
G162	2No. False acacia (<i>Robina pseudoacacia</i>)	15.0	Av. 550	Av. 7.5				3.0 (W)	4.0 (W)	Fair	M	Located in Mortlake Green to the south of the Stag Brewery component of the Site within area of shrubs. Sparse canopy with crossing branches and deadwood also noted.	Of nominal amenity value to location in association with adjacent trees. Identify cause of ill-health.	10+	C2
T163	Horse Chestnut (<i>Aesculus hippocastanum</i>)	15.0	370	Av. 5.0				2.0 (W)	1.5 (W)	Fair	EM	Located in Mortlake Green to the south of the Stag Brewery component of the Site within area of mown grass. Exposed shallow surface roots with mower damage noted. Linear cracks to bark. Signs consistent with Bleeding Canker of Horse Chestnut (BCHC) (<i>Pseudomonas syringae pv aesculi</i>).	Of general amenity value to location. Monitor BCHC.	20+	B2

Ref. No	Species	Est. Height (m)	Stem Dia. (mm)	Canopy Spread (m)				First significant branch (m)	Canopy Clearance (m)	Physiological Condition	Age	Observations and Conditions	Preliminary Management Recommendations	Est. Remaining Contribution (yrs)	Category
				N	S	E	W								
G164	9No. Lime (<i>Tilia</i> sp.)	Av. 15.0	Av. 550	Av. 4.0				Av. 4.0	Av. 5.0	Fair	SM	Located along Lower Richmond Road adjacent to Mortlake Green to the south of the Stag Brewery component of the Site in 1.5x1.5m tree pits. Suckering and epicormic growth on most has been previously removed but is beginning to re-grow. Some limbs / co-dominant stems removed.	Of general amenity value to location as a group. Maintain epicormic / suckering growth removal regime.	40+	B2
T165	Norway Maple (<i>Acer platanoides</i>)	12.0	450	Av. 4.5				3.0 (S)	1.5 (S)	Fair	SM	Located in Mortlake Green to the south of the Stag Brewery component of the Site within area of shrubs. In competition with G166.	Of general amenity value to location in association with adjacent trees.	40+	B2
G166	2No. London Plane (<i>Platanus x hispanica</i>)	Av. 15.0	Av. 650	Av. 6.5				2.5 (W)	2.0 (S)	Good	SM - EM	Located in Mortlake Green to the south of the Stag Brewery component of the Site on edge of shrub border. Good buttress root development. In competition with T165.	Of general amenity value to location in association with adjacent trees.	40+	B2

Ref. No	Species	Est. Height (m)	Stem Dia. (mm)	Canopy Spread (m)				First significant branch (m)	Canopy Clearance (m)	Physiological Condition	Age	Observations and Conditions	Preliminary Management Recommendations	Est. Remaining Contribution (yrs)	Category
				N	S	E	W								
G167	14No. Lime (<i>Tilia</i> sp.)	Av. 15.0	Av. 700	Av. 7.0				Av. 4.0	Av. 3.5	Fair	SM - EM	Located within area of mown grass on edge of and within Mortlake Green to the south of the Stag Brewery component of the Site. Epicormic growth to trunks and suckering growth on some specimens.	Of general amenity value to location as a group. Consider formative pruning to remove epicormic and suckering growth.	40+	B2
T168	Beech (<i>Fagus sylvatica</i>)	10.0	195	Av. 1.5				1.5 (S)	1.5 (S)	Fair	Y - SM	Located in Mortlake Green to the south of the Stag Brewery component of the Site within area of mown grass. Historic pruning wounds on trunk almost occluded.	Of nominal amenity value to location.	40+	C2

Ref. No	Species	Est. Height (m)	Stem Dia. (mm)	Canopy Spread (m)				First significant branch (m)	Canopy Clearance (m)	Physiological Condition	Age	Observations and Conditions	Preliminary Management Recommendations	Est. Remaining Contribution (yrs)	Category
				N	S	E	W								
G169	London Plane (<i>Platanus x hispanica</i>) False acacia (<i>Robina pseudoacacia</i>) Sycamore (<i>Acer pseudoplatanus</i>) Horse Chestnut (<i>Aesculus hippocastanum</i>)	Av. 12.0	Av. 550	Av. 5.0				-	-	Fair	SM - EM	Located in Mortlake Green to the south of the Stag Brewery component of the Site within area of mown grass. Most are balanced in form. Bleeding Canker of Horse Chestnut (BCHC) (<i>Pseudomonas syringae pv aesculi</i>) noted on Horse Chestnuts.	Of general amenity value to location as a group. Monitor BCHC and overall health of affected trees.	40+	B2
T170	English Oak (<i>Quercus robur</i>)	8.0	150	Av. 7.0				2.0 (N)	1.0 (N)	Good	SM	Located in Mortlake Green to the south of the Stag Brewery component of the Site within area of mown grass. Level change down 1.0m to east. Some torn branches in lower canopies.	Of general amenity value to location. Consider formative pruning to tidy torn branches.	40+	B2
T171	Apple (<i>Malus sp.</i>)	10.0	230	Av. 3.0				1.5 (N)	1.5 (N)	Good	SM	Located in Mortlake Green to the south of the Stag Brewery component of the Site within group of shrubs on edge of park. Level change down 1.0m to north. Some deflection noted to retaining wall to north.	Of general amenity value to location. Monitor deflection of wall.	20+	C2

Ref. No	Species	Est. Height (m)	Stem Dia. (mm)	Canopy Spread (m)				First significant branch (m)	Canopy Clearance (m)	Physiological Condition	Age	Observations and Conditions	Preliminary Management Recommendations	Est. Remaining Contribution (yrs)	Category
				N	S	E	W								
G172	4No. Cherry (<i>Prunus sp.</i>)	Av. 8.0	220 – 450	Av. 3.0				-	-	Poor / Fair	SM - M	Located within area of mown grass in Mortlake Green to the south of the Stag Brewery component of the Site. Suspected top grafted specimen. Some cankers present at graft point. Minor exposed shallow surface roots.	Of general amenity value to location in association with adjacent trees. Monitor cankers and exposed shallow surface roots.	20+	C2
T173	Yew (<i>Taxus baccata</i>)	10.0	M/S (2) 295, 290	Av. 3.5				0.0	0.0	Fair	SM	Located within area of mown grass in Mortlake Green to the south of the Stag Brewery component of the Site. Bifurcates at base. Minor exposed shallow surface roots.	Of nominal amenity value to location. Monitor exposed surface roots for signs of decay.	40+	C2
G174	2No. Field Maple (<i>Acer campestre</i>) 1No. English Oak (<i>Quercus robur</i>) 1No. Sycamore (<i>Acer pseudoplatanus</i>)	Av. 12.0	Av. 450	Av. 5.0				Av. 1.5	Av. 2.0	Fair / Good	SM - EM	Located within area of mown grass in Mortlake Green to the south of the Stag Brewery component of the Site. Good buttress root development. Historic pruning wounds with varying degrees of wound wood development.	Of general amenity value to location as a group. Monitor pruning wounds for signs of decay.	40+	B2

Ref. No	Species	Est. Height (m)	Stem Dia. (mm)	Canopy Spread (m)				First significant branch (m)	Canopy Clearance (m)	Physiological Condition	Age	Observations and Conditions	Preliminary Management Recommendations	Est. Remaining Contribution (yrs)	Category
				N	S	E	W								
T175	Beech (<i>Fagus sylvatica</i>)	15.0	550	Av. 6.5				1.5 (W)	2.0 (W)	Fair	EM	Located within area of mown grass in Mortlake Green to the south of the Stag Brewery component of the Site. Large wound at base with some wound wood development. Historic pruning wounds on trunk now occluded.	Of general amenity value to location. Monitor wounds for signs of decay.	20+	B2
G176	3No. Lime (<i>Tilia</i> sp.)	Av. 20.0	Av. 750	Av. 9.0				Av. 3.0	Av. 1.5	Fair / Good	M	Located within area of mown grass in Mortlake Green to the south of the Stag Brewery component of the Site. Good buttress root development. Deadwood and torn branches in lower canopies. Historic pruning wounds at base now mostly occluded.	Of general amenity value to location as a group. Consider formative pruning to remove deadwood and torn branches. Monitor pruning wounds for signs of decay.	40+	B2

Ref. No	Species	Est. Height (m)	Stem Dia. (mm)	Canopy Spread (m)				First significant branch (m)	Canopy Clearance (m)	Physiological Condition	Age	Observations and Conditions	Preliminary Management Recommendations	Est. Remaining Contribution (yrs)	Category
				N	S	E	W								
G177	2No. Cherry (<i>Prunus sp.</i>)	8.0	790, 490	Av. 3.5				Av. 1.5	Av. 1.5	Fair / Good	EM - M	Located within area of mown grass in Mortlake Green to the south of the Stag Brewery component of the Site. Some deflection noted to adjacent macadam pathway to W. Suspected top grafted specimens. Exposed shallow surface roots from W specimen with large wounds and decay visible. Historic limb removal from graft junctions.	Of general amenity value to location. Monitor exposed surface roots and decay.	20+	C2
T178	Purple Plum (<i>Prunus cerasifera</i> 'Nigra')	12.0	290	Av. 3.0				1.5 (S)	0.5 (S)	Fair	EM	Located on edge of shrub bed in Mortlake Green to the south of the Stag Brewery component of the Site. Slight lean to east from competition with adjacent shrubs. Crossing and fused branches noted within.	Of general amenity value to location. Consider formative pruning to alleviate crossing branches.	20+	C2

C. Extract from BS5837:2012 – Default Specification for Protective Barrier

Figure 2 Default specification for protective barrier

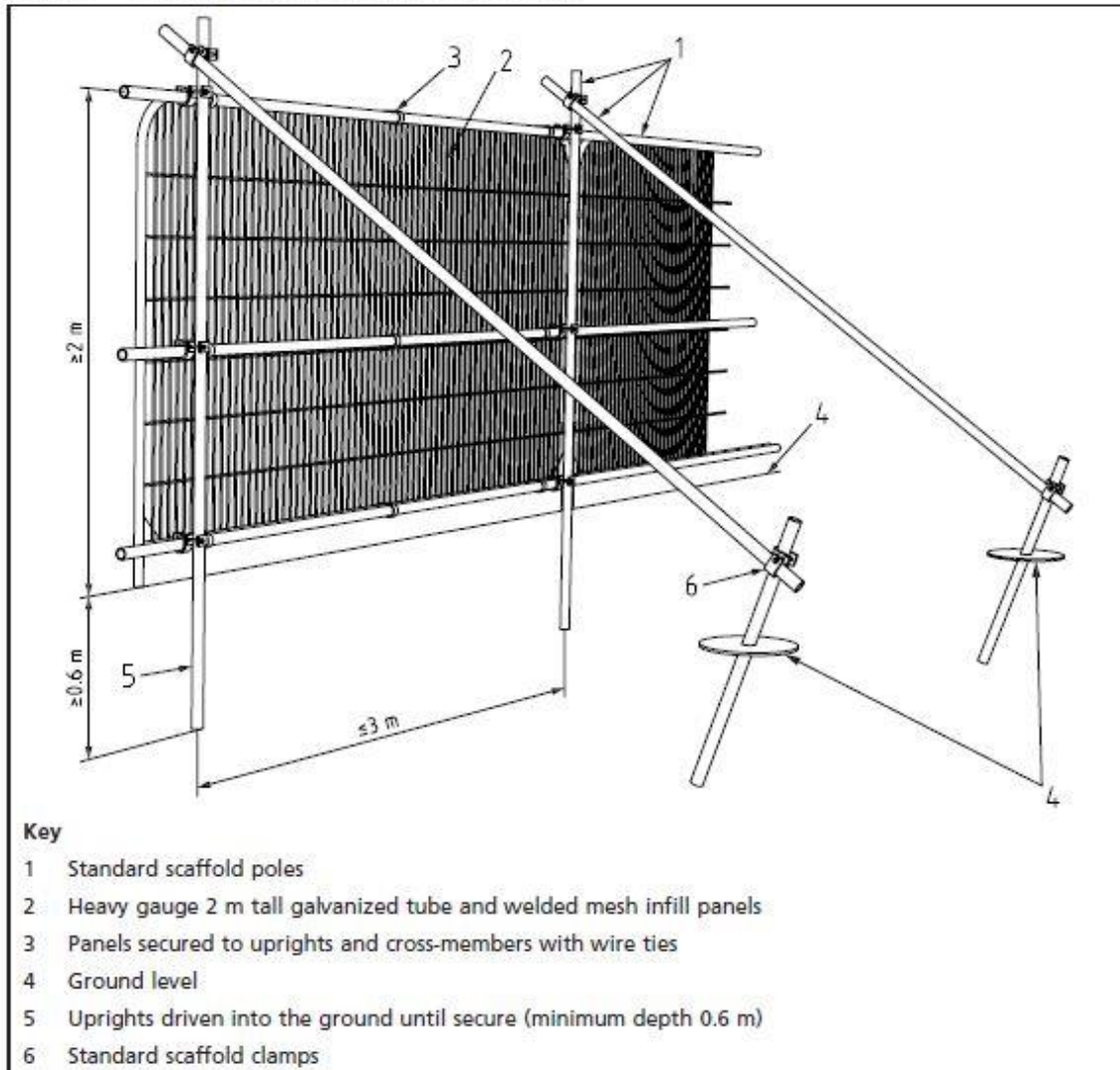

D. Extract from BS5837:2012 – Examples of Above-Ground Stabilizing Systems

Figure 3 Examples of above-ground stabilizing systems

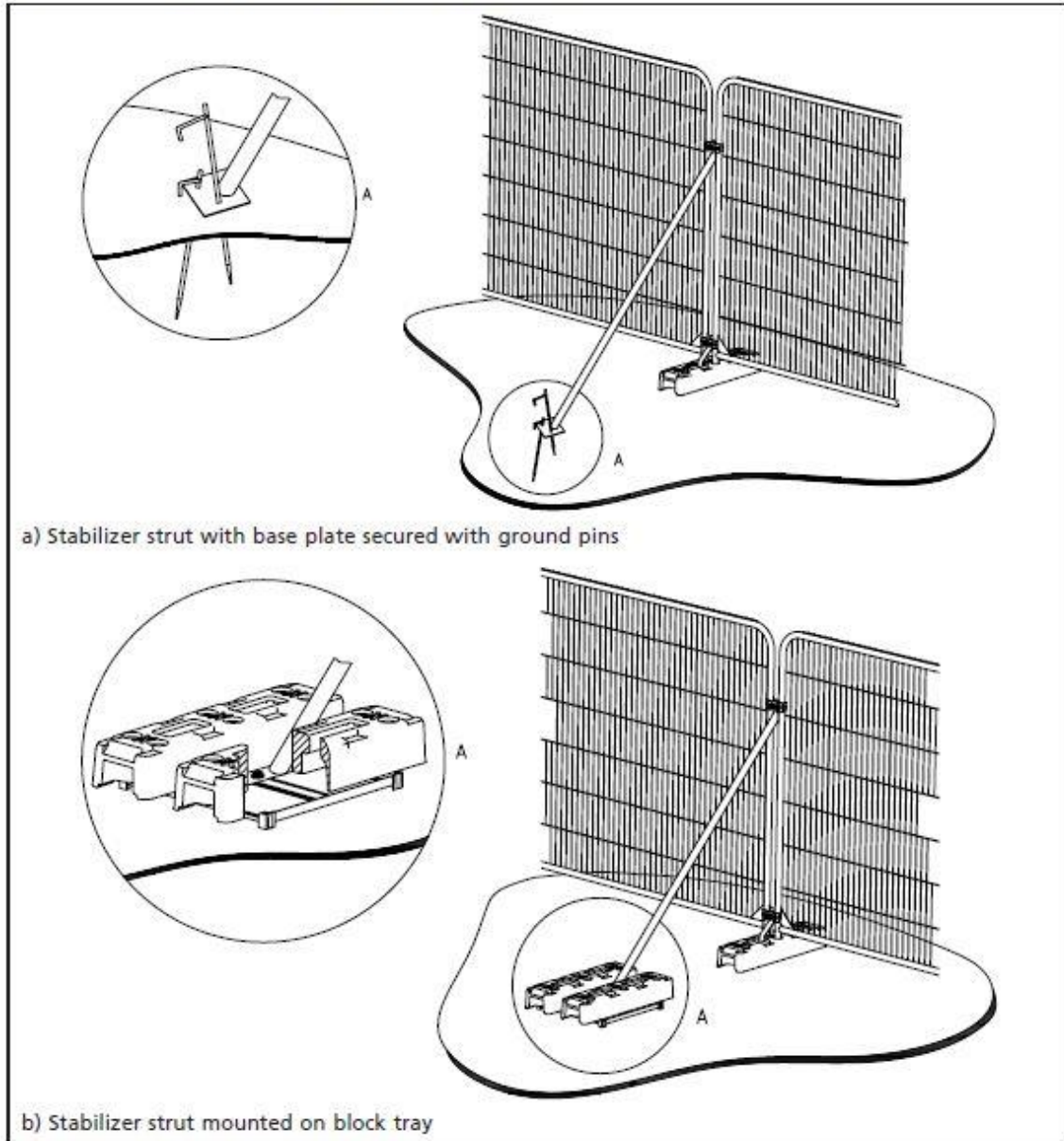

E. Tree Protection Signage (Example)

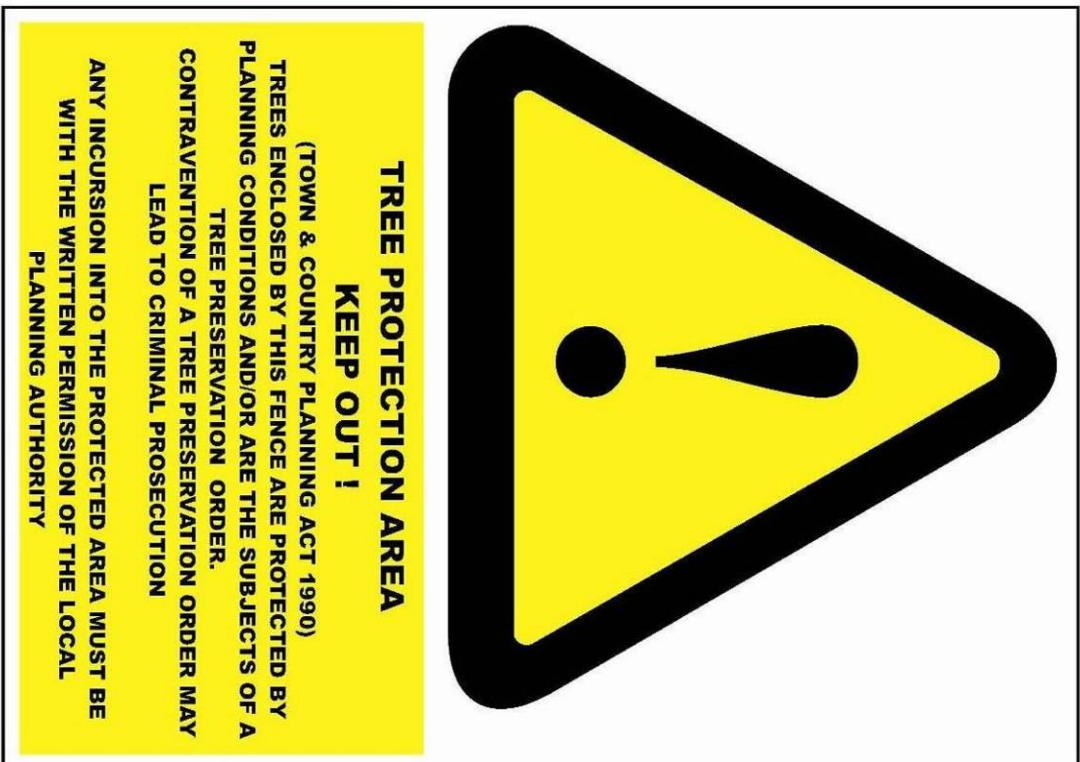

F. Tree-Box Barrier Protection (Example)

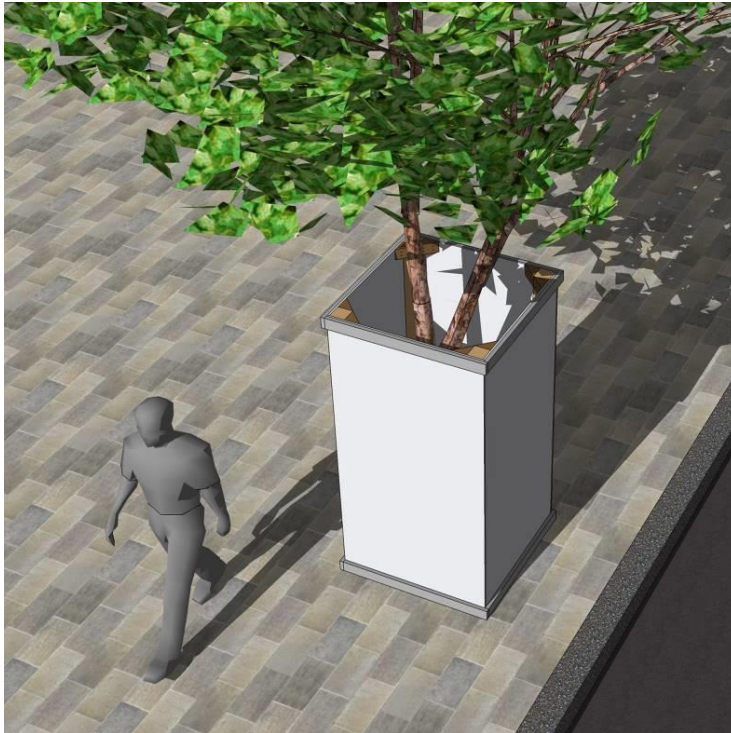

TREE PROTECTION BOX FRAME SPECIFICATION

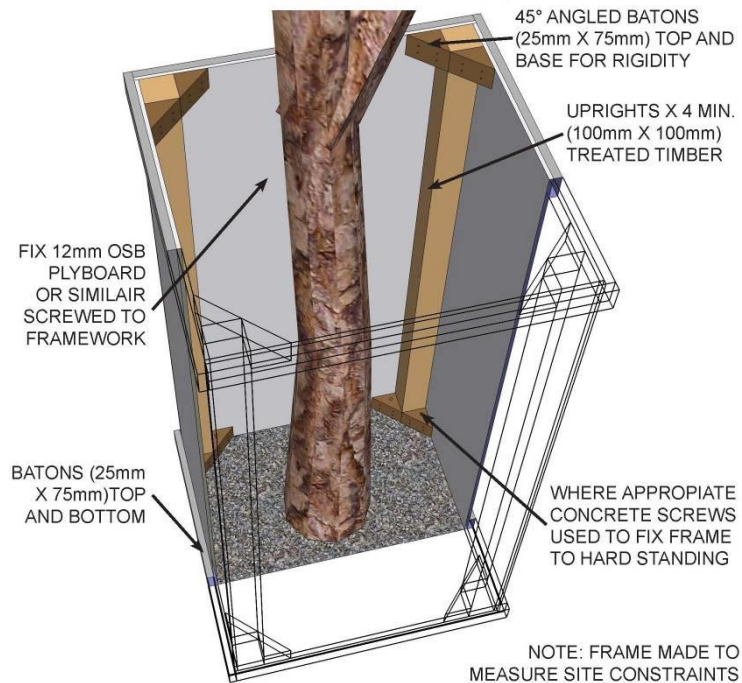

UK and Ireland Office Locations

