

rev	details	by	date
D00	Issue for Information	RJ	29.09.2017
D01	Issue for Information	RJ	04.10.2017
D02	Issue for Information	RJ	25.11.2017
D03	Issue for Planning	RJ	25.01.2018
D04	Issue for Planning	RJ	09.02.2018

Notes

- 1.0 Do not scale from drawing, use figured dimensions only
- 1.1 All dimensions to be checked onsite
- 1.2 This drawing to be read in conjunction with all other Gillespies drawings and specifications

LEGEND

- Public Realm
- Private Realm
- Communal Courtyard
- Site Application Boundary
- School Application Boundary

Note:

- 1. In the event that building positions move within the limits of deviation set out in the parameter plans, the landscape zones will be adjusted to match any deviation from the current layout.
- 2. Please refer to Squires and Partners Drawing 16019_C645_Z2_P_PR_001 to 16019_C645_Z2_P_PR_011 for building locations.

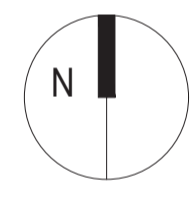
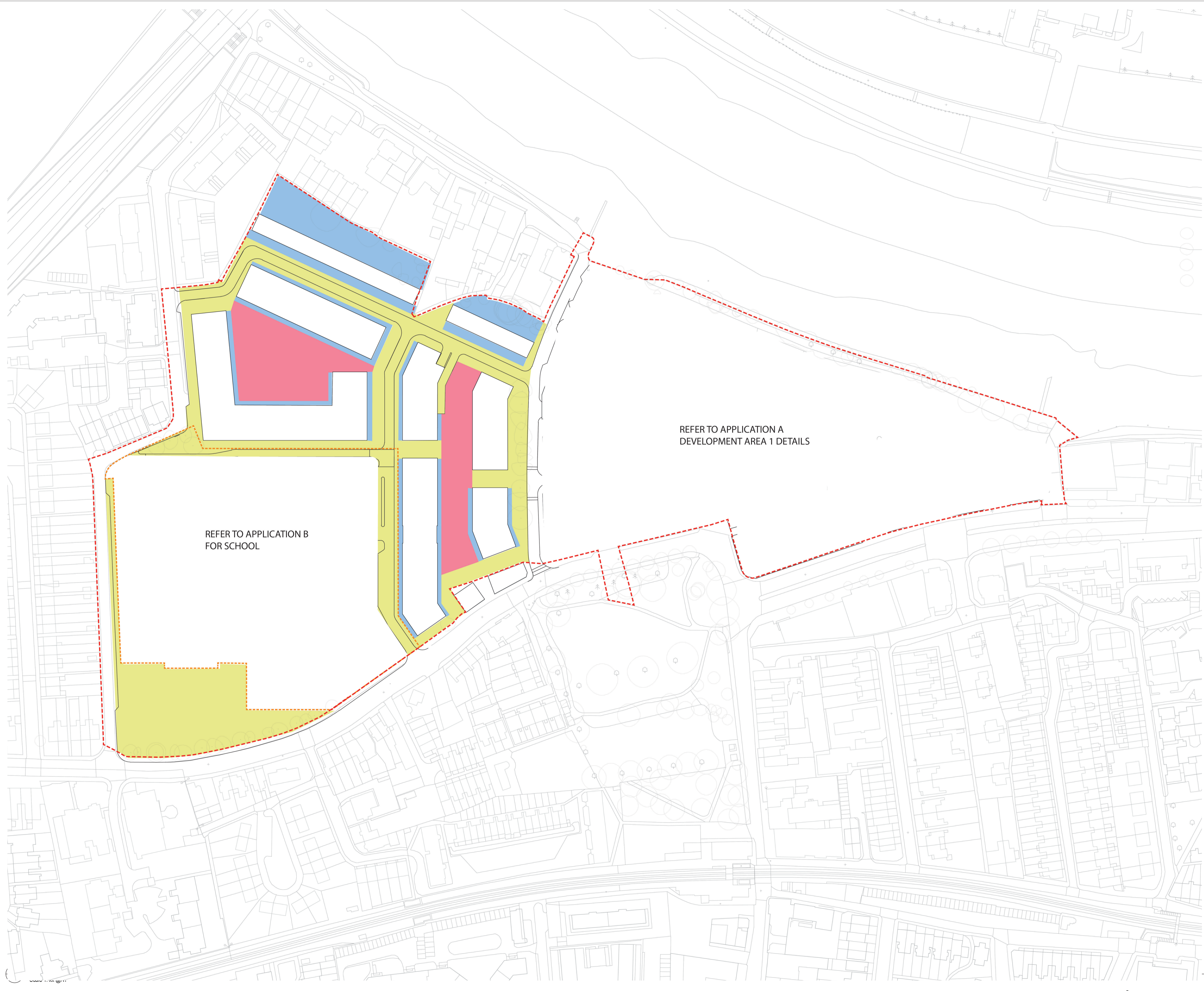

Project title			
STAG BREWERY			
Drawing title			
Proposed Outline Application Open Space Plan			
Drawing status	Scale	Drawn	Date
DESIGN	1:1000 @ A1	RJ	04.10.2017
Drawing number	Revision	Checked	RC
P10736-00-001 - 121	D04	Revision	RC
Client			
DARTMOUTH CAPITAL			
<small>Alameda House, 99-100 Sydney Street, London E9 9JH</small>			
<small>P: 0207 629 9229</small>			
GILLESPIES			
<small>1 St John's Square, London EC1M 4DH P: 020 7253 2929 F: 020 7253 3900 E: design.london@gillespies.co.uk</small>			