



## **Stag Brewery, Mortlake**

### **Environmental Statement Volume 2: Figures**

For Reselton Properties

February 2018



## Environmental Statement Volume 2: Figures

Stag Brewery, Mortlake

February 2018

**Waterman Group plc**

Pickfords Wharf, Clink Street, London SE1 9DG  
[www.watermangroup.com](http://www.watermangroup.com)





**Client Name:** Reselton Properties Limited  
**Document Reference:** Environmental Statement Volume 2: Figures  
**Project Number:** WIE10667

### Quality Assurance – Approval Status

This document has been prepared and checked in accordance with Waterman Group's IMS (BS EN ISO 9001: 2015, BS EN ISO 14001: 2015 and BS OHSAS 18001:2007)

---

Issue	Date	Prepared by	Checked by	Approved by
01	February 2018	Ellen Smith Senior Consultant	Ros Boalch Principal Consultant	Kirsty Rimondi Technical Director



## Disclaimer

This report has been prepared by Waterman Infrastructure & Environment Limited, with all reasonable skill, care and diligence within the terms of the Contract with the client, incorporation of our General Terms and Condition of Business and taking account of the resources devoted to us by agreement with the client.

We disclaim any responsibility to the client and others in respect of any matters outside the scope of the above.

This report is confidential to the client and we accept no responsibility of whatsoever nature to third parties to whom this report, or any part thereof, is made known. Any such party relies on the report at its own risk.

## Contents

### Volume 2: Figures

- Figure 1.1 Site Location Plan
- Figure 1.2 Planning Application Boundaries
- Figure 1.3 The Site
- Figure 3.1 Existing Buildings and Structures on the Stag Brewery component of the Site
- Figure 3.2 Existing On and Off-Site Predominant Land Uses
- Figure 3.3 Selection of Photographs of the Existing Site
- Figure 3.4 Selection of Photographs of the Existing Area Surrounding the Site
- Figure 4.1 March 2017 Public Consultation Masterplan
- Figure 4.2 July 2017 Public Consultation Masterplan
- Figure 4.3 Illustrative Riverfront Elevation Circa March 2017
- Figure 4.4 Illustrative Riverfront Elevation Circa July 2017
- Figure 4.5 March 2017 Chalker's Corner Option
- Figure 4.6 July 2017 Chalker's Corner Option
- Figure 5.1 Location of Proposed Buildings within the Stag Brewery component of the Site
- Figure 6.1 Construction Programme
- Figure 7.1 'Areas' for the Purpose of the Socio-economic Assessment
- Figure 8.1 Location of Pedestrian Crossing Points
- Figure 9.1 Noise Monitoring and Sensitive Receptor Locations
- Figure 10.1 Air Quality Modelled Receptor Locations
- Figure 13.1 Habitat Features Plan
- Figure 13.2 Results of the Evening Bat Activity Survey 13/07/17
- Figure 13.3 Results of the Dawn Bat Activity Survey 08/08/17
- Figure 13.4 Results of the Evening Bat Activity Survey 04/09/17
- Figure 15.1 Heritage Asset Site Plan
- Figure 16.1 Terrain Analysis of the Site and Surrounds
- Figure 16.2 Designations and Access within the Site and Surrounds
- Figure 16.3 Townscape Character Areas as Defined by the Mortlake Village Planning Guidance Draft SPD
- Figure 16.4 Viewpoint Locations agreed with the London Borough of Richmond Upon Thames

- Figure 16.5 Tree Preservation Orders within the Site and Surrounding Area
- Figure 16.6 Viewpoint 1a Existing and Proposed View looking North West across Lower Richmond Road
- Figure 16.7 Viewpoint 1b Existing and Proposed View looking North East across Lower Richmond Road
- Figure 16.8 Viewpoint 2 Existing and Proposed View from Thames Bank looking South East
- Figure 16.9 Viewpoint 3 Existing and Proposed View from the Southern End of Chiswick Bridge
- Figure 16.10 Viewpoint 4 Existing and Proposed View from the Northern End of Chiswick Bridge
- Figure 16.11 Viewpoint 5 Existing and Proposed View from Dan Mason Drive
- Figure 16.12 Viewpoint 6 Existing and Proposed View from the Thames Path (north) looking South West across the River Thames
- Figure 16.13 Viewpoint 7 Existing and Proposed View from Thames Path (south) looking West
- Figure 16.14 Viewpoint 8 Existing and Proposed View from Mortlake High Street looking West
- Figure 16.15 Viewpoint 9 Existing and Proposed View from Sheen Lane
- Figure 16.16 Viewpoint 10 Existing and Proposed View looking North across Mortlake Green
- Figure 16.17 Viewpoint 11 Existing and Proposed View from the Road Bridge on the South Circular Road
- Figure 16.18 Viewpoint 12 Existing and Proposed View from Lower Richmond Road adjacent to Mortlake Green
- Figure 17.1 Photographs of the Wind Tunnel Test Models
- Figure 17.2 Seasonal Wind Roses for London Combined (in Beaufort Force)
- Figure 17.3 Configuration 1 – Existing Site with existing surrounding buildings (Ground Floor, Windiest Season)
- Figure 17.4 Configuration 1 – Existing Site with existing surrounding buildings (Ground Floor, Summer Season)
- Figure 17.5 Configuration 2 – The Development with existing surrounding buildings (Ground Floor, Windiest Season)
- Figure 17.6 Configuration 2 – The Development with existing surrounding buildings (Balconies and Roof View, Windiest Season)
- Figure 17.7 Configuration 2 – The Development with existing surrounding buildings (School Roof, Windiest Season)
- Figure 17.8 Configuration 2 – The Development with existing surrounding buildings (Ground Floor, Summer Season)
- Figure 17.9 Configuration 2 – The Development with existing surrounding buildings (Balconies and Roof View, Summer Season)
- Figure 17.10 Configuration 2 – The Development with existing surrounding buildings (School Roof, Summer Season)

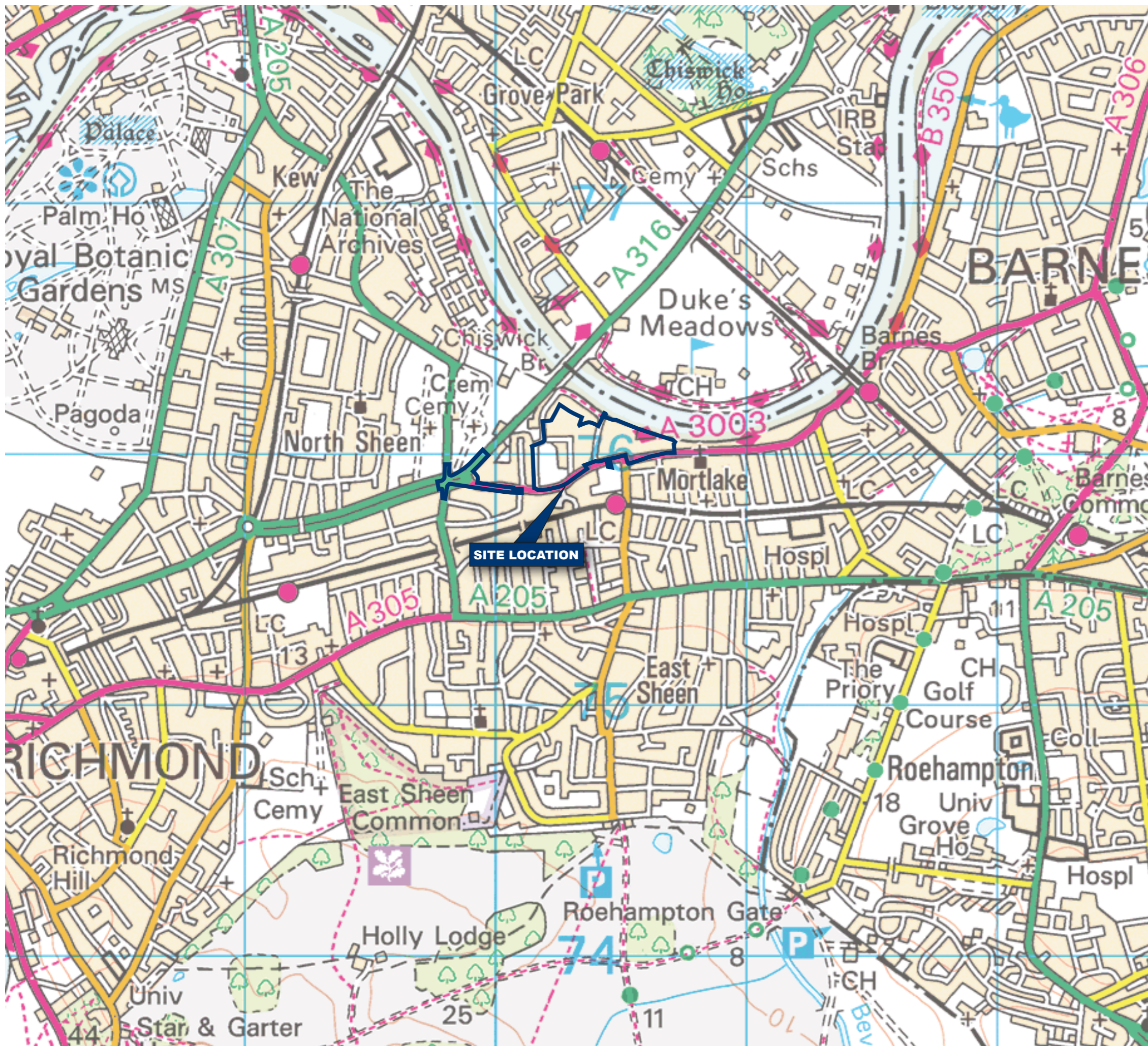

Planning Application Drawings



Project Details	WIE10667-101: Stag Brewery, Mortlake
Figure Title	Figure 1.1: Site Location Plan
Figure Ref	WIE10667-101_GR_ES_1.1A
Date	2018
File Location	\\s-inc\wiel\projects\wie10667\101\graphics\es\issued figures

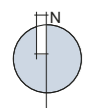
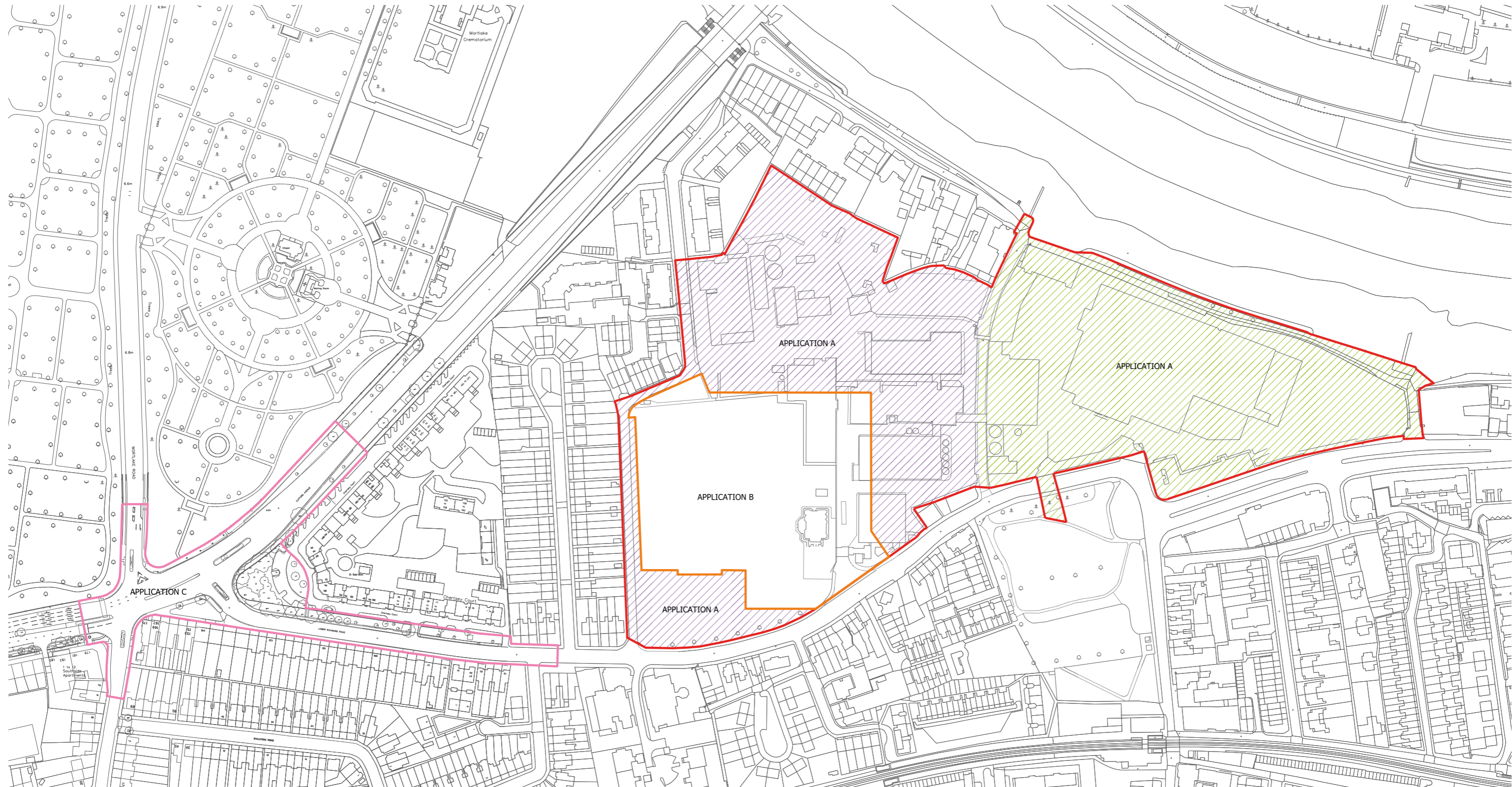



-  Application A Boundary
-  Application B Boundary
-  Application C Boundary

-  Development Area 1
-  Development Area 2

<b>Project Details</b>	WIE10667-101: Stag Brewery, Mortlake
<b>Figure Title</b>	Figure 1.2: Planning Application Boundaries
<b>Figure Ref</b>	WIE10667-101_GR_ES_1.2A
<b>Date</b>	2018
<b>File Location</b>	\\s-incs\wiel\projects\wie10667\101\graphics\es\issued figures

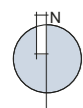
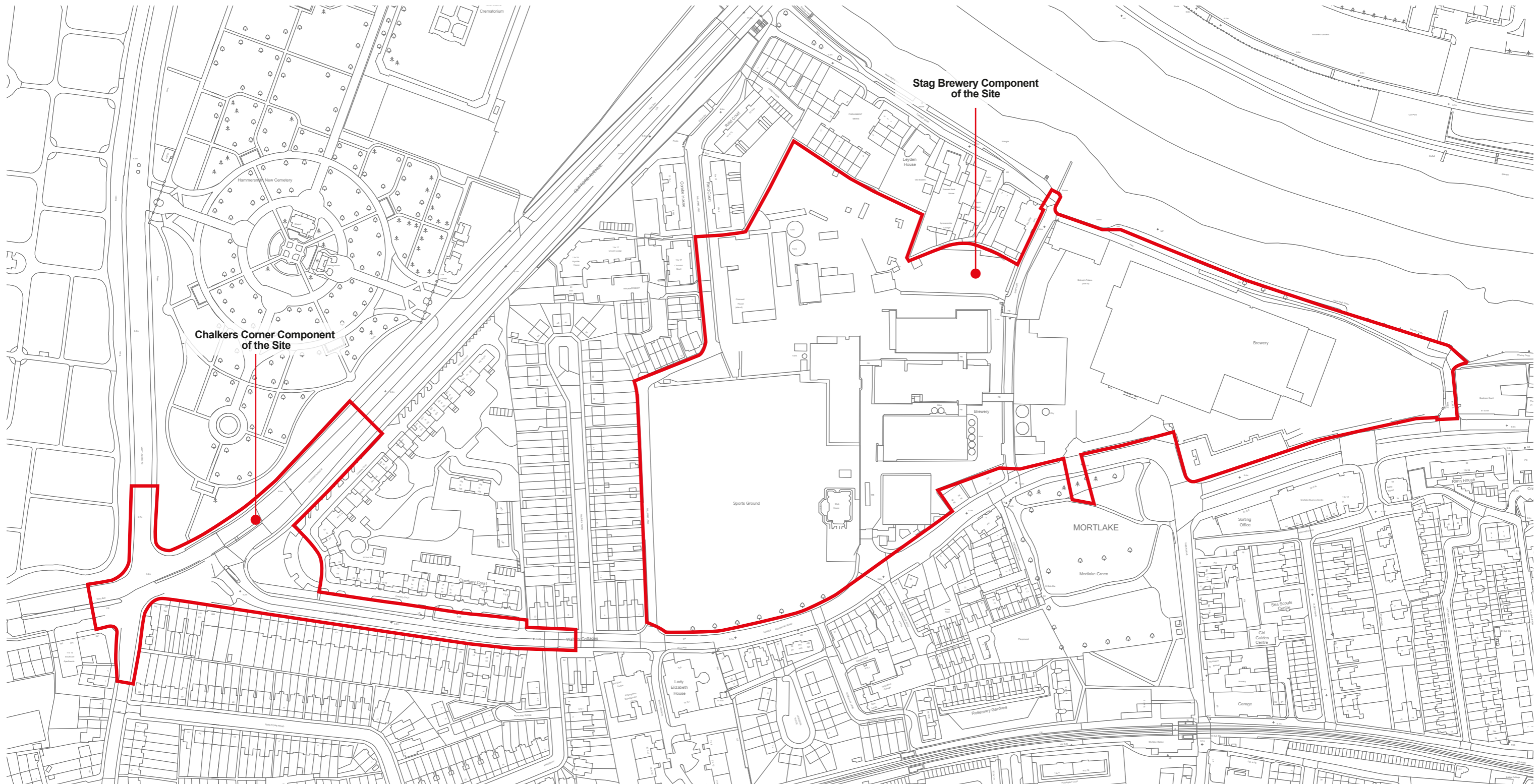

 The Site

<b>Project Details</b>	WIE10667-101: Stag Brewery, Mortlake
<b>Figure Title</b>	Figure 1.3: The Site
<b>Figure Ref</b>	WIE10667-101_GR_ES_1.3A
<b>Date</b>	2018
<b>File Location</b>	\\s-incs\wie\projects\wie10667\101\graphics\es\issued figures

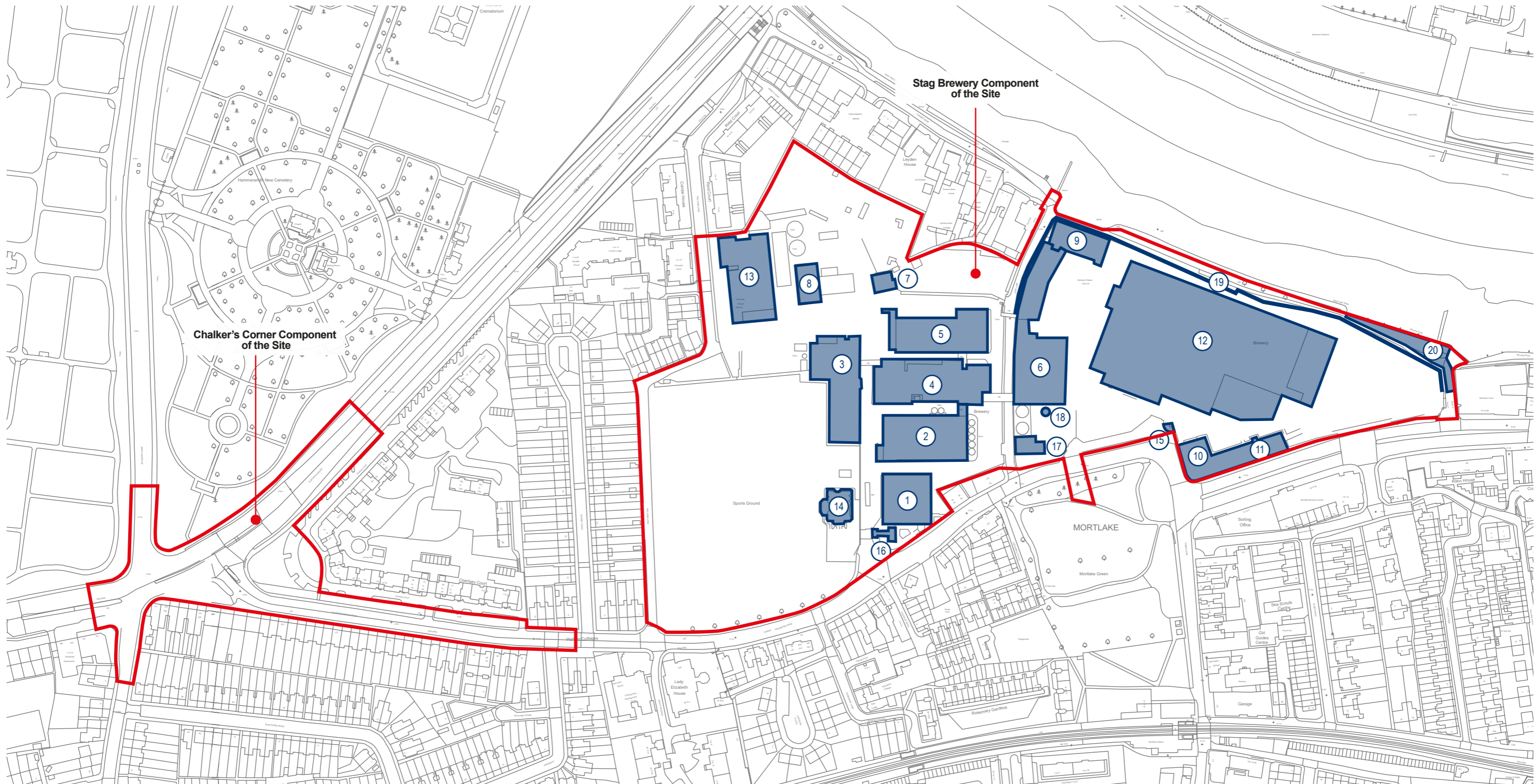

- |                    |                      |                         |                   |  |              |
|--------------------|----------------------|-------------------------|-------------------|--|--------------|
| The Site           | 1 P.O.B              | 5 Finishing Cellar      | 9 Maltings        | 13 Stable Court                                      | 17 CO2 Block |
| 2 Brewhouse        | 6 Power House        | 10 Former Hotel         | 14 Sports Club    | 18 Chimney Stack                                     |              |
| 3 Process Building | 7 Powder Store       | 11 Former Bottling Hall | 15 East Gatehouse | 19 River Wall  |              |
| 4 Chip Cellar      | 8 Effluent Treatment | 12 Packaging            | 16 West Gatehouse | 20 Railway Tracks, Granite Paving and River Moorings |              |

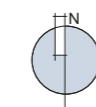

Project Details	WIE10667-101: Stag Brewery, Mortlake
Figure Title	Figure 3.1: Existing Buildings and Structures on the Site
Figure Ref	WIE10667-101_GR_ES_3.1A
Date	2018
File Location	\\s-incs\wie\projects\wie10667\101\graphics\es\issued figures

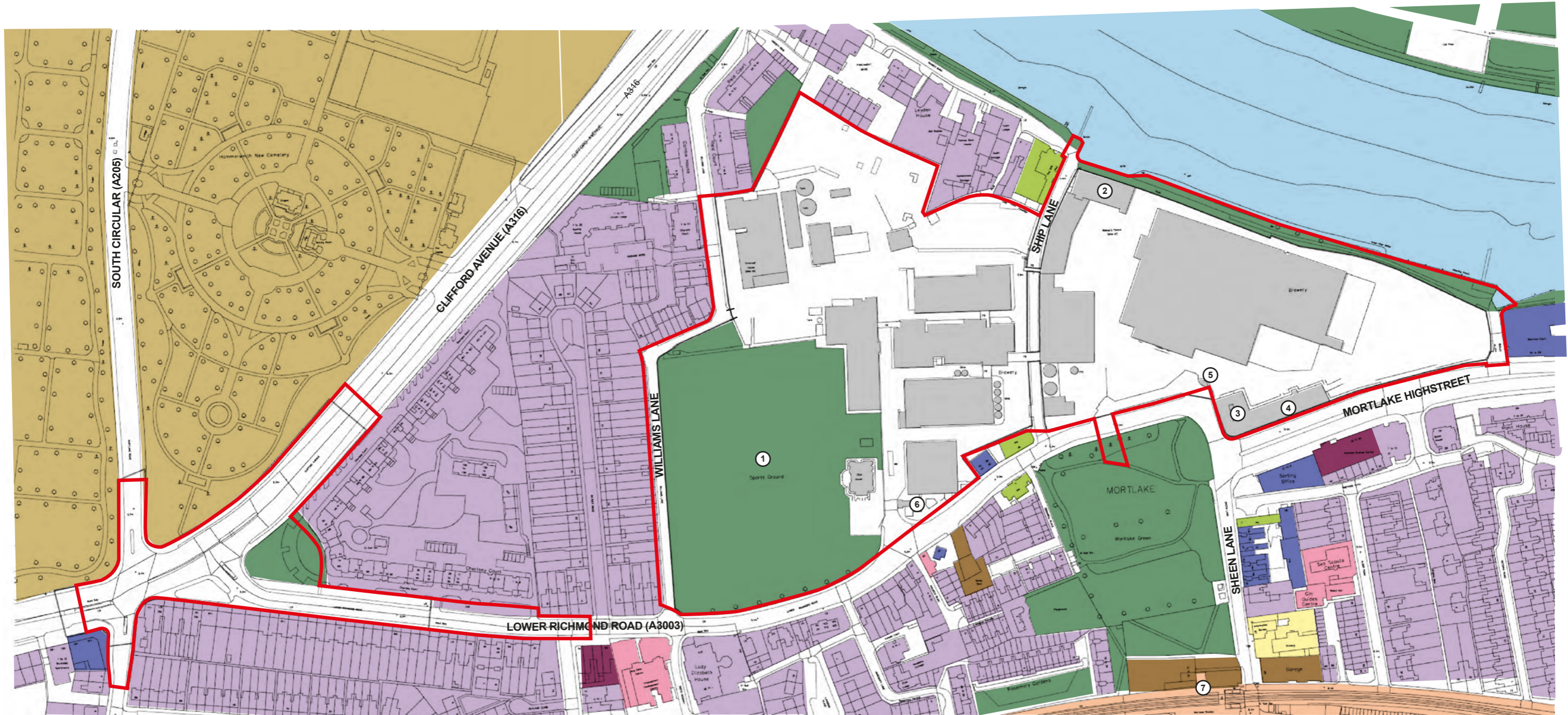

- |   |                               |                                  |                       |
|---|-------------------------------|----------------------------------|-----------------------|
| The Site                                    | Office                        | Brewery Buildings and Structures | Former Hotel          |
| Residential                                 | Education                     | River / Watercourse              | Former Bottling Hall  |
| Open Space / Amenity Space                  | Light Industrial              | Cemetery                         | East Entrance         |
| Railway Infrastructure (Including Stations) | Retail / Food and Drink       | Watney's Sports Ground           | West Entrance         |
| Community                                   | Retail with Residential above | Maltings                         | Mortlake Rail Station |

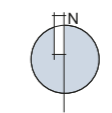

Project Details	WIE10667-101: Stag Brewery, Mortlake
Figure Title	Figure 3.2: Existing On and Off-Site Predominant Land Uses
Figure Ref	WIE10667-101_GR_ES_3.2A
Date	2018
File Location	\\s-inc\wiel\projects\wie10667\101\graphics\es\issued figures



Photo 1 The southern facade of the Maltings



Photo 2 Northern facade of the Maltings from the tow path



Photo 3 View of Former Hotel and Former Bottling Hall from Mortlake High Street



Photo 4 Former Hotel and Former Bottling Hall



Photo 5 View of the Site from the south westerly point, looking north east over Watney's Sports Ground towards Brewery Buildings



Photo 6 Brewery Buildings to the west of Ship Lane from south



Photo 7 Packaging building to the east of Ship Lane



Photo 8 The perimeter wall with the eastern facade of the Maltings at the end



Photo 9 View from Ship Lane looking north



Photo 10: View of Chalkers Corner looking West

Project Details	WIE10667-101: Stag Brewery, Mortlake
Figure Title	Figure 3.3: Selection of Photographs of the Existing Site
Figure Ref	WIE10667-101_GR_ES_3.3A
Date	2018
File Location	\\s-inc\wiel\projects\wie10667\101\graphics\es\issued figures



Photo 1 View east from Chiswick Bridge. Visible are the Maltings, the Ship Inn and residential properties along the Thames Bank



Photo 2 View from Thames tow path to Bulls Alley and Site perimeter wall to the right



Photo 3 The Site perimeter wall from the tow path



Photo 4 The River Thames tow path to the north of the Ship Inn



Photo 5 Housing development to the north west of the Site, fronting the River Thames



Photo 6 Residential properties along Williams Lane, bordering the Site to the West



Photo 7 The Jolly Gardeners Pub

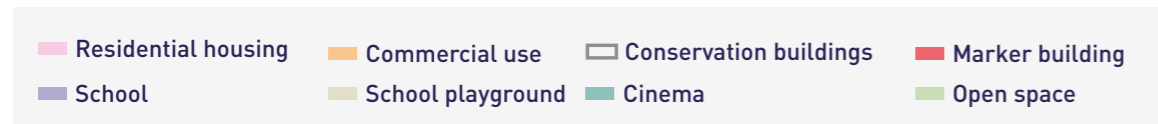

Photo 8 The Ship Inn



Photo 9 View north across Mortlake Green to the Site

Project Details	WIE10667-101: Stag Brewery, Mortlake
Figure Title	Figure 3.4: Selection of Photographs of the Existing Area Surrounding the Site
Figure Ref	WIE10667-101_GR_ES_3.4A
Date	2018
File Location	\\s-Incs\wiel\projects\wie10667\101\graphics\es\issued figures



Project Details	WIE10667-101: Stag Brewery, Mortlake
Figure Title	Figure 4.1: March 2017 Public Consultation Masterplan
Figure Ref	WIE10667-101_GR_ES_4.1A
Date	2018
File Location	\\s-inc\wiel\projects\wie10667\101\graphics\es\issued figures



- Residential
- School
- Care village
- Healthcare
- Commercial use
- Cinema
- Hotel building
- Community use
- Gym

Project Details	WIE10667-101: Stag Brewery, Mortlake
Figure Title	Figure 4.2: July 2017 Public Consultation Masterplan
Figure Ref	WIE10667-101_GR_ES_4.2A
Date	2018
File Location	\\s-incs\wie\projects\wie10667\101\graphics\es\issued figures

Source: Squire and Partners

© WATERMAN INFRASTRUCTURE & ENVIRONMENT

Reproduced from the Ordnance Survey maps with the permission of the Controller of Her Majesty's Stationery Office, © Crown copyright, Waterman Infrastructure & Environment, Pickfords Wharf, Clink Street, London SE1 9DG. Licence number LAN1000628.



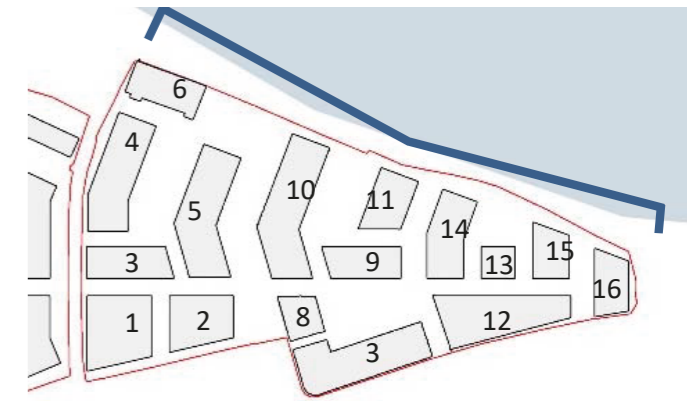

Project Details	WIE10667-101: Stag Brewery, Mortlake
Figure Title	Figure 4.3: Illustrative Riverfront Elevation Circa March 2017
Figure Ref	WIE10667-101_GR_ES_4.3A
Date	2018
File Location	\\s-Incs\wie\projects\wie10667\101\graphics\es\issued figures
	<a href="http://www.watermangroup.com">www.watermangroup.com</a>

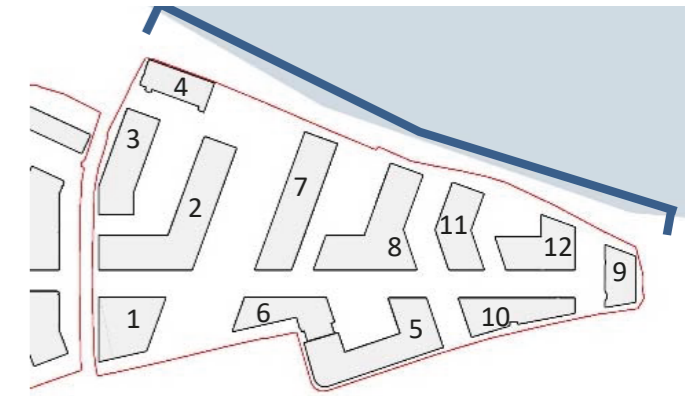

← BUILDING 9 →

← BUILDING 12 →

← BUILDING 11 →

← BUILDING 8 →

← BUILDING 7 →

← BUILDING 2 →

↔  
WIDENED  
GREEN  
LINK

Project Details	WIE10667-101: Stag Brewery, Mortlake
Figure Title	Figure 4.4: Illustrative Riverfront Elevation Circa July 2017
Figure Ref	WIE10667-101_GR_ES_4.4A
Date	2018
File Location	\\s-incs\wiel\projects\wie10667\101\graphics\es\issued figures

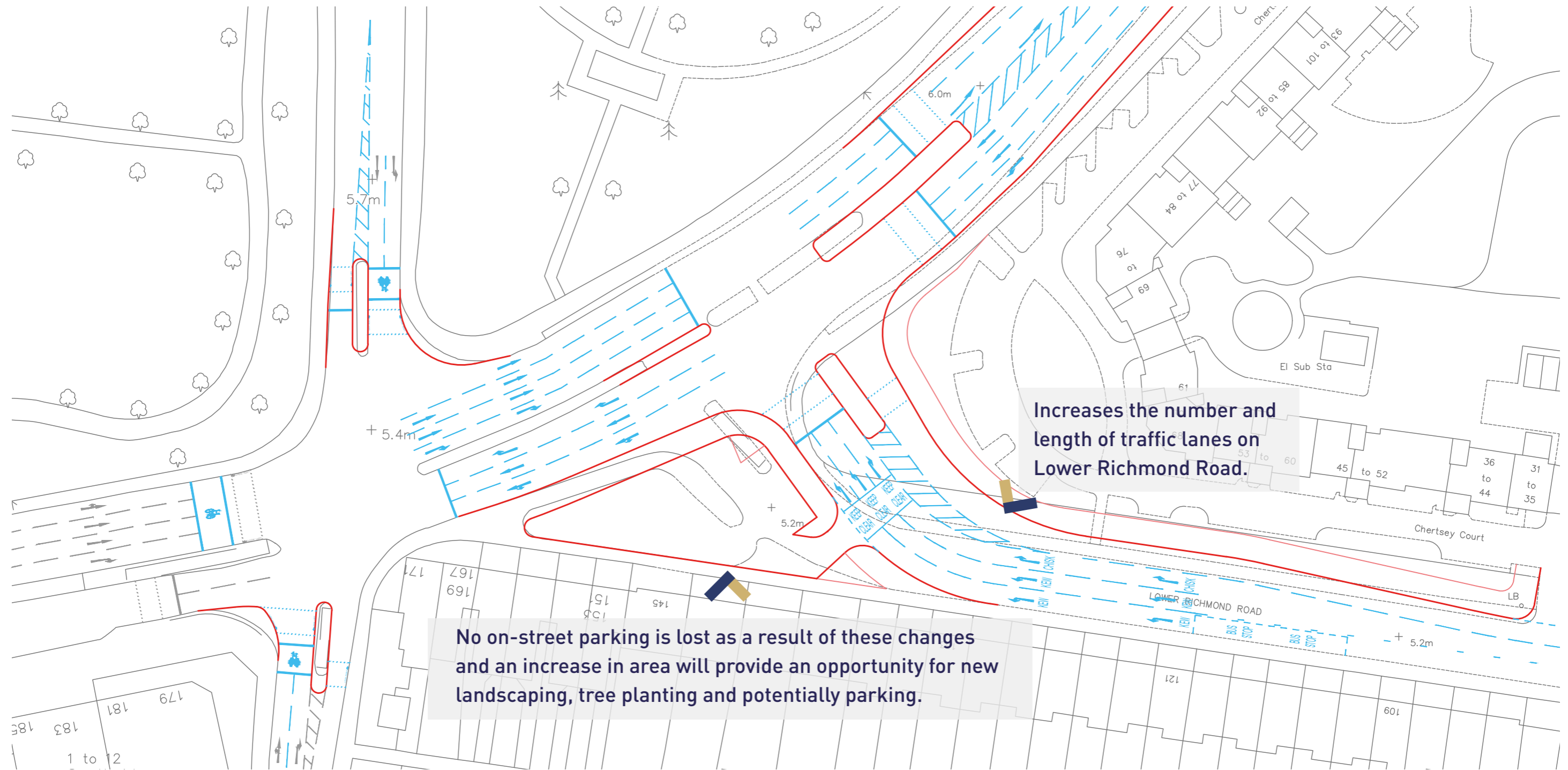

<b>Project Details</b>	WIE10667-101: Stag Brewery, Mortlake
<b>Figure Title</b>	Figure 4.5: March 2017 Chalker's Corner Option
<b>Figure Ref</b>	WIE10667-101_GR_ES_4.5A
<b>Date</b>	2018
<b>File Location</b>	\\s-incs\wie\projects\wie10667\101\graphics\es\issued figures