



General

- Specified Site
- Specified Buffer(s)
- X Bearing Reference Point

Urban Soil Chemistry Chromium

● BGS Urban Soil Chemistry Measured Concentration Values (mg/kg)

Chromium Concentrations mg/kg

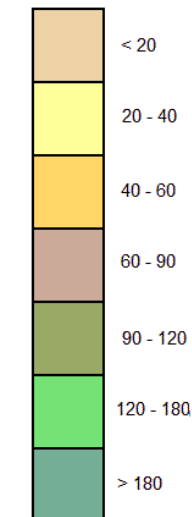

Urban Soil Chemistry Chromium - Slice A

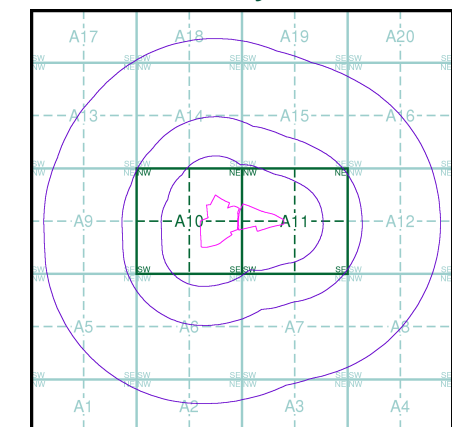

Order Details

Order Details: 89303208_1_1
 Customer Ref: WIE10667-100
 National Grid Reference: 520360, 175990
 Slice: A
 Site Area (Ha): 8.56
 Search Buffer (m): 1000

Site Details

Site at, Mortlake, Richmond upon Thames



Tel: 0844 844 9952
 Fax: 0844 844 9951
 Web: www.envirocheck.co.uk

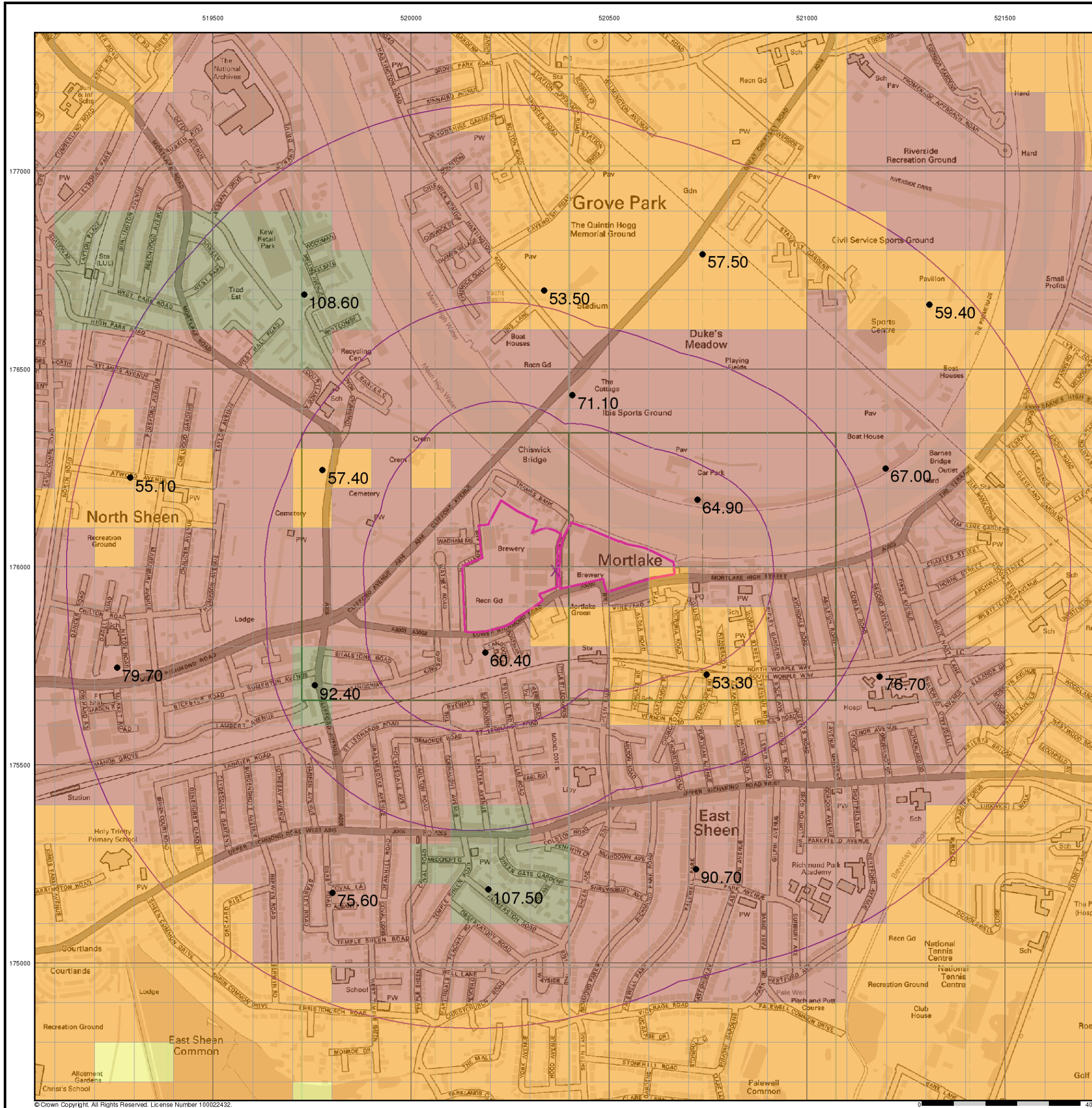



General

- ▲ Specified Site
- Specified Buffer(s)
- X Bearing Reference Point

Urban Soil Chemistry Lead

● BGS Urban Soil Chemistry Measured Concentration Values (mg/kg)

Lead Concentrations mg/kg

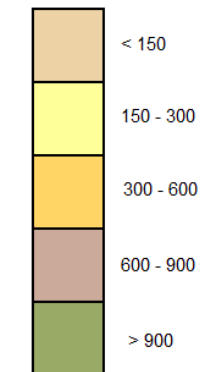

Urban Soil Chemistry Lead - Slice A

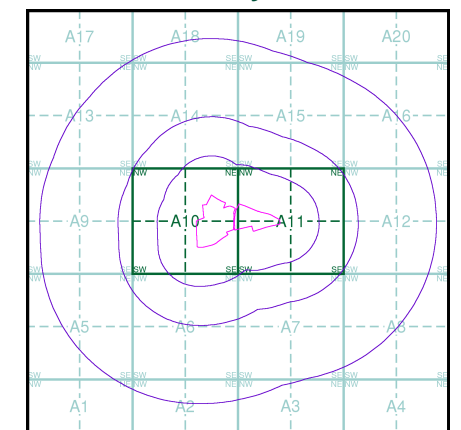

Order Details

Order Details: 89303208_1_1
 Customer Ref: WIE10667-100
 National Grid Reference: 520360, 175990
 Slice: A
 Site Area (Ha): 8.56
 Search Buffer (m): 1000

Site Details

Site at, Mortlake, Richmond upon Thames



Tel: 0844 844 9952
 Fax: 0844 844 9951
 Web: www.envirocheck.co.uk

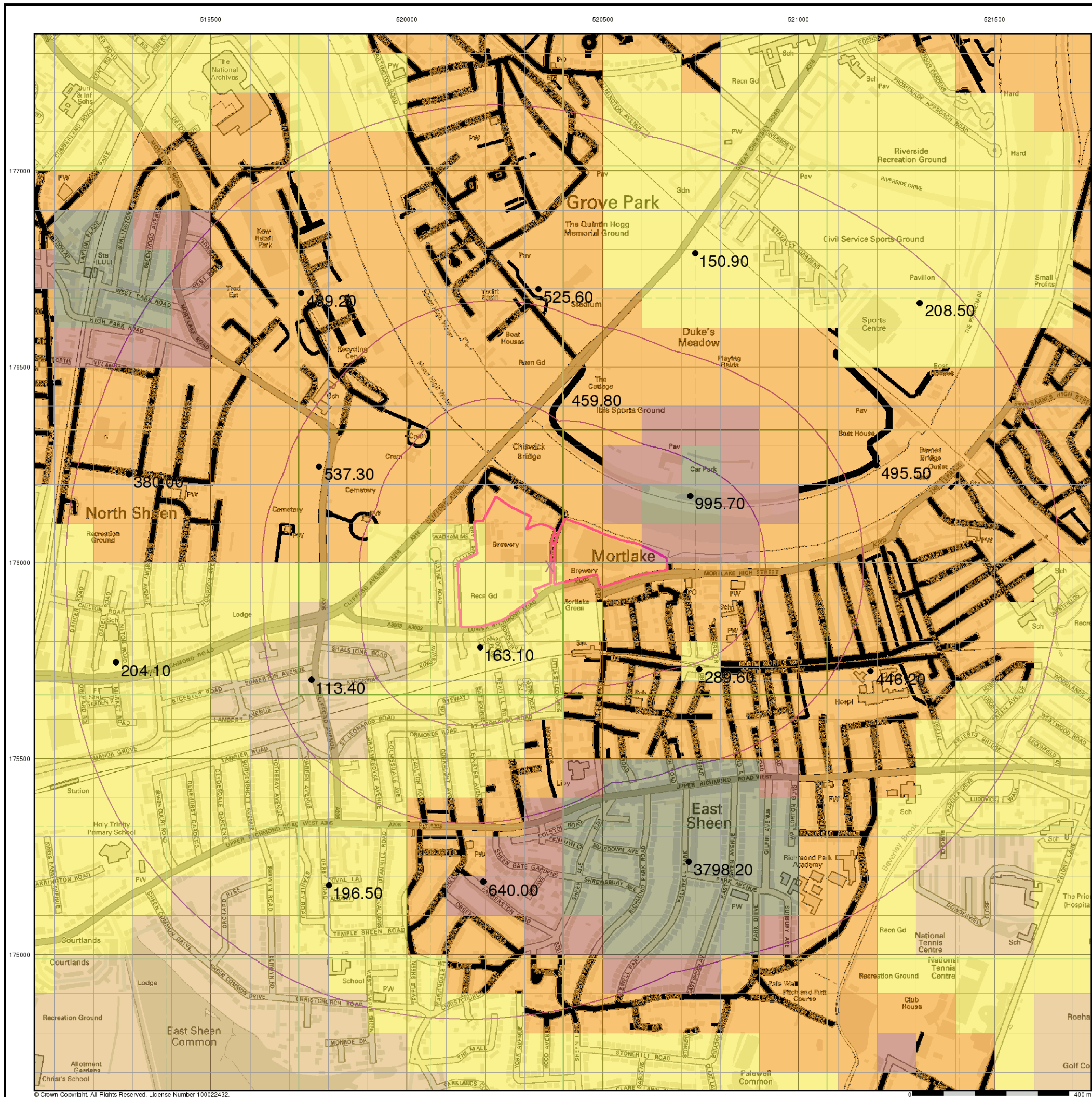



General

- Specified Site
- Specified Buffer(s)
- X Bearing Reference Point

Urban Soil Chemistry Nickel

● BGS Urban Soil Chemistry Measured Concentration Values (mg/kg)

Nickel Concentrations mg/kg

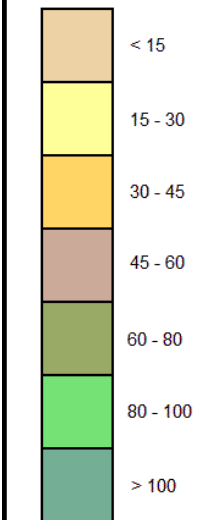

Urban Soil Chemistry Nickel - Slice A

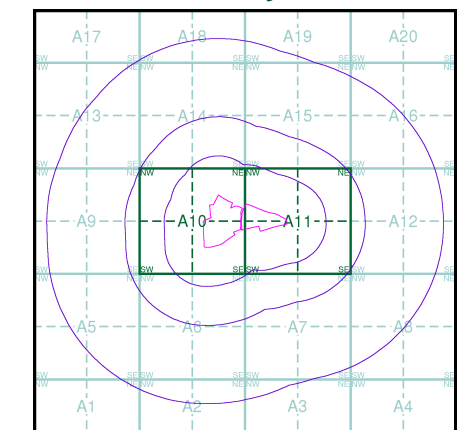

Order Details

Order Details: 89303208_1_1
 Customer Ref: WIE10667-100
 National Grid Reference: 520360, 175990
 Slice: A
 Site Area (Ha): 8.56
 Search Buffer (m): 1000

Site Details

Site at, Mortlake, Richmond upon Thames



Tel: 0844 844 9952
 Fax: 0844 844 9951
 Web: www.envirocheck.co.uk

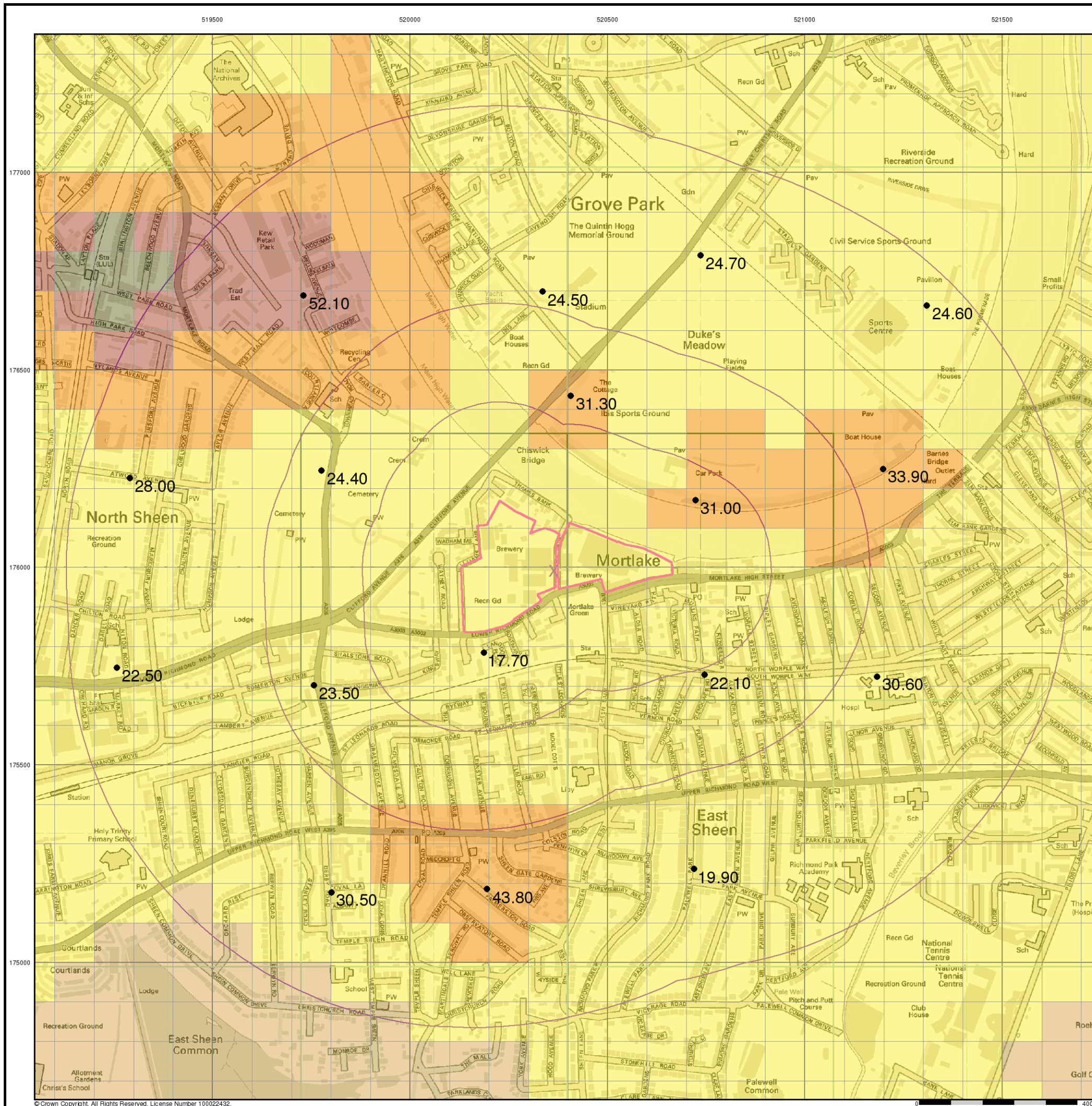

© Crown Copyright. All Rights Reserved. License Number 100022432.



- General**
- Specified Site
 - Specified Buffer(s)
 - Bearing Reference Point
 - Map ID
 - Several of Type at Location
 - Pylon
 - Overhead Transmission Line
- Agency and Hydrological**
- Contaminated Land Register Entry or Notice (Location)
 - Contaminated Land Register Entry or Notice
 - Discharge Consent
 - Enforcement or Prohibition Notice
 - Integrated Pollution Control
 - Integrated Pollution Prevention Control
 - Local Authority Integrated Pollution Prevention and Control
 - Local Authority Pollution Prevention and Control Enforcement
 - Pollution Incident to Controlled Waters
 - Prosecution Relating to Authorised Processes
 - Prosecution Relating to Controlled Waters
 - Registered Radioactive Substance
 - River Network or Water Feature
 - River Quality Sampling Point
 - Substantiated Pollution Incident Register
 - Water Abstraction
 - Water Industry Act Referral
- Waste**
- BGS Recorded Landfill Site (Location)
 - BGS Recorded Landfill Site
 - EA Historic Landfill (Buffered Point)
 - EA Historic Landfill (Polygon)
 - Integrated Pollution Control Registered Waste Site
 - Licensed Waste Management Facility (Landfill Boundary)
 - Licensed Waste Management Facility (Location)
 - Local Authority Recorded Landfill Site (Location)
 - Local Authority Recorded Landfill Site
 - Potentially Infilled Land (Non-water)
 - Potentially Infilled Land (Non-water)
 - Potentially Infilled Land (Water)
 - Potentially Infilled Land (Water)
 - Potentially Infilled Land (Water)
 - Registered Landfill Site
 - Registered Landfill Site (Location)
 - Registered Landfill Site (Point Buffered to 100m)
 - Registered Landfill Site (Point Buffered to 250m)
 - Registered Waste Transfer Site (Location)
 - Registered Waste Transfer Site
 - Registered Waste Treatment or Disposal Site (Location)
 - Registered Waste Treatment or Disposal Site
- Hazardous Substances**
- COMAH Site
 - Explosive Site
 - NIHHS Site
 - Planning Hazardous Substance Consent
 - Planning Hazardous Substance Enforcement
- Geological**
- BGS Recorded Mineral Site

Site Sensitivity Map - Segment A10

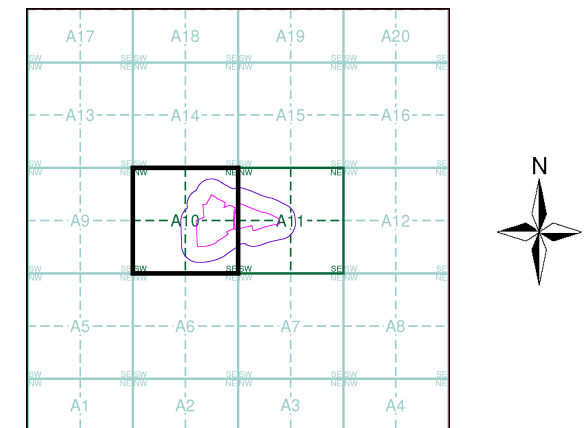

Order Details

Order Number: 89303208_1_1
 Customer Ref: WIE10667-100
 National Grid Reference: 520360, 175990
 Slice: A
 Site Area (Ha): 8.56
 Plot Buffer (m): 100

Site Details

Site at, Mortlake, Richmond upon Thames

Landmark
 Information Group

Tel: 0844 844 9952
 Fax: 0844 844 9951
 Web: www.envirocheck.co.uk

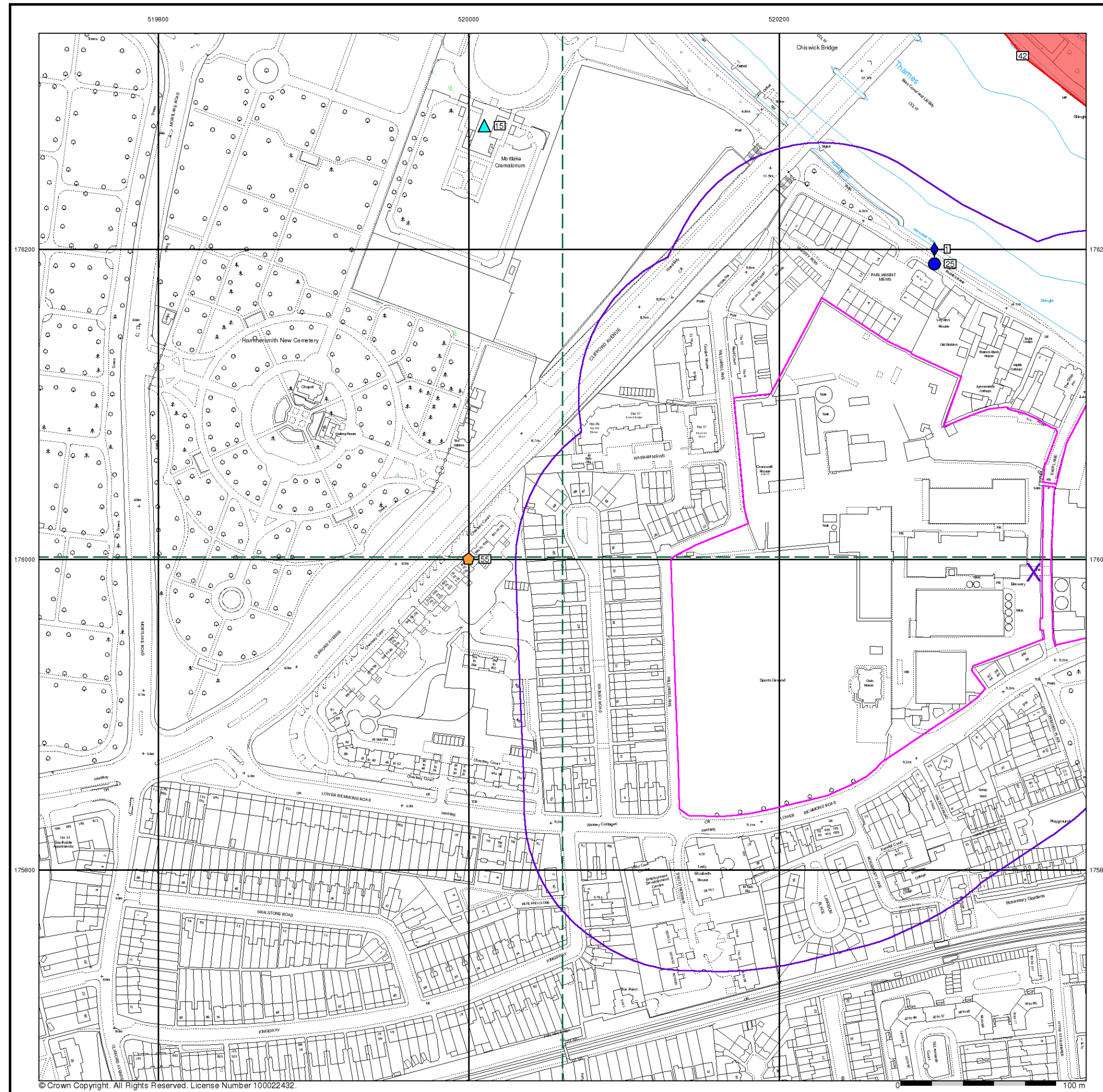



- General**
- Specified Site
 - Specified Buffer(s)
 - Bearing Reference Point
 - Map ID
 - Several of Types at Location
 - Pylon
 - Overhead Transmission Line
- Agency and Hydrological**
- Contaminated Land Register Entry or Notice (Location)
 - Contaminated Land Register Entry or Notice
 - Discharge Consent
 - Enforcement or Prohibition Notice
 - Integrated Pollution Control
 - Integrated Pollution Prevention and Control
 - Local Authority Integrated Pollution Prevention and Control
 - Local Authority Pollution Prevention and Control Enforcement
 - Pollution Incident to Controlled Waters
 - Prosecution Relating to Authorised Processes
 - Prosecution Relating to Controlled Waters
 - Registered Radioactive Substance
 - River Network or Water Feature
 - River Quality Sampling Point
 - Substantiated Pollution Incident Register
 - Water Abstraction
 - Water Industry Act Referral
- Waste**
- BGS Recorded Landfill Site (Location)
 - BGS Recorded Landfill Site
 - EA Historic Landfill (Buffered Point)
 - EA Historic Landfill (Polygon)
 - Integrated Pollution Control Registered Waste Site
 - Licensed Waste Management Facility (Landfill Boundary)
 - Licensed Waste Management Facility (Location)
 - Local Authority Recorded Landfill Site (Location)
 - Local Authority Recorded Landfill Site
 - Potentially Infilled Land (Non-water)
 - Potentially Infilled Land (Non-water)
 - Potentially Infilled Land (Non-water)
 - Potentially Infilled Land (Water)
 - Potentially Infilled Land (Water)
 - Potentially Infilled Land (Water)
 - Registered Landfill Site
 - Registered Landfill Site (Location)
 - Registered Landfill Site (Point Buffered to 100m)
 - Registered Landfill Site (Point Buffered to 250m)
 - Registered Waste Transfer Site (Location)
 - Registered Waste Transfer Site
 - Registered Waste Treatment or Disposal Site (Location)
 - Registered Waste Treatment or Disposal Site
- Hazardous Substances**
- COMAH Site
 - Explosive Site
 - NIHHS Site
 - Planning Hazardous Substance Consent
 - Planned Hazardous Substance Enforcement
- Geological**
- BGS Recorded Mineral Site

Site Sensitivity Map - Segment A11

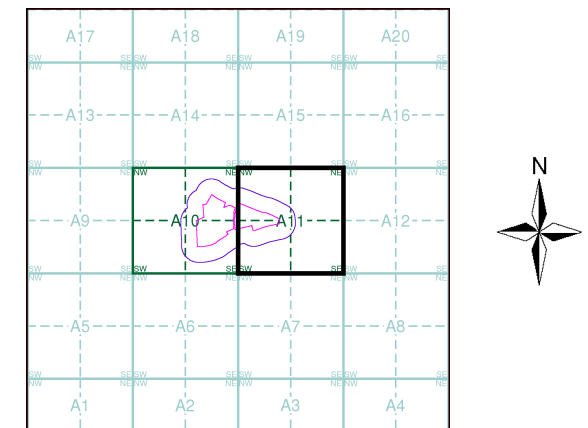

Order Details

Order Number: 89303208_1_1
 Customer Ref: WIE10667-100
 National Grid Reference: 520360, 175990
 Slice: A
 Site Area (Ha): 8.56
 Plot Buffer (m): 100

Site Details

Site at, Mortlake, Richmond upon Thames

Landmark
 Information Group

Tel: 0844 844 9952
 Fax: 0844 844 9951
 Web: www.envirocheck.co.uk

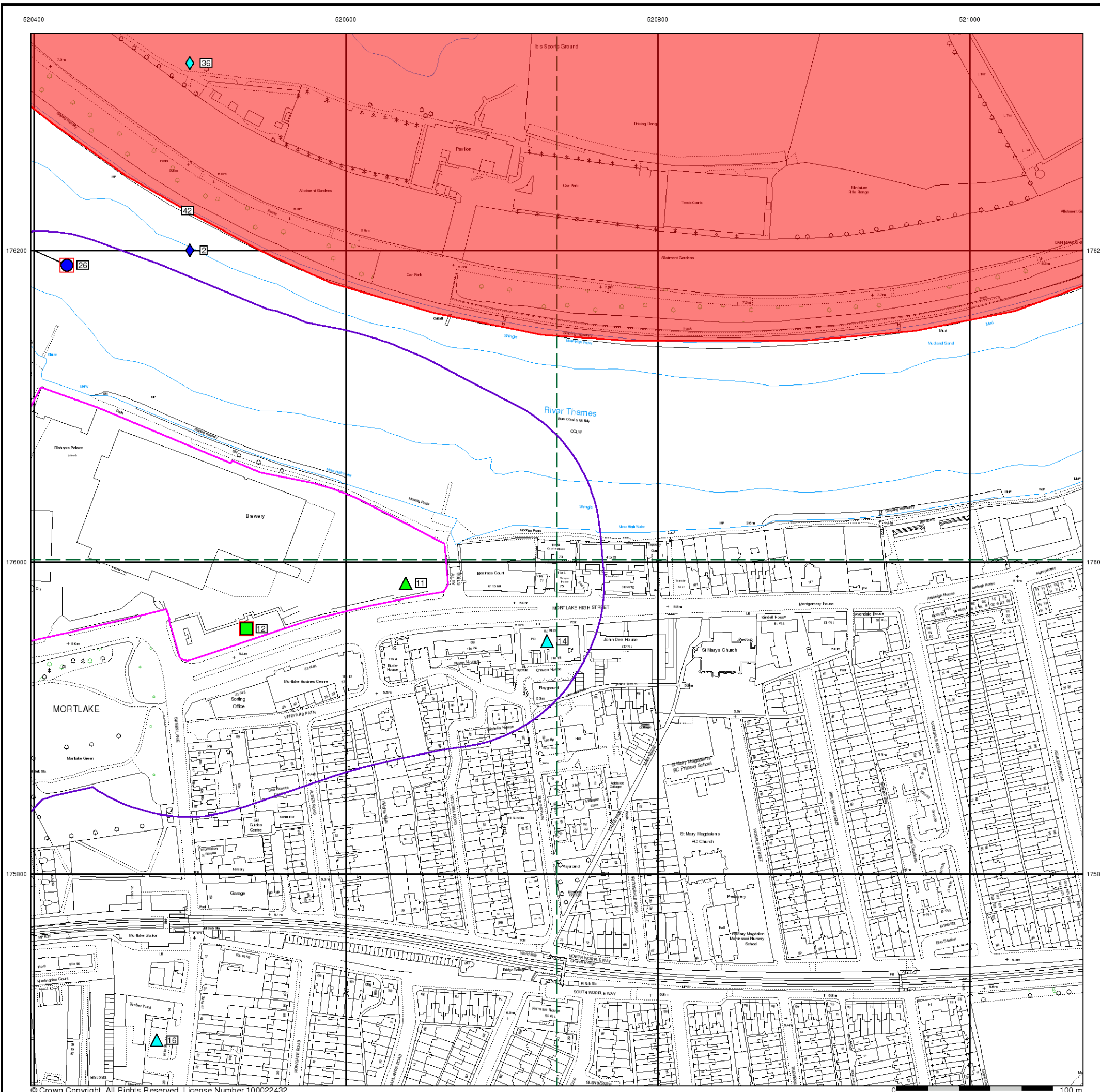



- General**
- Specified Site
 - Specified Buffer(s)
 - Bearing Reference Point
 - Map ID
 - Several of Type at Location
- Agency and Hydrological**
- Contaminated Land Register Entry or Notice (Location)
 - Contaminated Land Register Entry or Notice
 - Discharge Consent
 - Enforcement or Prohibition Notice
 - Integrated Pollution Control
 - Integrated Pollution Prevention Control
 - Local Authority Integrated Pollution Prevention and Control
 - Local Authority Pollution Prevention and Control Enforcement
 - Pollution Incident to Controlled Waters
 - Prosecution Relating to Authorised Processes
 - Prosecution Relating to Controlled Waters
 - Registered Radioactive Substance
 - River Network or Water Feature
 - River Quality Sampling Point
 - Substantiated Pollution Incident Register
 - Water Abstraction
 - Water Industry Act Referral
- Waste**
- BGS Recorded Landfill Site (Location)
 - BGS Recorded Landfill Site
 - EA Historic Landfill (Buffered Point)
 - EA Historic Landfill (Polygon)
 - Integrated Pollution Control Registered Waste Site
 - Licensed Waste Management Facility (Landfill Boundary)
 - Licensed Waste Management Facility (Location)
 - Local Authority Recorded Landfill Site (Location)
 - Local Authority Recorded Landfill Site
 - Potentially Infilled Land (Non-water)
 - Potentially Infilled Land (Non-water)
 - Potentially Infilled Land (Non-water)
 - Potentially Infilled Land (Water)
 - Potentially Infilled Land (Water)
 - Potentially Infilled Land (Water)
 - Registered Landfill Site
 - Registered Landfill Site (Location)
 - Registered Landfill Site (Point Buffered to 100m)
 - Registered Landfill Site (Point Buffered to 250m)
 - Registered Waste Transfer Site (Location)
 - Registered Waste Transfer Site
 - Registered Waste Treatment or Disposal Site (Location)
 - Registered Waste Treatment or Disposal Site
- Hazardous Substances**
- COMAH Site
 - Explosive Site
 - NIHHS Site
 - Planning Hazardous Substance Consent
 - Planning Hazardous Substance Enforcement
 - BGS Recorded Mineral Site
- Geological**
- BGS Recorded Mineral Site

Site Sensitivity Map - Slice A

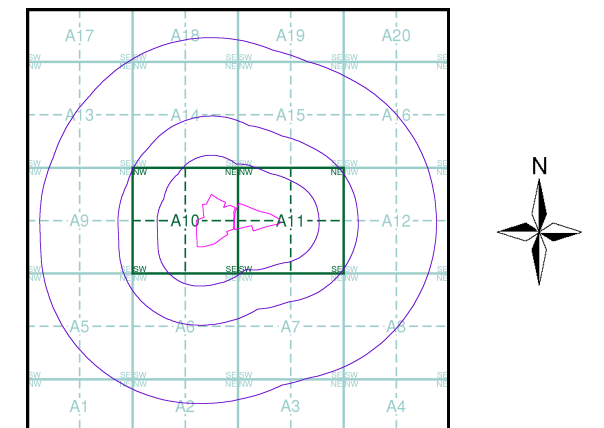

Order Details

Order Number: 89303208_1_1
 Customer Ref: WIE10667-100
 National Grid Reference: 520360, 175990
 Slice: A
 Site Area (Ha): 8.56
 Search Buffer (m): 1000

Site Details

Site at, Mortlake, Richmond upon Thames

Landmark
 Information Group

Tel: 0844 844 9952
 Fax: 0844 844 9951
 Web: www.envirocheck.co.uk

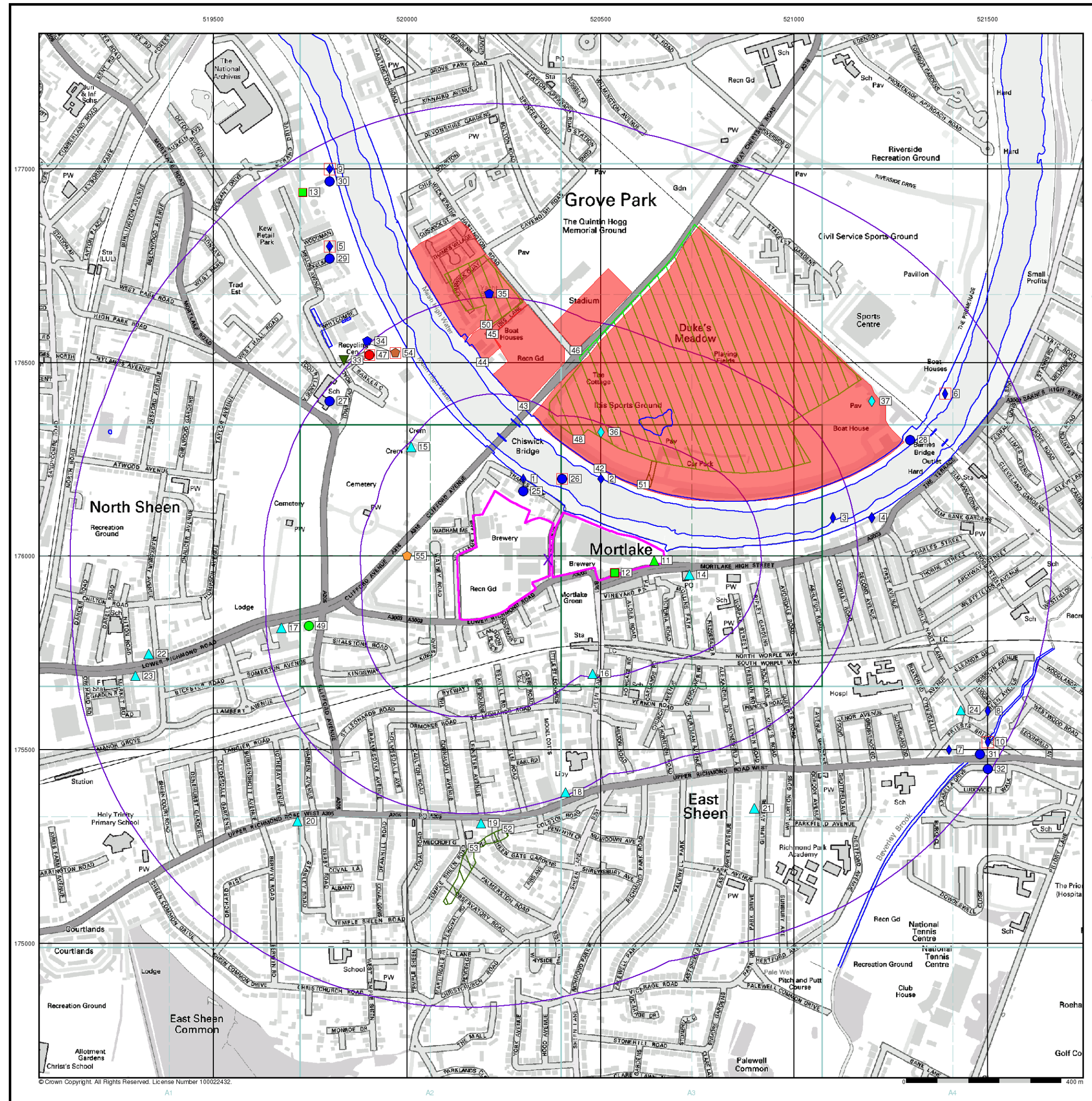

© Crown Copyright. All Rights Reserved. License Number 100022432.



- General**
- Specified Site
 - Specified Buffer(s)
 - Bearing Reference Point
 - Slice
 - Map ID
- Industrial Land Use**
- Contemporary Trade Directory Entry
 - Fuel Station Entry
 - Gas Pipeline
 - Points of Interest - Commercial Services
 - Points of Interest - Education and Health
 - Points of Interest - Manufacturing and Production
 - Points of Interest - Public Infrastructure
 - Points of Interest - Recreational and Environmental
 - Underground Electrical Cables

Industrial Land Use Map - Slice A

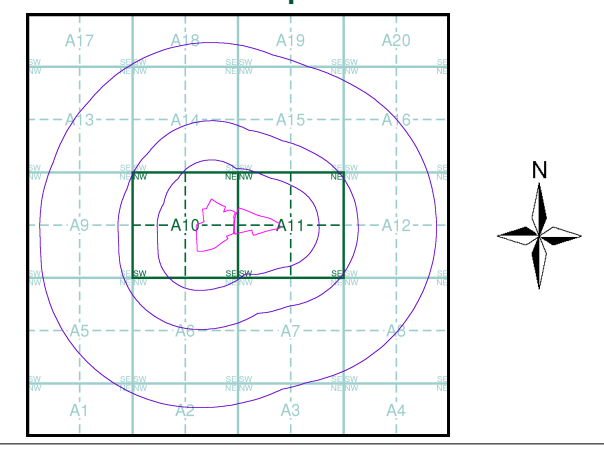

Order Details

Order Number: 89303208_1_1
 Customer Ref: WIE10667-100
 National Grid Reference: 520360, 175990
 Slice: A
 Site Area (Ha): 8.56
 Search Buffer (m): 1000

Site Details

Site at, Mortlake, Richmond upon Thames

Landmark Information Group

Tel: 0844 844 9952
 Fax: 0844 844 9951
 Web: www.envirocheck.co.uk



General

- Specified Site
- Specified Buffer(s)
- Bearing Reference Point

Agency and Hydrological (Flood)

- Extreme Flooding from Rivers or Sea without Defences (Zone 2)
- Flooding from Rivers or Sea without Defences (Zone 3)
- Area Benefiting from Flood Defence
- Flood Water Storage Areas
- Flood Defence

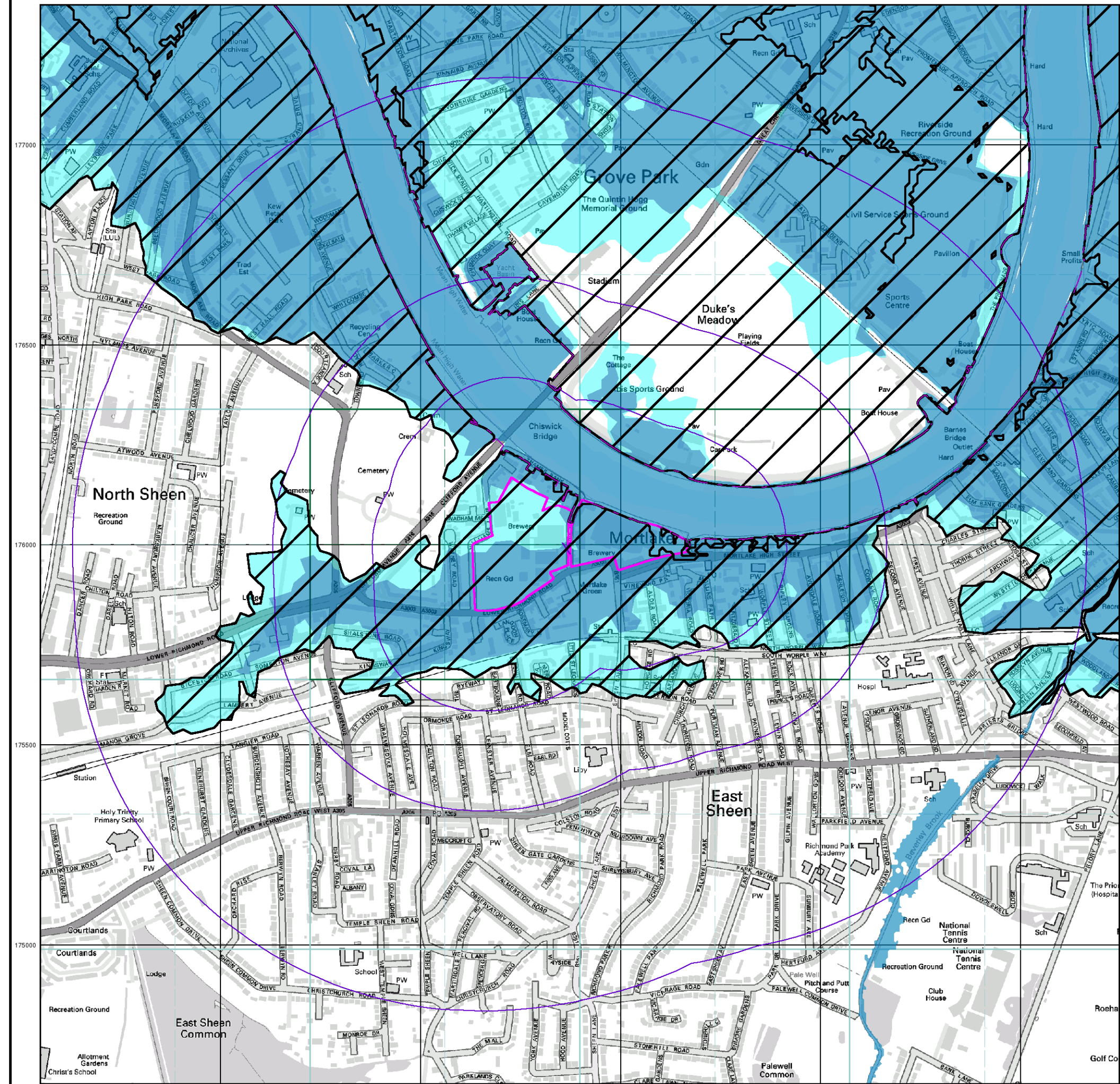

Flood Map - Slice A

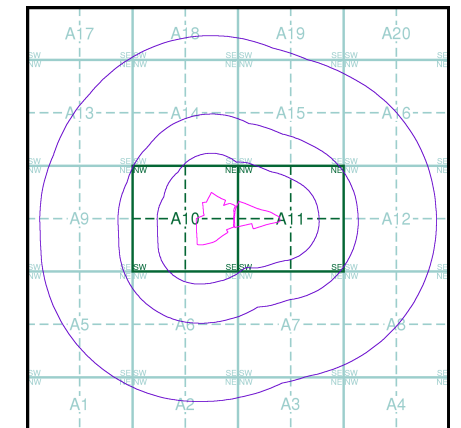

Order Details

Order Number: 89303208_1_1
 Customer Ref: WIE10667-100
 National Grid Reference: 520360, 175990
 Slice: A
 Site Area (Ha): 8.56
 Search Buffer (m): 1000

Site Details

Site at, Mortlake, Richmond upon Thames



Tel: 0844 844 9952
 Fax: 0844 844 9951
 Web: www.envirocheck.co.uk



General

- Specified Site
- Specified Buffer(s)
- Bearing Reference Point
- Map ID
- Several of Type at Location

Agency and Hydrological (Boreholes)

- BGS Borehole Depth 0 - 10m
- BGS Borehole Depth 10 - 30m
- BGS Borehole Depth 30m +
- Confidential
- Other

For Borehole information please refer to the Borehole .csv file which accompanied this slice.

A copy of the BGS Borehole Ordering Form is available to download from the Support section of www.envirocheck.co.uk.

Borehole Map - Slice A

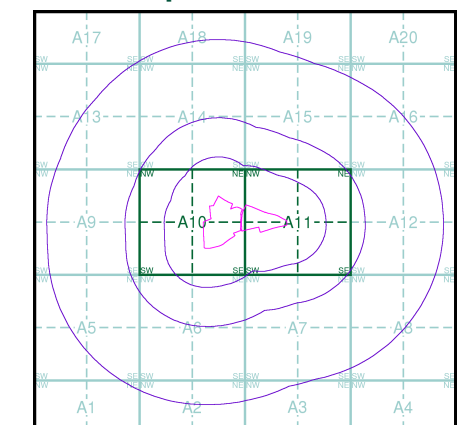

Order Details

Order Number: 89303208_1_1
 Customer Ref: WIE10667-100
 National Grid Reference: 520360, 175990
 Slice: A
 Site Area (Ha): 8.56
 Search Buffer (m): 1000

Site Details

Site at, Mortlake, Richmond upon Thames



Tel: 0844 844 9952
 Fax: 0844 844 9951
 Web: www.envirocheck.co.uk

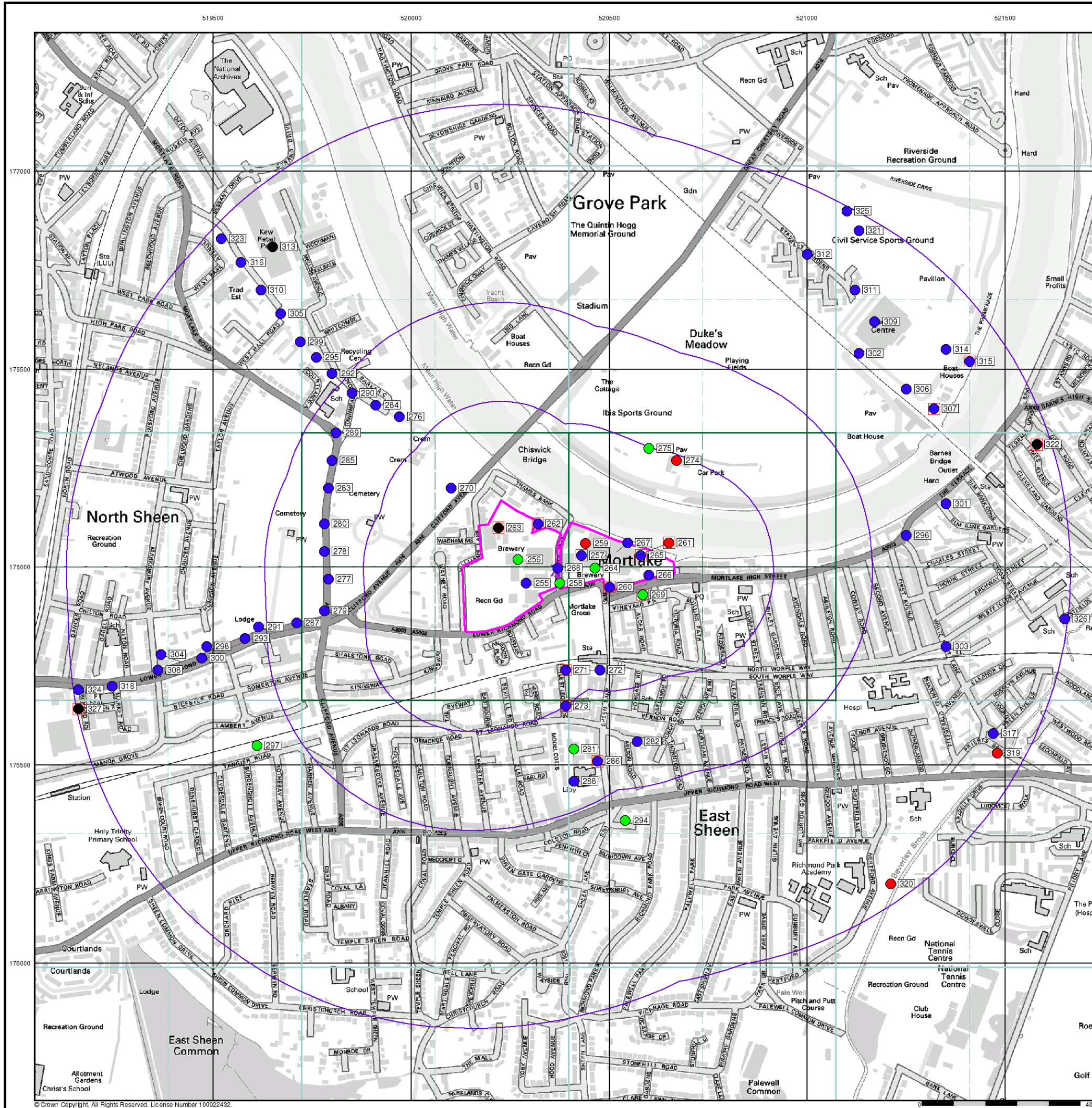

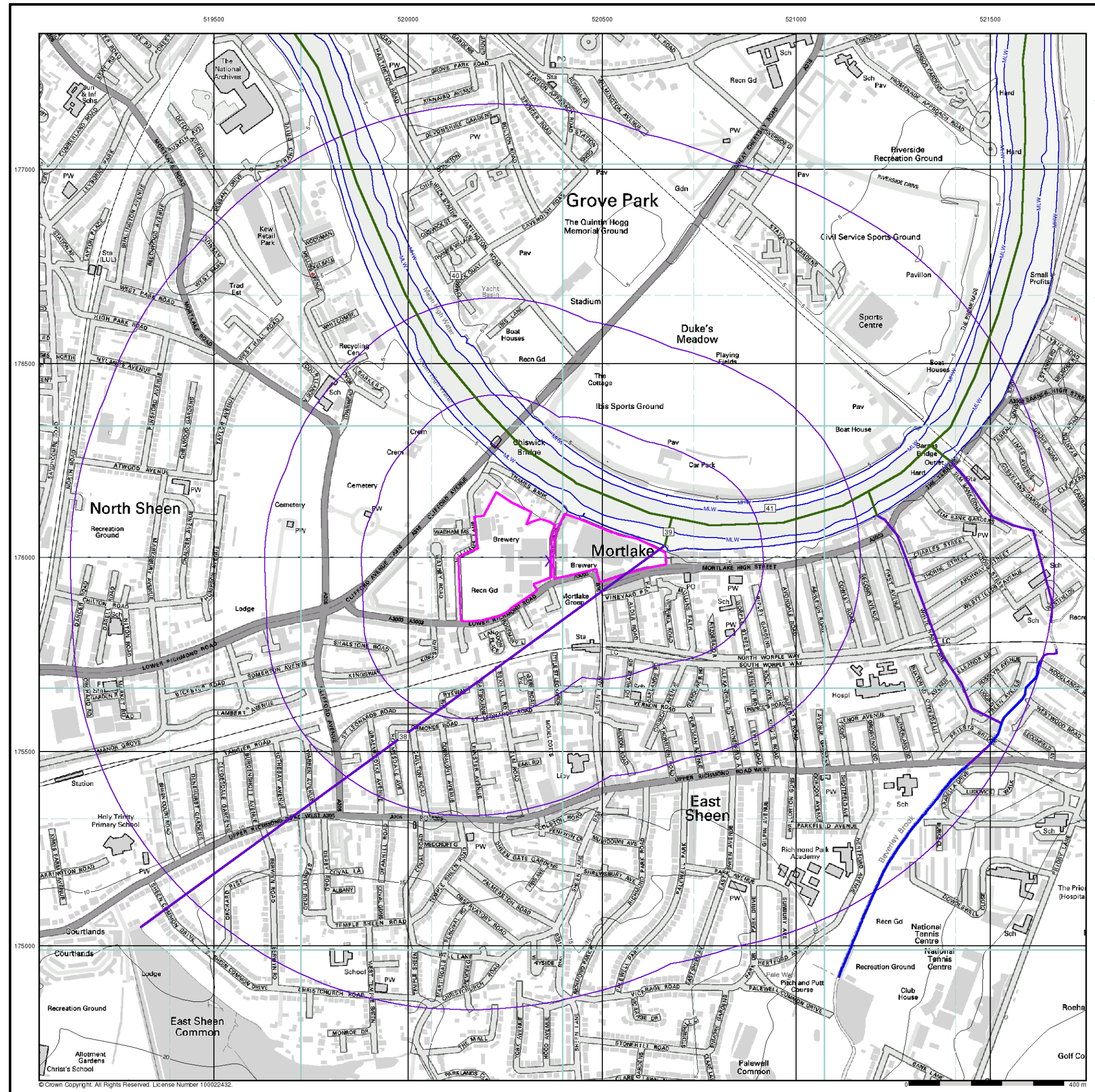

General

- Specified Site
- Specified Buffer(s)
- Bearing Reference Point
- Map ID

Detailed River Network Data

- Primary River
- Secondary River
- Tertiary River
- Canal
- Canal Tunnel
- Undefined River
- Lake/Reservoir
- Offline Drainage Feature
- Extended Culvert (greater than 50m)
- Underground River (inferred)
- Underground River (local knowledge)
- Downstream of High Water Mark
- Downstream of Seaward Extension
- Not assigned River feature

Contours (height in metres)

- Standard Contour 105
- Master Contour 100
- Spot Height *167.3
- MLW Mean Low Water
- MHW Mean High Water

EANRW Detailed River Network Map - Slice A

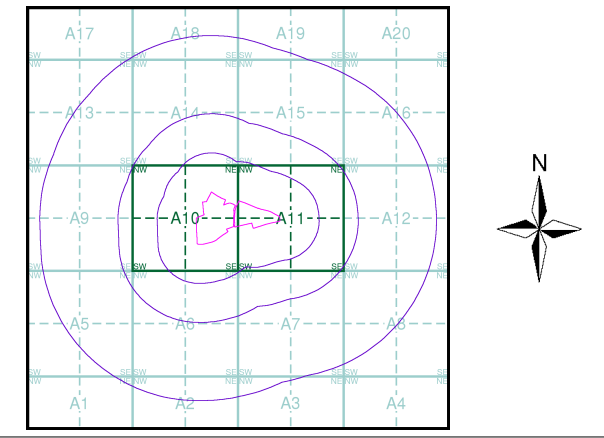

Order Details

Order Number: 89303208_1_1
 Customer Ref: WIE10667-100
 National Grid Reference: 520360, 175990
 Slice: A
 Site Area (Ha): 8.56
 Search Buffer (m): 1000

Site Details

Site at, Mortlake, Richmond upon Thames



Tel: 0844 844 9952
 Fax: 0844 844 9951
 Web: www.envirocheck.co.uk



General

- Specified Site
- Specified Buffer(s)
- Bearing Reference Point

Risk of Flooding from Surface Water

- High - 30 Year Return
- Medium - 100 Year Return
- Low - 1000 Year Return

Suitability

See the suitability map below

- National to county
- County to town
- Town to street
- Street to parcels of land
- Property

EANRW Suitability Map - Slice A

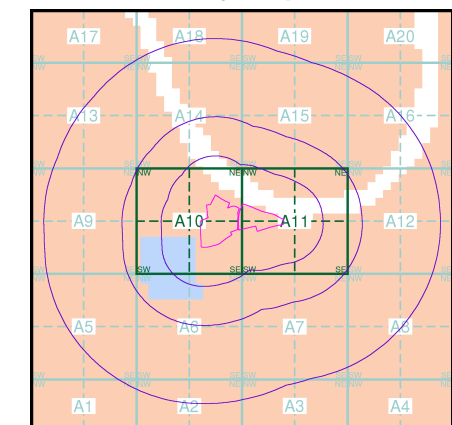

Order Details

Order Number: 89303208_1_1
 Customer Ref: WIE10667-100
 National Grid Reference: 520360, 175990
 Slice: A
 Site Area (Ha): 8.56
 Search Buffer (m): 1000

Site Details

Site at, Mortlake, Richmond upon Thames



Tel: 0844 844 9952
 Fax: 0844 844 9951
 Web: www.envirocheck.co.uk

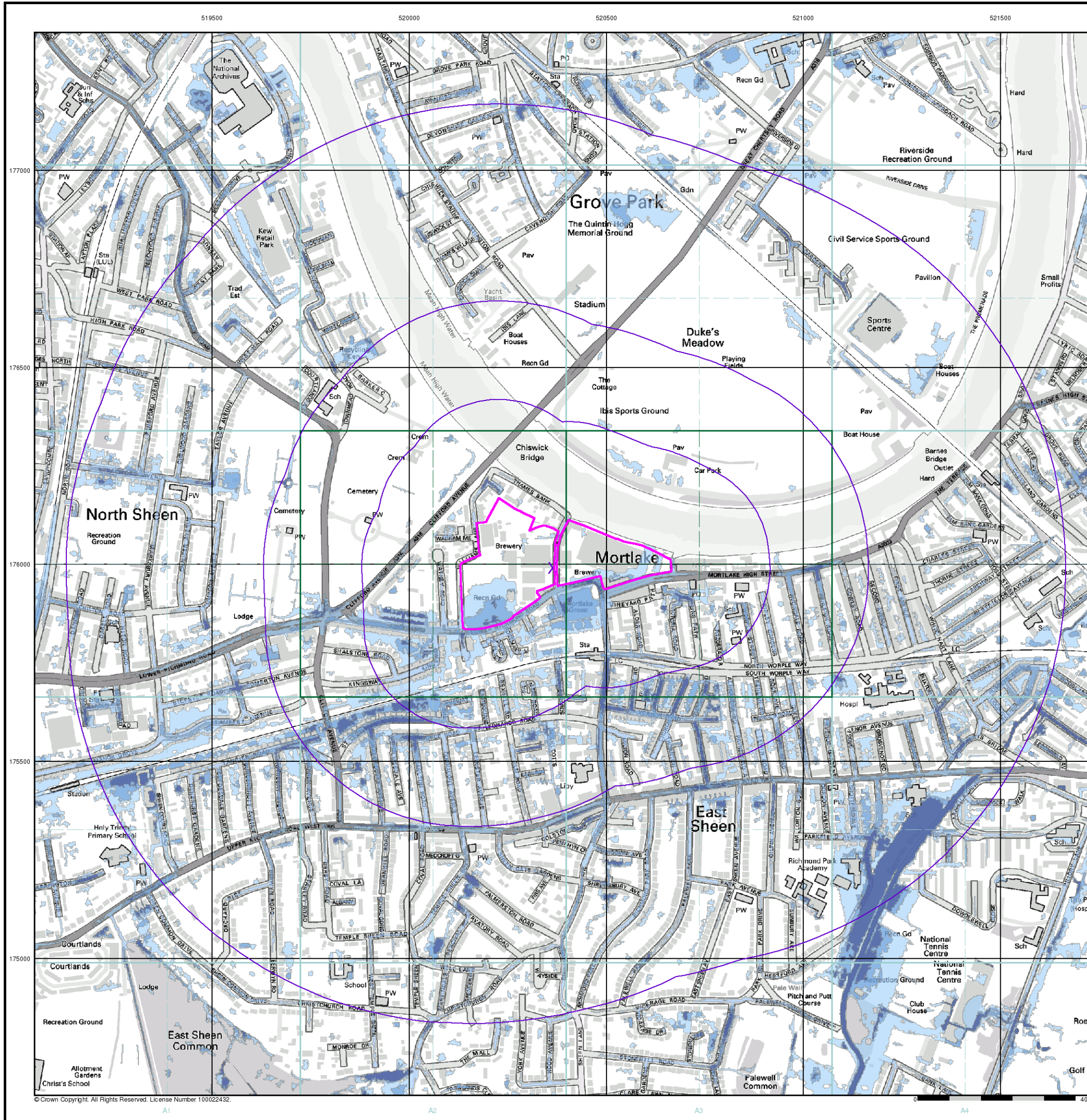

© Crown Copyright. All Rights Reserved. License Number 100022432.