

### CBA TREES

Russell House  
Unit 20 Chalcroft Business Park  
Burnetts Lane, West End,  
Southampton, SO30 2PA  
02380 986229

**10677**  
**Marble Hill House and Park**  
**Tree Survey Plan - South West Quadrant**

**SCALE :** 1 : 250 @ A3  
**DATE :** 12/05/2017



**MAP FILENAME :** CBA10677.01\_TSP SW Quadrant  
**BASE PLAN:** MHH16T01-17

Pear Technology Services Ltd, Email info@peartechology.co.uk  
Maps based on Ordnance Survey MasterMap or 1:25000 Mid-scale data with  
the permission of the Controller of HMSO. © Crown Copyright.

1. Shading Arcs not shown on this plan
2. Root Protection Areas are shown as a theoretical circle and at this stage do not take into account site features and constraints.
3. Trees marked with \* and group and hedge outlines are indicatively plotted.

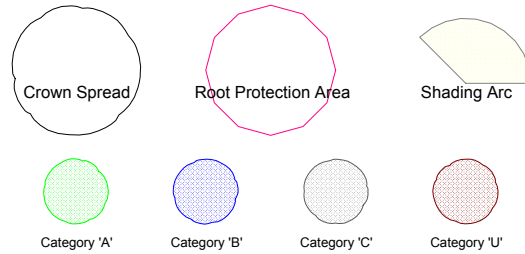





Grp 3 B

Grp 11

TREE PRESERVATION ORDER / CONSERVATION AREA STATUS: Richmond Council has confirmed that the site lies within the CA8 Twickenham Riverside Conservation Area but there are no Tree Preservation Orders protecting trees on the site.

Shading Arcs not shown on this plan. Root Protection Areas are shown as a theoretical circle and at this stage do not take into account site features and constraints. Trees marked with \* and group outlines are indicatively plotted.

See separate plans for detail of Woodland Quarters : CBA\0677.01\_TSP NE Quadrant, CBA\0677.01\_TSP SE Quadrant, CBA\0677.01\_TSP NW Quadrant, CBA\0677.01\_TSP SW Quadrant.

The following trees have been classified as 'U' grade and should therefore be removed for reasons of sound arboricultural management: T21, G1.55, G1.59, G3.19, G3.21, G3.25, G3.28\*, G3.30\*, G4.17, G5.7, G7.8, G7.9, G7.36, G7.38, G7.138, G7.143, G7.149, G8.31, G8.53, G8.66, G9.7, G9.10, G9.14, G9.17, G10.88, G12.1

KEY

- TREES TO BE RETAINED AND PROTECTED IMMEDIATELY AROUND THE STABLE BLOCK
- TREES TO BE REMOVED
- TREES TO BE REMOVED FOR SOUND ARBORICULTURAL MANAGEMENT OR MADE SAFE AND RETAINED FOR HABITAT (G3.29 AND G3.30)
- FIT FOR PURPOSE TREE PROTECTION BARRIER
- FIT FOR PURPOSE GROUND PROTECTION FOR DURATION OF STABLE BLOCK WORKS
- FIT FOR PURPOSE GROUND PROTECTION UNTIL SUCH TIME AS PROPOSED FOOTPATH IS HAND DUG
- AREA OF EXISTING PATIO SLAB TO BE TEMPORARILY RETAINED FOR GROUND PROTECTION
- EXISTING SHED TO BE RETAINED

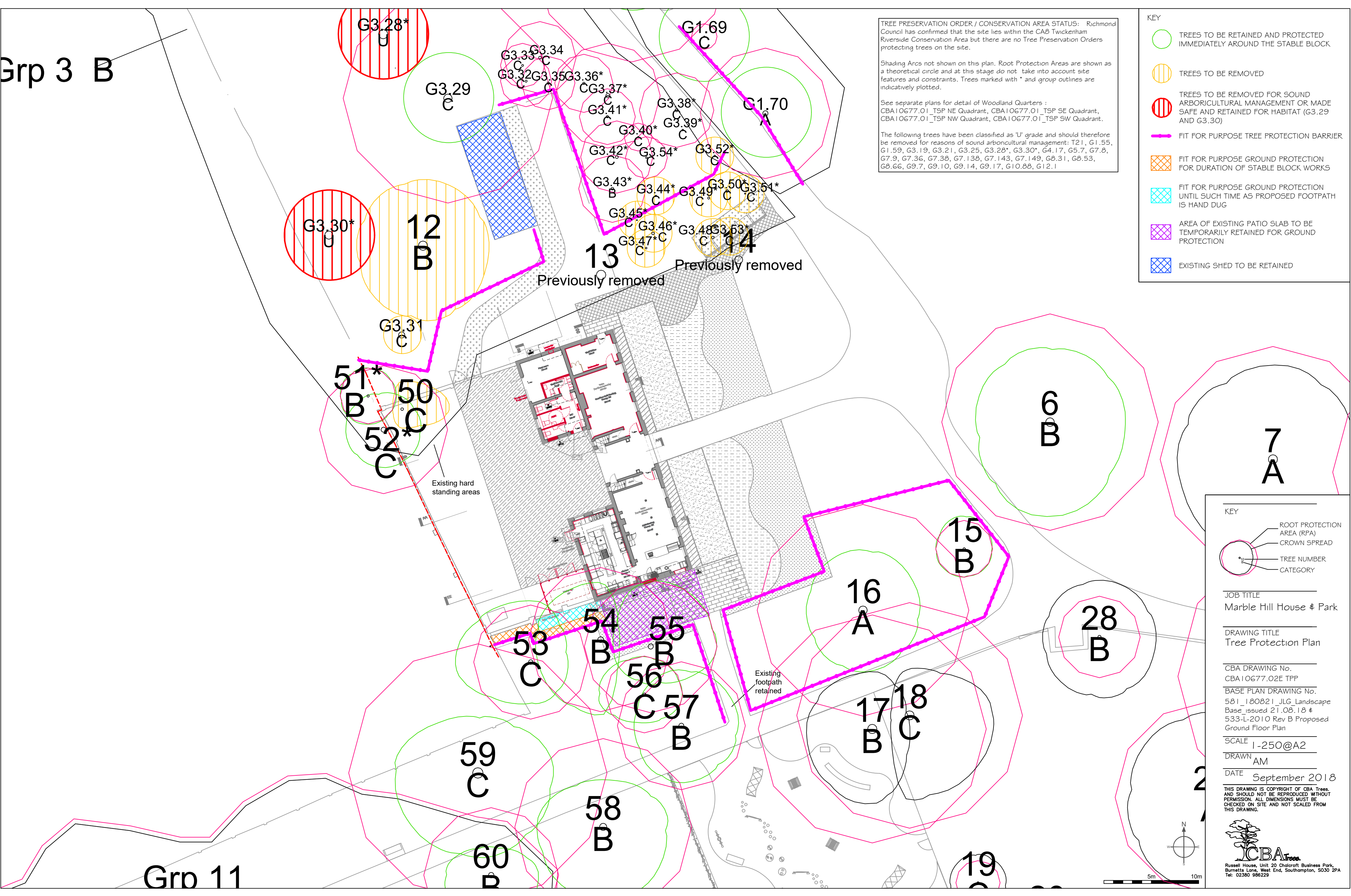

KEY

- ROOT PROTECTION AREA (RPA)
- CROWN SPREAD
- TREE NUMBER
- CATEGORY

JOB TITLE  
Marble Hill House & Park

DRAWING TITLE  
Tree Protection Plan

CBA DRAWING No.  
CBA\0677.02E TPP

BASE PLAN DRAWING No.  
581\_180821\_JLG Landscape Base issued 21.08.18 & 533-L-2010 Rev B Proposed Ground Floor Plan

SCALE 1-250@A2

DRAWN AM

DATE September 2018

THIS DRAWING IS COPYRIGHT OF CBA Trees AND SHOULD NOT BE REPRODUCED WITHOUT PERMISSION. ALL DIMENSIONS MUST BE CHECKED ON SITE AND NOT SCALED FROM THIS DRAWING.

Russell House, Unit 20 Chalcraft Business Park, Burnetts Lane, West End, Southampton, SO30 2PA  
Tel: 02380 986229

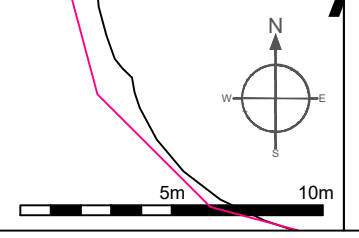



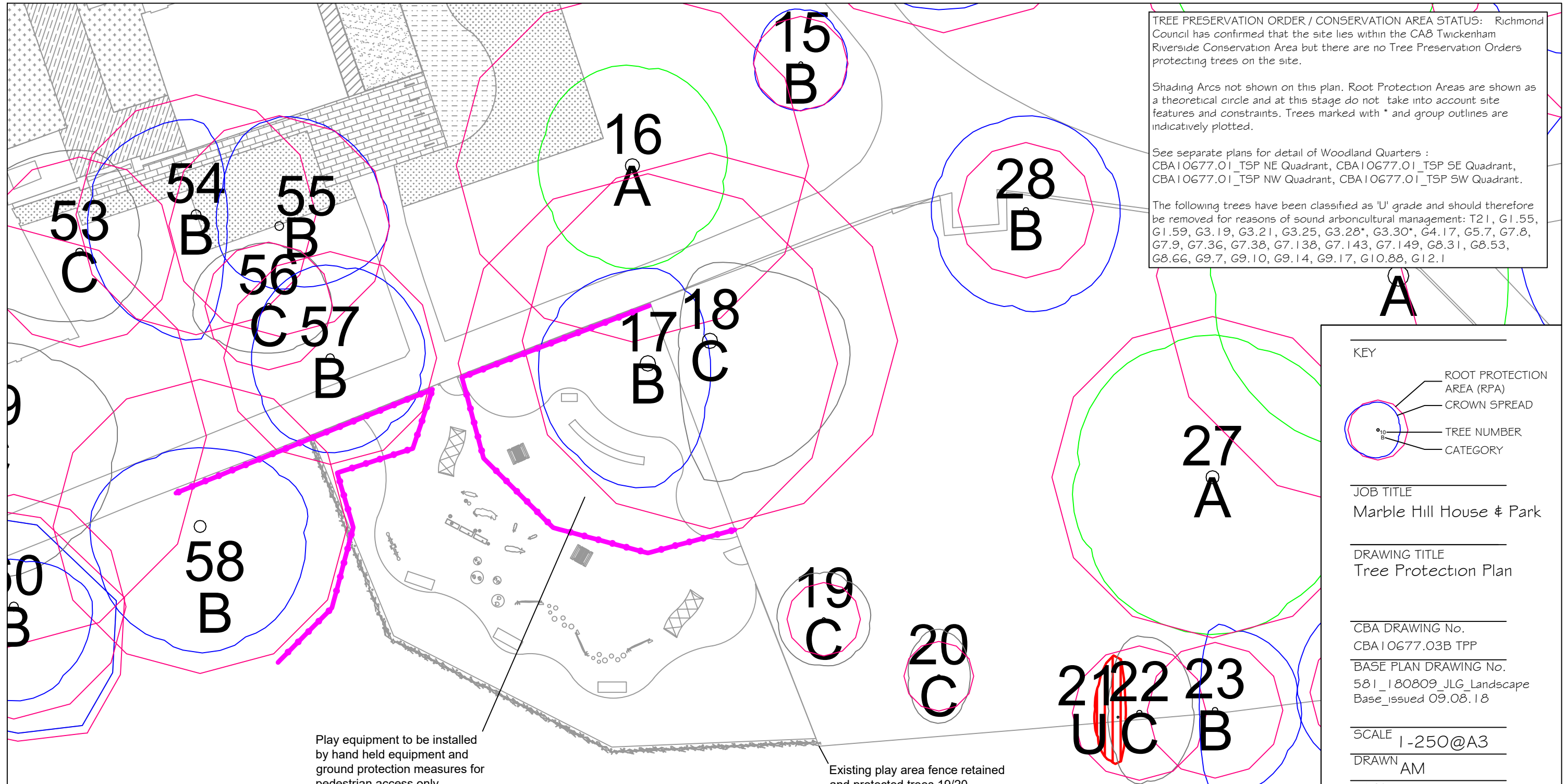

TREE PRESERVATION ORDER / CONSERVATION AREA STATUS: Richmond Council has confirmed that the site lies within the CA8 Twickenham Riverside Conservation Area but there are no Tree Preservation Orders protecting trees on the site.

Shading Arcs not shown on this plan. Root Protection Areas are shown as a theoretical circle and at this stage do not take into account site features and constraints. Trees marked with \* and group outlines are indicatively plotted.

See separate plans for detail of Woodland Quarters :  
 CBA10677.01\_TSP NE Quadrant, CBA10677.01\_TSP SE Quadrant,  
 CBA10677.01\_TSP NW Quadrant, CBA10677.01\_TSP SW Quadrant.

The following trees have been classified as 'U' grade and should therefore be removed for reasons of sound arboricultural management: T21, G1.55, G1.59, G3.19, G3.21, G3.25, G3.28\*, G3.30\*, G4.17, G5.7, G7.8, G7.9, G7.36, G7.38, G7.138, G7.143, G7.149, G8.31, G8.53, G8.66, G9.7, G9.10, G9.14, G9.17, G10.88, G12.1

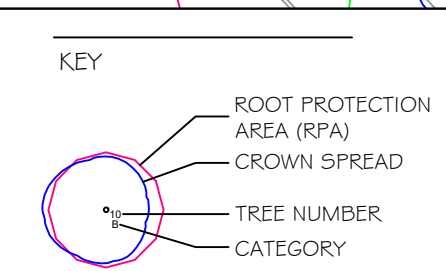

JOB TITLE  
Marble Hill House & Park

DRAWING TITLE  
Tree Protection Plan

CBA DRAWING No.  
CBA10677.03B TPP

BASE PLAN DRAWING No.  
581\_180809\_JLG\_Landscape  
Base\_issued 09.08.18

SCALE  
1-250@A3

DRAWN  
AM

DATE  
August 2018

THIS DRAWING IS COPYRIGHT OF CBA Trees. AND SHOULD NOT BE REPRODUCED WITHOUT PERMISSION. ALL DIMENSIONS MUST BE CHECKED ON SITE AND NOT SCALED FROM THIS DRAWING.



Play equipment to be installed by hand held equipment and ground protection measures for pedestrian access only.

Existing play area fence retained and protected trees 19/20

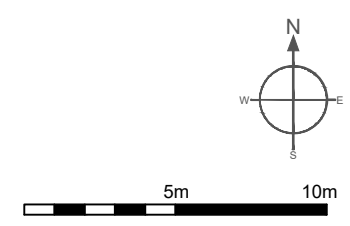
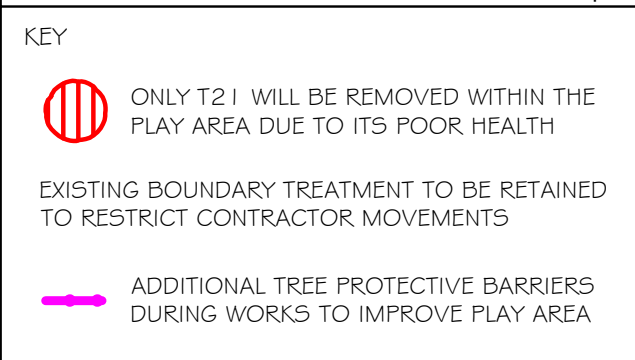





For tree protection details please refer to CBA10677.02E

For tree protection details please refer to CBA10677.03B

Please refer to 581\_PL.L.27\_NE Woodland Quarter

Please refer to 581\_PL.L.26\_NW Woodland Quarter

Please refer to 581\_PL.L.29\_SE Woodland Quarter

Please refer to 581\_PL.L.28\_SW Woodland Quarter

**TREE PRESERVATION ORDER / CONSERVATION AREA STATUS:** Rushmore Council has confirmed that the site lies within the CAB Tickerton Riverside Conservation Area but there are no Tree Preservation Orders protecting trees on the site.  
 Shading Area not shown on this plan. Root Protection Areas are shown as a theoretical circle and at this stage do not take into account site features and constraints. Trees marked with 'x' and group outlines are inductively plotted.  
 See separate plans for detail of Woodland Quarters:  
 CBA10677.01\_TSP NE Quadrant, CBA10677.02\_TSP SE Quadrant, CBA10677.03\_TSP NW Quadrant, CBA10677.04\_TSP SW Quadrant.  
 The following trees have been classified as 'I' grade and should therefore be removed for reasons of sound arboricultural management: G1.5, G1.9, G3.19, G3.21, G3.25, G3.29, G3.30, G4.17, G5.7, G7.0, G7.9, G7.16, G7.18, G7.19, G7.14, G7.14, G7.14, G8.31, G8.53, G8.66, G9.7, G9.10, G9.14, G9.17, G10.88, G12.1

- KEY**
- TREE ADVISED TO BE REMOVED FOR REASONS OF SOUND ARBORICULTURAL MANAGEMENT, SUBJECT TO LOCAL AUTHORITY APPROVAL
  - TREE TO BE REMOVED TO FACILITATE STABLE BLOCK, CAFE AND LANDSCAPE RESTORATION WORKS SUBJECT TO LOCAL AUTHORITY APPROVAL
  - LANDSCAPE RESTORATION WORKS PLEASE REFER TO JAL GIBBONS DRAWINGS FOR SPECIFICS
  - TREES TO BE RETAINED AND PROTECTED IN ACCORDANCE WITH BS5837:2012

**KEY**

- ROOT PROTECTION AREA (RPA)
- CROWN SPREAD
- TREE NUMBER
- CATEGORY

**JOB TITLE**  
Marble Hill House 4 Park

**DRAWING TITLE**  
Tree Retention Plan

**CBA DRAWING No.**  
CBA10677.04E TRP

**SCALE PLAN DRAWING NO.**  
581\_100821\_JLG Landscape Base\_souled 21.06.16

**SCALE**  
1:500 @A0

**DRAWN**  
AM

**DATE**  
September 2018

**THE DRAWING IS THE PROPERTY OF CBA AND NOT TO BE REPRODUCED OR TRANSMITTED IN ANY FORM OR BY ANY MEANS, ELECTRONIC OR MECHANICAL, INCLUDING PHOTOCOPYING, RECORDING, OR BY ANY INFORMATION STORAGE AND RETRIEVAL SYSTEM.**

**CBA**  
Rushmore Council, 100 Victoria Road, Reading, RG2 0BA

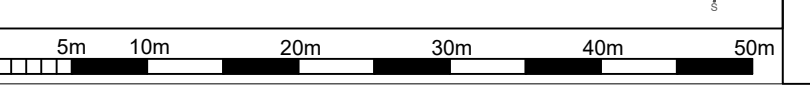







## TREE WORKS SCHEDULE

<b>Client:</b>	English Heritage	<b>Site:</b>	Marble Hill House and Park
<b>Date:</b>	August 2018	<b>Consultant:</b>	Stefan Rose <i>Bsc (Hons)</i> , TechCert ( <i>Arbor.A</i> ), TechArborA

Tree No.	Species	Recommended Works
21	Elder	• Fell and remove stump
47	Yew	• Fell and remove stump
48	Holm Oak	• Fell and remove stump
49	Birch 'Youngii'	• Fell and remove stump
Grp 3	Mixed Species	• Fell and remove stumps in section as indicated on plan CBA10677.02B TPP
G3.28	Horse Chestnut	• Fell to a safe height
G3.30	Horse Chestnut	• Fell to a safe height
G3.48	Acacia	• Fell and remove stump
G3.49	Hemlock	• Fell and remove stump
G3.50	Cherry	• Fell and remove stump
G3.51	Yew	• Fell and remove stump
G3.53	Cypress	• Fell and remove stump
G4.13	Swedish Whitebeam	• Fell and remove stump
G7.8	Common Lime	• Fell and remove stump
G7.9	Common Yew	• Fell and remove stump
G7.41	Field Maple	• Fell and remove stump
G7.59	Field Maple	• Fell and remove stump
G7.76	Holm Oak	• Fell and remove stump
G7.83	Holm Oak	• Retained as coppice
G7.84	Holm Oak	• Fell and remove stump
G7.85	Holm Oak	• Fell and remove stump
G7.86	Holm Oak	• Fell and remove stump
G7.87	Holm Oak	• Fell and remove stump
G7.88	Holm Oak	• Fell and remove stump
G7.89	Holm Oak	• Fell and remove stump
G7.90	Common Hawthorn	• Fell and remove stump
G7.91	Holm Oak	• Retained as coppice
G7.93	Dogwood	• Fell and remove stump
G7.94	Holm Oak	• Fell and remove stump
G7.95	Robinia	• Fell and remove stump
G7.96	Robinia	• Fell and remove stump
G7.97	Robinia	• Fell and remove stump
G7.98	Robinia	• Fell and remove stump
G7.99	Robinia	• Fell and remove stump
G7.100	Common Hawthorn	• Fell and remove stump
G7.101	English Elm	• Fell and remove stump

Tree No.	Species	Recommended Works
G7.102	Common Holly	• Fell and remove stump
G7.103	Field Maple	• Fell and remove stump
G7.104	Field Maple	• Retained as coppice
G7.105	Wild Cherry	• Fell and remove stump
G7.106	Field Maple	• Fell and remove stump
G7.110	Common Ash	• Fell and remove stump
G7.116	Common Lime	• Fell and remove stump
G7.133	English Elm	• Retained as coppice
G7.135	Common Hawthorn	• Retained as coppice
G7.138	Common Holly	• Fell and remove stump
G7.143	Common Hawthorn	• Fell and remove stump
G7.146	Common Holly	• Fell and remove stump
G7.147	Common Holly	• Fell and remove stump
G7.148	Common Ash	• Fell and remove stump
G7.149	Norway Maple	• Fell and remove stump
G7.150	Common Holly	• Fell and remove stump
G7.152*	English Elm	• Retained as coppice
G7.154	Wild Cherry	• Fell and remove stump
G7.155	Common Holly	• Fell and remove stump
G7.156	Common Hawthorn	• Fell and remove stump
G7.157	Common Holly	• Retained as coppice
G7.158	English Elm	• Retained as coppice
G7.159	Common Holly	• Fell and remove stump
G7.160	Common Holly	• Fell and remove stump
G7.161	Holm Oak	• Fell and remove stump
G7.162	Norway Maple	• Fell and remove stump
G7.163	Common Horse Chestnut	• Fell and remove stump
G7.164	Field Maple	• Fell and remove stump
G7.165	Robinia	• Fell and remove stump
G7.166	Robinia	• Fell and remove stump
G7.167	Norway Maple	• Fell and remove stump
G7.168	Common Holly	• Fell and remove stump
G7.169	Common Holly	• Fell and remove stump
G7.170	English Elm	• Fell and remove stump
G7.171	English Elm	• Retained as coppice
G7.176	Norway Maple	• Fell and remove stump
G7.177	Sycamore	• Fell and remove stump
G7.178	Common Holly	• Fell and remove stump
G7.179	Norway Maple	• Fell and remove stump
G7.180	Common Holly	• Fell and remove stump
G7.181	Field Maple	• Fell and remove stump
G7.182	Field Maple	• Fell and remove stump
G7.184	Common Hawthorn	• Retained as coppice
G7.185	Robinia	• Fell and remove stump
G7.187	Robinia	• Fell and remove stump
G7.188	Common Hawthorn	• Fell and remove stump



Tree No.	Species	Recommended Works
G7.189	Common Hawthorn	• Fell and remove stump
G7.192	Cherry Laurel	• Fell and remove stump
G7.195	English Elm	• Fell and remove stump
G7.196	Holm Oak	• Fell and remove stump
G7.197	Holm Oak	• Fell and remove stump
G7.198	Pedunculate Oak	• Fell and remove stump
G7.199	Common Holly	• Fell and remove stump
G7.200	Common Holly	• Fell and remove stump
G7.201	Wild Cherry	• Fell and remove stump
G7.203	Common Yew	• Fell and remove stump
G7.204	Common Yew	• Fell and remove stump
G8.11	Common Yew	• Fell and remove stump
G8.16*	Common Ash	• Retained as coppice
G8.25	English Elm	• Fell and remove stump
G8.26	English Elm	• Fell and remove stump
G8.27	English Elm	• Fell and remove stump
G8.28	English Elm	• Fell and remove stump
G8.31	Wild Cherry	• Fell and remove stump
G8.32	English Elm	• Fell and remove stump
G8.33	English Elm	• Fell and remove stump
G8.34	English Elm	• Fell and remove stump
G8.35*	English Elm	• Fell and remove stump
G8.36	Field Maple	• Fell and remove stump
G8.37*	English Elm	• Fell and remove stump
G8.38	English Elm	• Fell and remove stump
G8.39	English Elm	• Fell and remove stump
G8.40	Common Ash	• Fell and remove stump
G8.41	Common Holly	• Fell and remove stump
G8.42*	Sycamore	• Fell and remove stump
G8.43	Common Ash	• Fell and remove stump
G8.44*	English Elm	• Fell and remove stump
G8.45*	English Elm	• Fell and remove stump
G8.46*	English Elm	• Fell and remove stump
G8.47*	English Elm	• Fell and remove stump
G8.48*	English Elm	• Fell and remove stump
G8.49	Griselinia littoralis	• Fell and remove stump
G8.50	English Elm	• Fell and remove stump
G8.51	Common Ash	• Fell and remove stump
G8.52*	English Elm	• Fell and remove stump
G8.53	Sycamore	• Fell and remove stump
G8.54*	Sycamore	• Fell and remove stump
G8.55	Common Holly	• Fell and remove stump
G8.56	Common Holly	• Fell and remove stump
G8.57	Common Elder	• Fell and remove stump
G8.58	Common Holly	• Fell and remove stump
G8.60	Common Yew	• Fell and remove stump



Tree No.	Species	Recommended Works
G8.61	Highclere Holly	• Fell and remove stump
G8.62*	Common Elder	• Fell and remove stump
G8.63	English Elm	• Fell and remove stump
G8.64*	Common Ash	• Fell and remove stump
G8.65	Common Holly	• Fell and remove stump
G8.66	Common Holly	• Fell and remove stump
G8.67	Common Holly	• Fell and remove stump
G8.68*	English Elm	• Fell and remove stump
G8.69	Common Holly	• Fell and remove stump
G8.70	Holm Oak	• Fell and remove stump
G8.71*	Common Yew	• Fell and remove stump
G8.72	Griselinia littoralis	• Fell and remove stump
G8.73	Common Holly	• Fell and remove stump
G8.74	Common Holly	• Fell and remove stump
G8.75*	Sycamore	• Fell and remove stump
G8.76*	English Elm	• Fell and remove stump
G8.77	Common Holly	• Fell and remove stump
G8.78	Common Holly	• Fell and remove stump
G8.79	English Elm	• Fell and remove stump
G8.80	English Elm	• Fell and remove stump
G8.81	Common Yew	• Fell and remove stump
G8.85*	Common Ash	• Retained as coppice
G8.89	English Elm	• Retained as coppice
G8.92	English Elm	• Retained as coppice
G8.99	Common Ash	• Retained as coppice
G8.100	Pedunculate Oak	• Retained as coppice
G9.7	Pedunculate Oak	• Retained for ecological reasons
G9.10	Pedunculate Oak	• Retained for ecological reasons
G9.14	Common Ash	• Fell and remove stump
G9.17	Common Lime	• Fell and remove stump
G9.25	Common Holly	• Retained as coppice
G9.29*	Common Holly	• Retained as coppice
G9.30	Sycamore	• Retained as coppice
G9.31	Sycamore	• Retained as coppice
G9.35	Cherry Laurel	• Fell and remove stump
G9.36	Common Holly	• Retained as coppice
G9.39	Common Yew	• Fell and remove stump
G9.41	Common Hornbeam	• Fell and remove stump
G9.42	Common Yew	• Fell and remove stump
G9.43	Common Hawthorn	• Fell and remove stump
G9.44	Common Yew	• Fell and remove stump
G9.51	Common Ash	• Retained as coppice
G9.53	Common Ash	• Retained as coppice
G9.57	Common Holly	• Retained as coppice
G9.62	Common Ash	• Fell and remove stump
G9.63	Common Lime	• Fell and remove stump



Tree No.	Species	Recommended Works
G9.64	Sycamore	• Retained as coppice
G9.65	Common Ash	• Retained as coppice
G9.71*	Common Ash	• Retained as coppice
G9.73	Common Hawthorn	• Retained as coppice
G9.74	Common Hawthorn	• Retained as coppice
G9.84	Common Yew	• Fell and remove stump
G9.85	Common Yew	• Fell and remove stump
G9.86	Common Yew	• Fell and remove stump
G9.87	Holm Oak	• Fell and remove stump
G9.88	Common Yew	• Fell and remove stump
G9.89	Common Yew	• Fell and remove stump
G9.90	Sycamore	• Fell and remove stump
G9.91	Holm Oak	• Fell and remove stump
G9.92	English Elm	• Fell and remove stump
G9.93	Common Yew	• Retained as coppice
G9.95	Sycamore	• Retained as coppice
G9.96	Common Ash	• Retained as coppice
G9.99	English Elm	• Fell and remove stump
G9.100	Common Yew	• Fell and remove stump
G9.101	English Elm	• Fell and remove stump
G9.102	Duplicate tree	• -
G9.104	Common Ash	• Fell and remove stump
G9.107	Pedunculate Oak	• Fell and remove stump
G9.108	English Elm	• Fell and remove stump
G9.109	Pedunculate Oak	• Fell and remove stump
G9.110	Pedunculate Oak	• Fell and remove stump
G9.113	Pedunculate Oak	• Fell and remove stump
G9.114	Sycamore	• Fell and remove stump
G9.115	Common Yew	• Fell and remove stump
G9.116	Common Hawthorn	• Fell and remove stump
G9.117	Common Hawthorn	• Fell and remove stump
G9.118	Pedunculate Oak	• Fell and remove stump
G9.119	Common Yew	• Fell and remove stump
G9.120	Common Yew	• Fell and remove stump
G9.121	Sycamore	• Fell and remove stump
G9.122	Sycamore	• Fell and remove stump
G9.123	Sycamore	• Fell and remove stump
G9.124	Sycamore	• Fell and remove stump
G9.125	Sycamore	• Fell and remove stump
G9.126	Sycamore	• Fell and remove stump
G9.127	Sycamore	• Fell and remove stump
G9.128	Common Yew	• Fell and remove stump
G9.129	Common Yew	• Fell and remove stump
G9.130	Holm Oak	• Fell and remove stump
G9.131	Holm Oak	• Fell and remove stump
G9.132	Common Yew	• Fell and remove stump



Tree No.	Species	Recommended Works
G9.133	Common Yew	• Fell and remove stump
G9.134	Common Hornbeam	• Fell and remove stump
G9.135	Holm Oak	• Fell and remove stump
G9.136	Common Hawthorn	• Fell and remove stump
G9.137	Pedunculate Oak	• Fell and remove stump
G9.138	Common Yew	• Fell and remove stump
G9.139	Common Holly	• Fell and remove stump
G9.140	Common Hornbeam	• Fell and remove stump
G9.141	Common Holly	• Fell and remove stump
G9.142	Common Holly	• Fell and remove stump
G9.143	Common Holly	• Fell and remove stump
G9.144	Common Holly	• Fell and remove stump
G9.145	Common Yew	• Fell and remove stump
G9.146	Common Holly	• Fell and remove stump
G9.147	Common Yew	• Fell and remove stump
G9.148	Common Yew	• Fell and remove stump
G9.149	Common Holly	• Fell and remove stump
G9.150	Common Hawthorn	• Fell and remove stump
G9.151	Sycamore	• Fell and remove stump
G9.152	Sycamore	• Fell and remove stump
G9.153	Sycamore	• Fell and remove stump
G9.154	Common Holly	• Fell and remove stump
G9.155	Common Holly	• Fell and remove stump
G9.156	Common Yew	• Fell and remove stump
G9.157*	Cherry Laurel x4	• Fell and remove stump
G9.158	Sycamore x3 Holly x4 Ash x2 Elder x2	• Fell and remove stump
G10.3	English Elm	• Fell and remove stump
G10.4	Common Holly	• Fell and remove stump
G10.5	Common Yew	• Fell and remove stump
G10.6	Sycamore	• Retained as coppice
G10.7	Sycamore	• Retained as coppice
G10.8	Pedunculate Oak	• Fell and remove stump
G10.9	Common Ash	• Fell and remove stump
G10.10	English Elm	• Fell and remove stump
G10.11	Common Ash	• Fell and remove stump
G10.12	Common Ash	• Fell and remove stump
G10.13	Common Ash	• Fell and remove stump
G10.14	Holm Oak	• Fell and remove stump
G10.15	Common Holly	• Fell and remove stump
G10.16	English Elm	• Retained as coppice
G10.19*	Elm x1 Yew x3 Holly x1 Holm Oak x1 Sycamore x4	• Fell and remove stump

Tree No.	Species	Recommended Works
G10.20	Common Holly	• Retained as coppice
G10.22	Common Holly	• Fell and remove stump
G10.23	Common Holly	• Retained as coppice
G10.24	Common Holly	• Fell and remove stump
G10.25	Common Yew	• Fell and remove stump
G10.26	Common Holly	• Fell and remove stump
G10.27	Common Hawthorn	• Fell and remove stump
G10.44	Ash Sycamore Elm x12	• Fell and remove stump
G10.46	Common Yew	• Fell and remove stump
G10.47	Common Ash	• Retained as coppice
G10.48	Common Yew	• Fell and remove stump
G10.49	Common Yew	• Fell and remove stump
G10.50	Stump	• Fell and remove stump
G10.51	Common Yew	• Fell and remove stump
G10.53	Common Ash	• Retained as coppice
G10.54	Common Ash	• Fell and remove stump
G10.55*	Cherry Laurel	• Fell and remove stump
G10.56*	Common Elder	• Fell and remove stump
G10.57	Portugal Laurel	• Fell and remove stump
G10.58	Common Holly	• Fell and remove stump
G10.59	Common Beech	• Fell and remove stump
G10.60	Sycamore	• Fell and remove stump
G10.61	Sycamore	• Retained as coppice
G10.64	Sycamore	• Retained as coppice
G10.65*	Common Holly	• Fell and remove stump
G10.66*	Common Holly	• Fell and remove stump
G10.67	Sycamore	• Fell and remove stump
G10.68	Common Ash	• Fell and remove stump
G10.69	Common Hawthorn	• Fell and remove stump
G10.70	Sycamore	• Fell and remove stump
G10.75	Sycamore	• Fell and remove stump
G10.76	Sycamore	• Fell and remove stump
G10.77	Sycamore	• Fell and remove stump
G10.78	Field Maple	• Fell and remove stump
G10.79	Common Ash	• Fell and remove stump
G10.80	English Elm	• Fell and remove stump
G10.81	Common Ash	• Fell and remove stump
G10.84	Field Maple	• Fell and remove stump
G10.85	Field Maple	• Fell and remove stump
G10.86	Common Ash	• Fell and remove stump
G10.87	Common Ash	• Fell and remove stump
G10.88	Common Ash	• Fell and remove stump
G10.89	Common Ash	• Fell and remove stump
G10.90	Field Maple	• Fell and remove stump
G10.92*	Common Ash	• Fell and remove stump



Tree No.	Species	Recommended Works
G10.98	Common Ash	• Fell and remove stump
G10.99	English Elm	• Fell and remove stump
G10.100	Common Ash	• Fell and remove stump
G10.101	English Elm	• Fell and remove stump
G10.102	English Elm	• Fell and remove stump
G10.103*	Sycamore	• Fell and remove stump
G10.104	English Elm	• Fell and remove stump
G10.106	Holm Oak	• Fell and remove stump
G10.109*	English Elm	• Fell and remove stump
G10.110	English Elm	• Fell and remove stump
G10.111*	Holm Oak	• Fell and remove stump
G10.114	English Elm	• Retained as coppice
G10.116	Field Maple	• Fell and remove stump
G10.117	Field Maple	• Fell and remove stump
G10.118	Field Maple	• Fell and remove stump
G10.119	Common Ash	• Fell and remove stump
G10.120	Field Maple	• Fell and remove stump
G10.122	Field Maple	• Fell and remove stump
G10.123*	English Elm	• Retained as coppice
G10.124	English Elm	• Retained as coppice
G10.126	Holm Oak	• Retained as coppice
G10.127	English Elm	• Retained as coppice
G10.132	English Elm	• Retained as coppice
G10.135*	Common Holly	• Retained as coppice
G10.137	Sycamore	• Fell and remove stump
G10.138	English Elm	• Fell and remove stump
G10.139	Common Holly	• Fell and remove stump
G10.141	English Elm	• Fell and remove stump
G10.142	Common Hawthorn	• Fell and remove stump
G10.143	Sycamore	• Fell and remove stump
G10.144	Common Hawthorn	• Fell and remove stump
G10.145	Sycamore	• Fell and remove stump
G10.146	Sycamore	• Fell and remove stump

- It is advised that all remedial tree works such as pruning is carried out between July and September or November and February. Tree works should also avoid the season for nesting birds.
- All tree works should be carried out in accordance with current best practice guidelines and BS3998: 2010 – Tree Works. Only natural target pruning method to be used.
- We recommend the use of an Arboricultural Association Approved Contractor or an ISA Certified Arborist/Tree Worker suitably insured and experienced to carry out the tree works.

