



3.1 SITE DEMOLITIONS AND REMOVALS

The demolition and removal strategy for Marble Hill Park aims to simplify the furniture and paving palette across the site, remove inappropriate and dilapidated structures in the context of the listed buildings, improve the setting of landscape features and increase access across the park.

Benches & Bins

A variety of bench types are currently present in the Park, in differing states of repair, the majority of which are memorial benches. Any non-memorial benches, like the one shown opposite, will be removed and replaced with a higher quality bench. A record will be made of all memorial benches to ensure these remain, or given the option to be replaced if they are in a poor state of repair. The location of benches will be rationalised and given new paved plinths. A strategy will be devised to accommodate requests for new memorial benches.

Currently separate litter and dog-foul bins are provided at Marble Hill Park, many of which are in poor condition. In line with revised waste collection policy, these bins will be replaced with single litter bins and located at strategic points near entrance/exits.

Fencing

The timber palisade fencing will be removed from the perimeter of the Woodland Quarters and replaced with a mix of estate railings and post and wire fencing set within hedges with gates for access to the public. The two northern quarters will be fully open to the public. The two southern quarters will mostly be accessible but will have two areas that are enclosed for nature conservation to allow longer term management.

Structures

The Chinese style shelter overlooking the west meadow is in poor state of repair and is not appropriate to the setting of Marble Hill House, so will be removed. The disused toilet block within the north-west Woodland Quarter will be removed to open up the area and improve the setting of the Ice House.

The two raised lawns in front of the Stable Block will be removed to improve the setting and open up views of the listed stables building.



Dilapidated benches



Litter bins

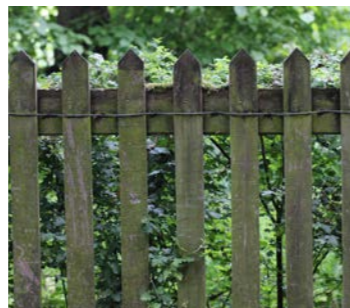

Palisade fencing around Woodland Quarters



Chinese style shelter



Raised lawns in front of Stable Block

KEY:

1. Removal of non-memorial bench. Replacement with new bench as per Furniture Plan 581_PL_L_04
2. Remove timber palisade fencing and replace with estate railings and post and wire fencing and gates for access
3. Demolition of former toilet block in Woodland Quarter
4. Removal of clipped hedge and fence around Grotto - new planting to improve setting as per drawing 581_PL_L_01 (Illustrative Landscape Plan)
5. Demolition of Chinese style shelter
6. Removal of speed restriction hump to enable access to new service yard entrance
7. Demolition of raised lawns in front of the Stable Block to improve setting
8. Removal of existing patches of hard standing
9. Removal of 3no. cycle stands. Replacements as per 581_PL_L_01
10. Removal of picket fence around existing cafe terrace

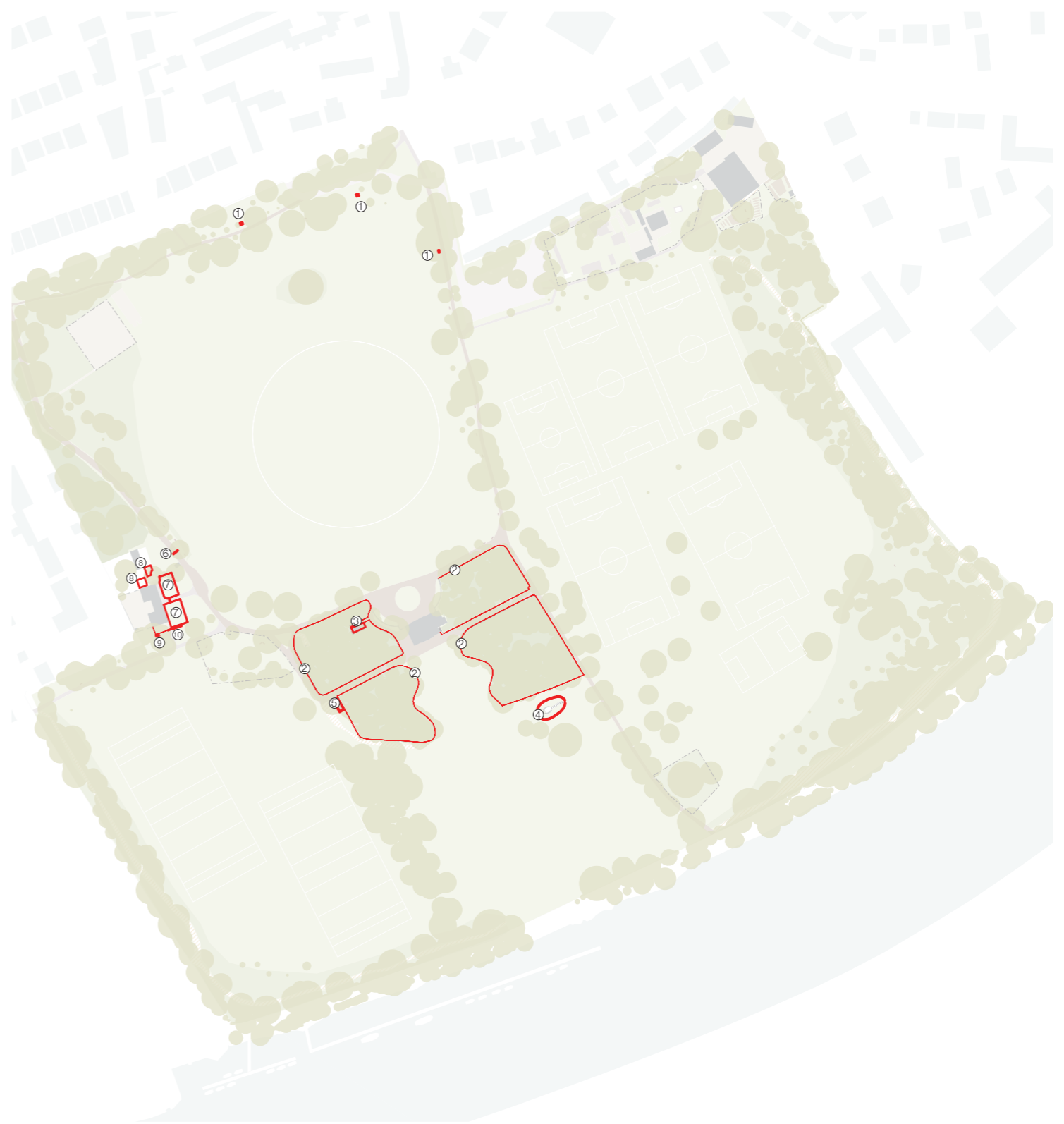

Sitewide Demolition Plan - Ref. 581_PL_L_11_B



3.2 SITE CONSTRUCTION MANAGEMENT

Site access will be from the north, from Richmond Road at White Lodge, along the western drive. This gate will be closed to park users throughout construction to avoid conflict between pedestrians, visitor cars and site traffic. Timed deliveries and banksmen will be required to ensure flow of site traffic is maintained and the site access is safe and secured. Consideration will be given to the size of delivery vehicles that can safely enter through the Richmond Road gate. A vehicle holding area will be designated inside the entrance gate so that vehicles are not held on Richmond Road and traffic flow is maintained. This will also be the wheel washing area for site traffic before exiting onto Richmond Road. The suspension of pavements, roadspace and bus stops will not be required. A designated parking area for construction workers will be provided within the secure site hoarding line, to the north of Marble Hill House. This will ensure visitor parking and surrounding roads will not be affected. Protective track matting will be placed on the lawn for parking, keeping the roads clear for site traffic. The lawn will be reinstated as part of the contractor's making good works of the site compound. The Stable Block and cafe works will have a dedicated storage area to the east of the Stables. The storage area for Main House and landscape works will be located east of the House in the north-east woodland quarter. Material storage will be outside of tree root protection areas and access routes which pass over RPA will be adequately protected in accordance with BS 5837:2012. Any skips required by the contractor will also be located in these storage areas. A solid 2m high hoarding will enclose two main work sites, including laydown and site welfare facilities; one at the Stable Block and the second around Marble Hill House, including the two northern woodland quarters. The boundary of the work site may change to accommodate site activities, particularly site services connections and renovations to the sports pitches. Heras fencing will be used to create safe enclosure on a short-term basis, or where a solid hoarding would be inappropriate.

A public information board will be located on the solid hoarding, adjacent to the north-south footpath. This will include details of the project, contractor, programme of works and emergency contact information. A phased construction programme will be developed with the chosen contractor. This will seek to maximise the area of usable park available to the public throughout construction and limit the impact of construction works on the enjoyment of the park.

The contractor will need to ensure they adhere to BS5288:2009 in relation to emission of noise, vibration, dust and working hours. They will also need to demonstrate that light spillage minimisation techniques are employed to ensure minimal disturbance to bats is incurred.



Sitewide Construction Management Plan - Ref. 581_PL_L_23_C

